

Sirois, Andrea
Somes, Daniel
622 Mercer Road
New Sharon ME 04955

B499P163 B3977P294 B3977P296

Previous Owner
Sirois, Beth
Gould, Heidi, Lori Gilman
52 Cottle Hill
Mt Vernon ME 04352
Sale Date: 5/14/2018

Previous Owner
Downing, Andrea
Somes, Daniel
622 Mercer Road
New Sharon ME 04955
Sale Date: 1/10/2018

Inspection Witnessed By:

X Date

No./Date	Description	Date Insp.

Notes:

2/24 - LD EST ALL DATA, EF, EST IF

New Sharon

Property Data		
Neighborhood	4 NBHD 4	
Tree Growth Year	0	
1ST MORTGAGE	0	
2ND MORTGAGE	0	
Zone/Land Use	1 New Sharon all	
Secondary Zone		
Topography		
1.Level	4.Below St	7.LevelBog
2.Rolling	5.Low	8.
3.Above St	6.Swampy	9.
Utilities		
1.Public	4.Dr Well	7.Cesspool
2.Water	5.Dug Well	8.
3.Sewer	6.Septic	9.Non
Street		
1.Paved	4.Proposed	7.
2.Semi Imp	5.R/O/W	8.
3.Gravel	6.	9.No
TG PLAN YEAR	0	
Tif District #	0	
Sale Data		
Sale Date	1/10/2018	
Price	88,340	
Sale Type	Land & Buildings	
1.Land	4.Mobile	7.C/I L&B
2.L&B	5.Other	8.
3.Building	6.C/I Land	9.
Financing	9 Unknown	
1.Convent	4.Seller	7.
2.FHA/VA	5.Private	8.
3.Assumed	6.Cash	9.Unknown
Validity	1 Arms Length Sale	
1.Valid	4.Split	7.Renovate
2.Related	5.Partial	8.Other
3.Distress	6.Exempt	9.
Verified	5 Public Record	
1.Buyer	4.Agent	7.Family
2.Seller	5.Pub Rec	8.Other
3.Lender	6.MLS	9.

Assessment Record				
Year	Land	Buildings	Exempt	Total
2011	49,000	63,890	10,000	102,890
2012	49,000	63,890	10,000	102,890
2013	49,000	63,890	10,000	102,890
2014	49,000	63,890	10,000	102,890
2015	49,000	63,890	10,000	102,890
2016	49,000	49,140	15,000	83,140
2017	49,000	49,140	20,000	78,140
2018	45,000	49,140	0	94,140
2019	45,000	49,140	0	94,140
2020	45,000	49,140	0	94,140
2021	45,000	49,140	0	94,140
2022	45,000	49,140	0	94,140
2024	56,610	123,240	0	179,850

Land Data						
Front Foot	Type	Effective		Influence		Influence Codes
		Frontage	Depth	Factor	Code	
11.Com-Site				%		1.Unimproved
12.Ind-Site				%		2.Excess Frtg
13.Res-Site PR				%		3.Topography
14.Res-Site DR				%		4.Size/Shape
15.Res-Site RMT				%		5.Access
				%		6.Restriction
				%		7.Open Space
				%		8.View/Environ
				%		9.Fract Share
				%		30.Rear Land >10
				%		31.Tillable
				%		32.Pasture
				%		33.Orchard
				%		34.Software F&O
				%		35.Mixed Wood F&O
				%		36.Hardwood F&O
				%		37.Software TG
				%		38.Mixed Wood TG
				%		39.Hardwood TG
				%		40.Wasteland
				%		41.Open Space
				%		42.Mobile Home Si
				%		43.Condo Site
				%		44.Lot Improvemen
				%		45.Subdivision Lo
				%		46.Golf Course
Total Acreage		20.00				



New Sharon

Map Lot 19-50

Account 143

Location 622 Mercer Road

Card 1

Of 1

10/16/2024

Building Style 7 Contemporary	SF Bsmt Living 0	Layout 1 Typical
1.Conv. 5.Garrison 9.Other	Fin Bsmt Grade 0 0	1.Typical 4. 7.
2.Ranch 6.Split 10.Gar/Apt	Secondary Heat 0	2.Inadeq 5. 8.
3.R Ranch 7.Contemp 11.Cottage	Heat Type 100% 5 Forced Warm Air	3.Poor 6. 9.
4.Cape 8.Log 12.Dblewid	1.HWBB 5.FWA 9.No Heat	Attic 9 None
Dwelling Units 1	2.HWCI 6.GravWA 10.Radiant	1.1/4 Fin 4.Full Fin 7.
Other Units 0	3.H Pump 7.Electric 11.	2.1/2 Fin 5.FI/Stair 8.
Stories 2 Two Story	4.Steam 8.FI/Wall 12.	3.3/4 Fin 6. 9.None
1.1 4.1.5 7.	Cool Type 0% 9 None	Insulation 1 Full
2.2 5.1.75 8.	1.Refrig 4.W&C Air 7.	1.Full 4.Minimal 7.
3.3 6.2.5 9.	2.Evapor 5. 8.	2.Heavy 5. 8.
Exterior Walls 1 Wood Siding	3.H Pump 6. 9.None	3.Capped 6. 9.None
1.Wood 5.Stucco 9.Other	Kitchen Style 2 Typical	Unfinished % 0%
2.Vin/Al 6.Brick 10.Cement	1.Modern 4.Obsolete 7.	Grade & Factor 2 Fair 110%
3.Compos. 7.Stone 11.	2.Typical 5. 8.	1.E Grade 4.B Grade 7.
4.Asbestos 8.Concrete 12.	3.Old Type 6. 9.None	2.D Grade 5.A Grade 8.SC Grade
Roof Surface 3 Sheet Metal	Bath(s) Style 2 Typical Bath(s)	3.C Grade 6.AA Grade 9.Same
1.Asphalt 4.Composit 7.SS	1.Modern 4.Obsolete 7.	SOQT (Footprint) 512
2.Slate 5.Wood 8.	2.Typical 5. 8.	Condition 2 Fair
3.Metal 6.Roll Roo 9.	3.Old Type 6. 9.None	1.Poor 4.Avg 7.V G
SF Masonry Trim 0	# Rooms 6	2.Fair 5.Avg+ 8.Exc
Solar Voltaic 0	# Bedrooms 3	3.Avg- 6.Good 9.Same
OPEN-4-CUSTOM 0	# Full Baths 1	Phys. % Good 0%
Year Built 1980	# Half Baths 1	Funct. % Good 100%
Year Remodeled 0	# Addn Fixtures 0	Functional Code 9 None
Foundation 1 Concrete	# Fireplaces 0	1.Incomp 4.Delap 7.No Power
1.Concrete 4.Wood 7.	 <p>TRIO Software A Division of Harris Computer Systems</p>	2.O-Built 5.Bsmt 8.No Power
2.C Block 5.Slab 8.		3.Damage 6.Common 9.No Power
3.Br/Stone 6.Piers 9.		Econ. % Good 100%
Basement 4 Full Basement		Economic Code None
1.1/4 Bmt 4.Full Bmt 7.		0.None 3.No Power 7.
2.1/2 Bmt 5.None 8.		1.Location 4.General 8.
3.3/4 Bmt 6. 9.None		2.Encroach 9.None 9.
Bsmt Gar # Cars 0		Entrance Code 5 Estimated
Wet Basement 1 Dry Basement		1.Interior 4.Vacant 7.
1.Dry 4. 7.		2.Exterior 5.Estimate 8.
2.Damp 5. 8.	3.Informal 6.Reviewed 9.	
3.Wet 6. 9.	Information Code 5 Estimate	
	1.Owner 4.Agent 7.	
	2.Relative 5.Estimate 8.	
	3.Tenant 6.Other 9.	

19-50-00

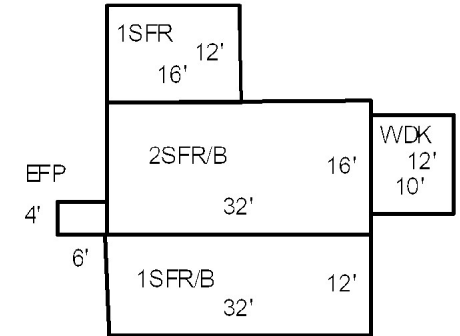

Proposed Value

Date Inspected 2/14/2024

Additions, Outbuildings & Improvements

Type	Year	Units	Grade	Cond	Phys.	Funct.	Sound Value
24 Frame Shed	1990	120	2 100	2	0 %	100 %	
84 Aboveground	2010	1	3 100	3	0 %	100 %	
1 One Story Frame	0	384	0 0	0	0 %	100 %	
27 Unfin Basement	0	384	0 0	0	0 %	100 %	
1 One Story Frame	0	192	0 0	0	0 %	100 %	
68 Wood Deck	0	120	0 0	0	0 %	100 %	
22 Encl Frame Porch	0	24	0 0	0	0 %	100 %	
					%	%	
					%	%	
					%	%	



- 1.One Story Fram
- 2.Two Story Fram
- 3.Three Story Fr
- 4.1 & 1/2 Story
- 5.1 & 3/4 Story
- 6.2 & 1/2 Story
- 21.Open Frame Por
- 22.Encl Frame Por
- 23.Frame Garage
- 24.Frame Shed
- 25.Frame Bay Wind
- 26.1SFr Overhang
- 27.Unfin Basement
- 28.Unfinished Att
- 29.Finished Attic