

LESLIE, EMMA
LESLIE, RICHARD
766 MILE HILL ROAD
NEW SHARON ME 04955

B4560P55

Previous Owner
McCormick, Heather M
766 MILE HILL ROAD

NEW SHARON ME 04955
Sale Date: 6/30/2023

Previous Owner
Boynton, Matthew J.
766 Mile Hill Rd

New Sharon ME 04955
Sale Date: 4/24/2017

Inspection Witnessed By:

X	Date
No./Date	Description
	Date Insp.

Notes:
2/24 - GL EA, EST IG, BEAMED, CEILING KITCH AREA,
NEWER KITCH+FLRG
7/24 - PB SALES REVIEW

New Sharon

Property Data		
Neighborhood	4 NBHD 4	
Tree Growth Year	0	
1ST MORTGAGE	0	
2ND MORTGAGE	0	
Zone/Land Use	1 New Sharon all	
Secondary Zone		
Topography	2 Rolling	
1.Level	4.Below St	7.LevelBog
2.Rolling	5.Low	8.
3.Above St	6.Swampy	9.
Utilities	4 Drilled Well 6 Septic System	
1.Public	4.Dr Well	7.Cesspool
2.Water	5.Dug Well	8.
3.Sewer	6.Septic	9.Non
Street	1 Paved	
1.Paved	4.Proposed	
2.Semi Imp	5.R/O/W	
3.Gravel	6.	
TG PLAN YEAR	0	
Tif District #	0	
Sale Data		
Sale Date	6/30/2023	
Price	240,000	
Sale Type	Land & Buildings	
1.Land	4.Mobile	7.C/I L&B
2.L&B	5.Other	8.
3.Building	6.C/I Land	9.
Financing	5 Private Finance	
1.Convent	4.Seller	7.
2.FHA/VA	5.Private	8.
3.Assumed	6.Cash	9.Unknown
Validity	1 Arms Length Sale	
1.Valid	4.Split	7.Renovate
2.Related	5.Partial	8.Other
3.Distress	6.Exempt	9.
Verified	5 Public Record	
1.Buyer	4.Agent	7.Family
2.Seller	5.Pub Rec	8.Other
3.Lender	6.MLS	9.

Assessment Record				
Year	Land	Buildings	Exempt	Total
2011	28,600	148,650	10,000	167,250
2012	28,600	148,650	10,000	167,250
2013	28,600	148,650	10,000	167,250
2014	28,600	148,650	10,000	167,250
2015	28,600	148,650	10,000	167,250
2016	28,600	148,650	15,000	162,250
2017	28,600	148,650	0	177,250
2018	28,600	148,650	0	177,250
2019	28,600	148,650	0	177,250
2020	28,600	148,650	25,000	152,250
2021	28,600	148,650	25,000	152,250
2022	28,600	148,650	22,250	155,000
2024	38,160	187,870	0	226,030

Land Data						
Front Foot	Type	Effective		Influence		Influence Codes
		Frontage	Depth	Factor	Code	
11.Com-Site				%		1.Unimproved
12.Ind-Site				%		2.Excess Frtg
13.Res-Site PR				%		3.Topography
14.Res-Site DR				%		4.Size/Shape
15.Res-Site RMT				%		5.Access
				%		6.Restriction
				%		7.Open Space
				%		8.View/Environ
				%		9.Fract Share
Square Foot		Square Feet		Acres		30.Rear Land >10
16.Not Used				%		31.Tillable
17.Not Used				%		32.Pasture
18.Not Used				%		33.Orchard
19.Not Used				%		34.Softwood F&O
20.Residential-Si				%		35.Mixed Wood F&O
Fract. Acre	Acreage/Sites					36.Hardwood F&O
21.Homesite (Frac	13	1.00	100	%	0	37.Softwood TG
22.Baselot (Fract	28	1.80	100	%	0	38.Mixed Wood TG
23.Misc (Fract)				%		39.Hardwood TG
Acres				%		40.Wasteland
24.Homesite				%		41.Open Space
25.Baselot				%		42.Mobile Home Si
26.Not Used				%		43.Condo Site
27.Not Used				%		44.Lot Improvemen
28.Rear Land <5				%		45.Subdivision Lo
29.Rear Land 5-10				%		46.Golf Course
Total Acreage		2.80				

New Sharon

Map Lot 16-33

Account 108

Location 766 Mile Hill Road

Card 1 Of 1 10/16/2024

Building Style 2 Ranch	SF Bsmt Living 0	Layout 1 Typical
1.Conv. 5.Garrison 9.Other	Fin Bsmt Grade 0 0	1.Typical 4. 7.
2.Ranch 6.Split 10.Gar/Apt	Secondary Heat 0	2.Inadeq 5. 8.
3.R Ranch 7.Contemp 11.Cottage	Heat Type 100% 1 Hot Water BB	3.Pool 6. 9.
4.Cape 8.Log 12.Dblewid	1.HWBB 5.FWA 9.No Heat	Attic 9 None
Dwelling Units 1	2.HWCI 6.GravWA 10.Radiant	1.1/4 Fin 4.Full Fin 7.
Other Units 0	3.H Pump 7.Electric 11.	2.1/2 Fin 5.FI/Stair 8.
Stories 1 One Story	4.Steam 8.FI/Wall 12.	3.3/4 Fin 6. 9.None
1.1 4.1.5 7.	Cool Type 100% 3 Heat Pump	Insulation 1 Full
2.2 5.1.75 8.	1.Refrig 4.W&C Air 7.	1.Full 4.Minimal 7.
3.3 6.2.5 9.	2.Evapor 5. 8.	2.Heavy 5. 8.
Exterior Walls 1 Wood Siding	3.H Pump 6. 9.None	3.Capped 6. 9.None
1.Wood 5.Stucco 9.Other	Kitchen Style 1 Modern	Unfinished % 0%
2.Vin/Al 6.Brick 10.Cement	1.Modern 4.Obsolete 7.	Grade & Factor 3 Average 100%
3.Compos. 7.Stone 11.	2.Typical 5. 8.	1.E Grade 4.B Grade 7.
4.Asbestos 8.Concrete 12.	3.Old Type 6. 9.None	2.D Grade 5.A Grade 8.SC Grade
Roof Surface 3 Sheet Metal	Bath(s) Style 1 Modern Bath(s)	3.C Grade 6.AA Grade 9.Same
1.Asphalt 4.Composit 7.SS	1.Modern 4.Obsolete 7.	SQFT (Footprint) 1364
2.Slate 5.Wood 8.	2.Typical 5. 8.	Condition 6 Good
3.Metal 6.Roll Roo 9.	3.Old Type 6. 9.None	1.Poor 4.Avg 7.V G
SF Masonry Trim 0	# Rooms 5	2.Fair 5.Avg+ 8.Exc
Solar Voltaic 0	# Bedrooms 3	3.Avg- 6.Good 9.Same
OPEN-4-CUSTOM 0	# Full Baths 1	Phys. % Good 0%
Year Built 1976	# Half Baths 1	Funct. % Good 100%
Year Remodeled 0	# Addn Fixtures 0	Functional Code 9 None
Foundation 1 Concrete	# Fireplaces 1	1.Incomp 4.Delap 7.No Power
1.Concrete 4.Wood 7.		2.O-Built 5.Bsmt 8.No Part
2.C Block 5.Slab 8.		3.Damage 6.Common 9.No
3.Br/Stone 6.Piers 9.		Econ. % Good 100%
Basement 4 Full Basement		Economic Code None
1.1/4 Bmt 4.Full Bmt 7.		0.None 3.No Power 7.
2.1/2 Bmt 5.None 8.		1.Location 4.General 8.
3.3/4 Bmt 6. 9.None		2.Encroach 9.None 9.
Bsmt Gar # Cars 0		Entrance Code 5 Estimate
Wet Basement 1 Dry Basement		1.Interior 4.Vacant 7.
1.Dry 4. 7.		2.General 5.Estimate 8.
2.Damp 5. 8.		3.Inform 6.Reviewed 9.
3.Wet 6. 9.		Information Code 5 Estimate
		1.Owner 4.Agent 7.
		2.Relative 5.Estimate 8.
		3.Tenant 6.Other 9.

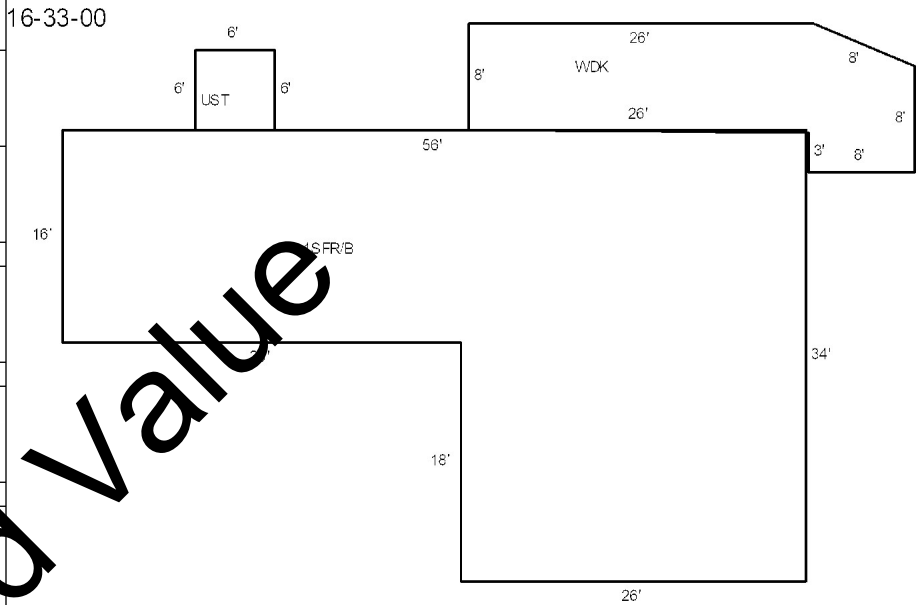

Proposed Value

Date Inspected 2/29/2024

Additions, Outbuildings & Improvements

Type	Year	Units	Grade	Cond	Phys.	Funct.	Sound Value
23 Frame Garage	1976	416	3 100	4	0 %	100 %	
24 Frame Shed	1976	192	3 100	4	0 %	100 %	
61 Canopy	1976	66	2 100	1	0 %	100 %	
68 Wood Deck	0	286	0 0	0	0 %	100 %	
19 Utility Storage	0	36	0 0	0	0 %	100 %	
					%	%	
					%	%	
					%	%	
					%	%	
					%	%	
					%	%	
					%	%	



- 1.One Story Fram
- 2.Two Story Fram
- 3.Three Story Fr
- 4.1 & 1/2 Story
- 5.1 & 3/4 Story
- 6.2 & 1/2 Story
- 21.Open Frame Por
- 22.Encl Frame Por
- 23.Frame Garage
- 24.Frame Shed
- 25.Frame Bay Wind
- 26.1SFr Overhang
- 27.Unfin Basement
- 28.Unfinished Att
- 29.Finished Attic