

Shurtleff, Daniel R
Shurtleff, Darcy D
925 INDUSTRY RD
NEW SHARON ME 04955

B1921P8

Inspection Witnessed By:

No./Date	Description	Date Insp.
X		

Notes:
2021 Trio showed 59 acres but the assessed value was correct in 29 acres.
Corrected in TRIO Tw
5/24 - LD EA, EST IA, EST ALL DATA=NT

New Sharon

Property Data			Assessment Record																																																																																																																																																																																																																
Neighborhood 5 NBHD 5			Year	Land	Buildings	Exempt	Total																																																																																																																																																																																																												
Tree Growth Year 0			2011	52,200	130,630	10,000	172,830																																																																																																																																																																																																												
1ST MORTGAGE 0			2012	52,200	130,630	10,000	172,830																																																																																																																																																																																																												
2ND MORTGAGE 0			2013	52,200	122,180	10,000	164,380																																																																																																																																																																																																												
Zone/Land Use 1 New Sharon all			2014	52,200	122,180	10,000	164,380																																																																																																																																																																																																												
Secondary Zone			2015	52,200	122,180	10,000	164,380																																																																																																																																																																																																												
Topography			2016	52,200	122,180	15,000	159,380																																																																																																																																																																																																												
1.Level 4.Below St 7.LevelBog			2017	52,200	122,180	20,000	154,380																																																																																																																																																																																																												
2.Rolling 5.Low 8.			2018	52,200	122,180	20,000	154,380																																																																																																																																																																																																												
3.Above St 6.Swampy 9.			2019	52,200	122,180	20,000	154,380																																																																																																																																																																																																												
Utilities			2020	52,200	122,180	25,000	149,380																																																																																																																																																																																																												
1.Public 4.Dr Well 7.Cesspool			2021	52,200	122,180	25,000	149,380																																																																																																																																																																																																												
2.Water 5.Dug Well 8.			2022	52,200	122,180	22,250	152,130																																																																																																																																																																																																												
3.Sewer 6.Septic 9.Non			2024	71,900	225,200	25,000	272,100																																																																																																																																																																																																												
Street																																																																																																																																																																																																																			
1.Paved 4.Proposed			<table border="1"> <thead> <tr> <th colspan="4">Land Data</th> </tr> <tr> <th rowspan="2">Front Foot</th> <th rowspan="2">Type</th> <th colspan="2">Effective</th> <th colspan="2">Influence</th> <th rowspan="2">Influence Codes</th> </tr> <tr> <th>Frontage</th> <th>Depth</th> <th>Factor</th> <th>Code</th> </tr> </thead> <tbody> <tr> <td>11.Com-Site</td> <td></td> <td></td> <td></td> <td>%</td> <td></td> <td>1.Unimproved</td> </tr> <tr> <td>12.Ind-Site</td> <td></td> <td></td> <td></td> <td>%</td> <td></td> <td>2.Excess Frtg</td> </tr> <tr> <td>13.Res-Site PR</td> <td></td> <td></td> <td></td> <td>%</td> <td></td> <td>3.Topography</td> </tr> <tr> <td>14.Res-Site DR</td> <td></td> <td></td> <td></td> <td>%</td> <td></td> <td>4.Size/Shape</td> </tr> <tr> <td>15.Res-Site RMT</td> <td></td> <td></td> <td></td> <td>%</td> <td></td> <td>5.Access</td> </tr> <tr> <td></td> <td></td> <td></td> <td></td> <td>%</td> <td></td> <td>6.Restriction</td> </tr> <tr> <td></td> <td></td> <td></td> <td></td> <td>%</td> <td></td> <td>7.Open Space</td> </tr> <tr> <td></td> <td></td> <td></td> <td></td> <td>%</td> <td></td> <td>8.View/Environ</td> </tr> <tr> <td></td> <td></td> <td></td> <td></td> <td>%</td> <td></td> <td>9.Fract Share</td> </tr> <tr> <td></td> <td></td> <td></td> <td></td> <td>%</td> <td></td> <td>Acres</td> </tr> <tr> <td></td> <td></td> <td></td> <td></td> <td>%</td> <td></td> <td>30.Rear Land >10</td> </tr> <tr> <td></td> <td></td> <td></td> <td></td> <td>%</td> <td></td> <td>31.Tillable</td> </tr> <tr> <td></td> <td></td> <td></td> <td></td> <td>%</td> <td></td> <td>32.Pasture</td> </tr> <tr> <td></td> <td></td> <td></td> <td></td> <td>%</td> <td></td> <td>33.Orchard</td> </tr> <tr> <td></td> <td></td> <td></td> <td></td> <td>%</td> <td></td> <td>34.Softwood F&O</td> </tr> <tr> <td></td> <td></td> <td></td> <td></td> <td>%</td> <td></td> <td>35.Mixed Wood F&O</td> </tr> <tr> <td></td> <td></td> <td></td> <td></td> <td>%</td> <td></td> <td>36.Hardwood F&O</td> </tr> <tr> <td></td> <td></td> <td></td> <td></td> <td>%</td> <td></td> <td>37.Softwood TG</td> </tr> <tr> <td></td> <td></td> <td></td> <td></td> <td>%</td> <td></td> <td>38.Mixed Wood TG</td> </tr> <tr> <td></td> <td></td> <td></td> <td></td> <td>%</td> <td></td> <td>39.Hardwood TG</td> </tr> <tr> <td></td> <td></td> <td></td> <td></td> <td>%</td> <td></td> <td>40.Wasteland</td> </tr> <tr> <td></td> <td></td> <td></td> <td></td> <td>%</td> <td></td> <td>41.Open Space</td> </tr> <tr> <td></td> <td></td> <td></td> <td></td> <td>%</td> <td></td> <td>42.Mobile Home Si</td> </tr> <tr> <td></td> <td></td> <td></td> <td></td> <td>%</td> <td></td> <td>43.Condo Site</td> </tr> <tr> <td></td> <td></td> <td></td> <td></td> <td>%</td> <td></td> <td>44.Lot Improvemen</td> </tr> <tr> <td></td> <td></td> <td></td> <td></td> <td>%</td> <td></td> <td>45.Subdivision Lo</td> </tr> <tr> <td></td> <td></td> <td></td> <td></td> <td>%</td> <td></td> <td>46.Golf Course</td> </tr> </tbody> </table>					Land Data				Front Foot	Type	Effective		Influence		Influence Codes	Frontage	Depth	Factor	Code	11.Com-Site				%		1.Unimproved	12.Ind-Site				%		2.Excess Frtg	13.Res-Site PR				%		3.Topography	14.Res-Site DR				%		4.Size/Shape	15.Res-Site RMT				%		5.Access					%		6.Restriction					%		7.Open Space					%		8.View/Environ					%		9.Fract Share					%		Acres					%		30.Rear Land >10					%		31.Tillable					%		32.Pasture					%		33.Orchard					%		34.Softwood F&O					%		35.Mixed Wood F&O					%		36.Hardwood F&O					%		37.Softwood TG					%		38.Mixed Wood TG					%		39.Hardwood TG					%		40.Wasteland					%		41.Open Space					%		42.Mobile Home Si					%		43.Condo Site					%		44.Lot Improvemen					%		45.Subdivision Lo					%		46.Golf Course
Land Data																																																																																																																																																																																																																			
Front Foot	Type	Effective		Influence		Influence Codes																																																																																																																																																																																																													
		Frontage	Depth	Factor	Code																																																																																																																																																																																																														
11.Com-Site				%		1.Unimproved																																																																																																																																																																																																													
12.Ind-Site				%		2.Excess Frtg																																																																																																																																																																																																													
13.Res-Site PR				%		3.Topography																																																																																																																																																																																																													
14.Res-Site DR				%		4.Size/Shape																																																																																																																																																																																																													
15.Res-Site RMT				%		5.Access																																																																																																																																																																																																													
				%		6.Restriction																																																																																																																																																																																																													
				%		7.Open Space																																																																																																																																																																																																													
				%		8.View/Environ																																																																																																																																																																																																													
				%		9.Fract Share																																																																																																																																																																																																													
				%		Acres																																																																																																																																																																																																													
				%		30.Rear Land >10																																																																																																																																																																																																													
				%		31.Tillable																																																																																																																																																																																																													
				%		32.Pasture																																																																																																																																																																																																													
				%		33.Orchard																																																																																																																																																																																																													
				%		34.Softwood F&O																																																																																																																																																																																																													
				%		35.Mixed Wood F&O																																																																																																																																																																																																													
				%		36.Hardwood F&O																																																																																																																																																																																																													
				%		37.Softwood TG																																																																																																																																																																																																													
				%		38.Mixed Wood TG																																																																																																																																																																																																													
				%		39.Hardwood TG																																																																																																																																																																																																													
				%		40.Wasteland																																																																																																																																																																																																													
				%		41.Open Space																																																																																																																																																																																																													
				%		42.Mobile Home Si																																																																																																																																																																																																													
				%		43.Condo Site																																																																																																																																																																																																													
				%		44.Lot Improvemen																																																																																																																																																																																																													
				%		45.Subdivision Lo																																																																																																																																																																																																													
				%		46.Golf Course																																																																																																																																																																																																													
TG PLAN YEAR 0			Square Foot																																																																																																																																																																																																																
Tif District # 0			Acres/Sites																																																																																																																																																																																																																
Sale Data			Total Acreage 29.00																																																																																																																																																																																																																
Sale Date																																																																																																																																																																																																																			
Price																																																																																																																																																																																																																			
Sale Type																																																																																																																																																																																																																			
1.Land 4.Mobile 7.C/I L&B																																																																																																																																																																																																																			
2.L&B 5.Other 8.																																																																																																																																																																																																																			
3.Bundling 6.C/I Land 9.																																																																																																																																																																																																																			
Financing																																																																																																																																																																																																																			
1.Convent 4.Seller 7.																																																																																																																																																																																																																			
2.FHA/VA 5.Private 8.																																																																																																																																																																																																																			
3.Assumed 6.Cash 9.Unknown																																																																																																																																																																																																																			
Validity																																																																																																																																																																																																																			
1.Valid 4.Split 7.Renovate																																																																																																																																																																																																																			
2.Related 5.Partial 8.Other																																																																																																																																																																																																																			
3.Distress 6.Exempt 9.																																																																																																																																																																																																																			
Verified																																																																																																																																																																																																																			
1.Buyer 4.Agent 7.Family																																																																																																																																																																																																																			
2.Seller 5.Pub Rec 8.Other																																																																																																																																																																																																																			
3.Lender 6.MLS 9.																																																																																																																																																																																																																			

New Sharon

Map Lot 14-31

Account 974

Location 925 Industry Road

Card 1

Of 1

10/16/2024

Building Style 4 Cape Cod	SF Bsmt Living 0	Layout 1 Typical
1.Conv. 5.Garrison 9.Other	Fin Bsmt Grade 0 0	1.Typical 4. 7.
2.Ranch 6.Split 10.Gar/Apt	Secondary Heat 0	2.Inadeq 5. 8.
3.R Ranch 7.Contemp 11.Cottage	Heat Type 100% 1 Hot Water BB	3.Poor 6. 9.
4.Cape 8.Log 12.Dblewid	1.HWBB 5.FWA 9.No Heat	Attic 5 Floor & Stairs
Dwelling Units 1	2.HWCI 6.GravWA 10.Radiant	1.1/4 Fin 4.Full Fin 7.
Other Units 0	3.H Pump 7.Electric 11.	2.1/2 Fin 5.FI/Stair 8.
Stories 4 One & 1/2 Story	4.Steam 8.FI/Wall 12.	3.3/4 Fin 6. 9.None
1.1 4.1.5 7.	Cool Type 0% 9 None	Insulation 1 Full
2.2 5.1.75 8.	1.Refrig 4.W&C Air 7.	1.Full 4.Minimal 7.
3.3 6.2.5 9.	2.Evapor 5. 8.	2.Heavy 5. 8.
Exterior Walls 1 Wood Siding	3.H Pump 6. 9.None	3.Capped 6. 9.None
1.Wood 5.Stucco 9.Other	Kitchen Style 2 Typical	Unfinished % 0%
2.Vin/Al 6.Brick 10.Cement	1.Modern 4.Obsolete 7.	Grade & Factor 3 Average 100%
3.Compos. 7.Stone 11.	2.Typical 5. 8.	1.E Grade 4.B Grade 7.
4.Asbestos 8.Concrete 12.	3.Old Type 6. 9.None	2.D Grade 5.A Grade 8.SC Grade
Roof Surface 7 Standing Seam	Bath(s) Style 2 Typical Bath(s)	3.C Grade 6.AA Grade 9.Same
1.Asphalt 4.Composit 7.SS	1.Modern 4.Obsolete 7.	SQFT (Footprint) 806
2.Slate 5.Wood 8.	2.Typical 5. 8.	Condition 2 Fair
3.Metal 6.Roll Roo 9.	3.Old Type 6. 9.None	1.Poor 4.Avg 7.V G
SF Masonry Trim 0	# Rooms 8	2.Fair 5.Avg+ 8.Exc
Solar Voltaic 0	# Bedrooms 5	3.Avg- 6.Good 9.Same
OPEN-4-CUSTOM 0	# Full Baths 3	Phys. % Good 0%
Year Built 1900	# Half Baths 0	Funct. % Good 100%
Year Remodeled 0	# Addn Fixtures 0	Functional Code 9 None
Foundation 3 Brick &/or Stone	# Fireplaces 0	1.Incomp 4.Delap 7.No Power
1.Concrete 4.Wood 7.	 <p>TRIO Software A Division of Harris Computer Systems</p>	2.O-Built 5.Bsmt 8.None/Grn
2.C Block 5.Slab 8.		3.Damage 6.Common 9.None
3.Br/Stone 6.Piers 9.		Econ. % Good 100%
Basement 4 Full Basement		Economic Code None
1.1/4 Bmt 4.Full Bmt 7.		0.None 3.No Power 7.
2.1/2 Bmt 5.None 8.		1.Location 4.General 8.
3.3/4 Bmt 6. 9.None		2.Encroach 9.None 9.
Bsmt Gar # Cars 0		Entrance Code 5 Quarter Reviewed
Wet Basement 1 Dry Basement		1.Interior 4.Vacant 7.
1.Dry 4. 7.		2.General 5.Estimate 8.
2.Damp 5. 8.	3.Informal 6.Reviewed 9.	
3.Wet 6. 9.	Information Code 0	
	1.Owner 4.Agent 7.	
	2.Relative 5.Estimate 8.	
	3.Tenant 6.Other 9.	

14-31-00

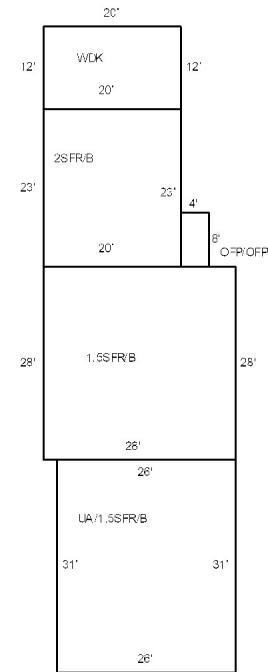

Proposed Value

Date Inspected 5/09/2024

Additions, Outbuildings & Improvements

Type	Year	Units	Grade	Cond	Phys.	Funct.	Sound Value
24 Frame Shed	0	240	4 100	4	0 %	100 %	
24 Frame Shed	0	120	4 100	4	0 %	100 %	
24 Frame Shed	0	540	4 100	4	0 %	100 %	
4 1 & 1/2 Story Fr	0	784	0 0	0	0 %	100 %	
2 Two Story Frame	0	460	0 0	0	0 %	100 %	
27 Unfin Basement	0	1244	0 0	0	0 %	100 %	
68 Wood Deck	0	240	0 0	0	0 %	100 %	
21 Open Frame	0	32	0 0	0	0 %	100 %	
					%	%	
					%	%	

- 1.One Story Fram
- 2.Two Story Fram
- 3.Three Story Fr
- 4.1 & 1/2 Story
- 5.1 & 3/4 Story
- 6.2 & 1/2 Story
- 21.Open Frame Por
- 22.Encl Frame Por
- 23.Frame Garage
- 24.Frame Shed
- 25.Frame Bay Wind
- 26.1SFr Overhang
- 27.Unfin Basement
- 28.Unfinished Att
- 29.Finished Attic

