

Chassie, Wynona Y
WOOLF, KARIANN E
470 INDUSTRY ROAD
NEW SHARON ME 04955

B3191P6 B3997P323 B4074P71 B4581P293

Previous Owner
Chassie, Lynn R.
470 Industry Road

New Sharon ME 04955
Sale Date: 3/29/2019

Previous Owner
Chassie, Robert L.
P.O. Box 143

New Sharon ME 04955
Sale Date: 5/21/2018

Inspection Witnessed By:

X Date

No./Date	Description	Date Insp.

Notes:

2/24 - PM EA, EST IA, EST = AYB, MT VIEW, VINYL SHD = NV

New Sharon

Property Data			Assessment Record				
Neighborhood 5 NBHD 5			Year	Land	Buildings	Exempt	Total
Tree Growth Year 0			2011	27,460	24,330	0	51,790
1ST MORTGAGE 0			2012	27,460	30,310	0	57,770
2ND MORTGAGE 0			2013	27,460	30,310	0	57,770
Zone/Land Use 1 New Sharon all			2014	27,460	30,310	0	57,770
Secondary Zone			2015	27,460	30,310	0	57,770
Topography			2016	27,460	23,310	0	50,770
1.Level 4.Below St 7.LevelBog			2017	27,460	23,310	0	50,770
2.Rolling 5.Low 8.			2018	27,460	23,310	0	50,770
3.Above St 6.Swampy 9.			2019	27,460	23,310	6,000	44,770
Utilities			2020	27,460	23,310	31,000	19,770
1.Public 4.Dr Well 7.Cesspool			2021	27,460	23,310	31,000	19,770
2.Water 5.Dug Well 8.			2022	27,460	23,310	27,590	23,180
3.Sewer 6.Septic 9.Non			2024	40,980	99,340	31,000	109,320
Street							
1.Paved 4.Proposed							
2.Semi Imp 5.R/O/W							
3.Gravel 6. Non							
TG PLAN YEAR 0							
Tif District # 0							
Sale Date 3/29/2019							
Price							
Sale Type							
Land & Buildings							
1.Land 4.Mobile 7.C/I L&B							
2.L&B 5.Other 8.							
3.Bundling 6.C/I Land 9.							
Financing 9 Unknown							
1.Convent 4.Seller 7.							
2.FHA/VA 5.Private 8.							
3.Assumed 6.Cash 9.Unknown							
Validity 2 Related Parties							
1.Valid 4.Split 7.Renovate							
2.Related 5.Partial 8.Other							
3.Distress 6.Exempt 9.							
Verified 5 Public Record							
1.Buyer 4.Agent 7.Family							
2.Seller 5.Pub Rec 8.Other							
3.Lender 6.MLS 9.							

Land Data						
Front Foot	Type	Effective		Influence		Influence Codes
		Frontage	Depth	Factor	Code	
11.Com-Site				%		1.Unimproved
12.Ind-Site				%		2.Excess Frtg
13.Res-Site PR				%		3.Topography
14.Res-Site DR				%		4.Size/Shape
15.Res-Site RMT				%		5.Access
				%		6.Restriction
				%		7.Open Space
				%		8.View/Environ
				%		9.Fract Share
				%		Acres
				%		30.Rear Land >10
				%		31.Tillable
				%		32.Pasture
				%		33.Orchard
				%		34.Softwood F&O
				%		35.Mixed Wood F&O
				%		36.Hardwood F&O
				%		37.Softwood TG
				%		38.Mixed Wood TG
				%		39.Hardwood TG
				%		40.Wasteland
				%		41.Open Space
				%		42.Mobile Home Si
				%		43.Condo Site
				%		44.Lot Improvemen
				%		45.Subdivision Lo
				%		46.Golf Course
Total Acreage				2.23		

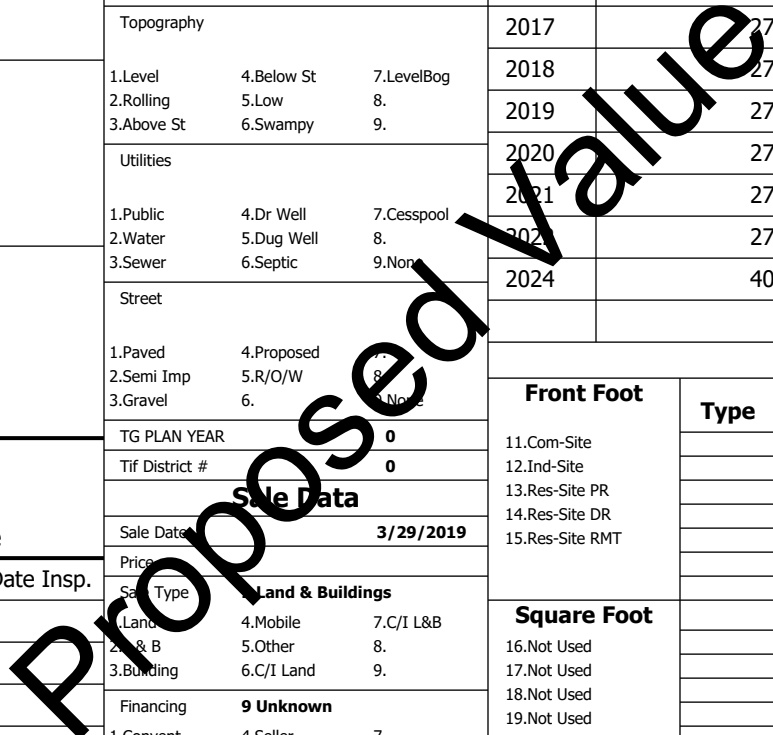

New Sharon

Map Lot 13-24-02

Account 1302

Location 470 Industry Road

Card 1 Of 1 10/16/2024

Building Style	SF Bsmt Living	Layout
1.Conv. 5.Garrison 9.Other	Fin Bsmt Grade	1.Typical 4. 7.
2.Ranch 6.Split 10.Gar/Apt	Secondary Heat	2.Inadeq 5. 8.
3.R Ranch 7.Contemp 11.Cottage	Heat Type 100%	3.Poor 6. 9.
4.Cape 8.Log 12.Dblewid	1.HWBB 5.FWA 9.No Heat	Attic
Dwelling Units	2.HWCI 6.GravWA 10.Radiant	1.1/4 Fin 4.Full Fin 7.
Other Units	3.H Pump 7.Electric 11.	2.1/2 Fin 5.FI/Stair 8.
Stories	4.Steam 8.FI/Wall 12.	3.3/4 Fin 6. 9.None
1.1 4.1.5 7.	Cool Type 0%	Insulation
2.2 5.1.75 8.	1.Refrig 4.W&C Air 7.	1.Full 4.Minimal 7.
3.3 6.2.5 9.	2.Evapor 5. 8.	2.Heavy 5. 8.
Exterior Walls	3.H Pump 6. 9.None	3.Capped 6. 9.None
1.Wood 5.Stucco 9.Other	Kitchen Style	Unfinished %
2.Vin/Al 6.Brick 10.Cement	1.Modern 4.Obsolete 7.	Grade & Factor
3.Compos. 7.Stone 11.	2.Typical 5. 8.	1.E Grade 4.B Grade 7.
4.Asbestos 8.Concrete 12.	3.Old Type 6. 9.None	2.D Grade 5.A Grade 8.SC Grade
Roof Surface	Bath(s) Style	3.C Grade 6.AA Grade 9.Same
1.Asphalt 4.Composit 7.SS	1.Modern 4.Obsolete 7.	SQFT (Footprint)
2.Slate 5.Wood 8.	2.Typical 5. 8.	Condition
3.Metal 6.Roll Roo 9.	3.Old Type 6. 9.None	1.Poor 4.Avg 7.V G
SF Masonry Trim	# Rooms	2.Fair 5.Avg+ 8.Exc
Solar Voltaic	# Bedrooms	3.Avg- 6.Good 9.Same
OPEN-4-CUSTOM	# Full Baths	Phys. % Good
Year Built	# Half Baths	Funct. % Good
Year Remodeled	# Addn Fixtures	Functional Code
Foundation	# Fireplaces	1.Incomp 4.Delap 7.No Power
1.Concrete 4.Wood 7.	 <p>TRIO Software A Division of Harris Computer Systems</p>	2.O-Built 5.Bsmt 8.No Power
2.C Block 5.Slab 8.		3.Damage 6.Common 9.No
3.Br/Stone 6.Piers 9.		Econ. % Good
Basement		Economic Code
1.1/4 Bmt 4.Full Bmt 7.		0.None 3.No Power 7.
2.1/2 Bmt 5.None 8.		1.Location 4.General 8.
3.3/4 Bmt 6. 9.None		2.Encroach 9.None 9.
Bsmt Gar # Cars		Entrance Code 5 Estimate
Wet Basement		1.Interior 4.Vacant 7.
1.Dry 4. 7.		2.Exterior 5.Estimate 8.
2.Damp 5. 8.	3.Informal 6.Reviewed 9.	
3.Wet 6. 9.	Information Code 5 Estimate	
	1.Owner 4.Agent 7.	
	2.Relative 5.Estimate 8.	
	3.Tenant 6.Other 9.	

13-24-02

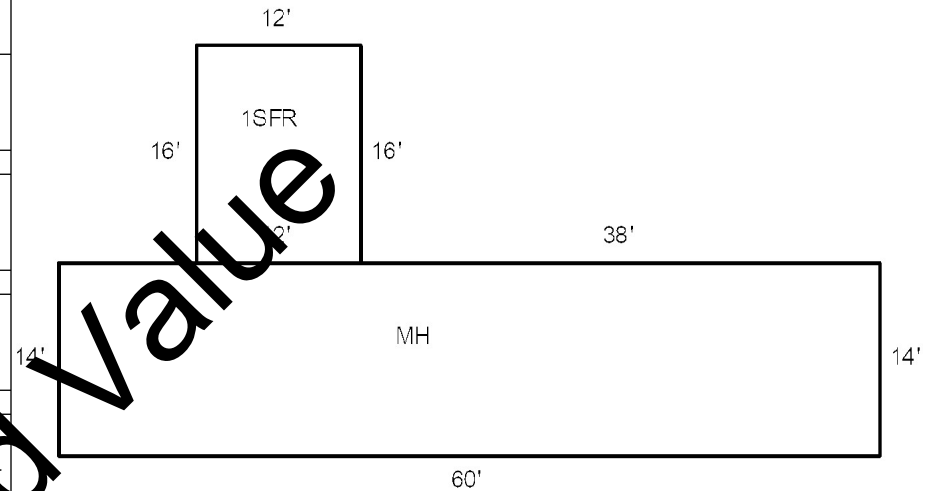

Date Inspected 2/01/2024

Additions, Outbuildings & Improvements

Type	Year	Units	Grade	Cond	Phys.	Funct.	Sound Value
998 14Mobile Home	2000	14x60	3 100	4	0 %	100 %	
1 One Story Frame	2000	192	3 100	4	0 %	100 %	
					%	%	
					%	%	
					%	%	
					%	%	
					%	%	
					%	%	
					%	%	
					%	%	
					%	%	



Proposed Value