

Daggett, Terrance B
Daggett, Amy E
39 MUDDY BROOK RD
NEW SHARON ME 04955

B3185P189

Inspection Witnessed By:

X Date

No./Date	Description	Date Insp.

Notes:
1/24 - PM EA, EST IA, EST ALL DATA = NO TRESPASS

New Sharon

Property Data			Assessment Record																																																																																																																																																																																																																
Neighborhood 5 NBHD 5			Year	Land	Buildings	Exempt	Total																																																																																																																																																																																																												
Tree Growth Year 0			2011	28,160	92,220	0	120,380																																																																																																																																																																																																												
1ST MORTGAGE 0			2012	28,160	91,080	0	119,240																																																																																																																																																																																																												
2ND MORTGAGE 0			2013	28,160	95,870	0	124,030																																																																																																																																																																																																												
Zone/Land Use 1 New Sharon all			2014	28,160	95,870	0	124,030																																																																																																																																																																																																												
Secondary Zone			2015	28,160	95,870	0	124,030																																																																																																																																																																																																												
Topography			2016	28,160	134,860	0	163,020																																																																																																																																																																																																												
1.Level 4.Below St 7.LevelBog			2017	28,200	134,860	20,000	143,060																																																																																																																																																																																																												
2.Rolling 5.Low 8.			2018	28,200	134,860	20,000	143,060																																																																																																																																																																																																												
3.Above St 6.Swampy 9.			2019	28,200	134,860	20,000	143,060																																																																																																																																																																																																												
Utilities			2020	28,200	134,860	25,000	138,060																																																																																																																																																																																																												
1.Public 4.Dr Well 7.Cesspool			2021	28,200	134,860	25,000	138,060																																																																																																																																																																																																												
2.Water 5.Dug Well 8.			2022	28,200	134,860	22,250	140,810																																																																																																																																																																																																												
3.Sewer 6.Septic 9.Non			2024	41,800	269,060	25,000	285,860																																																																																																																																																																																																												
Street																																																																																																																																																																																																																			
1.Paved 4.Proposed			<table border="1"> <thead> <tr> <th colspan="4">Land Data</th> </tr> <tr> <th rowspan="2">Front Foot</th> <th rowspan="2">Type</th> <th colspan="2">Effective</th> <th colspan="2">Influence</th> <th rowspan="2">Influence Codes</th> </tr> <tr> <th>Frontage</th> <th>Depth</th> <th>Factor</th> <th>Code</th> </tr> </thead> <tbody> <tr> <td>11.Com-Site</td> <td></td> <td></td> <td></td> <td>%</td> <td></td> <td>1.Unimproved</td> </tr> <tr> <td>12.Ind-Site</td> <td></td> <td></td> <td></td> <td>%</td> <td></td> <td>2.Excess Frtg</td> </tr> <tr> <td>13.Res-Site PR</td> <td></td> <td></td> <td></td> <td>%</td> <td></td> <td>3.Topography</td> </tr> <tr> <td>14.Res-Site DR</td> <td></td> <td></td> <td></td> <td>%</td> <td></td> <td>4.Size/Shape</td> </tr> <tr> <td>15.Res-Site RMT</td> <td></td> <td></td> <td></td> <td>%</td> <td></td> <td>5.Access</td> </tr> <tr> <td></td> <td></td> <td></td> <td></td> <td>%</td> <td></td> <td>6.Restriction</td> </tr> <tr> <td></td> <td></td> <td></td> <td></td> <td>%</td> <td></td> <td>7.Open Space</td> </tr> <tr> <td></td> <td></td> <td></td> <td></td> <td>%</td> <td></td> <td>8.View/Environ</td> </tr> <tr> <td></td> <td></td> <td></td> <td></td> <td>%</td> <td></td> <td>9.Fract Share</td> </tr> <tr> <td></td> <td></td> <td></td> <td></td> <td>%</td> <td></td> <td>Acres</td> </tr> <tr> <td></td> <td></td> <td></td> <td></td> <td>%</td> <td></td> <td>30.Rear Land >10</td> </tr> <tr> <td></td> <td></td> <td></td> <td></td> <td>%</td> <td></td> <td>31.Tillable</td> </tr> <tr> <td></td> <td></td> <td></td> <td></td> <td>%</td> <td></td> <td>32.Pasture</td> </tr> <tr> <td></td> <td></td> <td></td> <td></td> <td>%</td> <td></td> <td>33.Orchard</td> </tr> <tr> <td></td> <td></td> <td></td> <td></td> <td>%</td> <td></td> <td>34.Softwood F&O</td> </tr> <tr> <td></td> <td></td> <td></td> <td></td> <td>%</td> <td></td> <td>35.Mixed Wood F&O</td> </tr> <tr> <td></td> <td></td> <td></td> <td></td> <td>%</td> <td></td> <td>36.Hardwood F&O</td> </tr> <tr> <td></td> <td></td> <td></td> <td></td> <td>%</td> <td></td> <td>37.Softwood TG</td> </tr> <tr> <td></td> <td></td> <td></td> <td></td> <td>%</td> <td></td> <td>38.Mixed Wood TG</td> </tr> <tr> <td></td> <td></td> <td></td> <td></td> <td>%</td> <td></td> <td>39.Hardwood TG</td> </tr> <tr> <td></td> <td></td> <td></td> <td></td> <td>%</td> <td></td> <td>40.Wasteland</td> </tr> <tr> <td></td> <td></td> <td></td> <td></td> <td>%</td> <td></td> <td>41.Open Space</td> </tr> <tr> <td></td> <td></td> <td></td> <td></td> <td>%</td> <td></td> <td>42.Mobile Home Si</td> </tr> <tr> <td></td> <td></td> <td></td> <td></td> <td>%</td> <td></td> <td>43.Condo Site</td> </tr> <tr> <td></td> <td></td> <td></td> <td></td> <td>%</td> <td></td> <td>44.Lot Improvemen</td> </tr> <tr> <td></td> <td></td> <td></td> <td></td> <td>%</td> <td></td> <td>45.Subdivision Lo</td> </tr> <tr> <td></td> <td></td> <td></td> <td></td> <td>%</td> <td></td> <td>46.Golf Course</td> </tr> </tbody> </table>					Land Data				Front Foot	Type	Effective		Influence		Influence Codes	Frontage	Depth	Factor	Code	11.Com-Site				%		1.Unimproved	12.Ind-Site				%		2.Excess Frtg	13.Res-Site PR				%		3.Topography	14.Res-Site DR				%		4.Size/Shape	15.Res-Site RMT				%		5.Access					%		6.Restriction					%		7.Open Space					%		8.View/Environ					%		9.Fract Share					%		Acres					%		30.Rear Land >10					%		31.Tillable					%		32.Pasture					%		33.Orchard					%		34.Softwood F&O					%		35.Mixed Wood F&O					%		36.Hardwood F&O					%		37.Softwood TG					%		38.Mixed Wood TG					%		39.Hardwood TG					%		40.Wasteland					%		41.Open Space					%		42.Mobile Home Si					%		43.Condo Site					%		44.Lot Improvemen					%		45.Subdivision Lo					%		46.Golf Course
Land Data																																																																																																																																																																																																																			
Front Foot	Type	Effective		Influence		Influence Codes																																																																																																																																																																																																													
		Frontage	Depth	Factor	Code																																																																																																																																																																																																														
11.Com-Site				%		1.Unimproved																																																																																																																																																																																																													
12.Ind-Site				%		2.Excess Frtg																																																																																																																																																																																																													
13.Res-Site PR				%		3.Topography																																																																																																																																																																																																													
14.Res-Site DR				%		4.Size/Shape																																																																																																																																																																																																													
15.Res-Site RMT				%		5.Access																																																																																																																																																																																																													
				%		6.Restriction																																																																																																																																																																																																													
				%		7.Open Space																																																																																																																																																																																																													
				%		8.View/Environ																																																																																																																																																																																																													
				%		9.Fract Share																																																																																																																																																																																																													
				%		Acres																																																																																																																																																																																																													
				%		30.Rear Land >10																																																																																																																																																																																																													
				%		31.Tillable																																																																																																																																																																																																													
				%		32.Pasture																																																																																																																																																																																																													
				%		33.Orchard																																																																																																																																																																																																													
				%		34.Softwood F&O																																																																																																																																																																																																													
				%		35.Mixed Wood F&O																																																																																																																																																																																																													
				%		36.Hardwood F&O																																																																																																																																																																																																													
				%		37.Softwood TG																																																																																																																																																																																																													
				%		38.Mixed Wood TG																																																																																																																																																																																																													
				%		39.Hardwood TG																																																																																																																																																																																																													
				%		40.Wasteland																																																																																																																																																																																																													
				%		41.Open Space																																																																																																																																																																																																													
				%		42.Mobile Home Si																																																																																																																																																																																																													
				%		43.Condo Site																																																																																																																																																																																																													
				%		44.Lot Improvemen																																																																																																																																																																																																													
				%		45.Subdivision Lo																																																																																																																																																																																																													
				%		46.Golf Course																																																																																																																																																																																																													
TG PLAN YEAR 0			Square Foot																																																																																																																																																																																																																
Tif District # 0			16.Not Used																																																																																																																																																																																																																
Sale Data			17.Not Used																																																																																																																																																																																																																
			18.Not Used																																																																																																																																																																																																																
Sale Date			19.Not Used																																																																																																																																																																																																																
Price			20.Residential-Si																																																																																																																																																																																																																
Sale Type			Fract. Acre																																																																																																																																																																																																																
1.Land 4.Mobile 7.C/I L&B			21.Homesite (Frac																																																																																																																																																																																																																
2.L&B 5.Other 8.			22.Baslot (Frac																																																																																																																																																																																																																
3.Bundling 6.C/I Land 9.			23.Misc (Fract)																																																																																																																																																																																																																
Financing			Acres																																																																																																																																																																																																																
1.Convent 4.Seller 7.			24.Homesite																																																																																																																																																																																																																
2.FHA/VA 5.Private 8.			25.Baslot																																																																																																																																																																																																																
3.Assumed 6.Cash 9.Unknown			26.Not Used																																																																																																																																																																																																																
Validity			27.Not Used																																																																																																																																																																																																																
1.Valid 4.Split 7.Renovate			28.Rear Land <5																																																																																																																																																																																																																
2.Related 5.Partial 8.Other			29.Rear Land 5-10																																																																																																																																																																																																																
3.Distress 6.Exempt 9.			Total Acreage 5.20																																																																																																																																																																																																																
Verified																																																																																																																																																																																																																			
1.Buyer 4.Agent 7.Family																																																																																																																																																																																																																			
2.Seller 5.Pub Rec 8.Other																																																																																																																																																																																																																			
3.Lender 6.MLS 9.																																																																																																																																																																																																																			

New Sharon

Map Lot 13-14

Account 927

Location 39 Muddy Brook Road

Card 1 Of 1 10/16/2024

Building Style 4 Cape Cod	SF Bsmt Living 0	Layout 1 Typical
1.Conv. 5.Garrison 9.Other	Fin Bsmt Grade 0 0	1.Typical 4. 7.
2.Ranch 6.Split 10.Gar/Apt	Secondary Heat 0	2.Inadeq 5. 8.
3.R Ranch 7.Contemp 11.Cottage	Heat Type 100% 1 Hot Water BB	3.Poor 6. 9.
4.Cape 8.Log 12.Dblewid	1.HWBB 5.FWA 9.No Heat	Attic 9 None
Dwelling Units 1	2.HWCI 6.GravWA 10.Radiant	1.1/4 Fin 4.Full Fin 7.
Other Units 0	3.H Pump 7.Electric 11.	2.1/2 Fin 5.FI/Stair 8.
Stories 5 One & 3/4 Story	4.Steam 8.FI/Wall 12.	3.3/4 Fin 6. 9.None
1.1 4.1.5 7.	Cool Type 0% 9 None	Insulation 1 Full
2.2 5.1.75 8.	1.Refrig 4.W&C Air 7.	1.Full 4.Minimal 7.
3.3 6.2.5 9.	2.Evapor 5. 8.	2.Heavy 5. 8.
Exterior Walls 2 Vinyl/Aluminum	3.H Pump 6. 9.None	3.Capped 6. 9.None
1.Wood 5.Stucco 9.Other	Kitchen Style 2 Typical	Unfinished % 0%
2.Vin/Al 6.Brick 10.Cement	1.Modern 4.Obsolete 7.	Grade & Factor 3 Average 110%
3.Compos. 7.Stone 11.	2.Typical 5. 8.	1.E Grade 4.B Grade 7.
4.Asbestos 8.Concrete 12.	3.Old Type 6. 9.None	2.D Grade 5.A Grade 8.SC Grade
Roof Surface 1 Asphalt Shingles	Bath(s) Style 2 Typical Bath(s)	3.C Grade 6.AA Grade 9.Same
1.Asphalt 4.Composit 7.SS	1.Modern 4.Obsolete 7.	SQFT (Footprint) 1120
2.Slate 5.Wood 8.	2.Typical 5. 8.	Condition 6 Good
3.Metal 6.Roll Roo 9.	3.Old Type 6. 9.None	1.Poor 4.Avg 7.V G
SF Masonry Trim 0	# Rooms 8	2.Fair 5.Avg+ 8.Exc
Solar Voltaic 0	# Bedrooms 4	3.Avg- 6.Good 9.Same
OPEN-4-CUSTOM 0	# Full Baths 2	Phys. % Good 0%
Year Built 1990	# Half Baths 0	Funct. % Good 100%
Year Remodeled 0	# Addn Fixtures 0	Functional Code 9 None
Foundation 1 Concrete	# Fireplaces 0	1.Incomp 4.Delap 7.No Power
1.Concrete 4.Wood 7.	 <p>TRIO Software A Division of Harris Computer Systems</p>	2.O-Built 5.Bsmt 8.None/Grn
2.C Block 5.Slab 8.		3.Damage 6.Common 9.No
3.Br/Stone 6.Piers 9.		Econ. % Good 100%
Basement 4 Full Basement		Economic Code None
1.1/4 Bmt 4.Full Bmt 7.		0.None 3.No Power 7.
2.1/2 Bmt 5.None 8.		1.Location 4.General 8.
3.3/4 Bmt 6. 9.None		2.Encroach 9.None 9.
Bsmt Gar # Cars 0		Entrance Code 5 Quarter Reviewed
Wet Basement 1 Dry Basement		1.Interior 4.Vacant 7.
1.Dry 4. 7.		2.Exterior 5.Estimate 8.
2.Damp 5. 8.	3.Informal 9.Reviewed 9.	
3.Wet 6. 9.	Information Code 0	
	1.Owner 4.Agent 7.	
	2.Relative 5.Estimate 8.	
	3.Tenant 6.Other 9.	

13-14-00

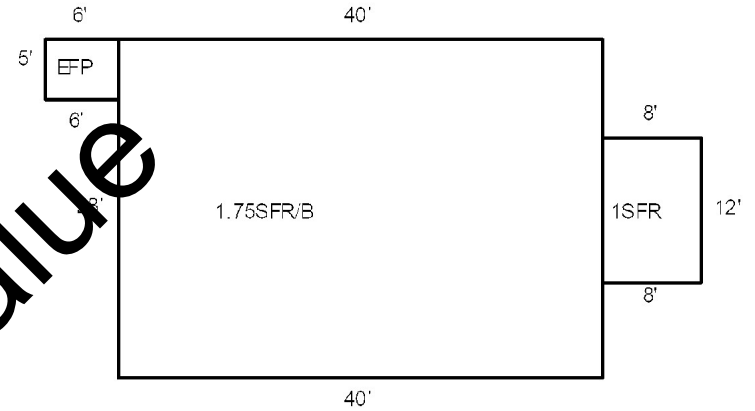

Date Inspected 1/30/2024

Additions, Outbuildings & Improvements

Type	Year	Units	Grade	Cond	Phys.	Funct.	Sound Value
21 Open Frame	0	120	3 100	4	0 %	100 %	
23 Frame Garage	0	320	3 100	4	0 %	100 %	
62 Patio	0	483	3 100	4	0 %	100 %	
1 One Story Frame	0	96	0 0	0	0 %	100 %	
22 Encl Frame Porch	0	30	0 0	0	0 %	100 %	
					%	%	
					%	%	
					%	%	
					%	%	
					%	%	
					%	%	

