

Pinkham, Daniel  
Watson, Mistee  
84 SWAN ROAD  
NEW SHARON ME 04955  
  
B3708P169 B3950P118

Property Data			Assessment Record				
Neighborhood <b>5 NBHD 5</b>			Year	Land	Buildings	Exempt	Total
Tree Growth Year <b>0</b>			2011	20,000	11,360	0	31,360
1ST MORTGAGE <b>0</b>			2012	20,000	11,360	0	31,360
2ND MORTGAGE <b>0</b>			2013	20,000	11,360	0	31,360
Zone/Land Use <b>1 New Sharon all</b>			2014	20,000	11,360	0	31,360
Secondary Zone			2015	20,000	11,360	0	31,360
Topography			2016	20,000	11,360	0	31,360
1.Level 4.Below St 7.LevelBog			2017	20,000	11,360	0	31,360
2.Rolling 5.Low 8.			2018	20,000	11,360	0	31,360
3.Above St 6.Swampy 9.			2019	20,000	11,360	0	31,360
Utilities			2020	20,000	11,360	25,000	6,360
1.Public 4.Dr Well 7.Cesspool			2021	20,000	11,360	25,000	6,360
2.Water 5.Dug Well 8.			2022	20,000	11,360	22,250	9,110
3.Sewer 6.Septic 9.Non			2024	31,600	66,270	25,000	72,870
Street							
1.Paved 4.Proposed							
2.Semi Imp 5.R/O/W							
3.Gravel 6. Non							

Inspection Witnessed By:

X Date

No./Date	Description	Date Insp.

Notes:

Applied for Homestead for 2019 Abatement 11/19/19  
1/24 - LD CALLBACK EA, EST IA, EST ALL DATA = NT  
7/24 - LD EF, IF, LAMINATE FLRS, PINE BOARD WALLS, DNP  
SHD1=LQ, NO POWER OR WATER IN STO BUT SET UP FOR  
PLUMP+ELECT, TMP CRPT=NV

New Sharon

Sale Data		
TG PLAN YEAR	<b>0</b>	
Tif District #	<b>0</b>	
Sale Date	<b>10/17/2017</b>	
Price		
Land & Buildings		
1.Land	4.Mobile	7.C/I L&B
2.L&B	5.Other	8.
3.Bundling	6.C/I Land	9.
Financing		
1.Convent	4.Seller	7.
2.FHA/VA	5.Private	8.
3.Assumed	6.Cash	9.Unknown
Validity		
1.Valid	4.Split	7.Renovate
2.Related	5.Partial	8.Other
3.Distress	6.Exempt	9.
Verified <b>5 Public Record</b>		
1.Buyer	4.Agent	7.Family
2.Seller	5.Pub Rec	8.Other
3.Lender	6.MLS	9.

Land Data						
Front Foot	Type	Effective		Influence		Influence Codes
		Frontage	Depth	Factor	Code	
11.Com-Site				%		1.Unimproved
12.Ind-Site				%		2.Excess Frtg
13.Res-Site PR				%		3.Topography
14.Res-Site DR				%		4.Size/Shape
15.Res-Site RMT				%		5.Access
				%		6.Restriction
				%		7.Open Space
				%		8.View/Environ
				%		9.Fract Share
Square Foot		Square Feet				<b>Acres</b>
16.Not Used				%		30.Rear Land >10
17.Not Used				%		31.Tillable
18.Not Used				%		32.Pasture
19.Not Used				%		33.Orchard
20.Residential-Si				%		34.Software F&O
				%		35.Mixed Wood F&O
				%		36.Hardwood F&O
				%		37.Software TG
				%		38.Mixed Wood TG
				%		39.Hardwood TG
				%		40.Wasteland
				%		41.Open Space
				%		42.Mobile Home Si
				%		43.Condo Site
				%		44.Lot Improvemen
				%		45.Subdivision Lo
				%		46.Golf Course
<b>Total Acreage</b>		<b>1.00</b>				

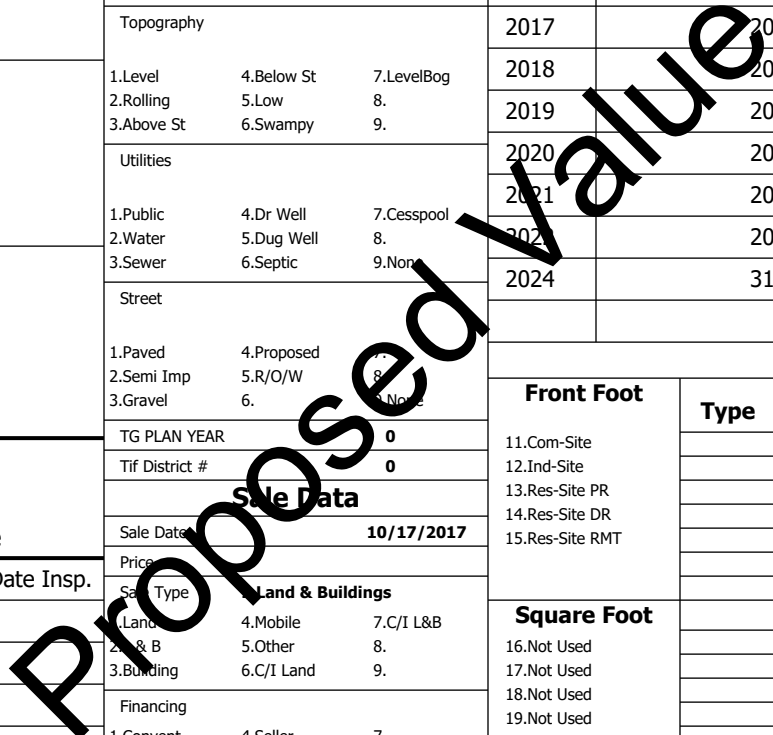

**New Sharon**

Map Lot 11-97

Account 1004

Location 84 Swan Road

Card 1 Of 1 10/16/2024

Building Style <b>0</b>	SF Bsmt Living <b>0</b>	Layout <b>0</b>
1.Conv. 5.Garrison 9.Other	Fin Bsmt Grade <b>0 0</b>	1.Typical 4. 7.
2.Ranch 6.Split 10.Gar/Apt	Secondary Heat <b>0</b>	2.Inadeq 5. 8.
3.R Ranch 7.Contemp 11.Cottage	Heat Type <b>100% 0</b>	3.Poor 6. 9.
4.Cape 8.Log 12.Dblewid	1.HWBB 5.FWA 9.No Heat	Attic <b>0</b>
Dwelling Units <b>0</b>	2.HWCI 6.GravWA 10.Radiant	1.1/4 Fin 4.Full Fin 7.
Other Units <b>0</b>	3.H Pump 7.Electric 11.	2.1/2 Fin 5.FI/Stair 8.
Stories <b>0</b>	4.Steam 8.FI/Wall 12.	3.3/4 Fin 6. 9.None
1.1 4.1.5 7.	Cool Type <b>0% 9 None</b>	Insulation <b>0</b>
2.2 5.1.75 8.	1.Refrig 4.W&C Air 7.	1.Full 4.Minimal 7.
3.3 6.2.5 9.	2.Evapor 5. 8.	2.Heavy 5. 8.
Exterior Walls <b>0</b>	3.H Pump 6. 9.None	3.Capped 6. 9.None
1.Wood 5.Stucco 9.Other	Kitchen Style <b>0</b>	Unfinished % <b>0%</b>
2.Vin/Al 6.Brick 10.Cement	1.Modern 4.Obsolete 7.	Grade & Factor <b>0 0%</b>
3.Compos. 7.Stone 11.	2.Typical 5. 8.	1.E Grade 4.B Grade 7.
4.Asbestos 8.Concrete 12.	3.Old Type 6. 9.None	2.D Grade 5.AA Grade 8.SC Grade
Roof Surface <b>0</b>	Bath(s) Style <b>0</b>	3.C Grade 6.AA Grade 9.Same
1.Asphalt 4.Composit 7.SS	1.Modern 4.Obsolete 7.	SQFT (Footprint) <b>0</b>
2.Slate 5.Wood 8.	2.Typical 5. 8.	Condition <b>0</b>
3.Metal 6.Roll Roo 9.	3.Old Type 6. 9.None	1.Poor 4.Avg 7.V G
SF Masonry Trim <b>0</b>	# Rooms <b>0</b>	2.Fair 5.Avg+ 8.Exc
Solar Voltaic <b>0</b>	# Bedrooms <b>0</b>	3.Avg- 6.Good 9.Same
OPEN-4-CUSTOM <b>0</b>	# Full Baths <b>0</b>	Phys. % Good <b>0%</b>
Year Built <b>0</b>	# Half Baths <b>0</b>	Funct. % Good <b>100%</b>
Year Remodeled <b>0</b>	# Addn Fixtures <b>0</b>	Functional Code <b>9 None</b>
Foundation <b>0</b>	# Fireplaces <b>0</b>	1.Incomp 4.Delap 7.No Power
1.Concrete 4.Wood 7.		2.O-Built 5.Bsmt 8.No Power
2.C Block 5.Slab 8.		3.Damage 6.Common 9.No Power
3.Br/Stone 6.Piers 9.		Econ. % Good <b>100%</b>
Basement <b>0</b>		Economic Code <b>None</b>
1.1/4 Bmt 4.Full Bmt 7.		0.None 3.No Power 7.
2.1/2 Bmt 5.None 8.		1.Location 4.General 8.
3.3/4 Bmt 6. 9.None		2.Encroach 9.None 9.
Bsmt Gar # Cars <b>0</b>		Entrance Code <b>1 Interior Inspect</b>
Wet Basement <b>0</b>		1.Interior 4.Vacant 7.
1.Dry 4. 7.		2.General 5.Estimate 8.
2.Damp 5. 8.		3.Informal 6.Reviewed 9.
3.Wet 6. 9.		Information Code <b>1 Owner</b>
		1.Owner 4.Agent 7.
		2.Relative 5.Estimate 8.
		3.Tenant 6.Other 9.



11-97-00

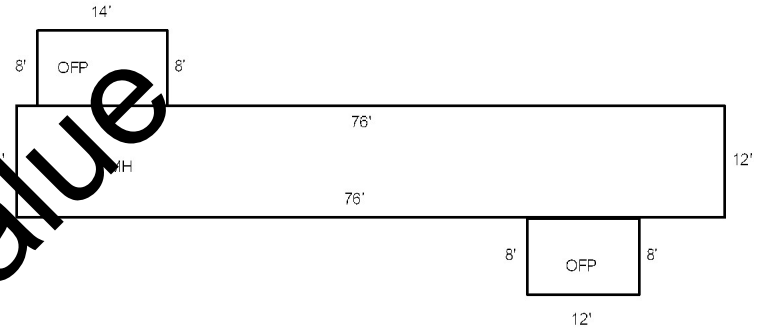

Date Inspected 7/18/2024

**Additions, Outbuildings & Improvements**

Type	Year	Units	Grade	Cond	Phys.	Funct.	Sound Value
997 12Mobile Home	1980	12x76	2 100	4	0 %	100 %	
21 Open Frame	0	208	3 100	3	0 %	100 %	
77 Cabin	1980	416	4 100	3	0 %	100 %	
61 Canopy	1980	192	4 100	3	0 %	100 %	
24 Frame Shed	1980	120	3 100	3	0 %	100 %	
24 Frame Shed	1980	196	2 100	2	0 %	100 %	
24 Frame Shed	1980	64	3 100	2	0 %	100 %	
					%	%	
					%	%	
					%	%	

- 1.One Story Fram
- 2.Two Story Fram
- 3.Three Story Fr
- 4.1 & 1/2 Story
- 5.1 & 3/4 Story
- 6.2 & 1/2 Story
- 21.Open Frame Por
- 22.Encl Frame Por
- 23.Frame Garage
- 24.Frame Shed
- 25.Frame Bay Wind
- 26.1SFr Overhang
- 27.Unfin Basement
- 28.Unfinished Att
- 29.Finished Attic

