

New Sharon

Map Lot 11-95-02

Account 1211

Location 251 Mile Hill Road

Card 1 Of 1 10/16/2024

| | | |
|--|---|---|
| Building Style 12 Dblewide | SF Bsmt Living 0 | Layout 1 Typical |
| 1.Conv. 5.Garrison 9.Other | Fin Bsmt Grade 0 0 | 1.Typical 4. 7. |
| 2.Ranch 6.Split 10.Gar/Apt | Secondary Heat 0 | 2.Inadeq 5. 8. |
| 3.R Ranch 7.Contemp 11.Cottage | Heat Type 100% 5 Forced Warm Air | 3.Poor 6. 9. |
| 4.Cape 8.Log 12.Dblewid | 1.HWBB 5.FWA 9.No Heat | Attic 9 None |
| Dwelling Units 1 | 2.HWCI 6.GravWA 10.Radiant | 1.1/4 Fin 4.Full Fin 7. |
| Other Units 0 | 3.H Pump 7.Electric 11. | 2.1/2 Fin 5.FI/Stair 8. |
| Stories 1 One Story | 4.Steam 8.FI/Wall 12. | 3.3/4 Fin 6. 9.None |
| 1.1 4.1.5 7. | Cool Type 0% 9 None | Insulation 1 Full |
| 2.2 5.1.75 8. | 1.Refrig 4.W&C Air 7. | 1.Full 4.Minimal 7. |
| 3.3 6.2.5 9. | 2.Evapor 5. 8. | 2.Heavy 5. 8. |
| Exterior Walls 2 Vinyl/Aluminum | 3.H Pump 6. 9.None | 3.Capped 6. 9.None |
| 1.Wood 5.Stucco 9.Other | Kitchen Style 2 Typical | Unfinished % 0% |
| 2.Vin/Al 6.Brick 10.Cement | 1.Modern 4.Obsolete 7. | Grade & Factor 3 Average 100% |
| 3.Compos. 7.Stone 11. | 2.Typical 5. 8. | 1.E Grade 4.B Grade 7. |
| 4.Asbestos 8.Concrete 12. | 3.Old Type 6. 9.None | 2.D Grade 5.A Grade 8.SC Grade |
| Roof Surface 1 Asphalt Shingles | Bath(s) Style 2 Typical Bath(s) | 3.C Grade 6.AA Grade 9.Same |
| 1.Asphalt 4.Composit 7.SS | 1.Modern 4.Obsolete 7. | SQFT (Footprint) 1352 |
| 2.Slate 5.Wood 8. | 2.Typical 5. 8. | Condition 4 Average |
| 3.Metal 6.Roll Roo 9. | 3.Old Type 6. 9.None | 1.Poor 4.Avg 7.V G |
| SF Masonry Trim 0 | # Rooms 5 | 2.Fair 5.Avg+ 8.Exc |
| Solar Voltaic 0 | # Bedrooms 3 | 3.Avg- 6.Good 9.Same |
| OPEN-4-CUSTOM 0 | # Full Baths 2 | Phys. % Good 0% |
| Year Built 2006 | # Half Baths 1 | Funct. % Good 100% |
| Year Remodeled 0 | # Addn Fixtures 2 | Functional Code 9 None |
| Foundation 5 Concrete Slab | # Fireplaces 0 | 1.Incomp 4.Delap 7.No Power |
| 1.Concrete 4.Wood 7. |  <p>TRIO Software A Division of Harris Computer Systems</p> | 2.O-Built 5.Bsmt 8.None/Grn |
| 2.C Block 5.Slab 8. | | 3.Damage 6.Common 9.No |
| 3.Br/Stone 6.Piers 9. | | Econ. % Good 100% |
| Basement 9 No Basement | | Economic Code None |
| 1.1/4 Bmt 4.Full Bmt 7. | | 0.None 3.No Power 7. |
| 2.1/2 Bmt 5.None 8. | | 1.Location 4.General 8. |
| 3.3/4 Bmt 6. 9.None | | 2.Encroach 9.None 9. |
| Bsmt Gar # Cars 0 | | Entrance Code 1 Interior Inspect |
| Wet Basement 0 | | 1.Interior 4.Vacant 7. |
| 1.Dry 4. 7. | | 2.Exterior 5.Estimate 8. |
| 2.Damp 5. 8. | 3.Inform 6.Reviewed 9. | |
| 3.Wet 6. 9. | Information Code 1 Owner | |
| | 1.Owner 4.Agent 7. | |
| | 2.Relative 5.Estimate 8. | |
| | 3.Tenant 6.Other 9. | |

11-95-02

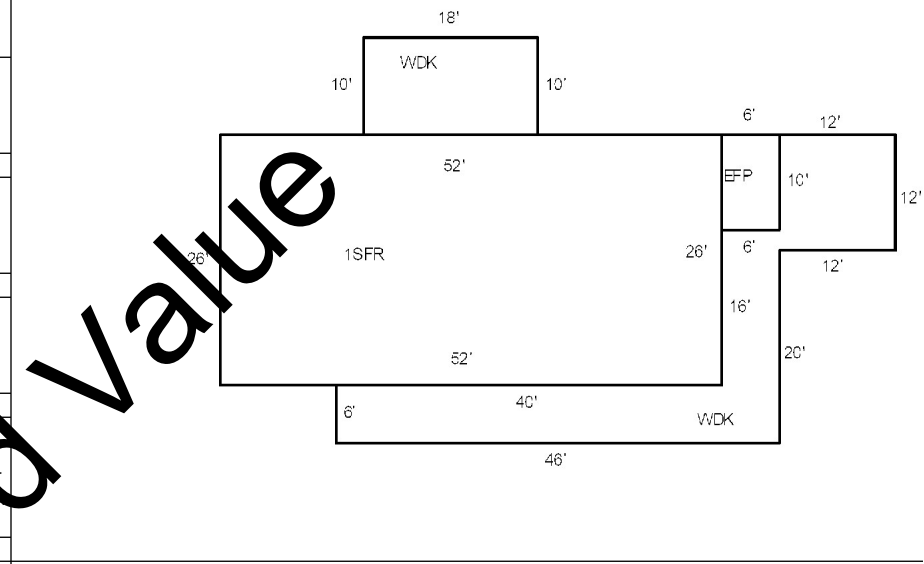

Date Inspected 7/17/2024

Additions, Outbuildings & Improvements

| Type | Year | Units | Grade | Cond | Phys. | Funct. | Sound Value |
|---------------------|------|-------|-------|------|-------|--------|-------------|
| 23 Frame Garage | 2000 | 720 | 3 100 | 3 | 0 % | 100 % | |
| 24 Frame Shed | 2000 | 130 | 3 100 | 3 | 0 % | 100 % | |
| 68 Wood Deck | 0 | 696 | 0 0 | 0 | 0 % | 100 % | |
| 22 Encl Frame Porch | 0 | 60 | 0 0 | 0 | 0 % | 100 % | |
| | | | | | % | % | |
| | | | | | % | % | |
| | | | | | % | % | |
| | | | | | % | % | |
| | | | | | % | % | |
| | | | | | % | % | |
| | | | | | % | % | |
| | | | | | % | % | |

- 1.One Story Fram
- 2.Two Story Fram
- 3.Three Story Fr
- 4.1 & 1/2 Story
- 5.1 & 3/4 Story
- 6.2 & 1/2 Story
- 21.Open Frame Por
- 22.Encl Frame Por
- 23.Frame Garage
- 24.Frame Shed
- 25.Frame Bay Wind
- 26.1SFr Overhang
- 27.Unfin Basement
- 28.Unfinished Att
- 29.Finished Attic