

Winter, Christopher D
205 Kimball Pond Road
New Sharon ME 04955

B1439P353 B4180P63

Previous Owner
Pearson, Robert J
c/oRhonda Ainshe
1007 Summerhaven Road
Augusta 04330
Sale Date: 4/22/2020

Inspection Witnessed By:

X Date

No./Date	Description	Date Insp.

Notes:

2022 Check for house 2021 Trio did not save, Abate and Supp
'24- New Hse w/well & septic missed- Abate & Supplement.
1/24 - GL EA, EST IA, UPSTAIRS INTERIOR UNFINISHED,
LIVING IN BASEMENT, UC EST 70% COMP, CHK 2025

New Sharon

Property Data		
Neighborhood	5 NBHD 5	
Tree Growth Year	0	
1ST MORTGAGE	0	
2ND MORTGAGE	0	
Zone/Land Use	1 New Sharon all	
Secondary Zone		
Topography		
1.Level	4.Below St	7.LevelBog
2.Rolling	5.Low	8.
3.Above St	6.Swampy	9.
Utilities		
1.Public	4.Dr Well	7.Cesspool
2.Water	5.Dug Well	8.
3.Sewer	6.Septic	9.Non
Street		
1.Paved	4.Proposed	7.
2.Semi Imp	5.R/O/W	8.
3.Gravel	6.	9.No
TG PLAN YEAR	0	
Tif District #	0	
Sale Data		
Sale Date	4/22/2020	
Price	57,500	
Sale Type	Land Only	
1.Land	4.Mobile	7.C/I L&B
2.L&B	5.Other	8.
3.Bundling	6.C/I Land	9.
Financing	9 Unknown	
1.Convent	4.Seller	7.
2.FHA/VA	5.Private	8.
3.Assumed	6.Cash	9.Unknown
Validity	1 Arms Length Sale	
1.Valid	4.Split	7.Renovate
2.Related	5.Partial	8.Other
3.Distress	6.Exempt	9.
Verified	5 Public Record	
1.Buyer	4.Agent	7.Family
2.Seller	5.Pub Rec	8.Other
3.Lender	6.MLS	9.

Assessment Record				
Year	Land	Buildings	Exempt	Total
2011	76,500	0	0	76,500
2012	76,500	0	0	76,500
2013	76,500	0	0	76,500
2014	76,500	0	0	76,500
2015	76,500	0	0	76,500
2016	76,500	0	0	76,500
2017	76,500	0	0	76,500
2018	76,500	0	0	76,500
2019	76,500	0	0	76,500
2020	76,500	0	0	76,500
2021	76,500	0	0	76,500
2022	76,500	0	0	76,500
2024	110,600	141,400	0	252,000

Land Data						
Front Foot	Type	Effective		Influence		Influence Codes
		Frontage	Depth	Factor	Code	
11.Com-Site				%		1.Unimproved
12.Ind-Site				%		2.Excess Frtg
13.Res-Site PR				%		3.Topography
14.Res-Site DR				%		4.Size/Shape
15.Res-Site RMT				%		5.Access
				%		6.Restriction
				%		7.Open Space
				%		8.View/Environ
				%		9.Fract Share
Square Foot		Square Feet				Acres
16.Not Used				%		30.Rear Land >10
17.Not Used				%		31.Tillable
18.Not Used				%		32.Pasture
19.Not Used				%		33.Orchard
20.Residential-Si				%		34.Softwood F&O
				%		35.Mixed Wood F&O
				%		36.Hardwood F&O
				%		37.Softwood TG
				%		38.Mixed Wood TG
				%		39.Hardwood TG
				%		40.Wasteland
				%		41.Open Space
				%		42.Mobile Home Si
				%		43.Condo Site
				%		44.Lot Improvemen
				%		45.Subdivision Lo
				%		46.Golf Course
Total Acreage				74.00		

New Sharon

Map Lot 11-64

Account 810

Location 205 KIMBALL POND ROAD

Card 1 Of 1 10/16/2024

Building Style 2 Ranch	SF Bsmt Living 1224	Layout 1 Typical
1.Conv. 5.Garrison 9.Other	Fin Bsmt Grade 3 100	1.Typical 4. 7.
2.Ranch 6.Split 10.Gar/Apt	Secondary Heat 0	2.Inadeq 5. 8.
3.R Ranch 7.Contemp 11.Cottage	Heat Type 100% 1 Hot Water BB	3.Poor 6. 9.
4.Cape 8.Log 12.Dblewid	1.HWBB 5.FWA 9.No Heat	Attic 9 None
Dwelling Units 1	2.HWCI 6.GravWA 10.Radiant	1.1/4 Fin 4.Full Fin 7.
Other Units 0	3.H Pump 7.Electric 11.	2.1/2 Fin 5.FI/Stair 8.
Stories 1 One Story	4.Steam 8.FI/Wall 12.	3.3/4 Fin 6. 9.None
1.1 4.1.5 7.	Cool Type 0% 9 None	Insulation 1 Full
2.2 5.1.75 8.	1.Refrig 4.W&C Air 7.	1.Full 4.Minimal 7.
3.3 6.2.5 9.	2.Evapor 5. 8.	2.Heavy 5. 8.
Exterior Walls 2 Vinyl/Aluminum	3.H Pump 6. 9.None	3.Capped 6. 9.None
1.Wood 5.Stucco 9.Other	Kitchen Style 2 Typical	Unfinished % 30%
2.Vin/Al 6.Brick 10.Cement	1.Modern 4.Obsolete 7.	Grade & Factor 3 Average 100%
3.Compos. 7.Stone 11.	2.Typical 5. 8.	1.E Grade 4.B Grade 7.
4.Asbestos 8.Concrete 12.	3.Old Type 6. 9.None	2.D Grade 5.A Grade 8.SC Grade
Roof Surface 3 Sheet Metal	Bath(s) Style 2 Typical Bath(s)	3.C Grade 6.AA Grade 9.Same
1.Asphalt 4.Composit 7.SS	1.Modern 4.Obsolete 7.	SQFT (Footprint) 1224
2.Slate 5.Wood 8.	2.Typical 5. 8.	Condition 4 Average
3.Metal 6.Roll Roo 9.	3.Old Type 6. 9.None	1.Poor 4.Avg 7.V G
SF Masonry Trim 0	# Rooms 6	2.Fair 5.Avg+ 8.Exc
Solar Voltaic 0	# Bedrooms 3	3.Avg- 6.Good 9.Same
OPEN-4-CUSTOM 0	# Full Baths 2	Phys. % Good 0%
Year Built 2023	# Half Baths 0	Funct. % Good 70%
Year Remodeled 0	# Addn Fixtures 0	Functional Code 1 Incomplete
Foundation 1 Concrete	# Fireplaces 0	1.Incomp 4.Delap 7.No Power
1.Concrete 4.Wood 7.		2.O-Built 5.Bsmt 8.No Part
2.C Block 5.Slab 8.		3.Damage 6.Common 9.No
3.Br/Stone 6.Piers 9.		Econ. % Good 100%
Basement 4 Full Basement		Economic Code None
1.1/4 Bmt 4.Full Bmt 7.		0.None 3.No Power 7.
2.1/2 Bmt 5.None 8.		1.Location 4.General 8.
3.3/4 Bmt 6. 9.None		2.Encroach 9.None 9.
Bsmt Gar # Cars 0		Entrance Code 3 Information Only
Wet Basement 1 Dry Basement		1.Interior 4.Vacant 7.
1.Dry 4. 7.		2.General 5.Estimate 8.
2.Damp 5. 8.		3.Information 6.Reviewed 9.
3.Wet 6. 9.		Information Code 1 Owner
		1.Owner 4.Agent 7.
		2.Relative 5.Estimate 8.
		3.Tenant 6.Other 9.



Proposed Value

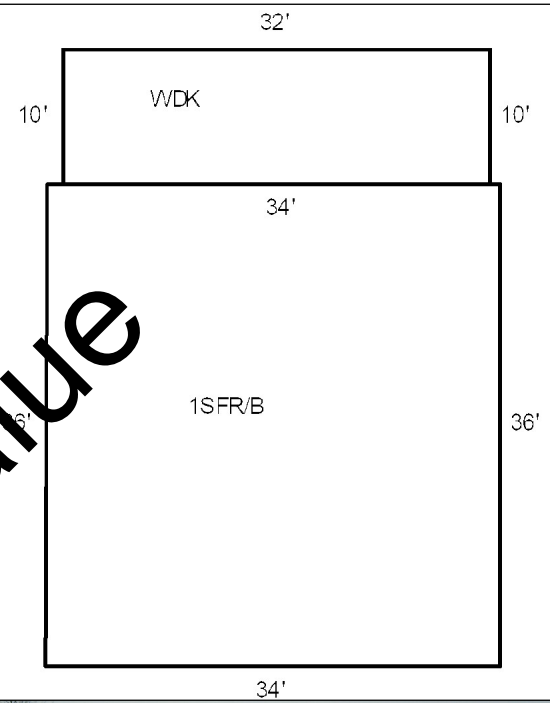

Date Inspected 1/31/2024

Additions, Outbuildings & Improvements

Type	Year	Units	Grade	Cond	Phys.	Funct.	Sound Value
24 Frame Shed	2005	220	2 100	2	0 %	100 %	
24 Frame Shed	2009	104	3 100	3	0 %	100 %	
68 Wood Deck	0	320	0 0	0	0 %	100 %	
					%	%	
					%	%	
					%	%	
					%	%	
					%	%	
					%	%	
					%	%	
					%	%	

- 1.One Story Fram
- 2.Two Story Fram
- 3.Three Story Fr
- 4.1 & 1/2 Story
- 5.1 & 3/4 Story
- 6.2 & 1/2 Story
- 21.Open Frame Por
- 22.Encl Frame Por
- 23.Frame Garage
- 24.Frame Shed
- 25.Frame Bay Wind
- 26.1SFR Overhang
- 27.Unfin Basement
- 28.Unfinished Att
- 29.Finished Attic