

LBowden, Michael A  
Bowden, Nancy L.  
43 Cook Road  
Windham ME 04062

B4522P322

Previous Owner  
Harris, Percy G. (devises of)  
Harris, Nancy M.  
20 Lane Road  
New Sharon ME 04955  
Sale Date: 10/31/2016

Inspection Witnessed By:

X Date

No./Date	Description	Date Insp.

Notes:  
1/24 - LD VACANT

New Sharon

Property Data		
Neighborhood	5 NBHD 5	
Tree Growth Year	0	
1ST MORTGAGE	0	
2ND MORTGAGE	0	
Zone/Land Use	1 New Sharon all	
Secondary Zone		
Topography		
1.Level	4.Below St	7.LevelBog
2.Rolling	5.Low	8.
3.Above St	6.Swampy	9.
Utilities		
1.Public	4.Dr Well	7.Cesspool
2.Water	5.Dug Well	8.
3.Sewer	6.Septic	9.Non
Street		
1.Paved	4.Proposed	7.
2.Semi Imp	5.R/O/W	8.
3.Gravel	6.	9.No
TG PLAN YEAR	0	
Tif District #	0	
Sale Data		
Sale Date	10/31/2016	
Price		
Sale Type	Land Only	
1.Land	4.Mobile	7.C/I L&B
2.L&B	5.Other	8.
3.Bundling	6.C/I Land	9.
Financing		
1.Convent	4.Seller	7.
2.FHA/VA	5.Private	8.
3.Assumed	6.Cash	9.Unknown
Validity		
1.Valid	4.Split	7.Renovate
2.Related	5.Partial	8.Other
3.Distress	6.Exempt	9.
Verified	5 Public Record	
1.Buyer	4.Agent	7.Family
2.Seller	5.Pub Rec	8.Other
3.Lender	6.MLS	9.

Assessment Record				
Year	Land	Buildings	Exempt	Total
2011	16,700	0	0	16,700
2012	16,700	0	0	16,700
2013	16,700	0	0	16,700
2014	16,700	0	0	16,700
2015	16,700	0	0	16,700
2016	16,700	0	0	16,700
2017	16,700	0	0	16,700
2018	16,700	0	0	16,700
2019	16,700	0	0	16,700
2020	16,700	0	0	16,700
2021	16,700	0	0	16,700
2022	16,700	0	0	16,700
2024	31,600	0	0	31,600

Land Data						
Front Foot	Type	Effective		Influence		Influence Codes
		Frontage	Depth	Factor	Code	
11.Com-Site				%		1.Unimproved
12.Ind-Site				%		2.Excess Frtg
13.Res-Site PR				%		3.Topography
14.Res-Site DR				%		4.Size/Shape
15.Res-Site RMT				%		5.Access
				%		6.Restriction
				%		7.Open Space
				%		8.View/Environ
				%		9.Fract Share
Square Foot	Square Feet					Acres
16.Not Used				%		30.Rear Land >10
17.Not Used				%		31.Tillable
18.Not Used				%		32.Pasture
19.Not Used				%		33.Orchard
20.Residential-Si				%		34.Software F&O
				%		35.Mixed Wood F&O
Fract. Acre	Acreage/Sites					36.Hardwood F&O
21.Homesite (Frac	49	1.00	100	%	0	37.Software TG
22.Baselot (Frac				%		38.Mixed Wood TG
23.Misc (Fract)				%		39.Hardwood TG
				%		40.Wasteland
24.Homesite				%		41.Open Space
25.Baselot				%		42.Mobile Home Si
26.Not Used				%		43.Condo Site
27.Not Used				%		44.Lot Improvemen
28.Rear Land <5				%		45.Subdivision Lo
29.Rear Land 5-10				%		46.Golf Course
<b>Total Acreage</b>			1.00			

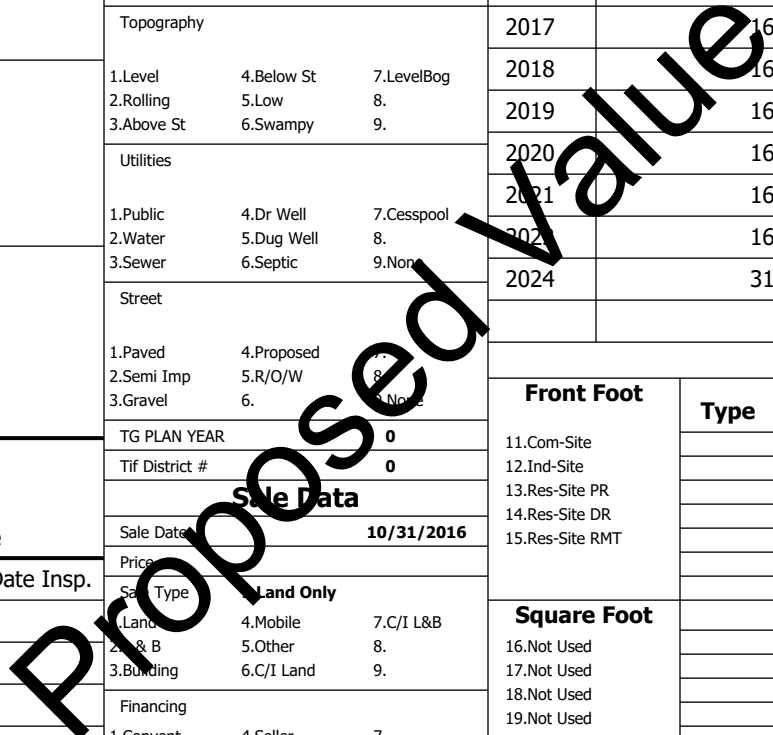

New Sharon

Map Lot 11-108-01

Account 494

Location Lane Road

Card 1 Of 1 10/16/2024

Building Style <b>0</b>	SF Bsmt Living <b>0</b>	Layout <b>0</b>
1.Conv. 5.Garrison 9.Other	Fin Bsmt Grade <b>0 0</b>	1.Typical 4. 7.
2.Ranch 6.Split 10.Gar/Apt	Secondary Heat <b>0</b>	2.Inadeq 5. 8.
3.R Ranch 7.Contemp 11.Cottage	Heat Type <b>100% 0</b>	3.Poor 6. 9.
4.Cape 8.Log 12.Dblewid	1.HWBB 5.FWA 9.No Heat	Attic <b>0</b>
Dwelling Units <b>0</b>	2.HWCI 6.GravWA 10.Radiant	1.1/4 Fin 4.Full Fin 7.
Other Units <b>0</b>	3.H Pump 7.Electric 11.	2.1/2 Fin 5.FI/Stair 8.
Stories <b>0</b>	4.Steam 8.FI/Wall 12.	3.3/4 Fin 6. 9.None
1.1 4.1.5 7.	Cool Type <b>0% 9 None</b>	Insulation <b>0</b>
2.2 5.1.75 8.	1.Refrig 4.W&C Air 7.	1.Full 4.Minimal 7.
3.3 6.2.5 9.	2.Evapor 5. 8.	2.Heavy 5. 8.
Exterior Walls <b>0</b>	3.H Pump 6. 9.None	3.Capped 6. 9.None
1.Wood 5.Stucco 9.Other	Kitchen Style <b>0</b>	Unfinished % <b>0%</b>
2.Vin/Al 6.Brick 10.Cement	1.Modern 4.Obsolete 7.	Grade & Factor <b>0 0%</b>
3.Compos. 7.Stone 11.	2.Typical 5. 8.	1.E Grade 4.B Grade 7.
4.Asbestos 8.Concrete 12.	3.Old Type 6. 9.None	2.D Grade 5.A Grade 8.SC Grade
Roof Surface <b>0</b>	Bath(s) Style <b>0</b>	3.C Grade 6.AA Grade 9.Same
1.Asphalt 4.Composit 7.SS	1.Modern 4.Obsolete 7.	SQFT (Footprint) <b>0</b>
2.Slate 5.Wood 8.	2.Typical 5. 8.	Condition <b>0</b>
3.Metal 6.Roll Roo 9.	3.Old Type 6. 9.None	1.Poor 4.Avg 7.V G
SF Masonry Trim <b>0</b>	# Rooms <b>0</b>	2.Fair 5.Avg+ 8.Exc
Solar Voltaic <b>0</b>	# Bedrooms <b>0</b>	3.Avg- 6.Good 9.Same
OPEN-4-CUSTOM <b>0</b>	# Full Baths <b>0</b>	Phys. % Good <b>0%</b>
Year Built <b>0</b>	# Half Baths <b>0</b>	Funct. % Good <b>100%</b>
Year Remodeled <b>0</b>	# Addn Fixtures <b>0</b>	Functional Code <b>9 None</b>
Foundation <b>0</b>	# Fireplaces <b>0</b>	1.Incomp 4.Delap 7.No Power
1.Concrete 4.Wood 7.		2.O-Built 5.Bsmt 8.No Part
2.C Block 5.Slab 8.		3.Damage 6.Common 9.No
3.Br/Stone 6.Piers 9.		Econ. % Good <b>100%</b>
Basement <b>0</b>		Economic Code <b>None</b>
1.1/4 Bmt 4.Full Bmt 7.		0.None 3.No Power 7.
2.1/2 Bmt 5.None 8.		1.Location 4.General 8.
3.3/4 Bmt 6. 9.None		2.Encroach 9.None 9.
Bsmt Gar # Cars <b>0</b>		Entrance Code <b>4 Unoccupied</b>
Wet Basement <b>0</b>		1.Interior 4.Vacant 7.
1.Dry 4. 7.		2.General 5.Estimate 8.
2.Damp 5. 8.		3.Informal 6.Reviewed 9.
3.Wet 6. 9.		Information Code <b>5 Estimate</b>
		1.Owner 4.Agent 7.
		2.Relative 5.Estimate 8.
		3.Tenant 6.Other 9.



Proposed Value

Date Inspected 1/04/2024

**Additions, Outbuildings & Improvements**

Type	Year	Units	Grade	Cond	Phys.	Funct.	Sound Value
					%	%	1.One Story Fram
					%	%	2.Two Story Fram
					%	%	3.Three Story Fr
					%	%	4.1 & 1/2 Story
					%	%	5.1 & 3/4 Story
					%	%	6.2 & 1/2 Story
					%	%	21.Open Frame Por
					%	%	22.Encl Frame Por
					%	%	23.Frame Garage
					%	%	24.Frame Shed
					%	%	25.Frame Bay Wind
					%	%	26.1SFr Overhang
					%	%	27.Unfin Basement
					%	%	28.Unfinished Att
					%	%	29.Finished Attic