

Rose, Realty Trust  
 Rose, Deborah Trustee  
 95 Lane Road  
 New Sharon ME 04955

B1886P50

Property Data			Assessment Record				
Neighborhood			Year	Land	Buildings	Exempt	Total
Tree Growth Year <b>0</b>			2011	79,100	0	0	79,100
1ST MORTGAGE <b>0</b>			2012	79,100	0	0	79,100
2ND MORTGAGE <b>0</b>			2013	79,100	0	0	79,100
Zone/Land Use <b>1 New Sharon all</b>			2014	79,100	0	0	79,100
Secondary Zone			2015	79,100	0	0	79,100
Topography			2016	79,100	0	0	79,100
1.Level 4.Below St 7.LevelBog			2017	79,100	0	0	79,100
2.Rolling 5.Low 8.			2018	79,100	0	0	79,100
3.Above St 6.Swampy 9.			2019	79,100	0	0	79,100
Utilities			2020	68,920	0	0	68,920
1.Public 4.Dr Well 7.Cesspool			2021	68,920	0	0	68,920
2.Water 5.Dug Well 8.			2022	68,920	0	0	68,920
3.Sewer 6.Septic 9.Non			2024	96,870	0	0	96,870
Street							
1.Paved 4.Proposed							
2.Semi Imp 5.R/O/W							
3.Gravel 6.							

Inspection Witnessed By:

No./Date	Description	Date Insp.
X		

Notes:  
 12.73 ac gifted to Joseph Buzzell (4125/30 09/23/2019) TW  
 1/24 - LD VACANT

New Sharon

Sale Data		
TG PLAN YEAR	<b>0</b>	
Tif District #	<b>0</b>	
Sale Date		
Price		
Sale Type		
1.Land 4.Mobile 7.C/I L&B		
2.L&B 5.Other 8.		
3.Bundleing 6.C/I Land 9.		
Financing		
1.Convent 4.Seller 7.		
2.FHA/VA 5.Private 8.		
3.Assumed 6.Cash 9.Unknown		
Validity		
1.Valid 4.Split 7.Renovate		
2.Related 5.Partial 8.Other		
3.Distress 6.Exempt 9.		
Verified		
1.Buyer 4.Agent 7.Family		
2.Seller 5.Pub Rec 8.Other		
3.Lender 6.MLS 9.		

Land Data						
Front Foot	Type	Effective		Influence		Influence Codes
		Frontage	Depth	Factor	Code	
11.Com-Site				%		1.Unimproved
12.Ind-Site				%		2.Excess Frtg
13.Res-Site PR				%		3.Topography
14.Res-Site DR				%		4.Size/Shape
15.Res-Site RMT				%		5.Access
				%		6.Restriction
				%		7.Open Space
				%		8.View/Environ
				%		9.Fract Share
				%		<b>Acres</b>
				%		30.Rear Land >10
				%		31.Tillable
				%		32.Pasture
				%		33.Orchard
				%		34.Softwood F&O
				%		35.Mixed Wood F&O
				%		36.Hardwood F&O
				%		37.Softwood TG
				%		38.Mixed Wood TG
				%		39.Hardwood TG
				%		40.Wasteland
				%		41.Open Space
				%		42.Mobile Home Si
				%		43.Condo Site
				%		44.Lot Improvemen
				%		45.Subdivision Lo
				%		46.Golf Course
<b>Total Acreage</b>		60.27				

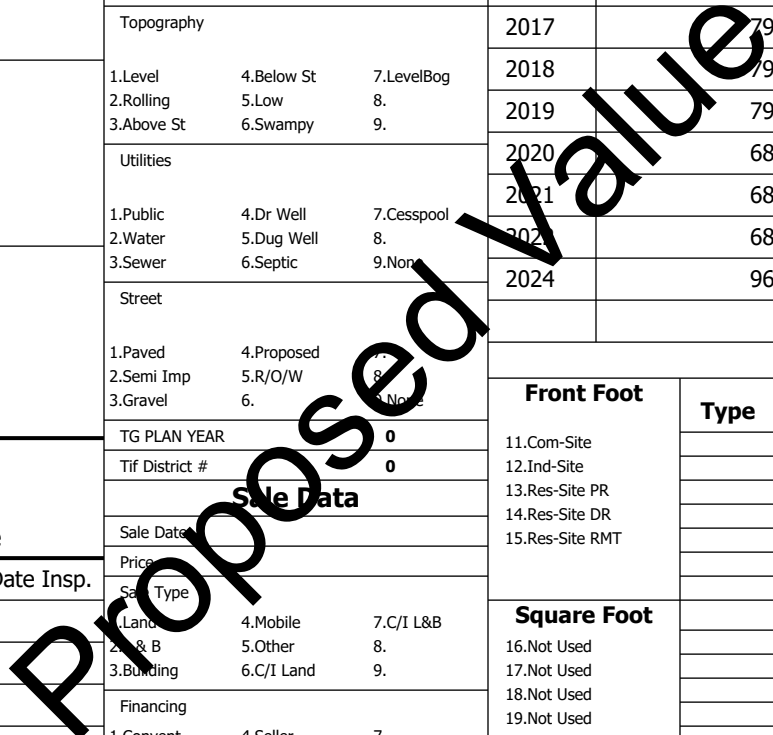

**New Sharon**

Map Lot 11-105-00

Account 916

Location Mercer Road

Card 1 Of 1 10/16/2024

Building Style <b>0</b>	SF Bsmt Living <b>0</b>	Layout <b>0</b>
1.Conv. 5.Garrison 9.Other	Fin Bsmt Grade <b>0 0</b>	1.Typical 4. 7.
2.Ranch 6.Split 10.Gar/Apt	Secondary Heat <b>0</b>	2.Inadeq 5. 8.
3.R Ranch 7.Contemp 11.Cottage	Heat Type <b>100% 0</b>	3.Poor 6. 9.
4.Cape 8.Log 12.Dblewid	1.HWBB 5.FWA 9.No Heat	Attic <b>0</b>
Dwelling Units <b>0</b>	2.HWCI 6.GravWA 10.Radiant	1.1/4 Fin 4.Full Fin 7.
Other Units <b>0</b>	3.H Pump 7.Electric 11.	2.1/2 Fin 5.FI/Stair 8.
Stories <b>0</b>	4.Steam 8.FI/Wall 12.	3.3/4 Fin 6. 9.None
1.1 4.1.5 7.	Cool Type <b>0% 9 None</b>	Insulation <b>0</b>
2.2 5.1.75 8.	1.Refrig 4.W&C Air 7.	1.Full 4.Minimal 7.
3.3 6.2.5 9.	2.Evapor 5. 8.	2.Heavy 5. 8.
Exterior Walls <b>0</b>	3.H Pump 6. 9.None	3.Capped 6. 9.None
1.Wood 5.Stucco 9.Other	Kitchen Style <b>0</b>	Unfinished % <b>0%</b>
2.Vin/Al 6.Brick 10.Cement	1.Modern 4.Obsolete 7.	Grade & Factor <b>0 0%</b>
3.Compos. 7.Stone 11.	2.Typical 5. 8.	1.E Grade 4.B Grade 7.
4.Asbestos 8.Concrete 12.	3.Old Type 6. 9.None	2.D Grade 5.A Grade 8.SC Grade
Roof Surface <b>0</b>	Bath(s) Style <b>0</b>	3.C Grade 6.AA Grade 9.Same
1.Asphalt 4.Composit 7.SS	1.Modern 4.Obsolete 7.	SQFT (Footprint) <b>0</b>
2.Slate 5.Wood 8.	2.Typical 5. 8.	Condition <b>0</b>
3.Metal 6.Roll Roo 9.	3.Old Type 6. 9.None	1.Poor 4.Avg 7.V G
SF Masonry Trim <b>0</b>	# Rooms <b>0</b>	2.Fair 5.Avg+ 8.Exc
Solar Voltaic <b>0</b>	# Bedrooms <b>0</b>	3.Avg- 6.Good 9.Same
OPEN-4-CUSTOM <b>0</b>	# Full Baths <b>0</b>	Phys. % Good <b>0%</b>
Year Built <b>0</b>	# Half Baths <b>0</b>	Funct. % Good <b>100%</b>
Year Remodeled <b>0</b>	# Addn Fixtures <b>0</b>	Functional Code <b>9 None</b>
Foundation <b>0</b>	# Fireplaces <b>0</b>	1.Incomp 4.Delap 7.No Power
1.Concrete 4.Wood 7.		2.O-Built 5.Bsmt 8.No Part
2.C Block 5.Slab 8.		3.Damage 6.Common 9.No
3.Br/Stone 6.Piers 9.		Econ. % Good <b>100%</b>
Basement <b>0</b>		Economic Code <b>None</b>
1.1/4 Bmt 4.Full Bmt 7.		0.None 3.No Power 7.
2.1/2 Bmt 5.None 8.		1.Location 4.General 8.
3.3/4 Bmt 6. 9.None		2.Encroach 9.None 9.
Bsmt Gar # Cars <b>0</b>		Entrance Code <b>4 Unoccupied</b>
Wet Basement <b>0</b>		1.Interior 4.Vacant 7.
1.Dry 4. 7.		2.General 5.Estimate 8.
2.Damp 5. 8.		3.Inform 6.Reviewed 9.
3.Wet 6. 9.		Information Code <b>5 Estimate</b>
		1.Owner 4.Agent 7.
		2.Relative 5.Estimate 8.
		3.Tenant 6.Other 9.



Proposed Value

Date Inspected 1/04/2024

**Additions, Outbuildings & Improvements**

Type	Year	Units	Grade	Cond	Phys.	Funct.	Sound Value
					%	%	1.One Story Fram
					%	%	2.Two Story Fram
					%	%	3.Three Story Fr
					%	%	4.1 & 1/2 Story
					%	%	5.1 & 3/4 Story
					%	%	6.2 & 1/2 Story
					%	%	21.Open Frame Por
					%	%	22.Encl Frame Por
					%	%	23.Frame Garage
					%	%	24.Frame Shed
					%	%	25.Frame Bay Wind
					%	%	26.1SFr Overhang
					%	%	27.Unfin Basement
					%	%	28.Unfinished Att
					%	%	29.Finished Attic