

DOMUCZICZ, ERIC RONALD
DOMUCZICZ, NICOLE E
239 Clearwater Road
New Sharon ME 04955

B4490P342

Previous Owner
Doherty, Timothy J
29 Wood Road

Pelham NH 03076
Sale Date: 9/13/2022

Inspection Witnessed By:

X Date

No./Date	Description	Date Insp.

Notes:

'24- ADJUST LAND ACORDING TO RECENT FORESTRY STAND TYPE MAP 159.74 ACRES TOTAL (156AC. T.G.)
5/24 - AB RUNS ALONG CLEARWATER RD BETWEEN #57 AND BORDER OF INDUSTRY . HEAVILY WOODED, FAIRLY FLAT DIRT ROAD
7/24 - KL SALES REVIEW, 9/2022 SALE UNQUAL/INCL MBLU 8/19

New Sharon

Property Data			Assessment Record				
Neighborhood 5 NBHD 5			Year	Land	Buildings	Exempt	Total
Tree Growth Year 0			2011	34,260	0	0	34,260
1ST MORTGAGE 0			2012	33,480	0	0	33,480
2ND MORTGAGE 0			2013	34,100	0	0	34,100
Zone/Land Use 1 New Sharon all			2014	35,650	0	0	35,650
Secondary Zone			2015	35,650	0	0	35,650
Topography 2 Rolling			2016	35,190	0	0	35,190
1.Level 4.Below St 7.LevelBog			2017	35,190	0	0	35,190
2.Rolling 5.Low 8.			2018	35,190	0	0	35,190
3.Above St 6.Swampy 9.			2019	46,500	0	0	46,500
Utilities			2020	47,120	0	0	47,120
1.Public 4.Dr Well 7.Cesspool			2021	43,400	0	0	43,400
2.Water 5.Dug Well 8.			2022	42,940	0	0	42,940
3.Sewer 6.Septic 9.Non			2024	73,380	0	0	73,380
Street 2 Semi-Improved							
1.Paved 4.Proposed							
2.Semi Imp 5.R/O/W							
3.Gravel 6. Non							
TG PLAN YEAR 0							
Tif District # 0							
Sale Date 9/13/2022							
Price 130,000							
Sale Type Land Only							
1.Land 4.Mobile 7.C/I L&B							
2.L&B 5.Other 8.							
3.Bundling 6.C/I Land 9.							
Financing 9 Unknown							
1.Convent 4.Seller 7.							
2.FHA/VA 5.Private 8.							
3.Assumed 6.Cash 9.Unknown							
Validity 8 Other Non Valid							
1.Valid 4.Split 7.Renovate							
2.Related 5.Partial 8.Other							
3.Distress 6.Exempt 9.							
Verified 5 Public Record							
1.Buyer 4.Agent 7.Family							
2.Seller 5.Pub Rec 8.Other							
3.Lender 6.MLS 9.							

Land Data						
Front Foot	Type	Effective		Influence		Influence Codes
		Frontage	Depth	Factor	Code	
11.Com-Site				%		1.Unimproved
12.Ind-Site				%		2.Excess Frtg
13.Res-Site PR				%		3.Topography
14.Res-Site DR				%		4.Size/Shape
15.Res-Site RMT				%		5.Access
				%		6.Restriction
				%		7.Open Space
				%		8.View/Environ
				%		9.Fract Share
				%		30.Rear Land >10
				%		31.Tillable
				%		32.Pasture
				%		33.Orchard
				%		34.Softwood F&O
				%		35.Mixed Wood F&O
				%		36.Hardwood F&O
				%		37.Softwood TG
				%		38.Mixed Wood TG
				%		39.Hardwood TG
				%		40.Wasteland
				%		41.Open Space
				%		42.Mobile Home Si
				%		43.Condo Site
				%		44.Lot Improvemen
				%		45.Subdivision Lo
				%		46.Golf Course
Square Foot		Square Feet				
16.Not Used				%		
17.Not Used				%		
18.Not Used				%		
19.Not Used				%		
20.Residential-Si				%		
Fract. Acre		Acres/Sites				
21.Homesite (Frac	38	114.00	100	%	0	
22.Basemat (Frac	36	42.00	100	%	0	
23.Misc (Fract)	51	1.00	100	%	0	
Acres						
24.Homesite	29	2.74	100	%	0	
25.Basemat				%		
26.Not Used				%		
27.Not Used				%		
28.Rear Land <5				%		
29.Rear Land 5-10				%		
Total Acreage				159.74		

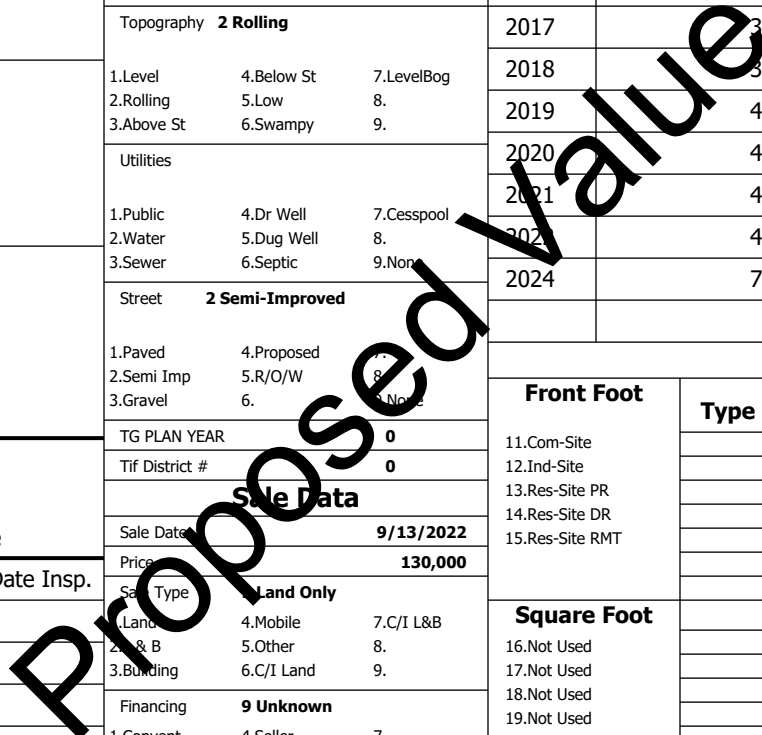

New Sharon

Map Lot 08-15

Account 650

Location 239 Clearwater Road

Card 1 Of 1 10/16/2024

Building Style 0	SF Bsmt Living 0	Layout 0
1.Conv. 5.Garrison 9.Other	Fin Bsmt Grade 0 0	1.Typical 4. 7.
2.Ranch 6.Split 10.Gar/Apt	Secondary Heat 0	2.Inadeq 5. 8.
3.R Ranch 7.Contemp 11.Cottage	Heat Type 100% 0	3.Poor 6. 9.
4.Cape 8.Log 12.Dblewid	1.HWBB 5.FWA 9.No Heat	Attic 0
Dwelling Units 0	2.HWCI 6.GravWA 10.Radiant	1.1/4 Fin 4.Full Fin 7.
Other Units 0	3.H Pump 7.Electric 11.	2.1/2 Fin 5.FI/Stair 8.
Stories 0	4.Steam 8.FI/Wall 12.	3.3/4 Fin 6. 9.None
1.1 4.1.5 7.	Cool Type 0% 9 None	Insulation 0
2.2 5.1.75 8.	1.Refrig 4.W&C Air 7.	1.Full 4.Minimal 7.
3.3 6.2.5 9.	2.Evapor 5. 8.	2.Heavy 5. 8.
Exterior Walls 0	3.H Pump 6. 9.None	3.Capped 6. 9.None
1.Wood 5.Stucco 9.Other	Kitchen Style 0	Unfinished % 0%
2.Vin/Al 6.Brick 10.Cement	1.Modern 4.Obsolete 7.	Grade & Factor 0 0%
3.Compos. 7.Stone 11.	2.Typical 5. 8.	1.E Grade 4.B Grade 7.
4.Asbestos 8.Concrete 12.	3.Old Type 6. 9.None	2.D Grade 5.A Grade 8.SC Grade
Roof Surface 0	Bath(s) Style 0	3.C Grade 6.AA Grade 9.Same
1.Asphalt 4.Composit 7.SS	1.Modern 4.Obsolete 7.	SQFT (Footprint) 0
2.Slate 5.Wood 8.	2.Typical 5. 8.	Condition 0
3.Metal 6.Roll Roo 9.	3.Old Type 6. 9.None	1.Poor 4.Avg 7.V G
SF Masonry Trim 0	# Rooms 0	2.Fair 5.Avg+ 8.Exc
Solar Voltaic 0	# Bedrooms 0	3.Avg- 6.Good 9.Same
OPEN-4-CUSTOM 0	# Full Baths 0	Phys. % Good 0%
Year Built 0	# Half Baths 0	Funct. % Good 100%
Year Remodeled 0	# Addn Fixtures 0	Functional Code 9 None
Foundation 0	# Fireplaces 0	1.Incomp 4.Delap 7.No Power
1.Concrete 4.Wood 7.		2.O-Built 5.Bsmt 8.No Part
2.C Block 5.Slab 8.		3.Damage 6.Common 9.No
3.Br/Stone 6.Piers 9.		Econ. % Good 100%
Basement 0		Economic Code None
1.1/4 Bmt 4.Full Bmt 7.		0.None 3.No Power 7.
2.1/2 Bmt 5.None 8.		1.Location 4.General 8.
3.3/4 Bmt 6. 9.None		2.Encroach 9.None 9.
Bsmt Gar # Cars 0		Entrance Code 4 Unoccupied
Wet Basement 0		1.Interior 4.Vacant 7.
1.Dry 4. 7.		2.General 5.Estimate 8.
2.Damp 5. 8.		3.Inform 6.Reviewed 9.
3.Wet 6. 9.		Information Code 5 Estimate
		1.Owner 4.Agent 7.
		2.Relative 5.Estimate 8.
		3.Tenant 6.Other 9.



Proposed Value

Date Inspected 5/07/2024

Additions, Outbuildings & Improvements

Type	Year	Units	Grade	Cond	Phys.	Funct.	Sound Value
					%	%	1.One Story Fram
					%	%	2.Two Story Fram
					%	%	3.Three Story Fr
					%	%	4.1 & 1/2 Story
					%	%	5.1 & 3/4 Story
					%	%	6.2 & 1/2 Story
					%	%	21.Open Frame Por
					%	%	22.Encl Frame Por
					%	%	23.Frame Garage
					%	%	24.Frame Shed
					%	%	25.Frame Bay Wind
					%	%	26.1SFr Overhang
					%	%	27.Unfin Basement
					%	%	28.Unfinished Att
					%	%	29.Finished Attic