

Allen, Jerry E
35 BAILEY HILL RD
NEW SHARON ME 04955

B2659P175

Property Data			Assessment Record				
Neighborhood 5 NBHD 5			Year	Land	Buildings	Exempt	Total
Tree Growth Year 0			2011	27,800	113,810	0	141,610
1ST MORTGAGE 0			2012	27,800	113,810	0	141,610
2ND MORTGAGE 0			2013	27,800	113,810	0	141,610
Zone/Land Use 1 New Sharon all			2014	27,800	113,810	0	141,610
Secondary Zone			2015	27,800	113,810	0	141,610
Topography			2016	27,800	113,810	0	141,610
1.Level 4.Below St 7.LevelBog			2017	27,800	113,810	0	141,610
2.Rolling 5.Low 8.			2018	27,800	113,810	0	141,610
3.Above St 6.Swampy 9.			2019	27,800	113,810	0	141,610
Utilities			2020	27,800	113,810	0	141,610
1.Public 4.Dr Well 7.Cesspool			2021	27,800	113,810	0	141,610
2.Water 5.Dug Well 8.			2022	27,800	113,810	0	141,610
3.Sewer 6.Septic 9.Non			2024	41,400	243,740	0	285,140
Street							
1.Paved 4.Proposed							
2.Semi Imp 5.R/O/W							
3.Gravel 6.							

Inspection Witnessed By:

X	Date	Description	Date Insp.

Notes:

Homestead for 2022
2/24 - LD EST ALL DATA = NT, EA-, EST IA-, TQS/BAS
POSSIBLE NEW ADD = NO SIDING

New Sharon

Sale Data		
TG PLAN YEAR 0		
Tif District # 0		
Sale Date		
Price		
Sale Type		
1.Land 4.Mobile 7.C/I L&B		
2.L&B 5.Other 8.		
3.Bundling 6.C/I Land 9.		
Financing		
1.Convent 4.Seller 7.		
2.FHA/VA 5.Private 8.		
3.Assumed 6.Cash 9.Unknown		
Validity		
1.Valid 4.Split 7.Renovate		
2.Related 5.Partial 8.Other		
3.Distress 6.Exempt 9.		
Verified		
1.Buyer 4.Agent 7.Family		
2.Seller 5.Pub Rec 8.Other		
3.Lender 6.MLS 9.		

Land Data						
Front Foot	Type	Effective		Influence		Influence Codes
		Frontage	Depth	Factor	Code	
11.Com-Site				%		1.Unimproved
12.Ind-Site				%		2.Excess Frtg
13.Res-Site PR				%		3.Topography
14.Res-Site DR				%		4.Size/Shape
15.Res-Site RMT				%		5.Access
				%		6.Restriction
				%		7.Open Space
				%		8.View/Environ
				%		9.Fract Share
Square Foot		Square Feet				Acres
16.Not Used				%		30.Rear Land >10
17.Not Used				%		31.Tillable
18.Not Used				%		32.Pasture
19.Not Used				%		33.Orchard
20.Residential-Si				%		34.Software F&O
				%		35.Mixed Wood F&O
				%		36.Hardwood F&O
13		1.00		100 %	0	37.Software TG
28		1.40		100 %	0	38.Mixed Wood TG
				%		39.Hardwood TG
				%		40.Wasteland
				%		41.Open Space
				%		42.Mobile Home Si
				%		43.Condo Site
				%		44.Lot Improvemen
				%		45.Subdivision Lo
				%		46.Golf Course
Total Acreage		2.40				

New Sharon

Map Lot 07-10

Account 570

Location 35 Bailey Hill Road

Card 1 Of 1 10/16/2024

Building Style 5 Garrison/Colonial	SF Bsmt Living 0	Layout 1 Typical
1.Conv. 5.Garrison 9.Other	Fin Bsmt Grade 0 0	1.Typical 4. 7.
2.Ranch 6.Split 10.Gar/Apt	Secondary Heat 0	2.Inadeq 5. 8.
3.R Ranch 7.Contemp 11.Cottage	Heat Type 100% 1 Hot Water BB	3.Poor 6. 9.
4.Cape 8.Log 12.Dblewid	1.HWBB 5.FWA 9.No Heat	Attic 9 None
Dwelling Units 1	2.HWCI 6.GravWA 10.Radiant	1.1/4 Fin 4.Full Fin 7.
Other Units 0	3.H Pump 7.Electric 11.	2.1/2 Fin 5.FI/Stair 8.
Stories 5 One & 3/4 Story	4.Steam 8.FI/Wall 12.	3.3/4 Fin 6. 9.None
1.1 4.1.5 7.	Cool Type 0% 9 None	Insulation 1 Full
2.2 5.1.75 8.	1.Refrig 4.W&C Air 7.	1.Full 4.Minimal 7.
3.3 6.2.5 9.	2.Evapor 5. 8.	2.Heavy 5. 8.
Exterior Walls 1 Wood Siding	3.H Pump 6. 9.None	3.Capped 6. 9.None
1.Wood 5.Stucco 9.Other	Kitchen Style 2 Typical	Unfinished % 0%
2.Vin/Al 6.Brick 10.Cement	1.Modern 4.Obsolete 7.	Grade & Factor 3 Average 100%
3.Compos. 7.Stone 11.	2.Typical 5. 8.	1.E Grade 4.B Grade 7.
4.Asbestos 8.Concrete 12.	3.Old Type 6. 9.None	2.D Grade 5.A Grade 8.SC Grade
Roof Surface 3 Sheet Metal	Bath(s) Style 2 Typical Bath(s)	3.C Grade 6.AA Grade 9.Same
1.Asphalt 4.Composit 7.SS	1.Modern 4.Obsolete 7.	SQFT (Footprint) 1280
2.Slate 5.Wood 8.	2.Typical 5. 8.	Condition 3 Below Average
3.Metal 6.Roll Roo 9.	3.Old Type 6. 9.None	1.Poor 4.Avg 7.V G
SF Masonry Trim 0	# Rooms 7	2.Fair 5.Avg+ 8.Exc
Solar Voltaic 0	# Bedrooms 3	3.Avg- 6.Good 9.Same
OPEN-4-CUSTOM 0	# Full Baths 2	Phys. % Good 0%
Year Built 1990	# Half Baths 0	Funct. % Good 100%
Year Remodeled 0	# Addn Fixtures 0	Functional Code 9 None
Foundation 1 Concrete	# Fireplaces 0	1.Incomp 4.Delap 7.No Power
1.Concrete 4.Wood 7.	 <p>TRIO Software A Division of Harris Computer Systems</p>	2.O-Built 5.Bsmt 8.No Power
2.C Block 5.Slab 8.		3.Damage 6.Common 9.No Power
3.Br/Stone 6.Piers 9.		Econ. % Good 100%
Basement 4 Full Basement		Economic Code None
1.1/4 Bmt 4.Full Bmt 7.		0.None 3.No Power 7.
2.1/2 Bmt 5.None 8.		1.Location 4.General 8.
3.3/4 Bmt 6. 9.None		2.Encroach 9.None 9.
Bsmt Gar # Cars 0		Entrance Code 5 Quarter Reviewed
Wet Basement 1 Dry Basement		1.Interior 4.Vacant 7.
1.Dry 4. 7.		2.Exterior 5.Estimate 8.
2.Damp 5. 8.	3.Informal 6.Reviewed 9.	
3.Wet 6. 9.	Information Code 0	
	1.Owner 4.Agent 7.	
	2.Relative 5.Estimate 8.	
	3.Tenant 6.Other 9.	

07-10-00

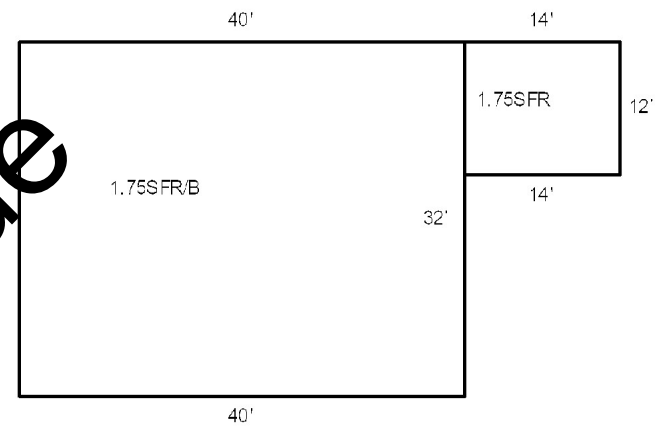

Date Inspected 2/27/2024

Additions, Outbuildings & Improvements

Type	Year	Units	Grade	Cond	Phys.	Funct.	Sound Value
23 Frame Garage	1990	440	3 100	3	0 %	100 %	
24 Frame Shed	1990	192	3 100	3	0 %	100 %	
24 Frame Shed	1990	64	2 100	2	0 %	100 %	
5 1 & 3/4 Story Fr	0	168	0 0	0	0 %	100 %	
					%	%	
					%	%	
					%	%	
					%	%	
					%	%	
					%	%	
					%	%	
					%	%	

- 1.One Story Fram
- 2.Two Story Fram
- 3.Three Story Fr
- 4.1 & 1/2 Story
- 5.1 & 3/4 Story
- 6.2 & 1/2 Story
- 21.Open Frame Por
- 22.Encl Frame Por
- 23.Frame Garage
- 24.Frame Shed
- 25.Frame Bay Wind
- 26.1SFr Overhang
- 27.Unfin Basement
- 28.Unfinished Att
- 29.Finished Attic