

DAGGETT, ROBERT Q JR
14 MUDDY BROOK ROAD
NEW SHARON ME 04955

B4502P27

Previous Owner
Daggett, Debra S
14 MUDDY BROOK RD

NEW SHARON ME 04955
Sale Date: 10/06/2022

Previous Owner
Daggett, Dorothy
14 Muddy Brook Rd.

New Sharon ME 04955
Sale Date: 4/28/2017

Inspection Witnessed By:

X Date

No./Date	Description	Date Insp.

Notes:

1/24 - PM EF, IF, EST = AYB, SHD = NV, KITCHEN UTILIZES WOOD STOVE

New Sharon

Property Data		
Neighborhood	5 NBHD 5	
Tree Growth Year	0	
1ST MORTGAGE	0	
2ND MORTGAGE	0	
Zone/Land Use	1 New Sharon all	
Secondary Zone		
Topography		
1.Level	4.Below St	7.LevelBog
2.Rolling	5.Low	8.
3.Above St	6.Swampy	9.
Utilities		
1.Public	4.Dr Well	7.Cesspool
2.Water	5.Dug Well	8.
3.Sewer	6.Septic	9.Non
Street		
1.Paved	4.Proposed	7.
2.Semi Imp	5.R/O/W	8.
3.Gravel	6.	9.No
TG PLAN YEAR	0	
Tif District #	0	
Sale Data		
Sale Date	10/06/2022	
Price		
Sale Type	Land & Buildings	
1.Land	4.Mobile	7.C/I L&B
2.L&B	5.Other	8.
3.Bundling	6.C/I Land	9.
Financing	9 Unknown	
1.Convent	4.Seller	7.
2.FHA/VA	5.Private	8.
3.Assumed	6.Cash	9.Unknown
Validity	2 Related Parties	
1.Valid	4.Split	7.Renovate
2.Related	5.Partial	8.Other
3.Distress	6.Exempt	9.
Verified	5 Public Record	
1.Buyer	4.Agent	7.Family
2.Seller	5.Pub Rec	8.Other
3.Lender	6.MLS	9.

Assessment Record				
Year	Land	Buildings	Exempt	Total
2011	23,760	60,020	16,000	67,780
2012	23,760	60,020	16,000	67,780
2013	23,760	60,020	16,000	67,780
2014	23,760	60,020	16,000	67,780
2015	23,760	60,020	16,000	67,780
2016	23,760	60,020	21,000	62,780
2017	23,760	60,020	0	83,780
2018	23,760	60,020	20,000	63,780
2019	23,760	60,020	20,000	63,780
2020	23,760	60,020	25,000	58,780
2021	23,760	60,020	25,000	58,780
2022	23,760	60,020	0	83,780
2024	36,300	102,160	25,000	113,460

Land Data						
Front Foot	Type	Effective		Influence		Influence Codes
		Frontage	Depth	Factor	Code	
11.Com-Site				%		1.Unimproved
12.Ind-Site				%		2.Excess Frtg
13.Res-Site PR				%		3.Topography
14.Res-Site DR				%		4.Size/Shape
15.Res-Site RMT				%		5.Access
				%		6.Restriction
				%		7.Open Space
				%		8.View/Environ
				%		9.Fract Share
Square Foot		Square Feet		Acres		30.Rear Land >10
16.Not Used				%		31.Tillable
17.Not Used				%		32.Pasture
18.Not Used				%		33.Orchard
19.Not Used				%		34.Softwood F&O
20.Residential-Si				%		35.Mixed Wood F&O
Fract. Acre	Acreage/Sites					36.Hardwood F&O
21.Homesite (Frac	14	1.00	100	%	0	37.Softwood TG
22.Baselot (Fract	28	1.88	100	%	0	38.Mixed Wood TG
23.Misc (Fract)				%		39.Hardwood TG
Acres				%		40.Wasteland
24.Homesite				%		41.Open Space
25.Baselot				%		42.Mobile Home Si
26.Not Used				%		43.Condo Site
27.Not Used				%		44.Lot Improvemen
28.Rear Land <5	Total Acreage 2.88					45.Subdivision Lo
29.Rear Land 5-10						46.Golf Course

New Sharon

Map Lot 06-39

Account 239

Location 14 Muddy Brook Road

Card 1

Of 1

10/16/2024

Building Style 4 Cape Cod	SF Bsmt Living 0	Layout 1 Typical
1.Conv. 5.Garrison 9.Other	Fin Bsmt Grade 0 0	1.Typical 4. 7.
2.Ranch 6.Split 10.Gar/Apt	Secondary Heat 0	2.Inadeq 5. 8.
3.R Ranch 7.Contemp 11.Cottage	Heat Type 100% 6 Gravity Warm Air	3.Poor 6. 9.
4.Cape 8.Log 12.Dblewid	1.HWBB 5.FWA 9.No Heat	Attic 9 None
Dwelling Units 1	2.HWCI 6.GravWA 10.Radiant	1.1/4 Fin 4.Full Fin 7.
Other Units 0	3.H Pump 7.Electric 11.	2.1/2 Fin 5.FI/Stair 8.
Stories 5 One & 3/4 Story	4.Steam 8.FI/Wall 12.	3.3/4 Fin 6. 9.None
1.1 4.1.5 7.	Cool Type 0% 9 None	Insulation 1 Full
2.2 5.1.75 8.	1.Refrig 4.W&C Air 7.	1.Full 4.Minimal 7.
3.3 6.2.5 9.	2.Evapor 5. 8.	2.Heavy 5. 8.
Exterior Walls 2 Vinyl/Aluminum	3.H Pump 6. 9.None	3.Capped 6. 9.None
1.Wood 5.Stucco 9.Other	Kitchen Style 4 Obsolete	Unfinished % 0%
2.Vin/Al 6.Brick 10.Cement	1.Modern 4.Obsolete 7.	Grade & Factor 3 Average 100%
3.Compos. 7.Stone 11.	2.Typical 5. 8.	1.E Grade 4.B Grade 7.
4.Asbestos 8.Concrete 12.	3.Old Type 6. 9.None	2.D Grade 5.A Grade 8.SC Grade
Roof Surface 3 Sheet Metal	Bath(s) Style 3 Old Style	3.C Grade 6.AA Grade 9.Same
1.Asphalt 4.Composit 7.SS	1.Modern 4.Obsolete 7.	SQFT (Footprint) 475
2.Slate 5.Wood 8.	2.Typical 5. 8.	Condition 2 Fair
3.Metal 6.Roll Roo 9.	3.Old Type 6. 9.None	1.Poor 4.Avg 7.V G
SF Masonry Trim 0	# Rooms 5	2.Fair 5.Avg+ 8.Exc
Solar Voltaic 0	# Bedrooms 2	3.Avg- 6.Good 9.Same
OPEN-4-CUSTOM 0	# Full Baths 1	Phys. % Good 0%
Year Built 1850	# Half Baths 0	Funct. % Good 100%
Year Remodeled 0	# Addn Fixtures 0	Functional Code 9 None
Foundation 2 Concrete Block	# Fireplaces 0	1.Incomp 4.Delap 7.No Power
1.Concrete 4.Wood 7.	 <p>TRIO Software A Division of Harris Computer Systems</p>	2.O-Built 5.Bsmt 8.No Power
2.C Block 5.Slab 8.		3.Damage 6.Common 9.No Power
3.Br/Stone 6.Piers 9.		Econ. % Good 100%
Basement 4 Full Basement		Economic Code None
1.1/4 Bmt 4.Full Bmt 7.		0.None 3.No Power 7.
2.1/2 Bmt 5.None 8.		1.Location 4.General 8.
3.3/4 Bmt 6. 9.None		2.Encroach 9.None 9.
Bsmt Gar # Cars 0		Entrance Code 1 Interior Inspect
Wet Basement 2 Damp Basement		1.Interior 4.Vacant 7.
1.Dry 4. 7.		2.Exterior 5.Estimate 8.
2.Damp 5. 8.	3.Inform 6.Reviewed 9.	
3.Wet 6. 9.	Information Code 1 Owner	
	1.Owner 4.Agent 7.	
	2.Relative 5.Estimate 8.	
	3.Tenant 6.Other 9.	

06-39-00

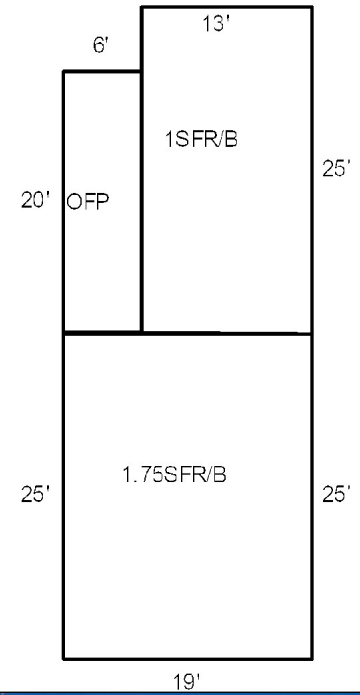

Proposed Value

Date Inspected 1/30/2024

Additions, Outbuildings & Improvements

Type	Year	Units	Grade	Cond	Phys.	Funct.	Sound Value
80 Barn	0	616	3 100	2	0 %	100 %	
1 One Story Frame	0	325	0 0	0	0 %	100 %	
27 Unfin Basement	0	325	0 0	0	0 %	100 %	
21 Open Frame	0	120	0 0	0	0 %	100 %	
					%	%	
					%	%	
					%	%	
					%	%	
					%	%	
					%	%	
					%	%	



- 1.One Story Fram
- 2.Two Story Fram
- 3.Three Story Fr
- 4.1 & 1/2 Story
- 5.1 & 3/4 Story
- 6.2 & 1/2 Story
- 21.Open Frame Por
- 22.Encl Frame Por
- 23.Frame Garage
- 24.Frame Shed
- 25.Frame Bay Wind
- 26.1SFr Overhang
- 27.Unfin Basement
- 28.Unfinished Att
- 29.Finished Attic