

Smiley, Philip T
 Smiley, Janelle
 7580 West Wedington Drive
 Fayetteville AR 72704

B3463P138 B4525P283

Inspection Witnessed By:

X _____ Date _____

No./Date	Description	Date Insp.

Notes:
 1/24 - PM VACANT

New Sharon

Property Data		
Neighborhood	5 NBHD 5	
Tree Growth Year	0	
1ST MORTGAGE	0	
2ND MORTGAGE	0	
Zone/Land Use	1 New Sharon all	
Secondary Zone		
Topography		
1.Level	4.Below St	7.LevelBog
2.Rolling	5.Low	8.
3.Above St	6.Swampy	9.
Utilities		
1.Public	4.Dr Well	7.Cesspool
2.Water	5.Dug Well	8.
3.Sewer	6.Septic	9.Non
Street		
1.Paved	4.Proposed	7.
2.Semi Imp	5.R/O/W	8.
3.Gravel	6.	9.No
TG PLAN YEAR	0	
Tif District #	0	
Sale Data		
Sale Date		
Price		
Sale Type		
1.Land	4.Mobile	7.C/I L&B
2.L & B	5.Other	8.
3.Bundling	6.C/I Land	9.
Financing		
1.Convent	4.Seller	7.
2.FHA/VA	5.Private	8.
3.Assumed	6.Cash	9.Unknown
Validity		
1.Valid	4.Split	7.Renovate
2.Related	5.Partial	8.Other
3.Distress	6.Exempt	9.
Verified		
1.Buyer	4.Agent	7.Family
2.Seller	5.Pub Rec	8.Other
3.Lender	6.MLS	9.

Assessment Record				
Year	Land	Buildings	Exempt	Total
2011	37,000	20,660	16,000	41,660
2012	37,000	20,660	16,000	41,660
2013	37,000	20,660	0	57,660
2014	37,000	20,660	0	57,660
2015	37,000	20,660	0	57,660
2016	37,000	15,890	0	52,890
2017	37,000	15,890	0	52,890
2018	37,000	15,890	0	52,890
2019	37,000	15,890	0	52,890
2020	37,000	15,890	0	52,890
2021	37,000	15,890	0	52,890
2022	37,000	15,890	0	52,890
2024	52,900	9,810	0	62,710

Land Data						
Front Foot	Type	Effective		Influence		Influence Codes
		Frontage	Depth	Factor	Code	
11.Com-Site				%		1.Unimproved
12.Ind-Site				%		2.Excess Frtg
13.Res-Site PR				%		3.Topography
14.Res-Site DR				%		4.Size/Shape
15.Res-Site RMT				%		5.Access
				%		6.Restriction
				%		7.Open Space
				%		8.View/Environ
				%		9.Fract Share
Square Foot	Square Feet					Acres
16.Not Used				%		30.Rear Land >10
17.Not Used				%		31.Tillable
18.Not Used				%		32.Pasture
19.Not Used				%		33.Orchard
20.Residential-Si				%		34.Softwood F&O
				%		35.Mixed Wood F&O
Fract. Acre	Acreage/Sites					36.Hardwood F&O
21.Homesite (Frac	13	1.00	100	%	0	37.Softwood TG
22.Baselot (Fract	28	4.00	100	%	0	38.Mixed Wood TG
23.Misc (Fract)	54	5.00	100	%	0	39.Hardwood TG
				%		40.Wasteland
24.Homesite				%		41.Open Space
25.Baselot				%		42.Mobile Home Si
26.Not Used				%		43.Condo Site
27.Not Used				%		44.Lot Improvemen
28.Rear Land <5						45.Subdivision Lo
29.Rear Land 5-10						46.Golf Course
Total Acreage			10.00			

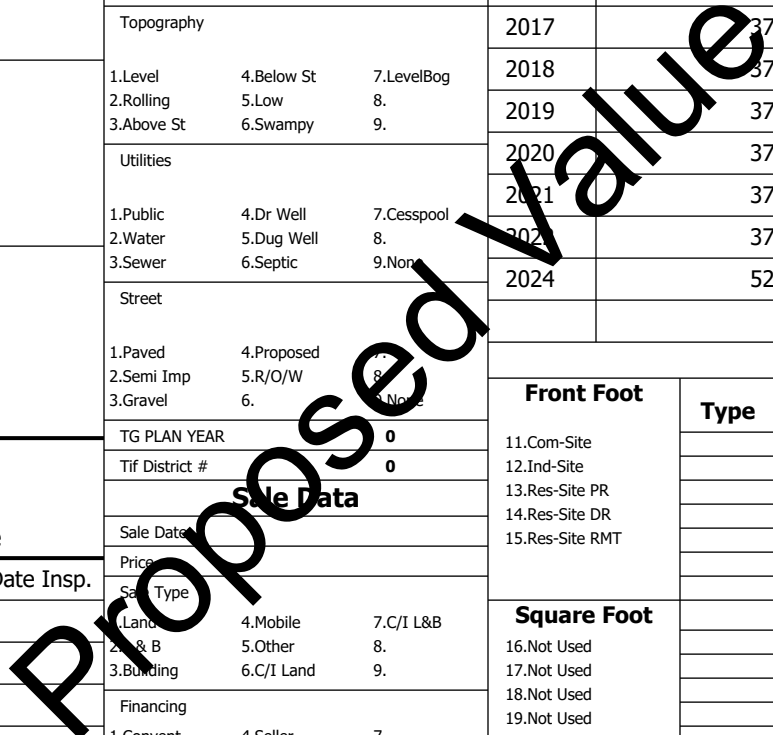

New Sharon

Map Lot 06-21-02

Account 79

Location 309 Weeks Mills Road

Card 1 Of 1 10/16/2024

Building Style 0	SF Bsmt Living 0	Layout 0
1.Conv. 5.Garrison 9.Other	Fin Bsmt Grade 0 0	1.Typical 4. 7.
2.Ranch 6.Split 10.Gar/Apt	Secondary Heat 0	2.Inadeq 5. 8.
3.R Ranch 7.Contemp 11.Cottage	Heat Type 100% 0	3.Poor 6. 9.
4.Cape 8.Log 12.Dblewid	1.HWBB 5.FWA 9.No Heat	Attic 0
Dwelling Units 0	2.HWCI 6.GravWA 10.Radiant	1.1/4 Fin 4.Full Fin 7.
Other Units 0	3.H Pump 7.Electric 11.	2.1/2 Fin 5.FI/Stair 8.
Stories 0	4.Steam 8.FI/Wall 12.	3.3/4 Fin 6. 9.None
1.1 4.1.5 7.	Cool Type 0% 9 None	Insulation 0
2.2 5.1.75 8.	1.Refrig 4.W&C Air 7.	1.Full 4.Minimal 7.
3.3 6.2.5 9.	2.Evapor 5. 8.	2.Heavy 5. 8.
Exterior Walls 0	3.H Pump 6. 9.None	3.Capped 6. 9.None
1.Wood 5.Stucco 9.Other	Kitchen Style 0	Unfinished % 0%
2.Vin/Al 6.Brick 10.Cement	1.Modern 4.Obsolete 7.	Grade & Factor 0 0%
3.Compos. 7.Stone 11.	2.Typical 5. 8.	1.E Grade 4.B Grade 7.
4.Asbestos 8.Concrete 12.	3.Old Type 6. 9.None	2.D Grade 5.A Grade 8.SC Grade
Roof Surface 0	Bath(s) Style 0	3.C Grade 6.AA Grade 9.Same
1.Asphalt 4.Composit 7.SS	1.Modern 4.Obsolete 7.	SQFT (Footprint) 0
2.Slate 5.Wood 8.	2.Typical 5. 8.	Condition 0
3.Metal 6.Roll Roo 9.	3.Old Type 6. 9.None	1.Poor 4.Avg 7.V G
SF Masonry Trim 0	# Rooms 0	2.Fair 5.Avg+ 8.Exc
Solar Voltaic 0	# Bedrooms 0	3.Avg- 6.Good 9.Same
OPEN-4-CUSTOM 0	# Full Baths 0	Phys. % Good 0%
Year Built 0	# Half Baths 0	Funct. % Good 100%
Year Remodeled 0	# Addn Fixtures 0	Functional Code 9 None
Foundation 0	# Fireplaces 0	1.Incomp 4.Delap 7.No Power
1.Concrete 4.Wood 7.		2.O-Built 5.Bsmt 8.None/Part
2.C Block 5.Slab 8.		3.Damage 6.Common 9.None
3.Br/Stone 6.Piers 9.		Econ. % Good 100%
Basement 0		Economic Code None
1.1/4 Bmt 4.Full Bmt 7.		0.None 3.No Power 7.
2.1/2 Bmt 5.None 8.		1.Location 4.General 8.
3.3/4 Bmt 6. 9.None		2.Encroach 9.None 9.
Bsmt Gar # Cars 0		Entrance Code 4 Unoccupied
Wet Basement 0		1.Interior 4.Vacant 7.
1.Dry 4. 7.		2.General 5.Estimate 8.
2.Damp 5. 8.		3.Informal 6.Reviewed 9.
3.Wet 6. 9.		Information Code 5 Estimate
		1.Owner 4.Agent 7.
		2.Relative 5.Estimate 8.
		3.Tenant 6.Other 9.



Proposed Value

Date Inspected 1/29/2024

Additions, Outbuildings & Improvements									
Type	Year	Units	Grade	Cond	Phys.	Funct.	Sound	Value	
997 12Mobile Home	1985	52x12	3 100	3	0 %	100 %			1.One Story Fram
					%	%			2.Two Story Fram
					%	%			3.Three Story Fr
					%	%			4.1 & 1/2 Story
					%	%			5.1 & 3/4 Story
					%	%			6.2 & 1/2 Story
					%	%			21.Open Frame Por
					%	%			22.Encl Frame Por
					%	%			23.Frame Garage
					%	%			24.Frame Shed
					%	%			25.Frame Bay Wind
					%	%			26.1SFr Overhang
					%	%			27.Unfin Basement
					%	%			28.Unfinished Att
					%	%			29.Finished Attic