

Kruchkow, Diane  
3 SALT MARSH RD  
NEW SHARON ME 04955

B1766P50

Inspection Witnessed By:

No./Date	Description	Date Insp.
X		

Notes:  
1/24 - PM VACANT

**New Sharon**

Property Data		
Neighborhood	5 NBHD 5	
Tree Growth Year	0	
1ST MORTGAGE	0	
2ND MORTGAGE	0	
Zone/Land Use	1 New Sharon all	
Secondary Zone		
Topography		
1.Level	4.Below St	7.LevelBog
2.Rolling	5.Low	8.
3.Above St	6.Swampy	9.
Utilities		
1.Public	4.Dr Well	7.Cesspool
2.Water	5.Dug Well	8.
3.Sewer	6.Septic	9.Non
Street		
1.Paved	4.Proposed	7.
2.Semi Imp	5.R/O/W	8.
3.Gravel	6.	9.No
TG PLAN YEAR	0	
Tif District #	0	
Sale Data		
Sale Date		
Price		
Sale Type		
1.Land	4.Mobile	7.C/I L&B
2.L&B	5.Other	8.
3.Bundling	6.C/I Land	9.
Financing		
1.Convent	4.Seller	7.
2.FHA/VA	5.Private	8.
3.Assumed	6.Cash	9.Unknown
Validity		
1.Valid	4.Split	7.Renovate
2.Related	5.Partial	8.Other
3.Distress	6.Exempt	9.
Verified		
1.Buyer	4.Agent	7.Family
2.Seller	5.Pub Rec	8.Other
3.Lender	6.MLS	9.

Assessment Record				
Year	Land	Buildings	Exempt	Total
2011	27,420	0	0	27,420
2012	27,420	0	0	27,420
2013	27,420	0	0	27,420
2014	27,420	0	0	27,420
2015	27,420	0	0	27,420
2016	27,420	0	0	27,420
2017	27,420	0	0	27,420
2018	27,420	0	0	27,420
2019	27,420	0	0	27,420
2020	27,420	0	0	27,420
2021	27,420	0	0	27,420
2022	27,420	0	0	27,420
2024	45,000	0	0	45,000

Land Data						
Front Foot	Type	Effective		Influence		Influence Codes
		Frontage	Depth	Factor	Code	
11.Com-Site				%		1.Unimproved
12.Ind-Site				%		2.Excess Frtg
13.Res-Site PR				%		3.Topography
14.Res-Site DR				%		4.Size/Shape
15.Res-Site RMT				%		5.Access
				%		6.Restriction
				%		7.Open Space
				%		8.View/Environ
				%		9.Fract Share
				%		30.Rear Land >10
				%		31.Tillable
				%		32.Pasture
				%		33.Orchard
				%		34.Software F&O
				%		35.Mixed Wood F&O
				%		36.Hardwood F&O
				%		37.Software TG
				%		38.Mixed Wood TG
				%		39.Hardwood TG
				%		40.Wasteland
				%		41.Open Space
				%		42.Mobile Home Si
				%		43.Condo Site
				%		44.Lot Improvemen
				%		45.Subdivision Lo
				%		46.Golf Course
<b>Total Acreage</b>	<b>8.40</b>					

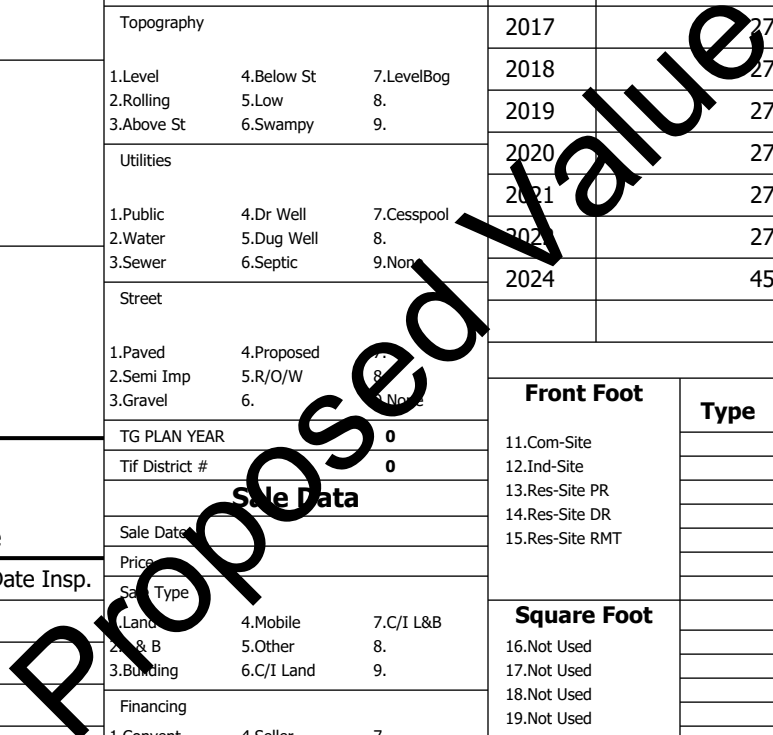

New Sharon

Map Lot 06-13

Account 592

Location Salt Marsh Road

Card 1 Of 1 10/16/2024

Building Style			SF Bsmt Living			Layout					
1.Conv.	5.Garrison	9.Other	Fin Bsmt Grade			1.Typical	4.	7.			
2.Ranch	6.Split	10.Gar/Apt	Secondary Heat			2.Inadeq	5.	8.			
3.R Ranch	7.Contemp	11.Cottage	Heat Type <b>100%</b>			3.Poor	6.	9.			
4.Cape	8.Log	12.Dblewid	1.HWBB	5.FWA	9.No Heat	Attic					
Dwelling Units			2.HWCI	6.GravWA	10.Radiant	1.1/4 Fin	4.Full Fin	7.			
Other Units			3.H Pump	7.Electric	11.	2.1/2 Fin	5.F/Stair	8.			
Stories			4.Steam	8.F/Wall	12.	3.3/4 Fin	6.	9.None			
1.1	4.1.5	7.	Cool Type <b>0%</b>			Insulation					
2.2	5.1.75	8.	1.Refrig	4.W&C Air	7.	1.Full	4.Minimal	7.			
3.3	6.2.5	9.	2.Evapor	5.	8.	2.Heavy	5.	8.			
Exterior Walls			3.H Pump	6.	9.None	3.Capped	6.	9.None			
1.Wood	5.Stucco	9.Other	Kitchen Style			Unfinished %					
2.Vin/Al	6.Brick	10.Cement	1.Modern	4.Obsolete	7.	Grade & Factor					
3.Compos.	7.Stone	11.	2.Typical	5.	8.	1.E Grade	4.B Grade	7.			
4.Asbestos	8.Concrete	12.	3.Old Type	6.	9.None	2.D Grade	5.A Grade	8.SC Grade			
Roof Surface			Bath(s) Style			3.C Grade	6.AA Grade	9.Same			
1.Asphalt	4.Composit	7.SS	1.Modern	4.Obsolete	7.	SQFT (Footprint)					
2.Slate	5.Wood	8.	2.Typical	5.	8.	Condition					
3.Metal	6.Roll Roo	9.	3.Old Type	6.	9.None	1.Poor	4.Avg	7.V G			
SF Masonry Trim			# Rooms			2.Fair	5.Avg+	8.Exc			
Solar Voltaic			# Bedrooms			3.Avg-	6.Good	9.Same			
OPEN-4-CUSTOM			# Full Baths			Phys. % Good					
Year Built			# Half Baths			Funct. % Good					
Year Remodeled			# Addn Fixtures			Functional Code					
Foundation			# Fireplaces			1.Incomp	4.Delap	7.No Power			
1.Concrete	4.Wood	7.				2.O-Built	5.Bsmt	8.No Power			
2.C Block	5.Slab	8.				3.Damage	6.Common	9.No Power			
3.Br/Stone	6.Piers	9.				Econ. % Good					
Basement						Economic Code					
1.1/4 Bmt	4.Full Bmt	7.				0.None	3.No Power	7.			
2.1/2 Bmt	5.None	8.				1.Location	4.General	8.			
3.3/4 Bmt	6.	9.None				2.Encroach	9.None	9.			
Bsmt Gar # Cars						Entrance Code			<b>4 Unoccupied</b>		
Wet Basement						1.Interior			4.Vacant	7.	
1.Dry	4.	7.				2.General	5.Estimate	8.			
2.Damp	5.	8.	3.Inform	6.Reviewed	9.						
3.Wet	6.	9.	Information Code			<b>5 Estimate</b>					
Date Inspected 1/29/2024			1.Owner			4.Agent	7.				
			2.Relative			5.Estimate	8.				
			3.Tenant			6.Other	9.				
<b>Additions, Outbuildings &amp; Improvements</b>						1.One Story Fram					
Type	Year	Units	Grade	Cond	Phys.	Funct.	Sound Value	2.Two Story Fram			
					%	%		3.Three Story Fr			
					%	%		4.1 & 1/2 Story			
					%	%		5.1 & 3/4 Story			
					%	%		6.2 & 1/2 Story			
					%	%		21.Open Frame Por			
					%	%		22.Encl Frame Por			
					%	%		23.Frame Garage			
					%	%		24.Frame Shed			
					%	%		25.Frame Bay Wind			
					%	%		26.1SFr Overhang			
					%	%		27.Unfin Basement			
					%	%		28.Unfinished Att			
					%	%		29.Finished Attic			

Proposed Value