

Ayer, John III
PO Box 84
Milliken CO 80543

B1019P208

Inspection Witnessed By:

X Date

No./Date	Description	Date Insp.

Notes:
Review of land pricing 2023. Changed lot to undeveloped.
1/24 - LD VACANT

New Sharon

Property Data		
Neighborhood	4 NBHD 4	
Tree Growth Year	0	
1ST MORTGAGE	0	
2ND MORTGAGE	0	
Zone/Land Use	1 New Sharon all	
Secondary Zone		
Topography		
1.Level	4.Below St	7.LevelBog
2.Rolling	5.Low	8.
3.Above St	6.Swampy	9.
Utilities		
1.Public	4.Dr Well	7.Cesspool
2.Water	5.Dug Well	8.
3.Sewer	6.Septic	9.Non
Street		
1.Paved	4.Proposed	7.
2.Semi Imp	5.R/O/W	8.
3.Gravel	6.	9.No
TG PLAN YEAR	0	
Tif District #	0	
Sale Data		
Sale Date		
Price		
Sale Type		
1.Land	4.Mobile	7.C/I L&B
2.L&B	5.Other	8.
3.Bundling	6.C/I Land	9.
Financing		
1.Convent	4.Seller	7.
2.FHA/VA	5.Private	8.
3.Assumed	6.Cash	9.Unknown
Validity		
1.Valid	4.Split	7.Renovate
2.Related	5.Partial	8.Other
3.Distress	6.Exempt	9.
Verified		
1.Buyer	4.Agent	7.Family
2.Seller	5.Pub Rec	8.Other
3.Lender	6.MLS	9.

Assessment Record				
Year	Land	Buildings	Exempt	Total
2011	29,000	0	0	29,000
2012	29,000	0	0	29,000
2013	29,000	0	0	29,000
2014	29,000	0	0	29,000
2015	29,000	0	0	29,000
2016	29,000	0	0	29,000
2017	29,000	0	0	29,000
2018	29,000	0	0	29,000
2019	29,000	0	0	29,000
2020	29,000	0	0	29,000
2021	29,000	0	0	29,000
2022	29,000	0	0	29,000
2024	32,940	0	0	32,940

Land Data						
Front Foot	Type	Effective		Influence		Influence Codes
		Frontage	Depth	Factor	Code	
11.Com-Site				%		1.Unimproved
12.Ind-Site				%		2.Excess Frtg
13.Res-Site PR				%		3.Topography
14.Res-Site DR				%		4.Size/Shape
15.Res-Site RMT				%		5.Access
				%		6.Restriction
				%		7.Open Space
				%		8.View/Environ
				%		9.Fract Share
Square Foot	Square Feet					Acres
16.Not Used				%		30.Rear Land >10
17.Not Used				%		31.Tillable
18.Not Used				%		32.Pasture
19.Not Used				%		33.Orchard
20.Residential-Si				%		34.Softwood F&O
				%		35.Mixed Wood F&O
				%		36.Hardwood F&O
				%		37.Softwood TG
				%		38.Mixed Wood TG
				%		39.Hardwood TG
				%		40.Wasteland
				%		41.Open Space
				%		42.Mobile Home Si
				%		43.Condo Site
				%		44.Lot Improvemen
				%		45.Subdivision Lo
				%		46.Golf Course
Total Acreage		3.00				

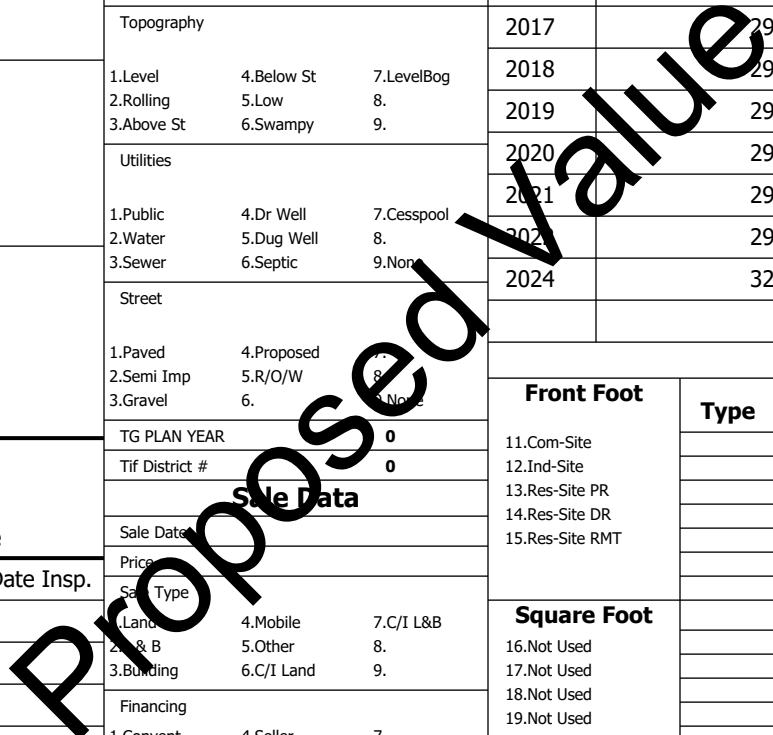

New Sharon

Map Lot 04-71

Account 39

Location Cape Cod Hill Road

Card 1 Of 1 10/16/2024

Building Style			SF Bsmt Living			Layout					
1.Conv.	5.Garrison	9.Other	Fin Bsmt Grade			1.Typical	4.	7.			
2.Ranch	6.Split	10.Gar/Apt	Secondary Heat			2.Inadeq	5.	8.			
3.R Ranch	7.Contemp	11.Cottage	Heat Type 100%			3.Poor	6.	9.			
4.Cape	8.Log	12.Dblewid	1.HWBB	5.FWA	9.No Heat	Attic					
Dwelling Units			2.HWCI	6.GravWA	10.Radiant	1.1/4 Fin	4.Full Fin	7.			
Other Units			3.H Pump	7.Electric	11.	2.1/2 Fin	5.F/Stair	8.			
Stories			4.Steam	8.F/Wall	12.	3.3/4 Fin	6.	9.None			
1.1	4.1.5	7.	Cool Type 0%			Insulation					
2.2	5.1.75	8.	1.Refrig	4.W&C Air	7.	1.Full	4.Minimal	7.			
3.3	6.2.5	9.	2.Evapor	5.	8.	2.Heavy	5.	8.			
Exterior Walls			3.H Pump	6.	9.None	3.Capped	6.	9.None			
1.Wood	5.Stucco	9.Other	Kitchen Style			Unfinished %					
2.Vin/Al	6.Brick	10.Cement	1.Modern	4.Obsolete	7.	Grade & Factor					
3.Compos.	7.Stone	11.	2.Typical	5.	8.	1.E Grade	4.B Grade	7.			
4.Asbestos	8.Concrete	12.	3.Old Type	6.	9.None	2.D Grade	5.A Grade	8.SC Grade			
Roof Surface			Bath(s) Style			3.C Grade	6.AA Grade	9.Same			
1.Asphalt	4.Composit	7.SS	1.Modern	4.Obsolete	7.	SQFT (Footprint)					
2.Slate	5.Wood	8.	2.Typical	5.	8.	Condition					
3.Metal	6.Roll Roo	9.	3.Old Type	6.	9.None	1.Poor	4.Avg	7.V G			
SF Masonry Trim			# Rooms			2.Fair	5.Avg+	8.Exc			
Solar Voltaic			# Bedrooms			3.Avg-	6.Good	9.Same			
OPEN-4-CUSTOM			# Full Baths			Phys. % Good					
Year Built			# Half Baths			Funct. % Good					
Year Remodeled			# Addn Fixtures			Functional Code					
Foundation			# Fireplaces			1.Incomp	4.Delap	7.No Power			
1.Concrete	4.Wood	7.				2.O-Built	5.Bsmt	8.No Power			
2.C Block	5.Slab	8.				3.Damage	6.Common	9.No Power	Econ. % Good		
3.Br/Stone	6.Piers	9.				Economic Code			0.None	3.No Power	7.
Basement						Entrance Code			1.Location	4.General	8.
1.1/4 Bmt	4.Full Bmt	7.				1.1			2.Encroach	9.None	9.
2.1/2 Bmt	5.None	8.				2.2			Unoccupied		
3.3/4 Bmt	6.	9.None				3.3			1.Interior	4.Vacant	7.
Bsmt Gar # Cars						4.4			2.Exterior	5.Estimate	8.
Wet Basement						5.5			3.Inform	6.Reviewed	9.
1.Dry	4.	7.				6.6			Information Code 5 Estimate		
2.Damp	5.	8.	7.7			1.Owner	4.Agent	7.			
3.Wet	6.	9.	8.8			2.Relative	5.Estimate	8.			
Date Inspected 1/03/2024			9.9			3.Tenant	6.Other	9.			
Additions, Outbuildings & Improvements											
Type	Year	Units	Grade	Cond	Phys.	Funct.	Sound Value				
					%	%		1.One Story Fram			
					%	%		2.Two Story Fram			
					%	%		3.Three Story Fr			
					%	%		4.1 & 1/2 Story			
					%	%		5.1 & 3/4 Story			
					%	%		6.2 & 1/2 Story			
					%	%		21.Open Frame Por			
					%	%		22.Encl Frame Por			
					%	%		23.Frame Garage			
					%	%		24.Frame Shed			
					%	%		25.Frame Bay Wind			
					%	%		26.1SFr Overhang			
					%	%		27.Unfin Basement			
					%	%		28.Unfinished Att			
					%	%		29.Finished Attic			

Proposed Value