

HANSON, MICHAEL J
HANSON, HANNAH R
128 INTERVALE RD
NEW SHARON ME 04955

B4479P34

Previous Owner
Horridge, Nelson L Jr
Horridge, Janice K
20285 Lana Lane
Porter TX 77365
Sale Date: 8/01/2022

Inspection Witnessed By:

X Date

No./Date	Description	Date Insp.

Notes:
1/24 - LD EA, EST IA, PROP. ABUTTS SANDY RIVER
7/24 - KL SALES REVIEW

New Sharon

Property Data		
Neighborhood	5 NBHD 5	
Tree Growth Year	0	
1ST MORTGAGE	0	
2ND MORTGAGE	0	
Zone/Land Use	1 New Sharon all	
Secondary Zone		
Topography	2 Rolling	
1.Level	4.Below St	7.LevelBog
2.Rolling	5.Low	8.
3.Above St	6.Swampy	9.
Utilities	4 Drilled Well 6 Septic System	
1.Public	4.Dr Well	7.Cesspool
2.Water	5.Dug Well	8.
3.Sewer	6.Septic	9.Non
Street	1 Paved	
1.Paved	4.Proposed	7.
2.Semi Imp	5.R/O/W	8.
3.Gravel	6.	9.No
TG PLAN YEAR	0	
Tif District #	0	
Sale Data		
Sale Date	8/01/2022	
Price	240,000	
Sale Type	Land & Buildings	
1.Land	4.Mobile	7.C/I L&B
2.L&B	5.Other	8.
3.Bundling	6.C/I Land	9.
Financing	9 Unknown	
1.Convent	4.Seller	7.
2.FHA/VA	5.Private	8.
3.Assumed	6.Cash	9.Unknown
Validity	1 Arms Length Sale	
1.Valid	4.Split	7.Renovate
2.Related	5.Partial	8.Other
3.Distress	6.Exempt	9.
Verified	5 Public Record	
1.Buyer	4.Agent	7.Family
2.Seller	5.Pub Rec	8.Other
3.Lender	6.MLS	9.

Assessment Record				
Year	Land	Buildings	Exempt	Total
2011	33,800	68,570	0	102,370
2012	33,800	68,570	0	102,370
2013	33,800	68,570	0	102,370
2014	33,800	68,570	0	102,370
2015	33,800	68,570	0	102,370
2016	33,800	68,570	0	102,370
2017	33,800	68,570	0	102,370
2018	33,800	68,570	0	102,370
2019	33,800	68,570	0	102,370
2020	33,800	68,570	0	102,370
2021	33,800	68,570	0	102,370
2022	33,800	68,570	22,250	80,120
2024	48,900	180,850	25,000	204,750

Land Data						
Front Foot	Type	Effective		Influence		Influence Codes
		Frontage	Depth	Factor	Code	
11.Com-Site				%		1.Unimproved
12.Ind-Site				%		2.Excess Frtg
13.Res-Site PR				%		3.Topography
14.Res-Site DR				%		4.Size/Shape
15.Res-Site RMT				%		5.Access
				%		6.Restriction
				%		7.Open Space
				%		8.View/Environ
				%		9.Fract Share
Square Foot	Square Feet					Acres
16.Not Used				%		30.Rear Land >10
17.Not Used				%		31.Tillable
18.Not Used				%		32.Pasture
19.Not Used				%		33.Orchard
20.Residential-Si				%		34.Software F&O
				%		35.Mixed Wood F&O
Fract. Acre	Acreage/Sites					
21.Homesite (Frac)	13	1.00	100	%	0	36.Hardwood F&O
22.Baselot (Frac)	28	4.00	100	%	0	37.Software TG
23.Misc (Fract)	54	1.00	100	%	0	38.Mixed Wood TG
				%		39.Hardwood TG
				%		40.Wasteland
				%		41.Open Space
				%		42.Mobile Home Si
				%		43.Condo Site
				%		44.Lot Improvemen
28.Rear Land <5	Total Acreage 6.00					45.Subdivision Lo
29.Rear Land 5-10						46.Golf Course

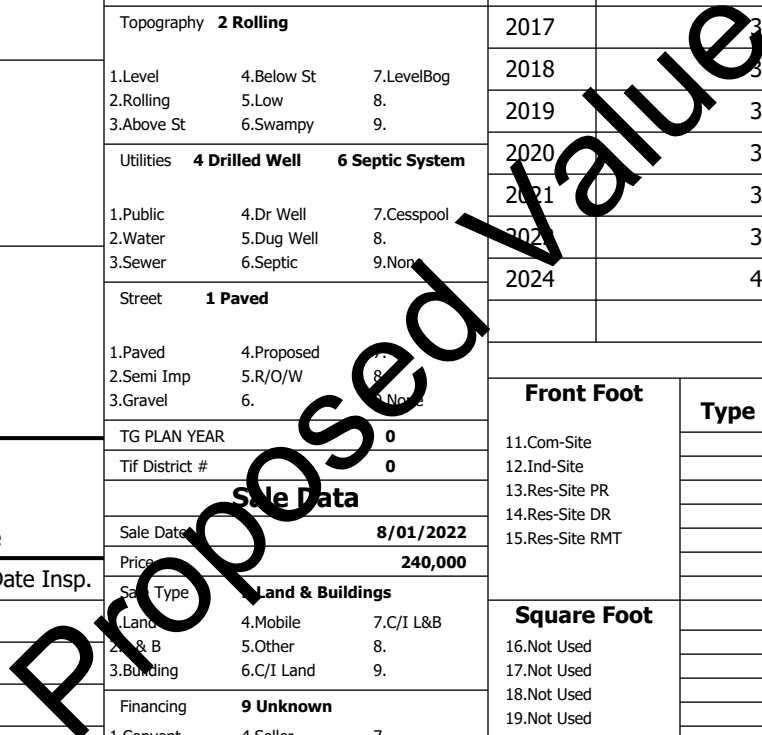

New Sharon

Map Lot 04-48

Account 538

Location 128 Intervale Road

Card 1 Of 1 10/16/2024

Building Style 3 Raised Ranch	SF Bsmt Living 448	Layout 1 Typical
1.Conv. 5.Garrison 9.Other	Fin Bsmt Grade 3 110	1.Typical 4. 7.
2.Ranch 6.Split 10.Gar/Apt	Secondary Heat 0	2.Inadeq 5. 8.
3.R Ranch 7.Contemp 11.Cottage	Heat Type 100% 5 Forced Warm Air	3.Poor 6. 9.
4.Cape 8.Log 12.Dblewid	1.HWBB 5.FWA 9.No Heat	Attic 9 None
Dwelling Units 1	2.HWCI 6.GravWA 10.Radiant	1.1/4 Fin 4.Full Fin 7.
Other Units 0	3.H Pump 7.Electric 11.	2.1/2 Fin 5.FI/Stair 8.
Stories 1 One Story	4.Steam 8.FI/Wall 12.	3.3/4 Fin 6. 9.None
1.1 4.1.5 7.	Cool Type 100% 3 Heat Pump	Insulation 1 Full
2.2 5.1.75 8.	1.Refrig 4.W&C Air 7.	1.Full 4.Minimal 7.
3.3 6.2.5 9.	2.Evapor 5. 8.	2.Heavy 5. 8.
Exterior Walls 2 Vinyl/Aluminum	3.H Pump 6. 9.None	3.Capped 6. 9.None
1.Wood 5.Stucco 9.Other	Kitchen Style 2 Typical	Unfinished % 0%
2.Vin/Al 6.Brick 10.Cement	1.Modern 4.Obsolete 7.	Grade & Factor 3 Average 100%
3.Compos. 7.Stone 11.	2.Typical 5. 8.	1.E Grade 4.B Grade 7.
4.Asbestos 8.Concrete 12.	3.Old Type 6. 9.None	2.D Grade 5.A Grade 8.SC Grade
Roof Surface 1 Asphalt Shingles	Bath(s) Style 2 Typical Bath(s)	3.C Grade 6.AA Grade 9.Same
1.Asphalt 4.Composit 7.SS	1.Modern 4.Obsolete 7.	SQFT (Footprint) 512
2.Slate 5.Wood 8.	2.Typical 5. 8.	Condition 6 Good
3.Metal 6.Roll Roo 9.	3.Old Type 6. 9.None	1.Poor 4.Avg 7.V G
SF Masonry Trim 0	# Rooms 6	2.Fair 5.Avg+ 8.Exc
Solar Voltaic 0	# Bedrooms 2	3.Avg- 6.Good 9.Same
OPEN-4-CUSTOM 0	# Full Baths 1	Phys. % Good 0%
Year Built 2006	# Half Baths 1	Funct. % Good 100%
Year Remodeled 0	# Addn Fixtures 0	Functional Code 9 None
Foundation 5 Concrete Slab	# Fireplaces 0	1.Incomp 4.Delap 7.No Power
1.Concrete 4.Wood 7.		2.O-Built 5.Bsmt 8.No Power
2.C Block 5.Slab 8.		3.Damage 6.Common 9.No Power
3.Br/Stone 6.Piers 9.		Econ. % Good 100%
Basement 4 Full Basement		Economic Code None
1.1/4 Bmt 4.Full Bmt 7.		0.None 3.No Power 7.
2.1/2 Bmt 5.None 8.		1.Location 4.General 8.
3.3/4 Bmt 6. 9.None		2.Encroach 9.None
Bsmt Gar # Cars 1		Entrance Code 5 Estimate
Wet Basement 1 Dry Basement		1.Interior 4.Vacant 7.
1.Dry 4. 7.		2.General 5.Estimate 8.
2.Damp 5. 8.		3.Informal 6.Reviewed 9.
3.Wet 6. 9.		Information Code 5 Estimate
		1.Owner 4.Agent 7.
		2.Relative 5.Estimate 8.
		3.Tenant 6.Other 9.

04-48

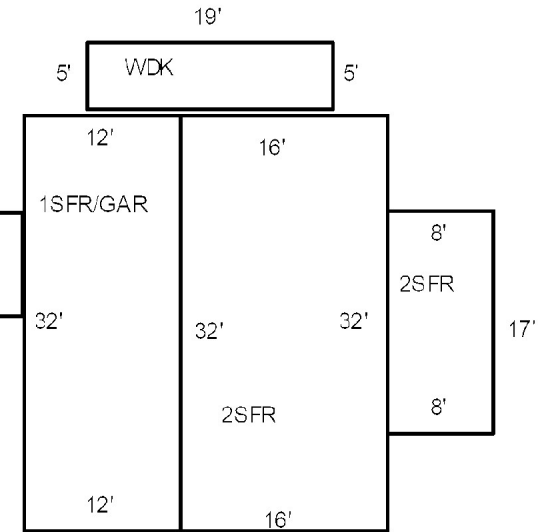

Proposed Value

Date Inspected 1/03/2024

Additions, Outbuildings & Improvements

Type	Year	Units	Grade	Cond	Phys.	Funct.	Sound Value
68 Wood Deck	0	64	0 0	0	0 %	100 %	
68 Wood Deck	0	95	0 0	0	0 %	100 %	
65 Stable w/Loft	2020	260	4 100	4	0 %	100 %	
22 Encl Frame Porch	0	136	0 0	0	0 %	100 %	
24 Frame Shed	0	136	0 0	0	0 %	100 %	
1 One Story Frame	0	384	0 0	0	0 %	100 %	
20 Finished	0	384	0 0	0	0 %	100 %	
					%	%	
					%	%	
					%	%	



- 1.One Story Fram
- 2.Two Story Fram
- 3.Three Story Fr
- 4.1 & 1/2 Story
- 5.1 & 3/4 Story
- 6.2 & 1/2 Story
- 21.Open Frame Por
- 22.Encl Frame Por
- 23.Frame Garage
- 24.Frame Shed
- 25.Frame Bay Wind
- 26.1SFR Overhang
- 27.Unfin Basement
- 28.Unfinished Att
- 29.Finished Attic