

Powers, Ronald T  
105 GEORGE THOMAS ROAD  
NEW SHARON ME 04955

B848P247 B3980P297 B4059P125

Previous Owner  
Gilley, Alice  
C/o Seth Harris  
192 George Thomas Road  
Chesterville Me 04938  
Sale Date: 1/01/4201

Inspection Witnessed By:

X Date

No./Date	Description	Date Insp.

Notes:

Trio gave 2 homestead exemptions for 2020 (sigh) TW  
1/24 - LD EA, EST IA

New Sharon

Property Data			Assessment Record				
Neighborhood <b>5 NBHD 5</b>			Year	Land	Buildings	Exempt	Total
Tree Growth Year <b>0</b>			2011	30,600	70,340	16,000	84,940
1ST MORTGAGE <b>0</b>			2012	30,600	70,340	16,000	84,940
2ND MORTGAGE <b>0</b>			2013	30,600	70,340	16,000	84,940
Zone/Land Use <b>1 New Sharon all</b>			2014	30,600	70,340	16,000	84,940
Secondary Zone			2015	30,600	70,340	16,000	84,940
Topography			2016	30,600	70,340	21,000	79,940
1.Level 4.Below St 7.LevelBog			2017	30,600	70,340	26,000	74,940
2.Rolling 5.Low 8.			2018	30,600	70,340	26,000	74,940
3.Above St 6.Swampy 9.			2019	25,600	70,340	20,000	75,940
Utilities			2020	25,600	70,340	50,000	45,940
1.Public 4.Dr Well 7.Cesspool			2021	25,600	70,340	25,000	70,940
2.Water 5.Dug Well 8.			2022	25,600	70,340	0	95,940
3.Sewer 6.Septic 9.Non			2024	38,650	145,510	25,000	159,160
Street							
1.Paved 4.Proposed							
2.Semi Imp 5.R/O/W							
3.Gravel 6. 8.							
TG PLAN YEAR <b>0</b>							
Tif District # <b>0</b>							
Sale Date <b>1/01/2014</b>							
Price							
Sale Type							
Land & Buildings							
1.Land 4.Mobile 7.C/I L&B							
2.L&B 5.Other 8.							
3.Bundling 6.C/I Land 9.							
Financing <b>9 Unknown</b>							
1.Convent 4.Seller 7.							
2.FHA/VA 5.Private 8.							
3.Assumed 6.Cash 9.Unknown							
Validity <b>8 Other Non Valid</b>							
1.Valid 4.Split 7.Renovate							
2.Related 5.Partial 8.Other							
3.Distress 6.Exempt 9.							
Verified <b>5 Public Record</b>							
1.Buyer 4.Agent 7.Family							
2.Seller 5.Pub Rec 8.Other							
3.Lender 6.MLS 9.							

Land Data						
Front Foot	Type	Effective		Influence		Influence Codes
		Frontage	Depth	Factor	Code	
11.Com-Site				%		1.Unimproved
12.Ind-Site				%		2.Excess Frtg
13.Res-Site PR				%		3.Topography
14.Res-Site DR				%		4.Size/Shape
15.Res-Site RMT				%		5.Access
				%		6.Restriction
				%		7.Open Space
				%		8.View/Environ
				%		9.Fract Share
				%		30.Rear Land >10
				%		31.Tillable
				%		32.Pasture
				%		33.Orchard
				%		34.Softwood F&O
				%		35.Mixed Wood F&O
				%		36.Hardwood F&O
				%		37.Softwood TG
				%		38.Mixed Wood TG
				%		39.Hardwood TG
				%		40.Wasteland
				%		41.Open Space
				%		42.Mobile Home Si
				%		43.Condo Site
				%		44.Lot Improvemen
				%		45.Subdivision Lo
				%		46.Golf Course
<b>Square Foot</b>		<b>Square Feet</b>				
16.Not Used				%		
17.Not Used				%		
18.Not Used				%		
19.Not Used				%		
20.Residential-Si				%		
<b>Fract. Acre</b>		<b>Acreege/Sites</b>				
21.Homesite (Frac	13	1.00	100	%	0	
22.Baselot (Fract	28	0.30	100	%	0	
23.Misc (Fract)				%		
<b>Acres</b>						
24.Homesite				%		
25.Baselot				%		
26.Not Used				%		
27.Not Used				%		
28.Rear Land <5				%		
29.Rear Land 5-10				%		
<b>Total Acreage</b>				1.30		



**New Sharon**

Map Lot 04-39

Account 419

Location 105 George Thomas Road

Card 1

Of 1

10/16/2024

Building Style <b>2 Ranch</b>	SF Bsmt Living <b>0</b>	Layout <b>1 Typical</b>
1.Conv. 5.Garrison 9.Other	Fin Bsmt Grade <b>0 0</b>	1.Typical 4. 7.
2.Ranch 6.Split 10.Gar/Apt	Secondary Heat <b>0</b>	2.Inadeq 5. 8.
3.R Ranch 7.Contemp 11.Cottage	Heat Type <b>100% 1 Hot Water BB</b>	3.Poor 6. 9.
4.Cape 8.Log 12.Dblewid	1.HWBB 5.FWA 9.No Heat	Attic <b>9 None</b>
Dwelling Units <b>1</b>	2.HWCI 6.GravWA 10.Radiant	1.1/4 Fin 4.Full Fin 7.
Other Units <b>0</b>	3.H Pump 7.Electric 11.	2.1/2 Fin 5.FI/Stair 8.
Stories <b>1 One Story</b>	4.Steam 8.FI/Wall 12.	3.3/4 Fin 6. 9.None
1.1 4.1.5 7.	Cool Type <b>0% 9 None</b>	Insulation <b>1 Full</b>
2.2 5.1.75 8.	1.Refrig 4.W&C Air 7.	1.Full 4.Minimal 7.
3.3 6.2.5 9.	2.Evapor 5. 8.	2.Heavy 5. 8.
Exterior Walls <b>2 Vinyl/Aluminum</b>	3.H Pump 6. 9.None	3.Capped 6. 9.None
1.Wood 5.Stucco 9.Other	Kitchen Style <b>2 Typical</b>	Unfinished % <b>0%</b>
2.Vin/Al 6.Brick 10.Cement	1.Modern 4.Obsolete 7.	Grade & Factor <b>3 Average 100%</b>
3.Compos. 7.Stone 11.	2.Typical 5. 8.	1.E Grade 4.B Grade 7.
4.Asbestos 8.Concrete 12.	3.Old Type 6. 9.None	2.D Grade 5.A Grade 8.SC Grade
Roof Surface <b>3 Sheet Metal</b>	Bath(s) Style <b>2 Typical Bath(s)</b>	3.C Grade 6.AA Grade 9.Same
1.Asphalt 4.Composit 7.SS	1.Modern 4.Obsolete 7.	SQFT (Footprint) <b>952</b>
2.Slate 5.Wood 8.	2.Typical 5. 8.	Condition <b>4 Average</b>
3.Metal 6.Roo 9.	3.Old Type 6. 9.None	1.Poor 4.Avg 7.V G
SF Masonry Trim <b>0</b>	# Rooms <b>5</b>	2.Fair 5.Avg+ 8.Exc
Solar Voltaic <b>0</b>	# Bedrooms <b>2</b>	3.Avg- 6.Good 9.Same
OPEN-4-CUSTOM <b>0</b>	# Full Baths <b>1</b>	Phys. % Good <b>0%</b>
Year Built <b>1980</b>	# Half Baths <b>0</b>	Funct. % Good <b>100%</b>
Year Remodeled <b>0</b>	# Addn Fixtures <b>0</b>	Functional Code <b>9 None</b>
Foundation <b>1 Concrete</b>	# Fireplaces <b>0</b>	1.Incomp 4.Delap 7.No Power
1.Concrete 4.Wood 7.	 <p><b>TRIO</b> Software A Division of Harris Computer Systems</p>	2.O-Built 5.Bsmt 8.No Power
2.C Block 5.Slab 8.		3.Damage 6.Common 9.No Power
3.Br/Stone 6.Piers 9.		Econ. % Good <b>100%</b>
Basement <b>4 Full Basement</b>		Economic Code <b>None</b>
1.1/4 Bmt 4.Full Bmt 7.		0.None 3.No Power 7.
2.1/2 Bmt 5.None 8.		1.Location 4.General 8.
3.3/4 Bmt 6. 9.None		2.Encroach 9.None 9.
Bsmt Gar # Cars <b>0</b>		Entrance Code <b>5 Estimate</b>
Wet Basement <b>1 Dry Basement</b>		1.Interior 4.Vacant 7.
1.Dry 4. 7.		2.General 5.Estimate 8.
2.Damp 5. 8.	3.Informal 6.Reviewed 9.	
3.Wet 6. 9.	Information Code <b>5 Estimate</b>	
	1.Owner 4.Agent 7.	
	2.Relative 5.Estimate 8.	
	3.Tenant 6.Other 9.	

04-38-00

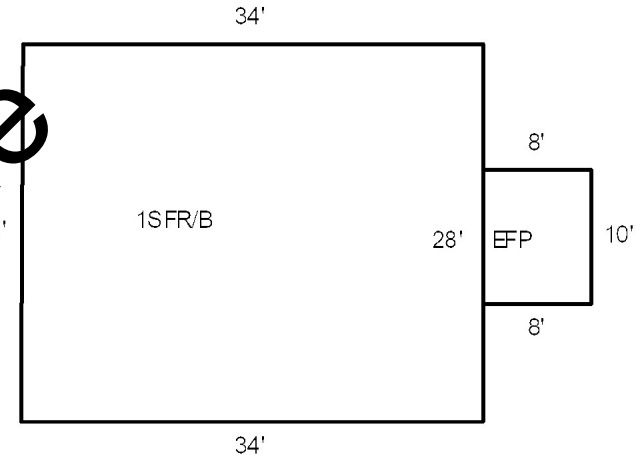

Date Inspected 1/02/2024

**Additions, Outbuildings & Improvements**

Type	Year	Units	Grade	Cond	Phys.	Funct.	Sound Value
64 Tennis Court	0	128	3 100	3	0 %	100 %	
21 Open Frame	0	96	3 100	3	0 %	100 %	
61 Canopy	0	128	3 100	3	0 %	100 %	
61 Canopy	0	192	3 100	3	0 %	100 %	
23 Frame Garage	0	576	3 100	3	0 %	100 %	
22 Encl Frame Porch	0	80	0 0	0	0 %	100 %	
					%	%	
					%	%	
					%	%	
					%	%	
					%	%	

- 1.One Story Fram
- 2.Two Story Fram
- 3.Three Story Fr
- 4.1 & 1/2 Story
- 5.1 & 3/4 Story
- 6.2 & 1/2 Story
- 21.Open Frame Por
- 22.Encl Frame Por
- 23.Frame Garage
- 24.Frame Shed
- 25.Frame Bay Wind
- 26.1SFr Overhang
- 27.Unfin Basement
- 28.Unfinished Att
- 29.Finished Attic

