

Tibbetts, Carl
Tibbetts, Stephanie
161 GEORGE THOMAS ROAD
NEW SHARON NC 04955

B2972P239

Previous Owner
Theobald, Barbara M.
Gilbert, Michael A.
350 River Road
Benton ME 04901
Sale Date: 7/26/2019

Inspection Witnessed By:

No./Date	Description	Date Insp.
X		

Notes:

2022 New Photo Stephanie added to record 8/8/22
7/6/23- W/MR. NEW HSE START W/WELL & SEPTIC.
1/24 - LD EA, EST IA, WATERFRONT = SHADY RIVER

New Sharon

Property Data			Assessment Record																																																																																																																																																																																																																	
Neighborhood 5 NBHD 5			Year	Land	Buildings	Exempt	Total																																																																																																																																																																																																													
Tree Growth Year 0			2011	20,000	17,830	0	37,830																																																																																																																																																																																																													
1ST MORTGAGE 0			2012	20,000	17,830	0	37,830																																																																																																																																																																																																													
2ND MORTGAGE 0			2013	20,000	17,830	0	37,830																																																																																																																																																																																																													
Zone/Land Use 1 New Sharon all			2014	20,000	17,830	0	37,830																																																																																																																																																																																																													
Secondary Zone			2015	20,000	17,830	0	37,830																																																																																																																																																																																																													
Topography			2016	20,000	17,830	0	37,830																																																																																																																																																																																																													
1.Level 4.Below St 7.LevelBog			2017	20,000	17,830	0	37,830																																																																																																																																																																																																													
2.Rolling 5.Low 8.			2018	20,000	17,830	0	37,830																																																																																																																																																																																																													
3.Above St 6.Swampy 9.			2019	20,000	17,830	0	37,830																																																																																																																																																																																																													
Utilities			2020	20,000	17,830	0	37,830																																																																																																																																																																																																													
1.Public 4.Dr Well 7.Cesspool			2021	20,000	17,830	0	37,830																																																																																																																																																																																																													
2.Water 5.Dug Well 8.			2022	20,000	46,675	0	66,675																																																																																																																																																																																																													
3.Sewer 6.Septic 9.Non			2024	31,600	239,350	0	270,950																																																																																																																																																																																																													
Street																																																																																																																																																																																																																				
1.Paved 4.Proposed			<table border="1"> <thead> <tr> <th colspan="5">Land Data</th> </tr> <tr> <th rowspan="2">Front Foot</th> <th rowspan="2">Type</th> <th colspan="2">Effective</th> <th colspan="2">Influence</th> <th rowspan="2">Influence Codes</th> </tr> <tr> <th>Frontage</th> <th>Depth</th> <th>Factor</th> <th>Code</th> </tr> </thead> <tbody> <tr> <td>11.Com-Site</td> <td></td> <td></td> <td></td> <td>%</td> <td></td> <td>1.Unimproved</td> </tr> <tr> <td>12.Ind-Site</td> <td></td> <td></td> <td></td> <td>%</td> <td></td> <td>2.Excess Frtg</td> </tr> <tr> <td>13.Res-Site PR</td> <td></td> <td></td> <td></td> <td>%</td> <td></td> <td>3.Topography</td> </tr> <tr> <td>14.Res-Site DR</td> <td></td> <td></td> <td></td> <td>%</td> <td></td> <td>4.Size/Shape</td> </tr> <tr> <td>15.Res-Site RMT</td> <td></td> <td></td> <td></td> <td>%</td> <td></td> <td>5.Access</td> </tr> <tr> <td></td> <td></td> <td></td> <td></td> <td>%</td> <td></td> <td>6.Restriction</td> </tr> <tr> <td></td> <td></td> <td></td> <td></td> <td>%</td> <td></td> <td>7.Open Space</td> </tr> <tr> <td></td> <td></td> <td></td> <td></td> <td>%</td> <td></td> <td>8.View/Environ</td> </tr> <tr> <td></td> <td></td> <td></td> <td></td> <td>%</td> <td></td> <td>9.Fract Share</td> </tr> <tr> <td></td> <td></td> <td></td> <td></td> <td>%</td> <td></td> <td>Acres</td> </tr> <tr> <td></td> <td></td> <td></td> <td></td> <td>%</td> <td></td> <td>30.Rear Land >10</td> </tr> <tr> <td></td> <td></td> <td></td> <td></td> <td>%</td> <td></td> <td>31.Tillable</td> </tr> <tr> <td></td> <td></td> <td></td> <td></td> <td>%</td> <td></td> <td>32.Pasture</td> </tr> <tr> <td></td> <td></td> <td></td> <td></td> <td>%</td> <td></td> <td>33.Orchard</td> </tr> <tr> <td></td> <td></td> <td></td> <td></td> <td>%</td> <td></td> <td>34.Software F&O</td> </tr> <tr> <td></td> <td></td> <td></td> <td></td> <td>%</td> <td></td> <td>35.Mixed Wood F&O</td> </tr> <tr> <td></td> <td></td> <td></td> <td></td> <td>%</td> <td></td> <td>36.Hardwood F&O</td> </tr> <tr> <td></td> <td></td> <td></td> <td></td> <td>%</td> <td></td> <td>37.Software TG</td> </tr> <tr> <td></td> <td></td> <td></td> <td></td> <td>%</td> <td></td> <td>38.Mixed Wood TG</td> </tr> <tr> <td></td> <td></td> <td></td> <td></td> <td>%</td> <td></td> <td>39.Hardwood TG</td> </tr> <tr> <td></td> <td></td> <td></td> <td></td> <td>%</td> <td></td> <td>40.Wasteland</td> </tr> <tr> <td></td> <td></td> <td></td> <td></td> <td>%</td> <td></td> <td>41.Open Space</td> </tr> <tr> <td></td> <td></td> <td></td> <td></td> <td>%</td> <td></td> <td>42.Mobile Home Si</td> </tr> <tr> <td></td> <td></td> <td></td> <td></td> <td>%</td> <td></td> <td>43.Condo Site</td> </tr> <tr> <td></td> <td></td> <td></td> <td></td> <td>%</td> <td></td> <td>44.Lot Improvemen</td> </tr> <tr> <td></td> <td></td> <td></td> <td></td> <td>%</td> <td></td> <td>45.Subdivision Lo</td> </tr> <tr> <td></td> <td></td> <td></td> <td></td> <td>%</td> <td></td> <td>46.Golf Course</td> </tr> </tbody> </table>					Land Data					Front Foot	Type	Effective		Influence		Influence Codes	Frontage	Depth	Factor	Code	11.Com-Site				%		1.Unimproved	12.Ind-Site				%		2.Excess Frtg	13.Res-Site PR				%		3.Topography	14.Res-Site DR				%		4.Size/Shape	15.Res-Site RMT				%		5.Access					%		6.Restriction					%		7.Open Space					%		8.View/Environ					%		9.Fract Share					%		Acres					%		30.Rear Land >10					%		31.Tillable					%		32.Pasture					%		33.Orchard					%		34.Software F&O					%		35.Mixed Wood F&O					%		36.Hardwood F&O					%		37.Software TG					%		38.Mixed Wood TG					%		39.Hardwood TG					%		40.Wasteland					%		41.Open Space					%		42.Mobile Home Si					%		43.Condo Site					%		44.Lot Improvemen					%		45.Subdivision Lo					%		46.Golf Course
Land Data																																																																																																																																																																																																																				
Front Foot	Type	Effective						Influence		Influence Codes																																																																																																																																																																																																										
		Frontage						Depth	Factor		Code																																																																																																																																																																																																									
11.Com-Site				%		1.Unimproved																																																																																																																																																																																																														
12.Ind-Site				%		2.Excess Frtg																																																																																																																																																																																																														
13.Res-Site PR				%		3.Topography																																																																																																																																																																																																														
14.Res-Site DR				%		4.Size/Shape																																																																																																																																																																																																														
15.Res-Site RMT				%		5.Access																																																																																																																																																																																																														
				%		6.Restriction																																																																																																																																																																																																														
				%		7.Open Space																																																																																																																																																																																																														
				%		8.View/Environ																																																																																																																																																																																																														
				%		9.Fract Share																																																																																																																																																																																																														
				%		Acres																																																																																																																																																																																																														
				%		30.Rear Land >10																																																																																																																																																																																																														
				%		31.Tillable																																																																																																																																																																																																														
				%		32.Pasture																																																																																																																																																																																																														
				%		33.Orchard																																																																																																																																																																																																														
				%		34.Software F&O																																																																																																																																																																																																														
				%		35.Mixed Wood F&O																																																																																																																																																																																																														
				%		36.Hardwood F&O																																																																																																																																																																																																														
				%		37.Software TG																																																																																																																																																																																																														
				%		38.Mixed Wood TG																																																																																																																																																																																																														
				%		39.Hardwood TG																																																																																																																																																																																																														
				%		40.Wasteland																																																																																																																																																																																																														
				%		41.Open Space																																																																																																																																																																																																														
				%		42.Mobile Home Si																																																																																																																																																																																																														
				%		43.Condo Site																																																																																																																																																																																																														
				%		44.Lot Improvemen																																																																																																																																																																																																														
				%		45.Subdivision Lo																																																																																																																																																																																																														
				%		46.Golf Course																																																																																																																																																																																																														
TG PLAN YEAR 0			Front Foot																																																																																																																																																																																																																	
Tif District # 0			Square Foot																																																																																																																																																																																																																	
Sale Date 7/26/2019			Fract. Acre																																																																																																																																																																																																																	
Price 360,000			Acres																																																																																																																																																																																																																	
Sale Type Land & Buildings			Total Acreage 1.00																																																																																																																																																																																																																	
1.Land 4.Mobile 7.C/I L&B																																																																																																																																																																																																																				
2.L&B 5.Other 8.																																																																																																																																																																																																																				
3.Bundling 6.C/I Land 9.																																																																																																																																																																																																																				
Financing 9 Unknown																																																																																																																																																																																																																				
1.Convent 4.Seller 7.																																																																																																																																																																																																																				
2.FHA/VA 5.Private 8.																																																																																																																																																																																																																				
3.Assumed 6.Cash 9.Unknown																																																																																																																																																																																																																				
Validity 1 Arms Length Sale																																																																																																																																																																																																																				
1.Valid 4.Split 7.Renovate																																																																																																																																																																																																																				
2.Related 5.Partial 8.Other																																																																																																																																																																																																																				
3.Distress 6.Exempt 9.																																																																																																																																																																																																																				
Verified 5 Public Record																																																																																																																																																																																																																				
1.Buyer 4.Agent 7.Family																																																																																																																																																																																																																				
2.Seller 5.Pub Rec 8.Other																																																																																																																																																																																																																				
3.Lender 6.MLS 9.																																																																																																																																																																																																																				



New Sharon

Map Lot 04-38-02

Account 1268

Location 161 George Thomas Road

Card 1 Of 1 10/16/2024

Building Style 7 Contemporary	SF Bsmt Living 0	Layout 1 Typical
1.Conv. 5.Garrison 9.Other	Fin Bsmt Grade 0 0	1.Typical 4. 7.
2.Ranch 6.Split 10.Gar/Apt	Secondary Heat 0	2.Inadeq 5. 8.
3.R Ranch 7.Contemp 11.Cottage	Heat Type 100% 7 Electric	3.Poor 6. 9.
4.Cape 8.Log 12.Dblewid	1.HWBB 5.FWA 9.No Heat	Attic 9 None
Dwelling Units 1	2.HWCI 6.GravWA 10.Radiant	1.1/4 Fin 4.Full Fin 7.
Other Units 0	3.H Pump 7.Electric 11.	2.1/2 Fin 5.F/Stair 8.
Stories 2 Two Story	4.Steam 8.F/Wall 12.	3.3/4 Fin 6. 9.None
1.1 4.1.5 7.	Cool Type 0% 9 None	Insulation 1 Full
2.2 5.1.75 8.	1.Refrig 4.W&C Air 7.	1.Full 4.Minimal 7.
3.3 6.2.5 9.	2.Evapor 5. 8.	2.Heavy 5. 8.
Exterior Walls 1 Wood Siding	3.H Pump 6. 9.None	3.Capped 6. 9.None
1.Wood 5.Stucco 9.Other	Kitchen Style 2 Typical	Unfinished % 0%
2.Vin/Al 6.Brick 10.Cement	1.Modern 4.Obsolete 7.	Grade & Factor 3 Average 110%
3.Compos. 7.Stone 11.	2.Typical 5. 8.	1.E Grade 4.B Grade 7.
4.Asbestos 8.Concrete 12.	3.Old Type 6. 9.None	2.D Grade 5.A Grade 8.SC Grade
Roof Surface 3 Sheet Metal	Bath(s) Style 2 Typical Bath(s)	3.C Grade 6.AA Grade 9.Same
1.Asphalt 4.Composit 7.SS	1.Modern 4.Obsolete 7.	SQFT (Footprint) 952
2.Slate 5.Wood 8.	2.Typical 5. 8.	Condition 4 Average
3.Metal 6.Roll Roo 9.	3.Old Type 6. 9.None	1.Poor 4.Avg 7.V G
SF Masonry Trim 0	# Rooms 5	2.Fair 5.Avg+ 8.Exc
Solar Voltaic 0	# Bedrooms 3	3.Avg- 6.Good 9.Same
OPEN-4-CUSTOM 0	# Full Baths 1	Phys. % Good 0%
Year Built 2022	# Half Baths 1	Funct. % Good 100%
Year Remodeled 0	# Addn Fixtures 0	Functional Code 9 None
Foundation 5 Concrete Slab	# Fireplaces 0	1.Incomp 4.Delap 7.No Power
1.Concrete 4.Wood 7.		2.O-Built 5.Bsmt 8.None/Part
2.C Block 5.Slab 8.		3.Damage 6.Common 9.None
3.Br/Stone 6.Piers 9.		Econ. % Good 100%
Basement 9 No Basement		Economic Code None
1.1/4 Bmt 4.Full Bmt 7.		0.None 3.No Power 7.
2.1/2 Bmt 5.None 8.		1.Location 4.General 8.
3.3/4 Bmt 6. 9.None		2.Encroach 9.None 9.
Bsmt Gar # Cars 0		Entrance Code 5 Estimate
Wet Basement 0		1.Interior 4.Vacant 7.
1.Dry 4. 7.		2.General 5.Estimate 8.
2.Damp 5. 8.		3.Inform 6.Reviewed 9.
3.Wet 6. 9.		Information Code 5 Estimate
		1.Owner 4.Agent 7.
		2.Relative 5.Estimate 8.
		3.Tenant 6.Other 9.

03-38-01

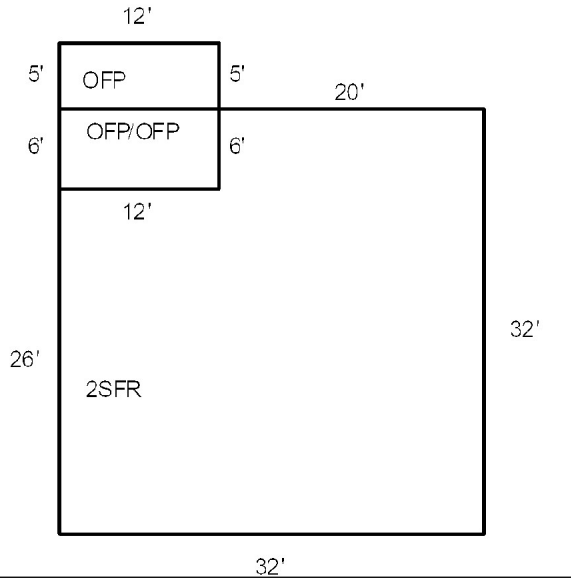

Date Inspected 1/02/2024

Additions, Outbuildings & Improvements

Type	Year	Units	Grade	Cond	Phys.	Funct.	Sound Value	
24 Frame Shed	1970	432	3 100	3	0 %	100 %		1.One Story Fram
21 Open Frame	0	204	0 0	0	0 %	100 %		2.Two Story Fram
					%	%		3.Three Story Fr
					%	%		4.1 & 1/2 Story
					%	%		5.1 & 3/4 Story
					%	%		6.2 & 1/2 Story
					%	%		21.Open Frame Por
					%	%		22.Encl Frame Por
					%	%		23.Frame Garage
					%	%		24.Frame Shed
					%	%		25.Frame Bay Wind
					%	%		26.1SFr Overhang
					%	%		27.Unfin Basement
					%	%		28.Unfinished Att
					%	%		29.Finished Attic

