

Kimball, Maydean
154 Hanscom Road
Benton ME 04901

B3482P272

Inspection Witnessed By:

X

Date

No./Date	Description	Date Insp.

Notes:

Flood zone 1- 5 reduction
1/24 - GL EP, POSTED NO TRESPASS, EST ALL DATA,
EXTERIOR WALLS ARE 50% WOOD 50% VINYL

New Sharon

Property Data			Assessment Record																																																																																																																																																																																																												
Neighborhood 4 NBHD 4			Year	Land	Buildings	Exempt	Total																																																																																																																																																																																																								
Tree Growth Year 0			2011	24,170	36,510	10,000	50,680																																																																																																																																																																																																								
1ST MORTGAGE 0			2012	24,170	36,510	10,000	50,680																																																																																																																																																																																																								
2ND MORTGAGE 0			2013	24,170	36,510	0	60,680																																																																																																																																																																																																								
Zone/Land Use 1 New Sharon all			2014	24,170	36,510	0	60,680																																																																																																																																																																																																								
Secondary Zone			2015	24,170	36,510	0	60,680																																																																																																																																																																																																								
Topography			2016	24,170	36,510	0	60,680																																																																																																																																																																																																								
1.Level 4.Below St 7.LevelBog			2017	24,170	36,510	0	60,680																																																																																																																																																																																																								
2.Rolling 5.Low 8.			2018	24,170	36,510	0	60,680																																																																																																																																																																																																								
3.Above St 6.Swampy 9.			2019	24,170	36,510	0	60,680																																																																																																																																																																																																								
Utilities			2020	24,170	36,510	0	60,680																																																																																																																																																																																																								
1.Public 4.Dr Well 7.Cesspool			2021	24,170	36,510	0	60,680																																																																																																																																																																																																								
2.Water 5.Dug Well 8.			2022	24,170	36,510	0	60,680																																																																																																																																																																																																								
3.Sewer 6.Septic 9.Non			2024	39,630	98,510	0	138,140																																																																																																																																																																																																								
Street																																																																																																																																																																																																															
1.Paved 4.Proposed																																																																																																																																																																																																															
2.Semi Imp 5.R/O/W																																																																																																																																																																																																															
3.Gravel 6. Non																																																																																																																																																																																																															
TG PLAN YEAR 0			<table border="1"> <thead> <tr> <th rowspan="2">Front Foot</th> <th rowspan="2">Type</th> <th colspan="2">Effective</th> <th colspan="2">Influence</th> <th rowspan="2">Influence Codes</th> </tr> <tr> <th>Frontage</th> <th>Depth</th> <th>Factor</th> <th>Code</th> </tr> </thead> <tbody> <tr> <td>11.Com-Site</td> <td> </td> <td> </td> <td> </td> <td>%</td> <td> </td> <td>1.Unimproved</td> </tr> <tr> <td>12.Ind-Site</td> <td> </td> <td> </td> <td> </td> <td>%</td> <td> </td> <td>2.Excess Frtg</td> </tr> <tr> <td>13.Res-Site PR</td> <td> </td> <td> </td> <td> </td> <td>%</td> <td> </td> <td>3.Topography</td> </tr> <tr> <td>14.Res-Site DR</td> <td> </td> <td> </td> <td> </td> <td>%</td> <td> </td> <td>4.Size/Shape</td> </tr> <tr> <td>15.Res-Site RMT</td> <td> </td> <td> </td> <td> </td> <td>%</td> <td> </td> <td>5.Access</td> </tr> <tr> <td> </td> <td> </td> <td> </td> <td> </td> <td>%</td> <td> </td> <td>6.Restriction</td> </tr> <tr> <td> </td> <td> </td> <td> </td> <td> </td> <td>%</td> <td> </td> <td>7.Open Space</td> </tr> <tr> <td> </td> <td> </td> <td> </td> <td> </td> <td>%</td> <td> </td> <td>8.View/Environ</td> </tr> <tr> <td> </td> <td> </td> <td> </td> <td> </td> <td>%</td> <td> </td> <td>9.Fract Share</td> </tr> <tr> <td> </td> <td> </td> <td> </td> <td> </td> <td>%</td> <td> </td> <td>Acres</td> </tr> <tr> <td> </td> <td> </td> <td> </td> <td> </td> <td>%</td> <td> </td> <td>30.Rear Land >10</td> </tr> <tr> <td> </td> <td> </td> <td> </td> <td> </td> <td>%</td> <td> </td> <td>31.Tillable</td> </tr> <tr> <td> </td> <td> </td> <td> </td> <td> </td> <td>%</td> <td> </td> <td>32.Pasture</td> </tr> <tr> <td> </td> <td> </td> <td> </td> <td> </td> <td>%</td> <td> </td> <td>33.Orchard</td> </tr> <tr> <td> </td> <td> </td> <td> </td> <td> </td> <td>%</td> <td> </td> <td>34.Softwood F&O</td> </tr> <tr> <td> </td> <td> </td> <td> </td> <td> </td> <td>%</td> <td> </td> <td>35.Mixed Wood F&O</td> </tr> <tr> <td> </td> <td> </td> <td> </td> <td> </td> <td>%</td> <td> </td> <td>36.Hardwood F&O</td> </tr> <tr> <td> </td> <td> </td> <td> </td> <td> </td> <td>%</td> <td> </td> <td>37.Softwood TG</td> </tr> <tr> <td> </td> <td> </td> <td> </td> <td> </td> <td>%</td> <td> </td> <td>38.Mixed Wood TG</td> </tr> <tr> <td> </td> <td> </td> <td> </td> <td> </td> <td>%</td> <td> </td> <td>39.Hardwood TG</td> </tr> <tr> <td> </td> <td> </td> <td> </td> <td> </td> <td>%</td> <td> </td> <td>40.Wasteland</td> </tr> <tr> <td> </td> <td> </td> <td> </td> <td> </td> <td>%</td> <td> </td> <td>41.Open Space</td> </tr> <tr> <td> </td> <td> </td> <td> </td> <td> </td> <td>%</td> <td> </td> <td>42.Mobile Home Si</td> </tr> <tr> <td> </td> <td> </td> <td> </td> <td> </td> <td>%</td> <td> </td> <td>43.Condo Site</td> </tr> <tr> <td> </td> <td> </td> <td> </td> <td> </td> <td>%</td> <td> </td> <td>44.Lot Improvemen</td> </tr> <tr> <td> </td> <td> </td> <td> </td> <td> </td> <td>%</td> <td> </td> <td>45.Subdivision Lo</td> </tr> <tr> <td> </td> <td> </td> <td> </td> <td> </td> <td>%</td> <td> </td> <td>46.Golf Course</td> </tr> </tbody> </table>					Front Foot	Type	Effective		Influence		Influence Codes	Frontage	Depth	Factor	Code	11.Com-Site				%		1.Unimproved	12.Ind-Site				%		2.Excess Frtg	13.Res-Site PR				%		3.Topography	14.Res-Site DR				%		4.Size/Shape	15.Res-Site RMT				%		5.Access					%		6.Restriction					%		7.Open Space					%		8.View/Environ					%		9.Fract Share					%		Acres					%		30.Rear Land >10					%		31.Tillable					%		32.Pasture					%		33.Orchard					%		34.Softwood F&O					%		35.Mixed Wood F&O					%		36.Hardwood F&O					%		37.Softwood TG					%		38.Mixed Wood TG					%		39.Hardwood TG					%		40.Wasteland					%		41.Open Space					%		42.Mobile Home Si					%		43.Condo Site					%		44.Lot Improvemen					%		45.Subdivision Lo					%		46.Golf Course
Front Foot	Type	Effective								Influence		Influence Codes																																																																																																																																																																																																			
		Frontage	Depth	Factor	Code																																																																																																																																																																																																										
11.Com-Site				%		1.Unimproved																																																																																																																																																																																																									
12.Ind-Site				%		2.Excess Frtg																																																																																																																																																																																																									
13.Res-Site PR				%		3.Topography																																																																																																																																																																																																									
14.Res-Site DR				%		4.Size/Shape																																																																																																																																																																																																									
15.Res-Site RMT				%		5.Access																																																																																																																																																																																																									
				%		6.Restriction																																																																																																																																																																																																									
				%		7.Open Space																																																																																																																																																																																																									
				%		8.View/Environ																																																																																																																																																																																																									
				%		9.Fract Share																																																																																																																																																																																																									
				%		Acres																																																																																																																																																																																																									
				%		30.Rear Land >10																																																																																																																																																																																																									
				%		31.Tillable																																																																																																																																																																																																									
				%		32.Pasture																																																																																																																																																																																																									
				%		33.Orchard																																																																																																																																																																																																									
				%		34.Softwood F&O																																																																																																																																																																																																									
				%		35.Mixed Wood F&O																																																																																																																																																																																																									
				%		36.Hardwood F&O																																																																																																																																																																																																									
				%		37.Softwood TG																																																																																																																																																																																																									
				%		38.Mixed Wood TG																																																																																																																																																																																																									
				%		39.Hardwood TG																																																																																																																																																																																																									
				%		40.Wasteland																																																																																																																																																																																																									
				%		41.Open Space																																																																																																																																																																																																									
				%		42.Mobile Home Si																																																																																																																																																																																																									
				%		43.Condo Site																																																																																																																																																																																																									
				%		44.Lot Improvemen																																																																																																																																																																																																									
				%		45.Subdivision Lo																																																																																																																																																																																																									
				%		46.Golf Course																																																																																																																																																																																																									
Sale Data			<table border="1"> <thead> <tr> <th rowspan="2">Square Foot</th> <th rowspan="2">Type</th> <th colspan="2">Square Feet</th> <th rowspan="2">Acres</th> <th rowspan="2">Sites</th> </tr> <tr> <th> </th> <th> </th> </tr> </thead> <tbody> <tr> <td>16.Not Used</td> <td> </td> <td> </td> <td> </td> <td>%</td> <td> </td> </tr> <tr> <td>17.Not Used</td> <td> </td> <td> </td> <td> </td> <td>%</td> <td> </td> </tr> <tr> <td>18.Not Used</td> <td> </td> <td> </td> <td> </td> <td>%</td> <td> </td> </tr> <tr> <td>19.Not Used</td> <td> </td> <td> </td> <td> </td> <td>%</td> <td> </td> </tr> <tr> <td>20.Residential-Si</td> <td> </td> <td> </td> <td> </td> <td>%</td> <td> </td> </tr> <tr> <td colspan="2">Fract. Acre</td> <td colspan="4">Acres/Sites</td> </tr> <tr> <td>21.Homesite (Frac</td> <td>49</td> <td>1.00</td> <td>100</td> <td>%</td> <td>0</td> </tr> <tr> <td>22.Baslot (Frac</td> <td>28</td> <td>4.00</td> <td>100</td> <td>%</td> <td>0</td> </tr> <tr> <td>23.Misc (Frac)</td> <td>54</td> <td>2.70</td> <td>90</td> <td>%</td> <td>3</td> </tr> <tr> <td colspan="2">Acres</td> <td colspan="4"> </td> </tr> <tr> <td>24.Homesite</td> <td> </td> <td> </td> <td> </td> <td>%</td> <td> </td> </tr> <tr> <td>25.Baslot</td> <td> </td> <td> </td> <td> </td> <td>%</td> <td> </td> </tr> <tr> <td>26.Not Used</td> <td> </td> <td> </td> <td> </td> <td>%</td> <td> </td> </tr> <tr> <td>27.Not Used</td> <td> </td> <td> </td> <td> </td> <td>%</td> <td> </td> </tr> <tr> <td>28.Rear Land <5</td> <td colspan="4"> </td> <td> </td> </tr> <tr> <td>29.Rear Land 5-10</td> <td colspan="4"> </td> <td> </td> </tr> <tr> <td colspan="3">Financing</td> <td colspan="5"> Total Acreage 7.70 </td> </tr> <tr> <td colspan="3">1.Convent 4.Seller 7.</td> <td colspan="5"> </td> </tr> <tr> <td colspan="3">2.FHA/VA 5.Private 8.</td> <td colspan="5"> </td> </tr> <tr> <td colspan="3">3.Assumed 6.Cash 9.Unknown</td> <td colspan="5"> </td> </tr> <tr> <td colspan="3">Validity</td> <td colspan="5"> </td> </tr> <tr> <td colspan="3">1.Valid 4.Split 7.Renovate</td> <td colspan="5"> </td> </tr> <tr> <td colspan="3">2.Related 5.Partial 8.Other</td> <td colspan="5"> </td> </tr> <tr> <td colspan="3">3.Distress 6.Exempt 9.</td> <td colspan="5"> </td> </tr> <tr> <td colspan="3">Verified</td> <td colspan="5"> </td> </tr> <tr> <td colspan="3">1.Buyer 4.Agent 7.Family</td> <td colspan="5"> </td> </tr> <tr> <td colspan="3">2.Seller 5.Pub Rec 8.Other</td> <td colspan="5"> </td> </tr> <tr> <td colspan="3">3.Lender 6.MLS 9.</td> <td colspan="5"> </td> </tr> </tbody> </table>					Square Foot	Type	Square Feet		Acres	Sites			16.Not Used				%		17.Not Used				%		18.Not Used				%		19.Not Used				%		20.Residential-Si				%		Fract. Acre		Acres/Sites				21.Homesite (Frac	49	1.00	100	%	0	22.Baslot (Frac	28	4.00	100	%	0	23.Misc (Frac)	54	2.70	90	%	3	Acres						24.Homesite				%		25.Baslot				%		26.Not Used				%		27.Not Used				%		28.Rear Land <5						29.Rear Land 5-10						Financing			Total Acreage 7.70					1.Convent 4.Seller 7.								2.FHA/VA 5.Private 8.								3.Assumed 6.Cash 9.Unknown								Validity								1.Valid 4.Split 7.Renovate								2.Related 5.Partial 8.Other								3.Distress 6.Exempt 9.								Verified								1.Buyer 4.Agent 7.Family								2.Seller 5.Pub Rec 8.Other								3.Lender 6.MLS 9.							
Square Foot	Type	Square Feet		Acres	Sites																																																																																																																																																																																																										
16.Not Used				%																																																																																																																																																																																																											
17.Not Used				%																																																																																																																																																																																																											
18.Not Used				%																																																																																																																																																																																																											
19.Not Used				%																																																																																																																																																																																																											
20.Residential-Si				%																																																																																																																																																																																																											
Fract. Acre		Acres/Sites																																																																																																																																																																																																													
21.Homesite (Frac	49	1.00	100	%	0																																																																																																																																																																																																										
22.Baslot (Frac	28	4.00	100	%	0																																																																																																																																																																																																										
23.Misc (Frac)	54	2.70	90	%	3																																																																																																																																																																																																										
Acres																																																																																																																																																																																																															
24.Homesite				%																																																																																																																																																																																																											
25.Baslot				%																																																																																																																																																																																																											
26.Not Used				%																																																																																																																																																																																																											
27.Not Used				%																																																																																																																																																																																																											
28.Rear Land <5																																																																																																																																																																																																															
29.Rear Land 5-10																																																																																																																																																																																																															
Financing			Total Acreage 7.70																																																																																																																																																																																																												
1.Convent 4.Seller 7.																																																																																																																																																																																																															
2.FHA/VA 5.Private 8.																																																																																																																																																																																																															
3.Assumed 6.Cash 9.Unknown																																																																																																																																																																																																															
Validity																																																																																																																																																																																																															
1.Valid 4.Split 7.Renovate																																																																																																																																																																																																															
2.Related 5.Partial 8.Other																																																																																																																																																																																																															
3.Distress 6.Exempt 9.																																																																																																																																																																																																															
Verified																																																																																																																																																																																																															
1.Buyer 4.Agent 7.Family																																																																																																																																																																																																															
2.Seller 5.Pub Rec 8.Other																																																																																																																																																																																																															
3.Lender 6.MLS 9.																																																																																																																																																																																																															

New Sharon

Map Lot 04-17

Account 461

Location 659 Farmington Falls Road

Card 1

Of 1

10/16/2024

Building Style 4 Cape Cod	SF Bsmt Living 0	Layout 1 Typical
1.Conv. 5.Garrison 9.Other	Fin Bsmt Grade 0 0	1.Typical 4. 7.
2.Ranch 6.Split 10.Gar/Apt	Secondary Heat 0	2.Inadeq 5. 8.
3.R Ranch 7.Contemp 11.Cottage	Heat Type 100% 1 Hot Water BB	3.Poor 6. 9.
4.Cape 8.Log 12.Dblewid	1.HWBB 5.FWA 9.No Heat	Attic 9 None
Dwelling Units 1	2.HWCI 6.GravWA 10.Radiant	1.1/4 Fin 4.Full Fin 7.
Other Units 0	3.H Pump 7.Electric 11.	2.1/2 Fin 5.FI/Stair 8.
Stories 5 One & 3/4 Story	4.Steam 8.FI/Wall 12.	3.3/4 Fin 6. 9.None
1.1 4.1.5 7.	Cool Type 0% 9 None	Insulation 1 Full
2.2 5.1.75 8.	1.Refrig 4.W&C Air 7.	1.Full 4.Minimal 7.
3.3 6.2.5 9.	2.Evapor 5. 8.	2.Heavy 5. 8.
Exterior Walls 1 Wood Siding	3.H Pump 6. 9.None	3.Capped 6. 9.None
1.Wood 5.Stucco 9.Other	Kitchen Style 3 Old Style	Unfinished % 0%
2.Vin/Al 6.Brick 10.Cement	1.Modern 4.Obsolete 7.	Grade & Factor 3 Average 100%
3.Compos. 7.Stone 11.	2.Typical 5. 8.	1.E Grade 4.B Grade 7.
4.Asbestos 8.Concrete 12.	3.Old Type 6. 9.None	2.D Grade 5.A Grade 8.SC Grade
Roof Surface 1 Asphalt Shingles	Bath(s) Style 3 Old Style	3.C Grade 6.AA Grade 9.Same
1.Asphalt 4.Composit 7.SS	1.Modern 4.Obsolete 7.	SQFT (Footprint) 1360
2.Slate 5.Wood 8.	2.Typical 5. 8.	Condition 1 Poor
3.Metal 6.Roll Roo 9.	3.Old Type 6. 9.None	1.Poor 4.Avg 7.V G
SF Masonry Trim 0	# Rooms 7	2.Fair 5.Avg+ 8.Exc
Solar Voltaic 0	# Bedrooms 3	3.Avg- 6.Good 9.Same
OPEN-4-CUSTOM 0	# Full Baths 1	Phys. % Good 0%
Year Built 1880	# Half Baths 0	Funct. % Good 100%
Year Remodeled 0	# Addn Fixtures 0	Functional Code 9 None
Foundation 3 Brick &/or Stone	# Fireplaces 1	1.Incomp 4.Delap 7.No Power
1.Concrete 4.Wood 7.		2.O-Built 5.Bsmt 8.No Power
2.C Block 5.Slab 8.		3.Damage 6.Common 9.No Power
3.Br/Stone 6.Piers 9.		Econ. % Good 100%
Basement 4 Full Basement		Economic Code None
1.1/4 Bmt 4.Full Bmt 7.		0.None 3.No Power 7.
2.1/2 Bmt 5.None 8.		1.Location 4.General 8.
3.3/4 Bmt 6. 9.None		2.Encroach 9.None 9.
Bsmt Gar # Cars 0		Entrance Code 5 Quarter Reviewed
Wet Basement 1 Dry Basement		1.Interior 4.Vacant 7.
1.Dry 4. 7.		2.Exterior 5.Estimate 8.
2.Damp 5. 8.		3.Informal 6.Reviewed 9.
3.Wet 6. 9.		Information Code 0
		1.Owner 4.Agent 7.
		2.Relative 5.Estimate 8.
		3.Tenant 6.Other 9.

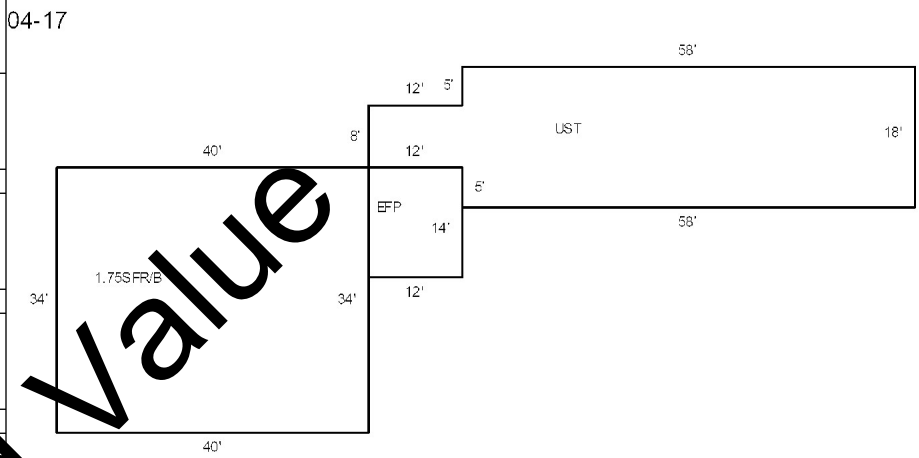

Date Inspected 1/03/2024

Additions, Outbuildings & Improvements

Type	Year	Units	Grade	Cond	Phys.	Funct.	Sound Value
83 Barn/Loft	0	1800	3 100	1	0 %	100 %	
22 Encl Frame Porch	0	168	0 0	0	0 %	100 %	
19 Utility Storage	0	1140	0 0	0	0 %	100 %	
					%	%	
					%	%	
					%	%	
					%	%	
					%	%	
					%	%	
					%	%	
					%	%	
					%	%	
					%	%	
					%	%	
					%	%	
					%	%	
					%	%	
					%	%	
					%	%	
					%	%	
					%	%	

Proposed Value