

Bergeron, Gary
Bergeron, Genoria
61 VIENNA RD
NEW SHARON ME 04955

B474P105

Inspection Witnessed By:

No./Date	Description	Date Insp.
X		

Notes:

Flood Plain 40%
 3/24 - GL EF, EST IF
 7/24 - MK CALLBACK EA, IA. EST AYB EARLY 1800'S/LATE 1700'S RENO EST 1984. NEWER HALF CONC B CRAWL. K1 MONITOR HEAT. WS + HP BACKUP. LAMIN/CARPET. DRYWALL. OF = TOILET + VANITY. WATERFRONT + VIEW CROWELL POND. SEMI BUSY RT41 NOISE. 2 WOODSTOVES, CROWELL POND WF

New Sharon

Property Data			Assessment Record																																																																																																																																																																																																												
Neighborhood			Year	Land	Buildings	Exempt	Total																																																																																																																																																																																																								
Tree Growth Year 0			2011	45,000	105,110	16,000	134,110																																																																																																																																																																																																								
1ST MORTGAGE 0			2012	45,000	105,110	16,000	134,110																																																																																																																																																																																																								
2ND MORTGAGE 0			2013	45,000	105,110	16,000	134,110																																																																																																																																																																																																								
Zone/Land Use 1 New Sharon all			2014	45,000	105,110	16,000	134,110																																																																																																																																																																																																								
Secondary Zone			2015	45,000	105,110	16,000	134,110																																																																																																																																																																																																								
Topography			2016	45,000	105,110	21,000	129,110																																																																																																																																																																																																								
1.Level 4.Below St 7.LevelBog			2017	45,000	105,110	26,000	124,110																																																																																																																																																																																																								
2.Rolling 5.Low 8.			2018	45,000	105,110	26,000	124,110																																																																																																																																																																																																								
3.Above St 6.Swampy 9.			2019	45,000	105,110	26,000	124,110																																																																																																																																																																																																								
Utilities 8			2020	45,000	105,110	31,000	119,110																																																																																																																																																																																																								
1.Public 4.Dr Well 7.Cesspool			2021	45,000	105,110	31,000	119,110																																																																																																																																																																																																								
2.Water 5.Dug Well 8.			2022	45,000	105,110	27,590	122,520																																																																																																																																																																																																								
3.Sewer 6.Septic 9.Non			2024	125,880	111,070	31,000	205,950																																																																																																																																																																																																								
Street																																																																																																																																																																																																															
1.Paved 4.Proposed			Land Data <table border="1"> <thead> <tr> <th rowspan="2">Front Foot</th> <th rowspan="2">Type</th> <th colspan="2">Effective</th> <th colspan="2">Influence</th> <th rowspan="2">Influence Codes</th> </tr> <tr> <th>Frontage</th> <th>Depth</th> <th>Factor</th> <th>Code</th> </tr> </thead> <tbody> <tr> <td>11.Com-Site</td> <td></td> <td></td> <td></td> <td>%</td> <td></td> <td>1.Unimproved</td> </tr> <tr> <td>12.Ind-Site</td> <td></td> <td></td> <td></td> <td>%</td> <td></td> <td>2.Excess Frtg</td> </tr> <tr> <td>13.Res-Site PR</td> <td></td> <td></td> <td></td> <td>%</td> <td></td> <td>3.Topography</td> </tr> <tr> <td>14.Res-Site DR</td> <td></td> <td></td> <td></td> <td>%</td> <td></td> <td>4.Size/Shape</td> </tr> <tr> <td>15.Res-Site RMT</td> <td></td> <td></td> <td></td> <td>%</td> <td></td> <td>5.Access</td> </tr> <tr> <td></td> <td></td> <td></td> <td></td> <td>%</td> <td></td> <td>6.Restriction</td> </tr> <tr> <td></td> <td></td> <td></td> <td></td> <td>%</td> <td></td> <td>7.Open Space</td> </tr> <tr> <td></td> <td></td> <td></td> <td></td> <td>%</td> <td></td> <td>8.View/Environ</td> </tr> <tr> <td></td> <td></td> <td></td> <td></td> <td>%</td> <td></td> <td>9.Fract Share</td> </tr> <tr> <td></td> <td></td> <td></td> <td></td> <td>%</td> <td></td> <td>Acres</td> </tr> <tr> <td></td> <td></td> <td></td> <td></td> <td>%</td> <td></td> <td>30.Rear Land >10</td> </tr> <tr> <td></td> <td></td> <td></td> <td></td> <td>%</td> <td></td> <td>31.Tillable</td> </tr> <tr> <td></td> <td></td> <td></td> <td></td> <td>%</td> <td></td> <td>32.Pasture</td> </tr> <tr> <td></td> <td></td> <td></td> <td></td> <td>%</td> <td></td> <td>33.Orchard</td> </tr> <tr> <td></td> <td></td> <td></td> <td></td> <td>%</td> <td></td> <td>34.Softwood F&O</td> </tr> <tr> <td></td> <td></td> <td></td> <td></td> <td>%</td> <td></td> <td>35.Mixed Wood F&O</td> </tr> <tr> <td></td> <td></td> <td></td> <td></td> <td>%</td> <td></td> <td>36.Hardwood F&O</td> </tr> <tr> <td></td> <td></td> <td></td> <td></td> <td>%</td> <td></td> <td>37.Softwood TG</td> </tr> <tr> <td></td> <td></td> <td></td> <td></td> <td>%</td> <td></td> <td>38.Mixed Wood TG</td> </tr> <tr> <td></td> <td></td> <td></td> <td></td> <td>%</td> <td></td> <td>39.Hardwood TG</td> </tr> <tr> <td></td> <td></td> <td></td> <td></td> <td>%</td> <td></td> <td>40.Wasteland</td> </tr> <tr> <td></td> <td></td> <td></td> <td></td> <td>%</td> <td></td> <td>41.Open Space</td> </tr> <tr> <td></td> <td></td> <td></td> <td></td> <td>%</td> <td></td> <td>42.Mobile Home Si</td> </tr> <tr> <td></td> <td></td> <td></td> <td></td> <td>%</td> <td></td> <td>43.Condo Site</td> </tr> <tr> <td></td> <td></td> <td></td> <td></td> <td>%</td> <td></td> <td>44.Lot Improvemen</td> </tr> <tr> <td></td> <td></td> <td></td> <td></td> <td>%</td> <td></td> <td>45.Subdivision Lo</td> </tr> <tr> <td></td> <td></td> <td></td> <td></td> <td>%</td> <td></td> <td>46.Golf Course</td> </tr> </tbody> </table>					Front Foot	Type	Effective		Influence		Influence Codes	Frontage	Depth	Factor	Code	11.Com-Site				%		1.Unimproved	12.Ind-Site				%		2.Excess Frtg	13.Res-Site PR				%		3.Topography	14.Res-Site DR				%		4.Size/Shape	15.Res-Site RMT				%		5.Access					%		6.Restriction					%		7.Open Space					%		8.View/Environ					%		9.Fract Share					%		Acres					%		30.Rear Land >10					%		31.Tillable					%		32.Pasture					%		33.Orchard					%		34.Softwood F&O					%		35.Mixed Wood F&O					%		36.Hardwood F&O					%		37.Softwood TG					%		38.Mixed Wood TG					%		39.Hardwood TG					%		40.Wasteland					%		41.Open Space					%		42.Mobile Home Si					%		43.Condo Site					%		44.Lot Improvemen					%		45.Subdivision Lo					%		46.Golf Course
Front Foot	Type	Effective								Influence		Influence Codes																																																																																																																																																																																																			
		Frontage						Depth	Factor	Code																																																																																																																																																																																																					
11.Com-Site				%		1.Unimproved																																																																																																																																																																																																									
12.Ind-Site				%		2.Excess Frtg																																																																																																																																																																																																									
13.Res-Site PR				%		3.Topography																																																																																																																																																																																																									
14.Res-Site DR				%		4.Size/Shape																																																																																																																																																																																																									
15.Res-Site RMT				%		5.Access																																																																																																																																																																																																									
				%		6.Restriction																																																																																																																																																																																																									
				%		7.Open Space																																																																																																																																																																																																									
				%		8.View/Environ																																																																																																																																																																																																									
				%		9.Fract Share																																																																																																																																																																																																									
				%		Acres																																																																																																																																																																																																									
				%		30.Rear Land >10																																																																																																																																																																																																									
				%		31.Tillable																																																																																																																																																																																																									
				%		32.Pasture																																																																																																																																																																																																									
				%		33.Orchard																																																																																																																																																																																																									
				%		34.Softwood F&O																																																																																																																																																																																																									
				%		35.Mixed Wood F&O																																																																																																																																																																																																									
				%		36.Hardwood F&O																																																																																																																																																																																																									
				%		37.Softwood TG																																																																																																																																																																																																									
				%		38.Mixed Wood TG																																																																																																																																																																																																									
				%		39.Hardwood TG																																																																																																																																																																																																									
				%		40.Wasteland																																																																																																																																																																																																									
				%		41.Open Space																																																																																																																																																																																																									
				%		42.Mobile Home Si																																																																																																																																																																																																									
				%		43.Condo Site																																																																																																																																																																																																									
				%		44.Lot Improvemen																																																																																																																																																																																																									
				%		45.Subdivision Lo																																																																																																																																																																																																									
				%		46.Golf Course																																																																																																																																																																																																									
TG PLAN YEAR 0			Square Foot																																																																																																																																																																																																												
Tif District # 0			16.Not Used																																																																																																																																																																																																												
			17.Not Used																																																																																																																																																																																																												
			18.Not Used																																																																																																																																																																																																												
			19.Not Used																																																																																																																																																																																																												
			20.Residential-Si																																																																																																																																																																																																												
Sale Data			Fract. Acre																																																																																																																																																																																																												
Sale Date			21.Homesite (Frac																																																																																																																																																																																																												
Price			22.Basemat (Frac																																																																																																																																																																																																												
Sale Type			23.Misc (Frac)																																																																																																																																																																																																												
1.Land 4.Mobile 7.C/I L&B			Acres																																																																																																																																																																																																												
2.L&B 5.Other 8.			24.Homesite																																																																																																																																																																																																												
3.Bunding 6.C/I Land 9.			25.Basemat																																																																																																																																																																																																												
Financing			26.Not Used																																																																																																																																																																																																												
1.Convent 4.Seller 7.			27.Not Used																																																																																																																																																																																																												
2.FHA/VA 5.Private 8.			28.Rear Land <5																																																																																																																																																																																																												
3.Assumed 6.Cash 9.Unknown			29.Rear Land 5-10																																																																																																																																																																																																												
Validity			Total Acreage 3.80																																																																																																																																																																																																												
1.Valid 4.Split 7.Renovate																																																																																																																																																																																																															
2.Related 5.Partial 8.Other																																																																																																																																																																																																															
3.Distress 6.Exempt 9.																																																																																																																																																																																																															
Verified																																																																																																																																																																																																															
1.Buyer 4.Agent 7.Family																																																																																																																																																																																																															
2.Seller 5.Pub Rec 8.Other																																																																																																																																																																																																															
3.Lender 6.MLS 9.																																																																																																																																																																																																															

New Sharon

Map Lot 02-02

Account 69

Location 61 Vienna Road

Card 1 Of 1 10/16/2024

Building Style 5 Garrison/Colonial	SF Bsmt Living 0	Layout 1 Typical
1.Conv. 5.Garrison 9.Other	Fin Bsmt Grade 0 0	1.Typical 4. 7.
2.Ranch 6.Split 10.Gar/Apt	Secondary Heat 0	2.Inadeq 5. 8.
3.R Ranch 7.Contemp 11.Cottage	Heat Type 100% 8 Floor/Wall Unit	3.Poor 6. 9.
4.Cape 8.Log 12.Dblewid	1.HWBB 5.FWA 9.No Heat	Attic 9 None
Dwelling Units 1	2.HWCI 6.GravWA 10.Radiant	1.1/4 Fin 4.Full Fin 7.
Other Units 0	3.H Pump 7.Electric 11.	2.1/2 Fin 5.FI/Stair 8.
Stories 2 Two Story	4.Steam 8.FI/Wall 12.	3.3/4 Fin 6. 9.None
1.1 4.1.5 7.	Cool Type 50% 3 Heat Pump	Insulation 1 Full
2.2 5.1.75 8.	1.Refrig 4.W&C Air 7.	1.Full 4.Minimal 7.
3.3 6.2.5 9.	2.Evapor 5. 8.	2.Heavy 5. 8.
Exterior Walls 2 Vinyl/Aluminum	3.H Pump 6. 9.None	3.Capped 6. 9.None
1.Wood 5.Stucco 9.Other	Kitchen Style 2 Typical	Unfinished % 0%
2.Vin/Al 6.Brick 10.Cement	1.Modern 4.Obsolete 7.	Grade & Factor 3 Average 100%
3.Compos. 7.Stone 11.	2.Typical 5. 8.	1.E Grade 4.B Grade 7.
4.Asbestos 8.Concrete 12.	3.Old Type 6. 9.None	2.D Grade 5.A Grade 8.SC Grade
Roof Surface 3 Sheet Metal	Bath(s) Style 2 Typical Bath(s)	3.C Grade 6.AA Grade 9.Same
1.Asphalt 4.Composit 7.SS	1.Modern 4.Obsolete 7.	SQFT (Footprint) 888
2.Slate 5.Wood 8.	2.Typical 5. 8.	Condition 4 Average
3.Metal 6.Roll Roo 9.	3.Old Type 6. 9.None	1.Poor 4.Avg 7.V G
SF Masonry Trim 0	# Rooms 6	2.Fair 5.Avg+ 8.Exc
Solar Voltaic 0	# Bedrooms 3	3.Avg- 6.Good 9.Same
OPEN-4-CUSTOM 0	# Full Baths 1	Phys. % Good 0%
Year Built 1800	# Half Baths 0	Funct. % Good 100%
Year Remodeled 1984	# Addn Fixtures 2	Functional Code 9 None
Foundation 3 Brick &/or Stone	# Fireplaces 0	1.Incomp 4.Delap 7.No Power
1.Concrete 4.Wood 7.		2.O-Built 5.Bsmt 8.No Part
2.C Block 5.Slab 8.		3.Damage 6.Common 9.No
3.Br/Stone 6.Piers 9.		Econ. % Good 100%
Basement 5 Crawl Space		Economic Code None
1.1/4 Bmt 4.Full Bmt 7.		0.None 3.No Power 7.
2.1/2 Bmt 5.None 8.		1.Location 4.General 8.
3.3/4 Bmt 6. 9.None		2.Encroach 9.None 9.
Bsmt Gar # Cars 0		Entrance Code 1 Interior Inspect
Wet Basement 0		1.Interior 4.Vacant 7.
1.Dry 4. 7.		2.Period 5.Estimate 8.
2.Damp 5. 8.		3.Inform 6.Reviewed 9.
3.Wet 6. 9.		Information Code 1 Owner
		1.Owner 4.Agent 7.
		2.Relative 5.Estimate 8.
		3.Tenant 6.Other 9.



Proposed Value

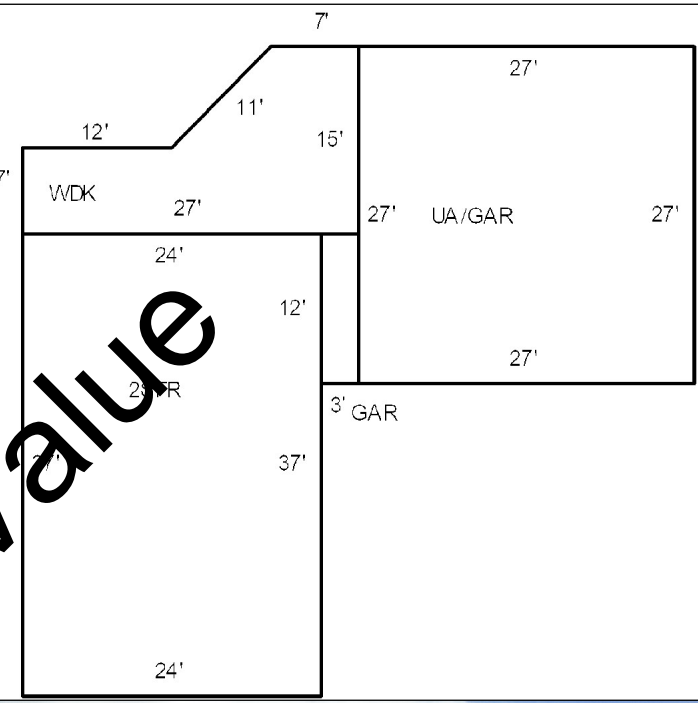

Date Inspected 7/29/2024

Additions, Outbuildings & Improvements

Type	Year	Units	Grade	Cond	Phys.	Funct.	Sound Value
23 Frame Garage	0	765	0 0	0	0 %	100 %	
68 Wood Deck	0	277	0 0	0	0 %	100 %	
28 Unfinished Attic	0	729	0 0	0	0 %	100 %	
					%	%	
					%	%	
					%	%	
					%	%	
					%	%	
					%	%	
					%	%	
					%	%	
					%	%	

