

MCHUGH, OLIVE S. (ESTATE OF)
McHugh, Frances L.
187 MAIN STREET
NEW SHARON ME 04955

B417P412 B4616P206

Property Data			Assessment Record				
Neighborhood 4 NBHD 4			Year	Land	Buildings	Exempt	Total
Tree Growth Year 0			2011	27,600	16,590	10,000	34,190
1ST MORTGAGE 0			2012	27,600	16,590	10,000	34,190
2ND MORTGAGE 0			2013	27,600	16,590	10,000	34,190
Zone/Land Use 1 New Sharon all			2014	27,600	16,590	10,000	34,190
Secondary Zone			2015	27,600	16,590	10,000	34,190
Topography			2016	27,600	16,590	15,000	29,190
1.Level 4.Below St 7.LevelBog			2017	27,600	16,590	20,000	24,190
2.Rolling 5.Low 8.			2018	27,600	16,590	20,000	24,190
3.Above St 6.Swampy 9.			2019	27,600	16,590	20,000	24,190
Utilities			2020	27,600	16,590	0	44,190
1.Public 4.Dr Well 7.Cesspool			2021	27,600	16,590	25,000	19,190
2.Water 5.Dug Well 8.			2022	27,600	16,590	22,250	21,940
3.Sewer 6.Septic 9.Non			2024	37,040	48,150	0	85,190
Street							
1.Paved 4.Proposed							
2.Semi Imp 5.R/O/W							
3.Gravel 6.							

Inspection Witnessed By:

No./Date	Description	Date Insp.
X		

Notes:
Oliver McHugh deceased (7/18/2018) Homestead exemption for 20210 TW
1/24 - LD EF, EST IF

New Sharon

Sale Data		
TG PLAN YEAR	0	
Tif District #	0	
Sale Date		
Price		
Sale Type		
1.Land 4.Mobile 7.C/I L&B		
2.L&B 5.Other 8.		
3.Bundling 6.C/I Land 9.		
Financing		
1.Convent 4.Seller 7.		
2.FHA/VA 5.Private 8.		
3.Assumed 6.Cash 9.Unknown		
Validity		
1.Valid 4.Split 7.Renovate		
2.Related 5.Partial 8.Other		
3.Distress 6.Exempt 9.		
Verified		
1.Buyer 4.Agent 7.Family		
2.Seller 5.Pub Rec 8.Other		
3.Lender 6.MLS 9.		

Land Data						
Front Foot	Type	Effective		Influence		Influence Codes
		Frontage	Depth	Factor	Code	
11.Com-Site				%		1.Unimproved
12.Ind-Site				%		2.Excess Frtg
13.Res-Site PR				%		3.Topography
14.Res-Site DR				%		4.Size/Shape
15.Res-Site RMT				%		5.Access
				%		6.Restriction
				%		7.Open Space
				%		8.View/Environ
				%		9.Fract Share
				%		Acres
				%		30.Rear Land >10
				%		31.Tillable
				%		32.Pasture
				%		33.Orchard
				%		34.Softwood F&O
				%		35.Mixed Wood F&O
				%		36.Hardwood F&O
				%		37.Softwood TG
				%		38.Mixed Wood TG
				%		39.Hardwood TG
				%		40.Wasteland
				%		41.Open Space
				%		42.Mobile Home Si
				%		43.Condo Site
				%		44.Lot Improvemen
				%		45.Subdivision Lo
				%		46.Golf Course
Total Acreage		2.30				

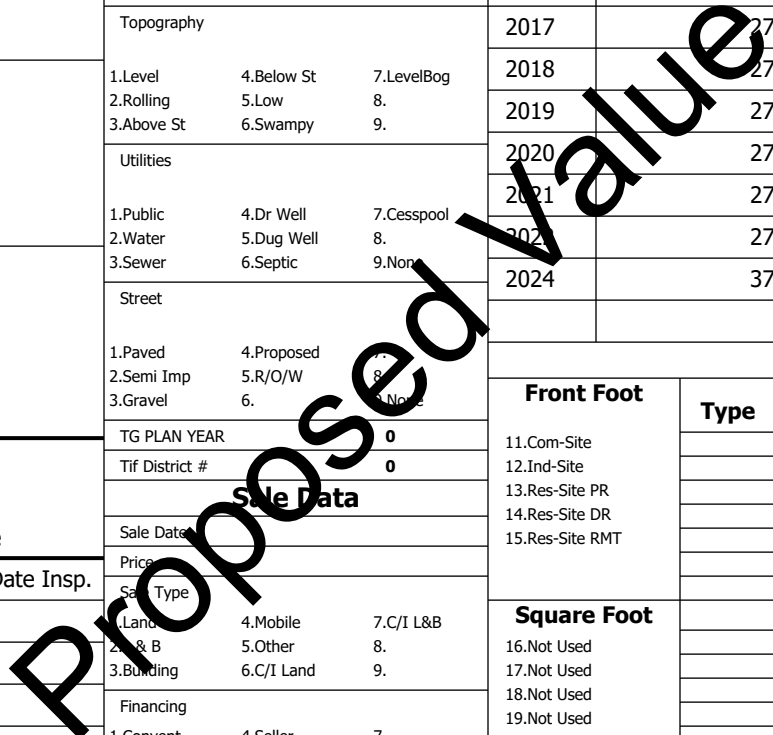

New Sharon

Map Lot 01-40

Account 691

Location 187 MAIN STREET

Card 1 Of 1 10/16/2024

Building Style 2 Ranch	SF Bsmt Living 0	Layout 1 Typical
1.Conv. 5.Garrison 9.Other	Fin Bsmt Grade 0 0	1.Typical 4. 7.
2.Ranch 6.Split 10.Gar/Apt	Secondary Heat 0	2.Inadeq 5. 8.
3.R Ranch 7.Contemp 11.Cottage	Heat Type 100% 5 Forced Warm Air	3.Poor 6. 9.
4.Cape 8.Log 12.Dblewid	1.HWB 5.FWA 9.No Heat	Attic 9 None
Dwelling Units 1	2.HWCI 6.GravWA 10.Radiant	1.1/4 Fin 4.Full Fin 7.
Other Units 0	3.H Pump 7.Electric 11.	2.1/2 Fin 5.FI/Stair 8.
Stories 1 One Story	4.Steam 8.FI/Wall 12.	3.3/4 Fin 6. 9.None
1.1 4.1.5 7.	Cool Type 0% 9 None	Insulation 1 Full
2.2 5.1.75 8.	1.Refrig 4.W&C Air 7.	1.Full 4.Minimal 7.
3.3 6.2.5 9.	2.Evapor 5. 8.	2.Heavy 5. 8.
Exterior Walls 1 Wood Siding	3.H Pump 6. 9.None	3.Capped 6. 9.None
1.Wood 5.Stucco 9.Other	Kitchen Style 2 Typical	Unfinished % 0%
2.Vin/Al 6.Brick 10.Cement	1.Modern 4.Obsolete 7.	Grade & Factor 3 Average 90%
3.Compos. 7.Stone 11.	2.Typical 5. 8.	1.E Grade 4.B Grade 7.
4.Asbestos 8.Concrete 12.	3.Old Type 6. 9.None	2.D Grade 5.A Grade 8.SC Grade
Roof Surface 3 Sheet Metal	Bath(s) Style 2 Typical Bath(s)	3.C Grade 6.AA Grade 9.Same
1.Asphalt 4.Composit 7.SS	1.Modern 4.Obsolete 7.	SQFT (Footprint) 589
2.Slate 5.Wood 8.	2.Typical 5. 8.	Condition 2 Fair
3.Metal 6.Roll Roo 9.	3.Old Type 6. 9.None	1.Poor 4.Avg 7.V G
SF Masonry Trim 0	# Rooms 4	2.Fair 5.Avg+ 8.Exc
Solar Voltaic 0	# Bedrooms 2	3.Avg- 6.Good 9.Same
OPEN-4-CUSTOM 0	# Full Baths 1	Phys. % Good 0%
Year Built 1960	# Half Baths 0	Funct. % Good 100%
Year Remodeled 0	# Addn Fixtures 0	Functional Code 9 None
Foundation 5 Concrete Slab	# Fireplaces 0	1.Incomp 4.Delap 7.No Power
1.Concrete 4.Wood 7.	 <p>TRIO Software A Division of Harris Computer Systems</p>	2.O-Built 5.Bsmt 8.None/Grn
2.C Block 5.Slab 8.		3.Damage 6.Common 9.No
3.Br/Stone 6.Piers 9.		Econ. % Good 100%
Basement 9 No Basement		Economic Code None
1.1/4 Bmt 4.Full Bmt 7.		0.None 3.No Power 7.
2.1/2 Bmt 5.None 8.		1.Location 4.General 8.
3.3/4 Bmt 6. 9.None		2.Encroach 9.None 9.
Bsmt Gar # Cars 0		Entrance Code 9 Information Only
Wet Basement 0		1.Interior 4.Vacant 7.
1.Dry 4. 7.		2.General 5.Estimate 8.
2.Damp 5. 8.	3.Inform 6.Reviewed 9.	
3.Wet 6. 9.	Information Code 1 Owner	
	1.Owner 4.Agent 7.	
	2.Relative 5.Estimate 8.	
	3.Tenant 6.Other 9.	

01-40

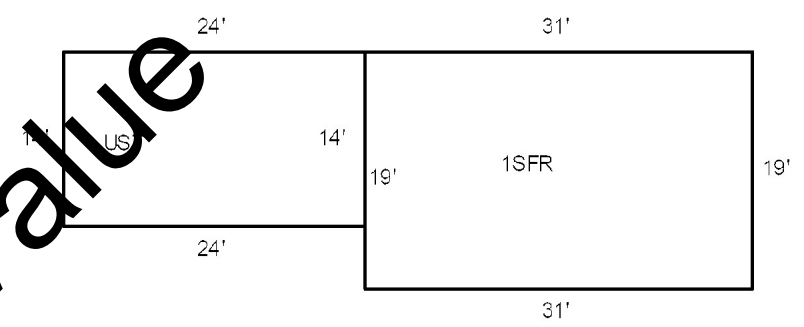

Date Inspected 1/16/2024

Additions, Outbuildings & Improvements

Type	Year	Units	Grade	Cond	Phys.	Funct.	Sound Value
19 Utility Storage	0	336	0 0	0	0 %	100 %	
					%	%	
					%	%	
					%	%	
					%	%	
					%	%	
					%	%	
					%	%	
					%	%	
					%	%	
					%	%	

- 1.One Story Fram
- 2.Two Story Fram
- 3.Three Story Fr
- 4.1 & 1/2 Story
- 5.1 & 3/4 Story
- 6.2 & 1/2 Story
- 21.Open Frame Por
- 22.Encl Frame Por
- 23.Frame Garage
- 24.Frame Shed
- 25.Frame Bay Wind
- 26.1SFr Overhang
- 27.Unfin Basement
- 28.Unfinished Att
- 29.Finished Attic