

Saltmarsh Farms Inc.
284 Main Street
Wilton ME 04294

B3716P343 B4387P145

Previous Owner
Boivin, James
Boivin, Tracy
84 INTERVALE RD
NEW SHARON 04955
Sale Date: 10/22/2021

Inspection Witnessed By:

X Date

No./Date	Description	Date Insp.

Notes:

Owner says acres wrong on 04-45 and 01-36-01. Chagned Trio on 041-36-01 to the correct 2.5 The trio land value was correct.

5/24 - MK EG, IG. CAFE + MARKET DBA: "ROOT DOWN FARM". SMALL INDUST KITCH. EST PAVING + PAT = IREG. EST AYB

New Sharon

Property Data		
Neighborhood	4 NBHD 4	
Tree Growth Year	0	
1ST MORTGAGE	0	
2ND MORTGAGE	0	
Zone/Land Use	1 New Sharon all	
Secondary Zone		
Topography		
1.Level	4.Below St	7.LevelBog
2.Rolling	5.Low	8.
3.Above St	6.Swampy	9.
Utilities		
1.Public	4.Dr Well	7.Cesspool
2.Water	5.Dug Well	8.
3.Sewer	6.Septic	9.Non
Street		
1.Paved	4.Proposed	7.
2.Semi Imp	5.R/O/W	8.
3.Gravel	6.	9.No
TG PLAN YEAR	0	
Tif District #	0	
Sale Data		
Sale Date	10/22/2021	
Price	179,000	
Sale Type	Land & Buildings	
1.Land	4.Mobile	7.C/I L&B
2.L&B	5.Other	8.
3.Bundling	6.C/I Land	9.
Financing	1 Conventional	
1.Convent	4.Seller	7.
2.FHA/VA	5.Private	8.
3.Assumed	6.Cash	9.Unknown
Validity	1 Arms Length Sale	
1.Valid	4.Split	7.Renovate
2.Related	5.Partial	8.Other
3.Distress	6.Exempt	9.
Verified	5 Public Record	
1.Buyer	4.Agent	7.Family
2.Seller	5.Pub Rec	8.Other
3.Lender	6.MLS	9.

Assessment Record				
Year	Land	Buildings	Exempt	Total
2011	28,000	106,230	0	134,230
2012	28,000	100,510	0	128,510
2013	28,000	100,510	0	128,510
2014	28,000	100,510	0	128,510
2015	28,000	100,510	0	128,510
2016	28,000	77,320	0	105,320
2017	28,000	77,320	0	105,320
2018	28,000	77,320	0	105,320
2019	28,000	77,320	0	105,320
2020	28,000	77,320	0	105,320
2021	28,000	77,320	0	105,320
2022	28,000	77,320	0	105,320
2024	45,320	188,590	0	233,910

Land Data						
Front Foot	Type	Effective		Influence		Influence Codes
		Frontage	Depth	Factor	Code	
11.Com-Site				%		1.Unimproved
12.Ind-Site				%		2.Excess Frtg
13.Res-Site PR				%		3.Topography
14.Res-Site DR				%		4.Size/Shape
15.Res-Site RMT				%		5.Access
				%		6.Restriction
				%		7.Open Space
				%		8.View/Environ
				%		9.Fract Share
				%		Acres
				%		30.Rear Land >10
				%		31.Tillable
				%		32.Pasture
				%		33.Orchard
				%		34.Softwood F&O
				%		35.Mixed Wood F&O
				%		36.Hardwood F&O
				%		37.Softwood TG
				%		38.Mixed Wood TG
				%		39.Hardwood TG
				%		40.Wasteland
				%		41.Open Space
				%		42.Mobile Home Si
				%		43.Condo Site
				%		44.Lot Improvemen
				%		45.Subdivision Lo
				%		46.Golf Course
Total Acreage				2.50		

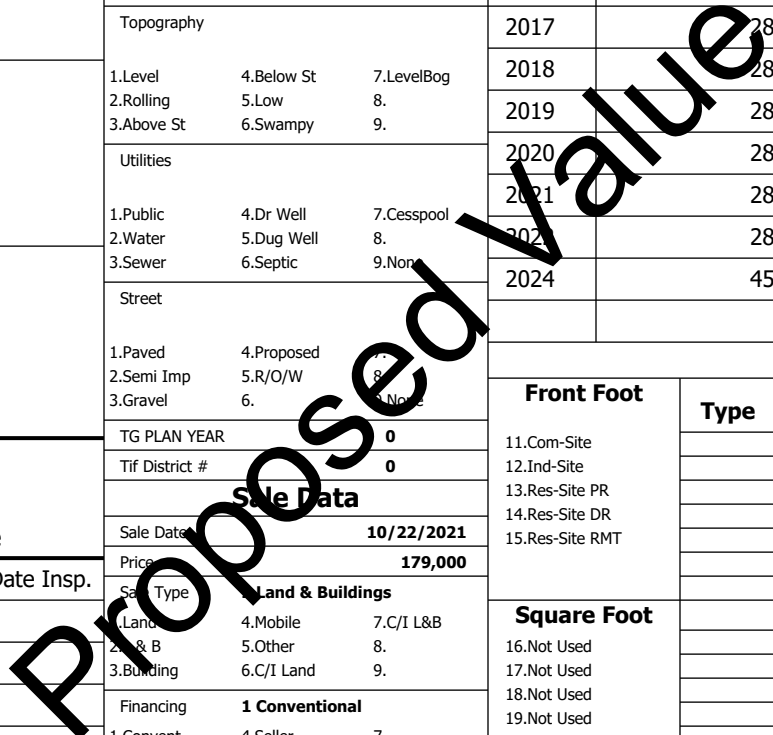

New Sharon

Map Lot 01-36-01

Account 815

Location 54 Farmington Falls Road

Card 1 Of 1 10/16/2024

Building Style 0	SF Bsmt Living 0	Layout 0
1.Conv. 5.Garrison 9.Other	Fin Bsmt Grade 0 0	1.Typical 4. 7.
2.Ranch 6.Split 10.Gar/Apt	Secondary Heat 0	2.Inadeq 5. 8.
3.R Ranch 7.Contemp 11.Cottage	Heat Type 100% 0	3.Poor 6. 9.
4.Cape 8.Log 12.Dblewid	1.HWBB 5.FWA 9.No Heat	Attic 0
Dwelling Units 0	2.HWCI 6.GravWA 10.Radiant	1.1/4 Fin 4.Full Fin 7.
Other Units 0	3.H Pump 7.Electric 11.	2.1/2 Fin 5.FI/Stair 8.
Stories 0	4.Steam 8.FI/Wall 12.	3.3/4 Fin 6. 9.None
1.1 4.1.5 7.	Cool Type 0% 9 None	Insulation 0
2.2 5.1.75 8.	1.Refrig 4.W&C Air 7.	1.Full 4.Minimal 7.
3.3 6.2.5 9.	2.Evapor 5. 8.	2.Heavy 5. 8.
Exterior Walls 0	3.H Pump 6. 9.None	3.Capped 6. 9.None
1.Wood 5.Stucco 9.Other	Kitchen Style 0	Unfinished % 0%
2.Vin/Al 6.Brick 10.Cement	1.Modern 4.Obsolete 7.	Grade & Factor 0 0%
3.Compos. 7.Stone 11.	2.Typical 5. 8.	1.E Grade 4.B Grade 7.
4.Asbestos 8.Concrete 12.	3.Old Type 6. 9.None	2.D Grade 5.A Grade 8.SC Grade
Roof Surface 0	Bath(s) Style 0	3.C Grade 6.AA Grade 9.Same
1.Asphalt 4.Composit 7.SS	1.Modern 4.Obsolete 7.	SQFT (Footprint) 0
2.Slate 5.Wood 8.	2.Typical 5. 8.	Condition 0
3.Metal 6.Roll Roo 9.	3.Old Type 6. 9.None	1.Poor 4.Avg 7.V G
SF Masonry Trim 0	# Rooms 0	2.Fair 5.Avg+ 8.Exc
Solar Voltaic 0	# Bedrooms 0	3.Avg- 6.Good 9.Same
OPEN-4-CUSTOM 0	# Full Baths 0	Phys. % Good 0%
Year Built 0	# Half Baths 0	Funct. % Good 100%
Year Remodeled 0	# Addn Fixtures 0	Functional Code 9 None
Foundation 0	# Fireplaces 0	1.Incomp 4.Delap 7.No Power
1.Concrete 4.Wood 7.		2.O-Built 5.Bsmt 8.No Power
2.C Block 5.Slab 8.		3.Damage 6.Common 9.No Power
3.Br/Stone 6.Piers 9.		Econ. % Good 100%
Basement 0		Economic Code None
1.1/4 Bmt 4.Full Bmt 7.		0.None 3.No Power 7.
2.1/2 Bmt 5.None 8.		1.Location 4.General 8.
3.3/4 Bmt 6. 9.None		2.Encroach 9.None 9.
Bsmt Gar # Cars 0		Entrance Code 1 Interior Inspect
Wet Basement 0		1.Interior 4.Vacant 7.
1.Dry 4. 7.		2.General 5.Estimate 8.
2.Damp 5. 8.		3.Informal 6.Reviewed 9.
3.Wet 6. 9.		Information Code 1 Owner
		1.Owner 4.Agent 7.
		2.Relative 5.Estimate 8.
		3.Tenant 6.Other 9.



Date Inspected 5/23/2024

Additions, Outbuildings & Improvements

Type	Year	Units	Grade	Cond	Phys.	Funct.	Sound Value
101 Asph Paving	0	900	3 100	4	0 %	100 %	
62 Patio	0	1400	3 100	4	0 %	100 %	
219 Store	2000	2432	3 100	6	0 %	100 %	
79 Gen2	0	1	3 100	4	0 %	100 %	
365 Cooler	0	43	3 100	4	0 %	100 %	
					%	%	
					%	%	
					%	%	
					%	%	
					%	%	
					%	%	

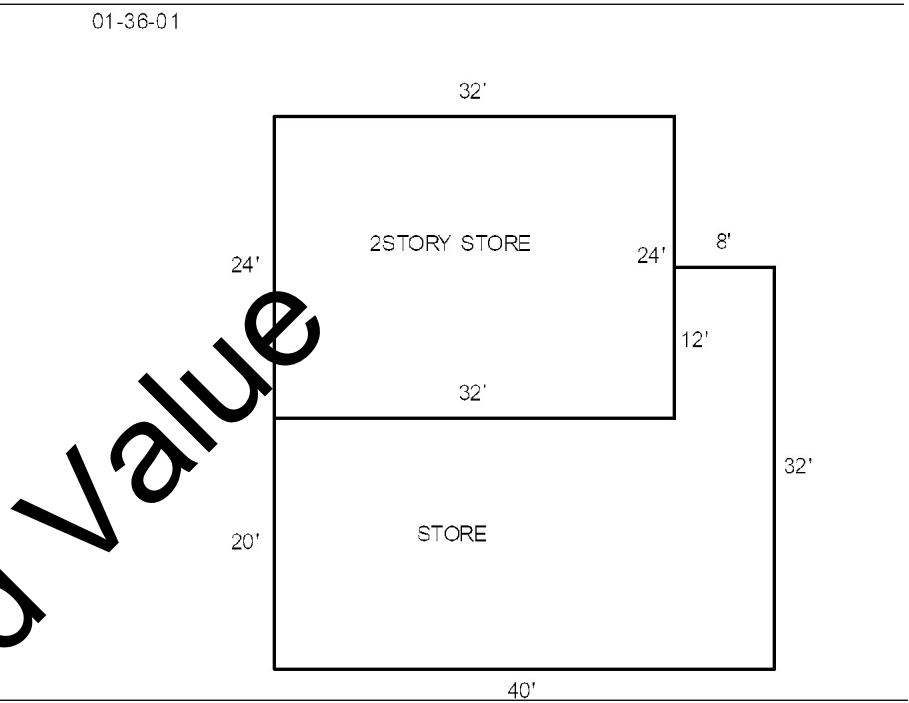

Proposed Value