

LEIGHTON, ALLAN R JR
115 DORSET ST
PORTLAND ME 04102

B5014P278

Property Data			Assessment Record						
Neighborhood 4 Forest Lake			Year	Land	Buildings	Exempt	Total		
Tree Growth Year 0			2011	31,500	17,647	0	49,147		
REVIEW 0			2012	31,500	17,647	0	49,147		
Building Permit 0			2013	31,500	17,647	0	49,147		
Zone/Land Use 12 Limited Residential			2014	31,500	17,647	0	49,147		
Secondary Zone 23 Lake District			2015	31,500	17,600	0	49,100		
Topography 1 Level			2016	31,500	17,600	0	49,100		
1. Hill 4. Below St 7.			2017	31,500	17,600	0	49,100		
2. Rolling 5. Low 8.			2018	31,500	17,600	0	49,100		
3. Above St 6. Swampy 9.			2019	45,700	27,800	0	73,500		
Utilities			2020	45,700	27,800	0	73,500		
1. Public 4. Driv Well/Po 7. Cesspool			2021	45,700	27,800	0	73,500		
2. Water 5. Dug Well 8. Lake			2022	45,700	27,800	0	73,500		
3. Holding Ta 6. Septic 9. None			2023	45,700	35,800	0	81,500		
Street 3 Gravel			Calc.	86,600	41,600	0	128,200		
1. Paved 4. Proposed			Land Data						
2. Semi Imp 5. R/O/W			Front Foot	Type	Effective		Influence		Influence Codes
3. Gravel 6. None			11. Water (0-200)		Frontage	Depth	Factor	Code	
GIS Map 75			12. Water (201-400)				%		1. Unimproved
Field Review 1			13. Water (401-800)				%		2. Excess Frtg
Sale Data			14. Water (801-160)				%		3. Topography
Sale Date			15. Water (161-32)				%		4. Size/Shape
Price			16. Water (3201-)				%		5. Access
Sale Type			17. Water SF Amen				%		6. Restriction
1. Land 4. Mobile 7.COM			18. Water View				%		7. Open Space
2. L & B 5. Other 8.			19. Water Influen				%		8. Environmental
3. Building 6. Condo 9.			20. ShoreFront A				%		9. Condo
Financing			Square Foot	Square Feet			%		Acres
1. Convent 4. Seller 7.			21. Base Lot				%		30. Blueberry(1-20
2. FHA/VA 5. Private 8.			22. Base Lot Vacan	23	0.15	100	%	0	31. Blueberry(21 -
3. Assumed 6. Cash 9.Unknown			23. Base Lot Unpav	17	1.00	100	%	0	32. Crop Land
Validity			Acres				%		33. Pasture
1. Valid 4. Split 7. Multiple			24. Acres to 10				%		34. Shorefront B
2. Related 5. Partial 8. Other			25. Acres 11-30				%		35. Shorefront C
3. Distress 6. Exempt 9. Estate			26. Acres 31-50				%		36. ANTENNA SITE
Verified			27. Acres 51& over				%		37. Softwood TG
1. Buyer 4. Agent 7. Family			28. Acres 71 & Ove				%		38. Mixed Wood TG
2. Seller 5. Pub Rec 8. Other			29. Woods (41+)				%		39. Hardwood TG
3. Lender 6. MLS 9.			Total Acreage		0.15				40. Wasteland

Inspection Witnessed By:

No./Date	Description	Date Insp.
X		

Notes:

Gray

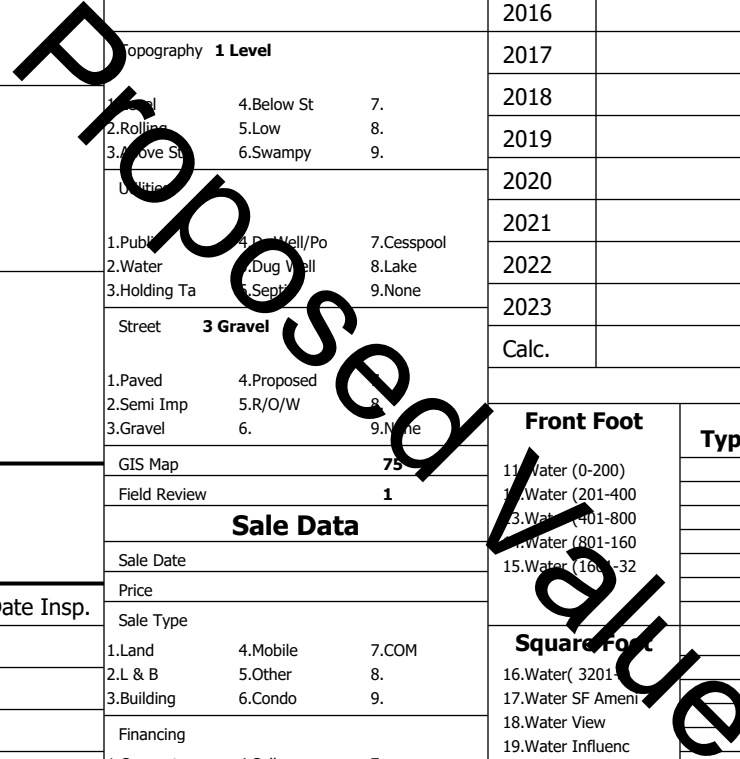

46.SP Meadow Cond

Building Style 11 Cottage/Camp	SF Bsmt Living 0	Layout 1 Typical
1.Conv. 5.Garrison 9.NE farm	Fin Bsmt Grade 0 0	1.Typical 4. 7.
2.Ranch 6.Split 10.Colonia	Secondary Heat 0	2.Inadeq 5. 8.
3.R Ranch/ 7.Contemp 11.Cottage	Heat Type 100% 9 Not Heated - Entire	3. 6. 9.
4.Cape 8.Log 12.Gambrel	1.HWB 5.FWA Dwelling 9.None	Attic 9 None
Dwelling Units 1	2.HWCI 6.Monitor 10.UNH2F	1.1/4 Fin 4.Full Fin 7.
Other Units 0	3.HWRF 7.Electric 11.Geother	2.1/2 Fin 5.FI/Stair 8.
Stories 1 One Story	4.Steam 8.FI/Wall 12.Heat/Co	3.3/4 Fin 6. 9.None
1.1 4.1.5 7.	Cool Type 0% 9 None	Insulation 9 None
2.2 5.1.75 8.	1.Central 4.W&C Air 7.	1.Full 4.Minimal 7.
3.3 6.2.5 9.	2.Evapor 5. 8.	2.Heavy 5. 8.
Exterior Walls 8 Wood Shingle	3.H Pump 6. 9.None	3.Capped 6. 9.None
1.Clapboar 5.Stucco 9.B & B	Kitchen Style 3 Old Style	Unfinished % 0%
2.Vin/Al 6.Brick 10.Cemplan	1.Modern 4.Obsolete	Grade & Factor 2 Fair 100%
3.Compos./ 7.Stone 11.Concret	2.Typical 5. 8.	1.E Grade 4.B Grade 7.SC Grade
4.Asbestos 8.Wood Shi 12.Wood Bo	3.Old Type 6. 9.None	2.C Grade 5.A Grade 8.
Roof Surface 1 Asphalt Shingles	Bath(s) Style 3 Old Style	3.D Grade 6.AA Grade 9.Same
1.Asphalt 4.Composit 7.Other	1.Modern 4.Obsolete 7.	SQFT (Footprint) 420
2.Slate 5.Wood 8.	2.Typical 5. 8.	Foundation Average
3.Metal 6.Roll Roo 9.	3.Old Type 6. 9.None	1.Poor Avg 7.V G
SF Masonry Trim 0	# Rooms 4	2.Fair Avg 8.Exc
SOLAR VOLTAIC 0	# Bedrooms 2	3.Avg- Good 9.Same
OPEN-4- 0	# Full Baths 0	Phys. % Good 0%
Year Built 1930	# Half Baths 0	Funct. % Good 0%
Year Remodeled 0	# Addn Fixtures 0	Functional Code 9 None
Foundation 6 Piers	# Fireplaces 0	1.Incomp 4.Delap 7.Layoff
1.Concrete 4.Wood 7.		2.O-Built 5.Bsmt 8.Long term
2.C Block 5.Slab 8.		3.Damage 6.Style None
3.Br/Stone 6.Piers 9.		Econ. % Good 100%
Basement 9 No Basement		Economic Code None
1.1/4 Bmt 4.Full Bmt 7.		0.None 3.No Power 6.Obsolete
2.1/2 Bmt 5.Crw 8.		1.Location 4.Generate 9.None
3.3/4 Bmt 6. 9.None		2.Encroach 5.Flood Pl 9.
Bsmt Gar # Cars 0		Entrance Code 1 Interior Inspect
Wet Basement 9 No Basement		1.Interior 4.Vacant 7.
1.Dry 4. 7.		2.Refusal 5.Estimate 8.
2.Damp 5. 8.		3.Informed 6. 9.
3.Wet 6. 9.		Information Code 1 Owner
		1.Owner 4.Agent 7.
		2.Relative 5.Estimate 8.
		3.Tenant 6.Other 9.

Date Inspected 8/31/2015

Additions, Outbuildings & Improvements

Type	Year	Units	Grade	Cond	Phys.	Funct.	Sound Value
					%	%	1.One Story Fram
					%	%	2.Two Story Fram
					%	%	3.Three Story Fr
					%	%	4.1 & 1/2 Story
					%	%	5.1 & 3/4 Story
					%	%	6.2 & 1/2 Story
					%	%	21.Open Frame Por
					%	%	22.Encl Frame Por
					%	%	23.Frame Garage
					%	%	24.Frame Shed
					%	%	25.Frame Bay Wind
					%	%	26.1SFr Overhang
					%	%	27.Unfin Basement
					%	%	28.Unfinished Att
					%	%	29.Finished Attic

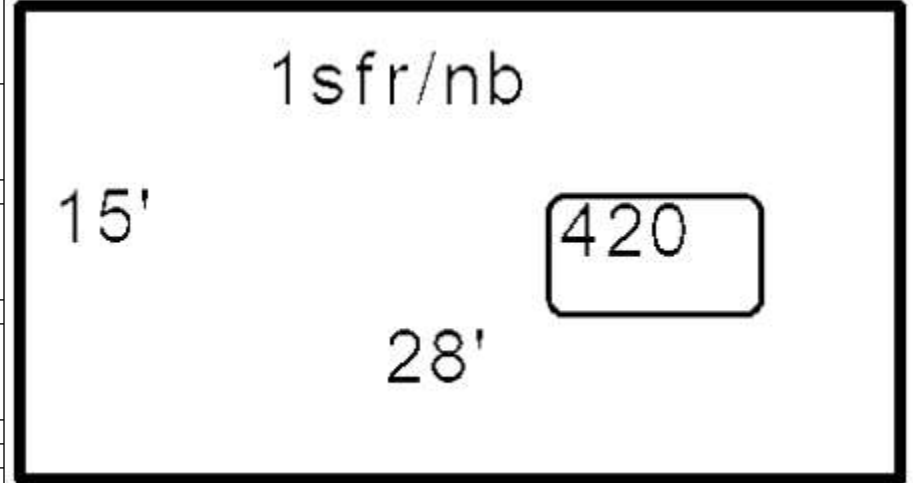

Proposed Value