

NICHOLS, MARK A
NICHOLS, STEPHANIE K
72 FOREST LAKE ROAD
GRAY ME 04039

B9835P316

Property Data			Assessment Record				
Neighborhood	82 Average Location		Year	Land	Buildings	Exempt	Total
Tree Growth Year	0		2011	47,000	167,695	8,500	206,195
REVIEW	0		2012	47,000	167,695	8,500	206,195
Building Permit	0		2013	47,000	167,695	8,500	206,195
Zone/Land Use	23 Lake District		2014	47,000	172,494	8,500	210,994
Secondary Zone			2015	47,000	172,500	9,000	210,500
Topography	2 Rolling		2016	47,000	172,500	9,000	210,500
1. Hill	4. Below St	7.	2017	47,000	172,500	13,500	206,000
2. Rolling	5. Low	8.	2018	47,000	172,500	18,000	201,500
3. Above St	6. Swampy	9.	2019	60,600	210,400	20,000	251,000
Utilities	4. Filled Well/Point		2020	60,600	210,400	20,000	251,000
1. Public	4. Dug Well/Po	7. Cesspool	2021	60,600	210,400	25,000	246,000
2. Water	5. Dug Well	8. Lake	2022	60,600	227,400	25,000	263,000
3. Holding Ta	6. Septic	9. None	2023	60,600	255,000	25,000	290,600
Street	1 Paved		Calc.	126,000	373,300	25,000	474,300
1. Paved	4. Proposed	8.	Land Data				
2. Semi Imp	5. R/O/W	9.	Front Foot	Type	Effective	Influence	Influence
3. Gravel	6.	9.	11. Water (0-200)		Frontage	Depth	Factor
GIS Map	75		12. Water (201-400)				Code
Field Review	1		13. Water (401-800)				1. Unimproved
Sale Data			14. Water (801-160)				2. Excess Frtg
Sale Date	12/24/1991		15. Water (161-320)				3. Topography
Price			Square Foot				4. Size/Shape
Sale Type			16. Water (3201-400)				5. Access
1. Land	4. Mobile	7. COM	17. Water SF Amen				6. Restriction
2. L & B	5. Other	8.	18. Water View				7. Open Space
3. Building	6. Condo	9.	19. Water Influen				8. Environmental
Financing			20. ShoreFront A				9. Condo
1. Convent	4. Seller	7.	Fract. Acre				Acres
2. FHA/VA	5. Private	8.	21. Base Lot	21	1.84	100 %	30. Blueberry(1-20
3. Assumed	6. Cash	9. Unknown	22. Base Lot Vacan	24	0.16	100 %	31. Blueberry(21 -
Validity			23. Base Lot Unpav				32. Crop Land
1. Valid	4. Split	7. Multiple	Acres				33. Pasture
2. Related	5. Partial	8. Other	24. Acres to 10				34. Shorefront B
3. Distress	6. Exempt	9. Estate	25. Acres 11-30				35. Shorefront C
Verified			26. Acres 31-50				36. ANTENNA SITE
1. Buyer	4. Agent	7. Family	27. Acres 51& over				37. Softwood TG
2. Seller	5. Pub Rec	8. Other	28. Acres 71 & Ove				38. Mixed Wood TG
3. Lender	6. MLS	9.	29. Woods (41+)				39. Hardwood TG
				Total Acreage		2.00	40. Wasteland
							41. Woodland
							42. Mobile Home Si
							43. Camp Site
							44. Lot Improvemen
							45. BA SF - Oce
							46. SP Meadow Cond

Inspection Witnessed By:

No./Date	Description	Date Insp.
X		

Notes:
5/24-FR=DR

Gray

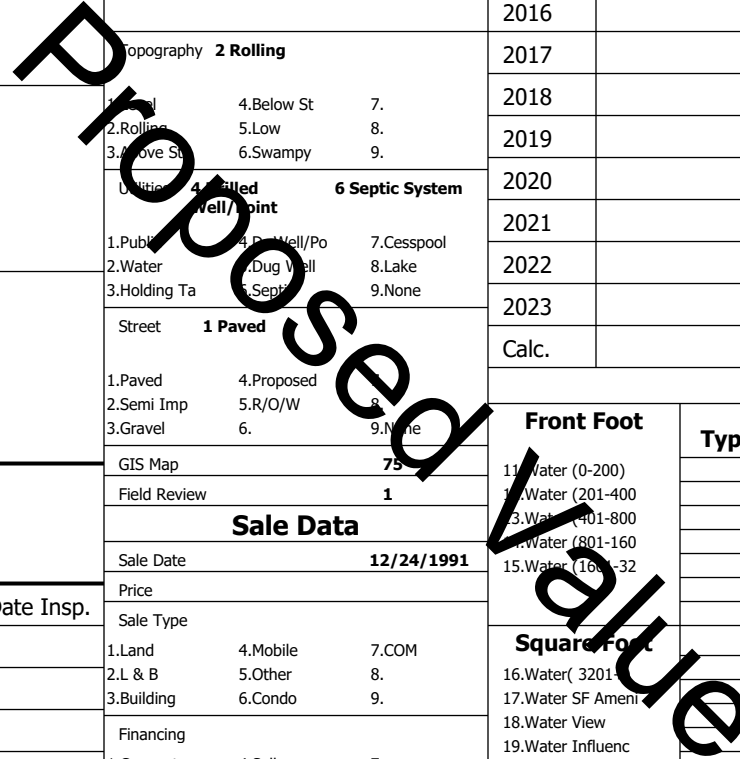

Gray

Map Lot 075-040-022-000

Account 2441

Location 72 FOREST LAKE RD

Card 1

Of 1

8/05/2024

Building Style 5 Garrison	SF Bsmt Living 0	Layout 1 Typical
1.Conv. 5.Garrison 9.NE farm	Fin Bsmt Grade 0 0	1.Typical 4. 7.
2.Ranch 6.Split 10.Colonia	Secondary Heat 0	2.Inadeq 5. 8.
3.R Ranch/ 7.Contemp 11.Cottage	Heat Type 100% 5 Forced Warm Air	3. 6. 9.
4.Cape 8.Log 12.Gambrel	1.HWBB 5.FWA 9.None	Attic 9 None
Dwelling Units 1	2.HWCI 6.Monitor 10.UNH2F	1.1/4 Fin 4.Full Fin 7.
Other Units 0	3.HWRF 7.Electric 11.Geother	2.1/2 Fin 5.FI/Stair 8.
Stories 2 Two Story	4.Steam 8.FI/Wall 12.Heat/Co	3.3/4 Fin 6. 9.None
1.1 4.1.5 7.	Cool Type 0% 4 Warm & Cool Air	Insulation 1 Full
2.2 5.1.75 8.	1.Central 4.W&C Air 7.	1.Full 4.Minimal 7.
3.3 6.2.5 9.	2.Evapor 5. 8.	2.Heavy 5. 8.
Exterior Walls 9 B & B	3.H Pump 6. 9.None	3.Capped 6. 9.None
1.Clapboard 5.Stucco 9.B & B	Kitchen Style 2 Typical	Unfinished % 0%
2.Vin/Al 6.Brick 10.Cemplan	1.Modern 4.Obsolete	Grade & Factor 3 Average 110%
3.Compos./ 7.Stone 11.Concret	2.Typical 5. 8.	1.E Grade 4.B Grade 7.SC Grade
4.Asbestos 8.Wood Shi 12.Wood Bo	3.Old Type 6. 9.None	2.D Grade 5.A Grade 8.
Roof Surface 1 Asphalt Shingles	Bath(s) Style 2 Typical Bath(s)	3.Grade 6.AA Grade 9.Same
1.Asphalt 4.Composit 7.Other	1.Modern 4.Obsolete 7.	SQFT (Footprint) 810
2.Slate 5.Wood 8.	2.Typical 5. 8.	Condition 4 Average
3.Metal 6.Roll Roo 9.	3.Old Type 6. 9.None	1.Poor Avg 7.V G
SF Masonry Trim 0	# Rooms 6	2.Fair Avg 8.Exc
SOLAR VOLTAIC 0	# Bedrooms 3	3.Avg- Good 9.Same
OPEN-4- 0	# Full Baths 2	Phys. % Good 0%
Year Built 1988	# Half Baths 0	Funct. % Good 100%
Year Remodeled 0	# Addn Fixtures 0	Functional Code 9 None
Foundation 1 Concrete	# Fireplaces 0	1.Incomp 4.Delap 7.Playoff
1.Concrete 4.Wood 7.		2.O-Built 5.Bsmt 8.Long term
2.C Block 5.Slab 8.		3.Damage 6.Style 9.None
3.Br/Stone 6.Piers 9.		Econ. % Good 95%
Basement 4 Full Basement		Economic Code Location
1.1/4 Bmt 4.Full Bmt 7.		0.None 3.No Power 6.Obsolete
2.1/2 Bmt 5.Crwl 8.		1.Location 4.Generate 9.None
3.3/4 Bmt 6. 9.None		2.Encroach 5.Flood Pl 9.
Bsmt Gar # Cars 0		Entrance Code 5 Estimated
Wet Basement 1 Dry Basement		1.Interior 4.Vacant 7.
1.Dry 4. 7.		2.Refusal 5.Estimate 8.
2.Damp 5. 8.		3.Informed 6. 9.
3.Wet 6. 9.		Information Code 5 Estimate
		1.Owner 4.Agent 7.
		2.Relative 5.Estimate 8.
		3.Tenant 6.Other 9.

Date Inspected 5/30/2024

Additions, Outbuildings & Improvements

Type	Year	Units	Grade	Cond	Phys.	Funct.	Sound Value
21 Open Frame	0	168	0 0	0	0 %	100 %	
68 Wood Deck	0	45	0 0	0	0 %	100 %	
23 Frame Garage	1997	780	4 100	4	0 %	100 %	
24 Frame Shed	1997	264	3 100	4	0 %	100 %	
26 1SFr Overhang	0	30	0 0	0	0 %	100 %	
1 One Story Frame	0	175	0 0	0	0 %	100 %	
23 Frame Garage	0	675	0 0	0	0 %	100 %	
79 1/2 St/Garage	0	675	0 0	0	0 %	100 %	
					%	%	
					%	%	

