

RUITTO, PATRICK  
326 PORTLAND ROAD  
GRAY ME 04039

B29359P32

Inspection Witnessed By:

X	Date	Date Insp.
No./Date	Description	Date Insp.

Notes:  
5/24-FR=DR

Gray

Property Data			Assessment Record						
Neighborhood <b>81 Fair-Traffic</b>			Year	Land	Buildings	Exempt	Total		
Tree Growth Year <b>0</b>			2012	36,100	0	0	36,100		
REVIEW <b>0</b>			2013	36,100	0	0	36,100		
Building Permit <b>0</b>			2014	35,210	0	0	35,210		
Zone/Land Use <b>18 Medium Density</b>			2015	35,200	0	0	35,200		
Secondary Zone			2016	35,200	0	0	35,200		
Topography <b>2 Rolling</b>			2017	35,200	0	0	35,200		
1. Above St 2. Rolling 3. Above St			2018	35,200	0	0	35,200		
4. Below St 5. Low 6. Swampy			2019	46,300	0	0	46,300		
7. 8. 9.			2020	46,300	0	0	46,300		
1. Public 2. Water 3. Holding Ta			2021	46,300	0	0	46,300		
4. Dug Well/Po 5. Septic 6. Swampy			2022	46,300	0	0	46,300		
7. Cesspool 8. Lake 9. None			2023	51,300	0	0	51,300		
Street <b>1 Paved</b>			Calc.	97,100	0	0	97,100		
1. Paved 2. Semi Imp 3. Gravel									
4. Proposed 5. R/O/W 6. None									
GIS Map <b>0</b>			<b>Land Data</b>						
Field Review <b>0</b>			<b>Front Foot</b>	<b>Type</b>	<b>Effective</b>		<b>Influence</b>		<b>Influence Codes</b>
			11. Water (0-200)		<b>Frontage</b>	<b>Depth</b>	<b>Factor</b>	<b>Code</b>	1. Unimproved
			12. Water (201-400)				%		2. Excess Frtg
			13. Water (401-800)				%		3. Topography
			14. Water (801-160)				%		4. Size/Shape
			15. Water (1601-32)				%		5. Access
							%		6. Restriction
							%		7. Open Space
							%		8. Environmental
							%		9. Condo
			<b>Square Foot</b>		<b>Square Feet</b>				<b>Acres</b>
			16. Water ( 3201-				%		30. Blueberry(1-20
			17. Water SF Amen				%		31. Blueberry(21 -
			18. Water View				%		32. Crop Land
			19. Water Influen				%		33. Pasture
			20. ShoreFront A				%		34. Shorefront B
							%		35. Shorefront C
			<b>Fract. Acre</b>		<b>Acreege/Sites</b>				36. ANTENNA SITE
			21. Base Lot	22	1.84	100	%	0	37. Softwood TG
			22. Base Lot Vacan	24	0.37	100	%	0	38. Mixed Wood TG
			23. Base Lot Unpav				%		39. Hardwood TG
							%		40. Wasteland
			<b>Acres</b>				%		41. Woodland
			24. Acres to 10				%		42. Mobile Home Si
			25. Acres 11-30				%		43. Camp Site
			26. Acres 31-50				%		44. Lot Improvemen
			27. Acres 51& over				%		45. BA SF - Oce
			28. Acres 71 & Ove				%		46. SP Meadow Cond
			29. Woods (41+)				%		
				<b>Total Acreege</b>		2.21			

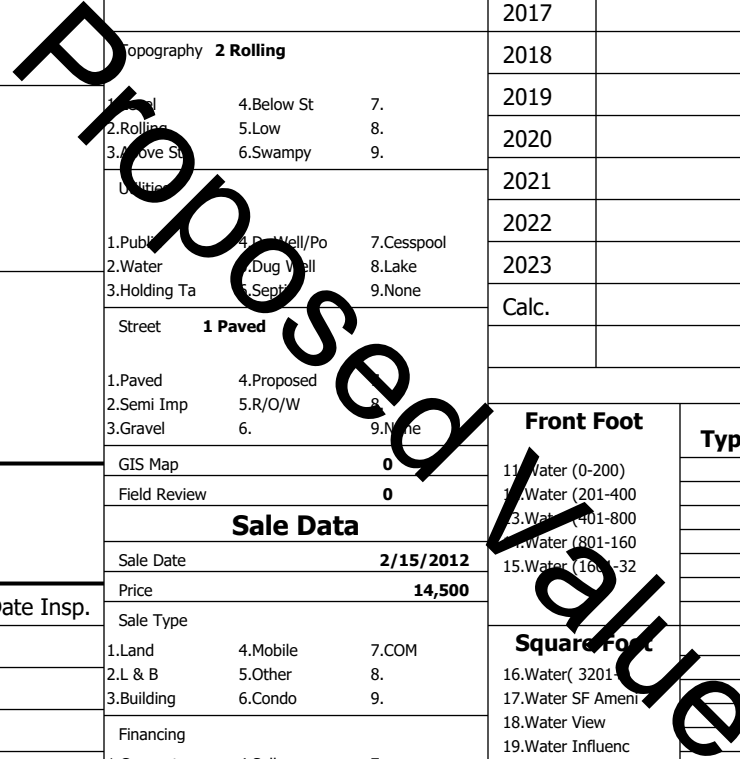

**Gray**

Map Lot 073-041-015-001

Account 4641

Location PORTLAND RD

Card 1

Of 1

8/05/2024

Building Style <b>0</b>	SF Bsmt Living <b>0</b>	Layout <b>0</b>
1.Conv. 5.Garrison 9.NE farm	Fin Bsmt Grade <b>0 0</b>	1.Typical 4. 7.
2.Ranch 6.Split 10.Colonia	Secondary Heat <b>0</b>	2.Inadeq 5. 8.
3.R Ranch/ 7.Contemp 11.Cottage	Heat Type <b>100% 0</b>	3. 6. 9.
4.Cape 8.Log 12.Gambrel	1.HWBB 5.FWA 9.None	Attic <b>0</b>
Dwelling Units <b>0</b>	2.HWCI 6.Monitor 10.UNH2F	1.1/4 Fin 4.Full Fin 7.
Other Units <b>0</b>	3.HWRF 7.Electric 11.Geother	2.1/2 Fin 5.FI/Stair 8.
Stories <b>0</b>	4.Steam 8.FI/Wall 12.Heat/Co	3.3/4 Fin 6. 9.None
1.1 4.1.5 7.	Cool Type <b>0% 9 None</b>	Insulation <b>0</b>
2.2 5.1.75 8.	1.Central 4.W&C Air 7.	1.Full 4.Minimal 7.
3.3 6.2.5 9.	2.Evapor 5. 8.	2.Heavy 5. 8.
Exterior Walls <b>0</b>	3.H Pump 6. 9.None	3.Capped 6. 9.None
1.Clapboar 5.Stucco 9.B & B	Kitchen Style <b>0</b>	Unfinished % <b>0%</b>
2.Vin/Al 6.Brick 10.Cemplan	1.Modern 4.Obsolete	Grade & Factor <b>0 0%</b>
3.Compos./ 7.Stone 11.Concret	2.Typical 5. 8.	1.E Grade 4.B Grade 7.SC Grade
4.Asbestos 8.Wood Shi 12.Wood Bo	3.Old Type 6. 9.None	2.C Grade 5.A Grade 8.
Roof Surface <b>0</b>	Bath(s) Style <b>0</b>	3.D Grade 6.AA Grade 9.Same
1.Asphalt 4.Composit 7.Other	1.Modern 4.Obsolete 7.	SQFT (Footprint) <b>0</b>
2.Slate 5.Wood 8.	2.Typical 5. 8.	1.Poor Avg 7.V G
3.Metal 6.Roll Roo 9.	3.Old Type 6. 9.None	2.Fair Avg 8.Exc
SF Masonry Trim <b>0</b>	# Rooms <b>0</b>	3.Avg- Good 9.Same
SOLAR VOLTAIC <b>0</b>	# Bedrooms <b>0</b>	Phys. % Good <b>0%</b>
OPEN-4- <b>0</b>	# Full Baths <b>0</b>	Funct. % Good <b>0%</b>
Year Built <b>0</b>	# Half Baths <b>0</b>	Functional Code <b>9 None</b>
Year Remodeled <b>0</b>	# Addn Fixtures <b>0</b>	1.Incomp 4.Delap 9.None
Foundation <b>0</b>	# Fireplaces <b>0</b>	2.O-Built 5.Bsmt 8.Long term
1.Concrete 4.Wood 7.		3.Damage 6.Style None
2.C Block 5.Slab 8.		Econ. % Good <b>100%</b>
3.Br/Stone 6.Piers 9.		Economic Code <b>None</b>
Basement <b>0</b>		0.None 3.No Power 6.Obsolete
1.1/4 Bmt 4.Full Bmt 7.		1.Location 4.Generate 9.None
2.1/2 Bmt 5.Crwl 8.		2.Encroach 5.Flood Pl 9.
3.3/4 Bmt 6. 9.None		Entrance Code <b>5 Estimated</b>
Bsmt Gar # Cars <b>0</b>		1.Interior 4.Vacant 7.
Wet Basement <b>0</b>		2.Refusal 5.Estimate 8.
1.Dry 4. 7.		3.Informed 6. 9.
2.Damp 5. 8.		Information Code <b>5 Estimate</b>
3.Wet 6. 9.		1.Owner 4.Agent 7.
		2.Relative 5.Estimate 8.
		3.Tenant 6.Other 9.



Date Inspected 5/30/2024

**Additions, Outbuildings & Improvements**

Type	Year	Units	Grade	Cond	Phys.	Funct.	Sound Value
					%	%	1.One Story Fram
					%	%	2.Two Story Fram
					%	%	3.Three Story Fr
					%	%	4.1 & 1/2 Story
					%	%	5.1 & 3/4 Story
					%	%	6.2 & 1/2 Story
					%	%	21.Open Frame Por
					%	%	22.Encl Frame Por
					%	%	23.Frame Garage
					%	%	24.Frame Shed
					%	%	25.Frame Bay Wind
					%	%	26.1SFr Overhang
					%	%	27.Unfin Basement
					%	%	28.Unfinished Att
					%	%	29.Finished Attic

Proposed Value