

COPP, PETER H  
10 DUTTON HILL  
GRAY ME 04039

B15101P307

Property Data			Assessment Record				
Neighborhood	82 Average Location		Year	Land	Buildings	Exempt	Total
Tree Growth Year	0		2011	42,000	117,975	8,500	151,475
REVIEW	0		2012	42,000	117,975	8,500	151,475
Building Permit	0		2013	42,000	117,975	8,500	151,475
Zone/Land Use	18 Medium Density		2014	42,000	128,899	8,500	162,399
Secondary Zone			2015	42,000	128,900	9,000	161,900
Topography	1 Level	4 Below Street	2016	42,000	128,900	9,000	161,900
1. Hill	4. Below St	7.	2017	42,000	128,900	13,500	157,400
2. Rolling	5. Low	8.	2018	42,000	128,900	18,000	152,900
3. Above St	6. Swampy	9.	2019	60,100	146,200	20,000	186,300
Utilities	4. Filled Well/Point	6 Septic System	2020	60,100	159,900	20,000	200,000
1. Public	4. Dug Well/Po	7. Cesspool	2021	60,100	159,900	25,000	195,000
2. Water	5. Dug Well	8. Lake	2022	60,100	159,900	25,000	195,000
3. Holding Ta	6. Septic	9. None	2023	60,100	175,100	25,000	210,200
Street	1 Paved		Calc.	117,600	280,500	25,000	373,100
1. Paved	4. Proposed	8.					
2. Semi Imp	5. R/O/W	9.					
3. Gravel	6. None						

Inspection Witnessed By:

X	Date	Date Insp.
No./Date	Description	Date Insp.

Notes:  
5/24-FR=DR

Gray

Sale Data		
Sale Date	10/13/1999	
Price		
Sale Type		
1. Land	4. Mobile	7.COM
2. L & B	5. Other	8.
3. Building	6. Condo	9.
Financing		
1. Convent	4. Seller	7.
2. FHA/VA	5. Private	8.
3. Assumed	6. Cash	9. Unknown
Validity		
1. Valid	4. Split	7. Multiple
2. Related	5. Partial	8. Other
3. Distress	6. Exempt	9. Estate
Verified		
1. Buyer	4. Agent	7. Family
2. Seller	5. Pub Rec	8. Other
3. Lender	6. MLS	9.

Land Data					
Type	Effective		Influence		Influence Codes
	Frontage	Depth	Factor	Code	
11. Water (0-200)			%		1. Unimproved
12. Water (201-400)			%		2. Excess Frtg
13. Water (401-800)			%		3. Topography
14. Water (801-160)			%		4. Size/Shape
15. Water (1601-32)			%		5. Access
			%		6. Restriction
			%		7. Open Space
			%		8. Environmental
			%		9. Condo
Square Foot		Square Feet		Acres	
16. Water ( 3201-			%		30. Blueberry(1-20
17. Water SF Amen			%		31. Blueberry(21 -
18. Water View			%		32. Crop Land
19. Water Influen			%		33. Pasture
20. ShoreFront A			%		34. Shorefront B
			%		35. Shorefront C
			%		36. ANTENNA SITE
			%		37. Softwood TG
			%		38. Mixed Wood TG
			%		39. Hardwood TG
			%		40. Wasteland
			%		41. Woodland
			%		42. Mobile Home Si
			%		43. Camp Site
			%		44. Lot Improvemen
			%		45. BA SF - Oce
			%		46. SP Meadow Cond
<b>Total Acreage</b>		1.00			

**Gray**

Map Lot 073-041-008-000

Account 2494

Location 10 DUTTON HILL

Card 1

Of 2

8/05/2024

Building Style <b>2 Ranch</b>	SF Bsmt Living <b>0</b>	Layout <b>1 Typical</b>
1.Conv. 5.Garrison 9.NE farm	Fin Bsmt Grade <b>0 0</b>	1.Typical 4. 7.
2.Ranch 6.Split 10.Colonia	Secondary Heat <b>2</b>	2.Inadeq 5. 8.
3.R Ranch/ 7.Contemp 11.Cottage	Heat Type <b>100% 9 Not Heated - Entire</b>	3. 6. 9.
4.Cape 8.Log 12.Gambrel	1.HWBB 5.FWA <b>Dwelling</b> 9.None	Attic <b>9 None</b>
Dwelling Units <b>1</b>	2.HWCI 6.Monitor 10.UNH2F	1.1/4 Fin 4.Full Fin 7.
Other Units <b>0</b>	3.HWRF 7.Electric 11.Geother	2.1/2 Fin 5.FI/Stair 8.
Stories <b>1 One Story</b>	4.Steam 8.FI/Wall 12.Heat/Co	3.3/4 Fin 6. 9.None
1.1 4.1.5 7.	Cool Type <b>0% 9 None</b>	Insulation <b>1 Full</b>
2.2 5.1.75 8.	1.Central 4.W&C Air 7.	1.Full 4.Minimal 7.
3.3 6.2.5 9.	2.Evapor 5. 8.	2.Heavy 5. 8.
Exterior Walls <b>8 Wood Shingle</b>	3.H Pump 6. 9.None	3.Capped 6. 9.None
1.Clapboa 5.Stucco 9.B & B	Kitchen Style <b>2 Typical</b>	Unfinished % <b>0%</b>
2.Vin/Al 6.Brick 10.Cemplan	1.Modern 4.Obsolete	Grade & Factor <b>3 Average 110%</b>
3.Compos./ 7.Stone 11.Concret	2.Typical 5. 8.	1.E Grade 4.B Grade 7.SC Grade
4.Asbestos 8.Wood Shi 12.Wood Bo	3.Old Type 6. 9.None	2.D Grade 5.A Grade 8.
Roof Surface <b>1 Asphalt Shingles</b>	Bath(s) Style <b>2 Typical Bath(s)</b>	3.C Grade 6.AA Grade 9.Same
1.Asphalt 4.Composit 7.Other	1.Modern 4.Obsolete 7.	SQFT (Footprint) <b>1122</b>
2.Slate 5.Wood 8.	2.Typical 5. 8.	Foundation <b>4 Average</b>
3.Metal 6.Roll Roo 9.	3.Old Type 6. 9.None	1.Poor 4.Avg 7.V G
SF Masonry Trim <b>0</b>	# Rooms <b>5</b>	2.Fair 5.Avg 8.Exc
SOLAR VOLTAIC <b>0</b>	# Bedrooms <b>3</b>	3.Avg- 6.Good 9.Same
OPEN-4- <b>0</b>	# Full Baths <b>1</b>	Phys. % Good <b>0%</b>
Year Built <b>1956</b>	# Half Baths <b>0</b>	Funct. % Good <b>100%</b>
Year Remodeled <b>1999</b>	# Addn Fixtures <b>0</b>	Functional Code <b>9 None</b>
Foundation <b>1 Concrete</b>	# Fireplaces <b>0</b>	1.Incomp 4.Delap 9.Layoff
1.Concrete 4.Wood 7.		2.O-Built 5.Bsmt 8.Long term
2.C Block 5.Slab 8.		3.Damage 6.Style 9.None
3.Br/Stone 6.Piers 9.		Econ. % Good <b>90%</b>
Basement <b>4 Full Basement</b>		Economic Code <b>Location</b>
1.1/4 Bmt 4.Full Bmt 7.		0.None 3.No Power 6.Obsolete
2.1/2 Bmt 5.Crw1 8.		1.Location 4.Generate 9.None
3.3/4 Bmt 6. 9.None		2.Encroach 5.Flood Pl 9.
Bsmt Gar # Cars <b>0</b>		Entrance Code <b>5 Estimated</b>
Wet Basement <b>1 Dry Basement</b>		1.Interior 4.Vacant 7.
1.Dry 4. 7.		2.Refusal 5.Estimate 8.
2.Damp 5. 8.		3.Informed 6. 9.
3.Wet 6. 9.		Information Code <b>5 Estimate</b>
		1.Owner 4.Agent 7.
		2.Relative 5.Estimate 8.
		3.Tenant 6.Other 9.

Date Inspected 5/30/2024

**Additions, Outbuildings & Improvements**

Type	Year	Units	Grade	Cond	Phys.	Funct.	Sound Value
68 Wood Deck	2012	256	3 100	4	0	100 %	
11 1 Story/Basement	1999	528	0 0	0	0	100 %	
43 2S Frame Garage	2002	768	2 100	4	0	100 %	
24 Frame Shed	2003	256	3 100	4	0	100 %	
24 Frame Shed	2010	288	1 100	4	0	100 %	
24 Frame Shed	0	221	2 100	3	0	100 %	
89 DH Bsmt Entry	0	1	0 0	0	0	100 %	
61 Canopy	0	247	3 100	3	0	100 %	
68 Wood Deck	2012	192	3 100	4	0	100 %	
23 Frame Garage	2018	528	3 100	4	0	100 %	

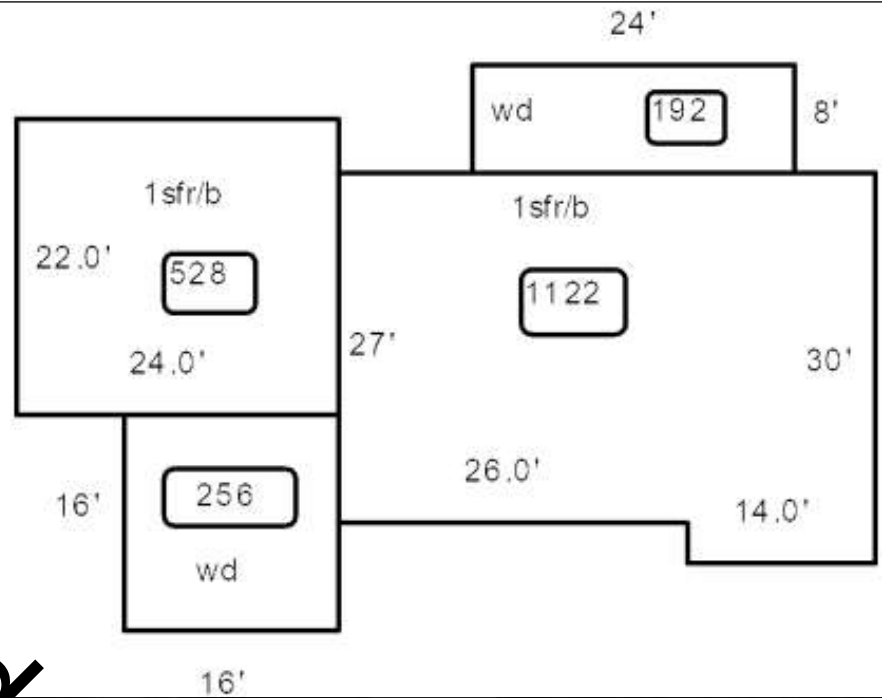



Gray

Map Lot 073-041-008-000

Account 2494

Location 10 DUTTON HILL

Card 2

Of 2

8/05/2024

Building Style	SF Bsmt Living	Layout
1.Conv. 5.Garrison 9.NE farm	Fin Bsmt Grade	1.Typical 4. 7.
2.Ranch 6.Split 10.Colonia	Secondary Heat	2.Inadeq 5. 8.
3.R Ranch/ 7.Contemp 11.Cottage	Heat Type	3. 6. 9.
4.Cape 8.Log 12.Gambrel	1.HWBB 5.FWA 9.None	Attic
Dwelling Units	2.HWCI 6.Monitor 10.UNH2F	1.1/4 Fin 4.Full Fin 7.
Other Units	3.HWRF 7.Electric 11.Geother	2.1/2 Fin 5.F/Stair 8.
Stories	4.Steam 8.F/Wall 12.Heat/Co	3.3/4 Fin 6. 9.None
1.1 4.1.5 7.	Cool Type	Insulation
2.2 5.1.75 8.	1.Central 4.W&C Air 7.	1.Full 4.Minimal 7.
3.3 6.2.5 9.	2.Evapor 5. 8.	2.Heavy 5. 8.
Exterior Walls	3.H Pump 6. 9.None	3.Capped 6. 9.None
1.Clapboar 5.Stucco 9.B & B	Kitchen Style	Unfinished %
2.Vin/Al 6.Brick 10.Cemplan	1.Modern 4.Obsolete	Grade & Factor
3.Compos./ 7.Stone 11.Concret	2.Typical 5. 8.	1.E Grade 4.B Grade 7.SC Grade
4.Asbestos 8.Wood Shi 12.Wood Bo	3.Old Type 6. 9.None	2.C Grade 5.A Grade 8.
Roof Surface	Bath(s) Style	3.C Grade 6.AA Grade 9.Same
1.Asphalt 4.Composit 7.Other	1.Modern 4.Obsolete 7.	SQFT (Footprint)
2.Slate 5.Wood 8.	2.Typical 5. 8.	1.Poor 2.Avg 7.V G
3.Metal 6.Roll Roo 9.	3.Old Type 6. 9.None	2.Fair 3.Avg+ 8.Exc
SF Masonry Trim	# Rooms	3.Avg- 4.Good 9.Same
SOLAR VOLTAIC	# Bedrooms	Phys. % Good
OPEN-4-	# Full Baths	Funct. % Good
Year Built	# Half Baths	Functional Code
Year Remodeled	# Addn Fixtures	1.Incomp 4.Delap 5.Layoff
Foundation	# Fireplaces	2.O-Built 5.Bsmt 6.Long term
1.Concrete 4.Wood 7.		3.Damage 6.Style None
2.C Block 5.Slab 8.		Econ. % Good
3.Br/Stone 6.Piers 9.		Economic Code
Basement		0.None 3.No Power 6.Obsolete
1.1/4 Bmt 4.Full Bmt 7.		1.Location 4.Generate 9.None
2.1/2 Bmt 5.Crwl 8.		2.Encroach 5.Flood Pl 9.
3.3/4 Bmt 6. 9.None		Entrance Code <b>5 Estimated</b>
Bsmt Gar # Cars		1.Interior 4.Vacant 7.
Wet Basement		2.Refusal 5.Estimate 8.
1.Dry 4. 7.		3.Informed 6. 9.
2.Damp 5. 8.	Information Code <b>5 Estimate</b>	
3.Wet 6. 9.	1.Owner 4.Agent 7.	
	2.Relative 5.Estimate 8.	
	3.Tenant 6.Other 9.	

Date Inspected 5/30/2024

**Additions, Outbuildings & Improvements**

Type	Year	Units	Grade	Cond	Phys.	Funct.	Sound Value
23 Frame Garage	1984	480	2 100	4	0 %	100 %	
					%	%	1.One Story Fram
					%	%	2.Two Story Fram
					%	%	3.Three Story Fr
					%	%	4.1 & 1/2 Story
					%	%	5.1 & 3/4 Story
					%	%	6.2 & 1/2 Story
					%	%	21.Open Frame Por
					%	%	22.Encl Frame Por
					%	%	23.Frame Garage
					%	%	24.Frame Shed
					%	%	25.Frame Bay Wind
					%	%	26.1SFr Overhang
					%	%	27.Unfin Basement
					%	%	28.Unfinished Att
					%	%	29.Finished Attic

Proposed Value