

CARTER, KEVIN J  
7029 DENISON ROAD  
SUMMERFIELD NC 27358

B35764P29

Property Data			Assessment Record						
Neighborhood <b>4 Forest Lake</b>			Year	Land	Buildings	Exempt	Total		
Tree Growth Year <b>0</b>			2011	74,271	43,145	0	117,416		
REVIEW <b>0</b>			2012	74,271	75,337	0	149,608		
Building Permit <b>0</b>			2013	74,271	75,337	0	149,608		
Zone/Land Use <b>12 Limited Residential</b>			2014	74,271	75,337	0	149,608		
Secondary Zone			2015	74,300	75,300	0	149,600		
Topography <b>2 Rolling 4 Below Street</b>			2016	74,300	75,300	0	149,600		
1. Hill 4. Below St 7.			2017	74,300	75,300	0	149,600		
2. Rolling 5. Low 8.			2018	74,300	75,300	0	149,600		
3. Above St 6. Swampy 9.			2019	107,300	102,600	0	209,900		
Utilities <b>6 Electric System 8 Lake Water</b>			2020	107,300	102,600	0	209,900		
1. Public 4. Dr. Well/Po 7. Cesspool			2021	107,300	102,600	0	209,900		
2. Water 5. Dug Well 8. Lake			2022	107,300	102,600	0	209,900		
3. Holding Ta 6. Septic 9. None			2023	107,300	119,600	0	226,900		
Street <b>3 Gravel</b>			Calc.	175,800	171,100	0	346,900		
1. Paved 4. Proposed			<b>Land Data</b>						
2. Semi Imp 5. R/O/W			<b>Front Foot</b>	<b>Type</b>	<b>Effective</b>		<b>Influence</b>		<b>Influence Codes</b>
3. Gravel 6. None 9. None					<b>Frontage</b>	<b>Depth</b>	<b>Factor</b>	<b>Code</b>	
GIS Map <b>72</b>			11. Water (0-200)	11	055	000	100 %	0	1. Unimproved
Field Review <b>1</b>			12. Water (201-400)				%		2. Excess Frtg
<b>Sale Data</b>			13. Water (401-800)				%		3. Topography
Sale Date <b>7/01/2019</b>			14. Water (801-160)				%		4. Size/Shape
Price			15. Water (161-32)				%		5. Access
Sale Type <b>2 Land &amp; Buildings</b>			<b>Square Foot</b>	<b>Square Feet</b>					6. Restriction
1. Land 4. Mobile 7. COM			16. Water ( 3201-				%		7. Open Space
2. L & B 5. Other 8.			17. Water SF Amen				%		8. Environmental
3. Building 6. Condo 9.			18. Water View				%		9. Condo
Financing <b>9 Unknown</b>			19. Water Influen				%		<b>Acres</b>
1. Convent 4. Seller 7.			20. ShoreFront A				%		30. Blueberry(1-20
2. FHA/VA 5. Private 8.			<b>Fract. Acre</b>	<b>Acreege/Sites</b>					31. Blueberry(21 -
3. Assumed 6. Cash 9. Unknown			21. Base Lot	20		0.34	100 %	0	32. Crop Land
Validity <b>2 Related Parties</b>			22. Base Lot Vacan				%		33. Pasture
1. Valid 4. Split 7. Multiple			23. Base Lot Unpav				%		34. Shorefront B
2. Related 5. Partial 8. Other			<b>Acres</b>						35. Shorefront C
3. Distress 6. Exempt 9. Estate			24. Acres to 10				%		36. ANTENNA SITE
Verified <b>1 Buyer</b>			25. Acres 11-30				%		37. Softwood TG
1. Buyer 4. Agent 7. Family			26. Acres 31-50				%		38. Mixed Wood TG
2. Seller 5. Pub Rec 8. Other			27. Acres 51& over				%		39. Hardwood TG
3. Lender 6. MLS 9.			28. Acres 71 & Ove				%		40. Wasteland
			29. Woods (41+)				%		41. Woodland
			<b>Total Acreege</b>		<b>0.34</b>				42. Mobile Home Si
									43. Camp Site
									44. Lot Improvemen
									45. BA SF - Oce
									46. SP Meadow Cond

Inspection Witnessed By:

No./Date	Description	Date Insp.
X		

Notes:

Gray

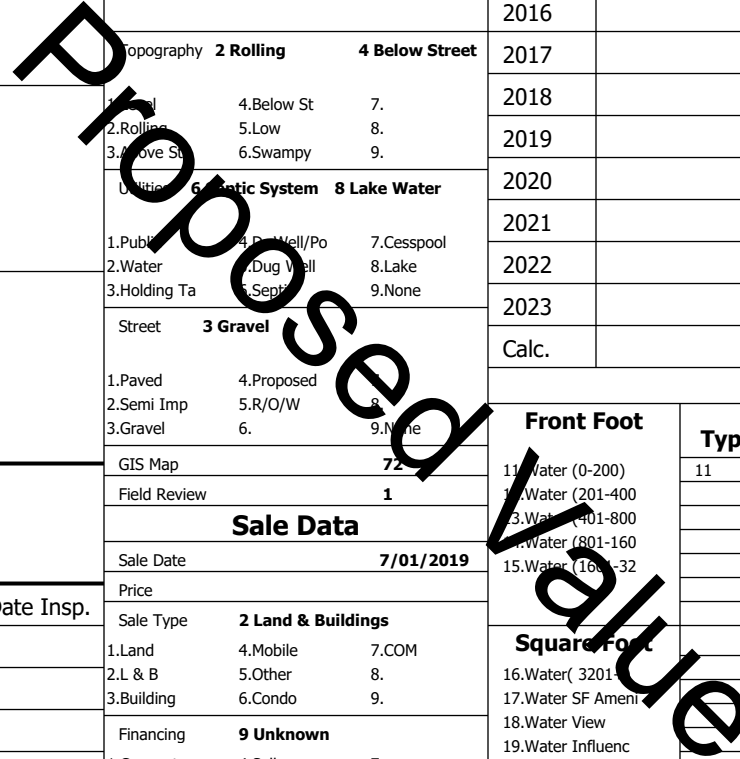

**Gray**

Map Lot 072-202-045-000

Account 3314

Location 41 LARRABEE LN

Card 1 Of 1

8/05/2024

Building Style <b>2 Ranch</b>	SF Bsmt Living <b>600</b>	Layout <b>1 Typical</b>
1.Conv. 5.Garrison 9.NE farm	Fin Bsmt Grade <b>3 100</b>	1.Typical 4. 7.
2.Ranch 6.Split 10.Colonia	Secondary Heat <b>0</b>	2.Inadeq 5. 8.
3.R Ranch/ 7.Contemp 11.Cottage	Heat Type <b>100% 9 Not Heated - Entire</b>	3. 6. 9.
4.Cape 8.Log 12.Gambrel	1.HWBB 5.FWA <b>9 Dwelling</b> 9.None	Attic <b>9 None</b>
Dwelling Units <b>1</b>	2.HWCI 6.Monitor 10.UNH2F	1.1/4 Fin 4.Full Fin 7.
Other Units <b>0</b>	3.HWRF 7.Electric 11.Geother	2.1/2 Fin 5.FI/Stair 8.
Stories <b>1 One Story</b>	4.Steam 8.FI/Wall 12.Heat/Co	3.3/4 Fin 6. 9.None
1.1 4.1.5 7.	Cool Type <b>0% 9 None</b>	Insulation <b>4 Minimal</b>
2.2 5.1.75 8.	1.Central 4.W&C Air 7.	1.Full 4.Minimal 7.
3.3 6.2.5 9.	2.Evapor 5. 8.	2.Heavy 5. 8.
Exterior Walls <b>13 Log</b>	3.H Pump 6. 9.None	3.Capped 6. 9.None
1.Clapboar 5.Stucco 9.B & B	Kitchen Style <b>2 Typical</b>	Unfinished % <b>0%</b>
2.Vin/Al 6.Brick 10.Cemplan	1.Modern 4.Obsolete	Grade & Factor <b>3 Average 100%</b>
3.Compos./ 7.Stone 11.Concret	2.Typical 5. 8.	1.E Grade 4.B Grade 7.SC Grade
4.Asbestos 8.Wood Shi 12.Wood Bo	3.Old Type 6. 9.None	2.C Grade 5.A Grade 8.
Roof Surface <b>3 Metal</b>	Bath(s) Style <b>2 Typical Bath(s)</b>	3.Grade 6.AA Grade 9.Same
1.Asphalt 4.Composit 7.Other	1.Modern 4.Obsolete 7.	SQFT (Footprint) <b>592</b>
2.Slate 5.Wood 8.	2.Typical 5. 8.	Condition <b>7 Very Good</b>
3.Metal 6.Roll Roo 9.	3.Old Type 6. 9.None	1.Poor Avg 7.V G
SF Masonry Trim <b>0</b>	# Rooms <b>4</b>	2.Fair Avg 8.Exc
SOLAR VOLTAIC <b>0</b>	# Bedrooms <b>2</b>	3.Avg- Good 9.Same
OPEN-4- <b>0</b>	# Full Baths <b>1</b>	Phys. % Good <b>0%</b>
Year Built <b>1929</b>	# Half Baths <b>1</b>	Funct. % Good <b>100%</b>
Year Remodeled <b>2011</b>	# Addn Fixtures <b>0</b>	Functional Code <b>9 None</b>
Foundation <b>1 Concrete</b>	# Fireplaces <b>1</b>	1.Incomp 4.Delap 9.No
1.Concrete 4.Wood 7.		2.O-Built 5.Bsmt 8.Long term
2.C Block 5.Slab 8.		3.Damage 6.Style 9.None
3.Br/Stone 6.Piers 9.		Econ. % Good <b>100%</b>
Basement <b>4 Full Basement</b>		Economic Code <b>None</b>
1.1/4 Bmt 4.Full Bmt 7.		0.None 3.No Power 6.Obsolete
2.1/2 Bmt 5.CrwI 8.		1.Location 4.Generate 9.None
3.3/4 Bmt 6. 9.None		2.Encroach 5.Flood Pl 9.
Bsmt Gar # Cars <b>0</b>		Entrance Code <b>3 Information Only</b>
Wet Basement <b>1 Dry Basement</b>		1.Interior 4.Vacant 7.
1.Dry 4. 7.		2.Refusal 5.Estimate 8.
2.Damp 5. 8.		3.Informed 6. 9.
3.Wet 6. 9.		Information Code <b>1 Owner</b>
		1.Owner 4.Agent 7.
		2.Relative 5.Estimate 8.
		3.Tenant 6.Other 9.

Date Inspected 9/14/2015

**Additions, Outbuildings & Improvements**

Type	Year	Units	Grade	Cond	Phys.	Funct.	Sound Value
11 1 Story/Basement	0	160	0 0	0	0	100 %	
68 Wood Deck	0	224	0 0	0	0	100 %	
68 Wood Deck	0	160	0 0	0	0	100 %	
11 1 Story/Basement	0	32	0 0	0	0	100 %	
						%	
						%	
						%	
						%	
						%	
						%	
						%	
						%	
						%	

