

HARMON, JAMES C  
HARMON, MEGAN  
236 PORTLAND ROAD  
GRAY ME 04039

B34002P64

Previous Owner  
HARMON, EUGENE C  
HARMON, LINDA D  
C/O JAMES & MEGAN HARMON  
WINDHAM ME 04062  
Sale Date: 5/11/2017

Property Data			Assessment Record				
Neighborhood <b>81 Fair-Traffic</b>			Year	Land	Buildings	Exempt	Total
Tree Growth Year <b>0</b>			2011	39,200	70,624	8,500	101,324
REVIEW <b>0</b>			2012	39,200	70,624	8,500	101,324
Building Permit <b>0</b>			2013	39,200	73,356	8,500	104,056
Zone/Land Use <b>13 Commercial</b>			2014	39,200	73,356	8,500	104,056
Secondary Zone			2015	39,200	73,400	9,000	103,600
Topography <b>2 Rolling 3 Above Street</b>			2016	39,200	73,400	9,000	103,600
1. Hill 4. Below St 7.			2017	39,200	73,400	13,500	99,100
2. Rolling 5. Low 8.			2018	39,200	73,400	18,000	94,600
3. Above St 6. Swampy 9.			2019	50,800	117,700	0	168,500
Utilities <b>2 Public Water 6 Septic System</b>			2020	50,800	117,700	0	168,500
1. Public 4. Dr. Well/Po 7. Cesspool			2021	50,800	117,700	0	168,500
2. Water 5. Dug Well 8. Lake			2022	50,800	117,700	0	168,500
3. Holding Ta 6. Septic 9. None			2023	50,800	137,700	0	188,500
Street <b>1 Paved</b>			Calc.	109,300	236,800	0	346,100
1. Paved 4. Proposed 8.							
2. Semi Imp 5. R/O/W 9.							
3. Gravel 6. None							
GIS Map <b>64</b>							
Field Review <b>1</b>							

Inspection Witnessed By:

X	Date
No./Date	Description
	Date Insp.

Notes:  
5/24-FR=DR

Gray

Sale Data		
Sale Date <b>5/11/2017</b>		
Price <b>175,000</b>		
Sale Type <b>2 Land &amp; Buildings</b>		
1. Land	4. Mobile	7. COM
2. L & B	5. Other	8.
3. Building	6. Condo	9.
Financing <b>9 Unknown</b>		
1. Convent	4. Seller	7.
2. FHA/VA	5. Private	8.
3. Assumed	6. Cash	9. Unknown
Validity <b>1 Arms Length Sale</b>		
1. Valid	4. Split	7. Multiple
2. Related	5. Partial	8. Other
3. Distress	6. Exempt	9. Estate
Verified <b>5 Public Record</b>		
1. Buyer	4. Agent	7. Family
2. Seller	5. Pub Rec	8. Other
3. Lender	6. MLS	9.

Land Data					
Type	Effective		Influence		Influence Codes
	Frontage	Depth	Factor	Code	
1. Water (0-200)			%		1. Unimproved
2. Water (201-400)			%		2. Excess Frtg
3. Water (401-800)			%		3. Topography
4. Water (801-1600)			%		4. Size/Shape
5. Water (1601-3200)			%		5. Access
			%		6. Restriction
			%		7. Open Space
			%		8. Environmental
			%		9. Condo
			%		30. Blueberry(1-20
			%		31. Blueberry(21 -
			%		32. Crop Land
			%		33. Pasture
			%		34. Shorefront B
			%		35. Shorefront C
			%		36. ANTENNA SITE
			%		37. Softwood TG
			%		38. Mixed Wood TG
			%		39. Hardwood TG
			%		40. Wasteland
			%		41. Woodland
			%		42. Mobile Home Si
			%		43. Camp Site
			%		44. Lot Improvemen
			%		45. BA SF - Oce
			%		46. SP Meadow Cond
<b>Total Acreage</b>			<b>0.80</b>		

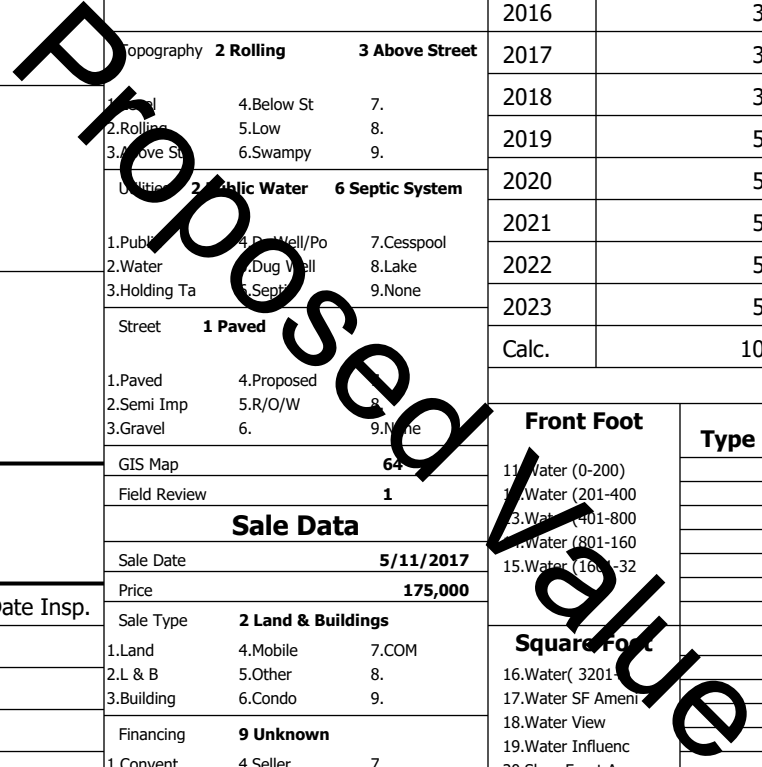

**Gray**

Map Lot 064-035-004-000

Account 2022

Location 236 PORTLAND RD

Card 1

Of 1

8/05/2024

Building Style <b>4 Cape Cod</b>	SF Bsmt Living <b>0</b>	Layout <b>1 Typical</b>
1.Conv. 5.Garrison 9.NE farm	Fin Bsmt Grade <b>0 0</b>	1.Typical 4. 7.
2.Ranch 6.Split 10.Colonia	Secondary Heat <b>0</b>	2.Inadeq 5. 8.
3.R Ranch/ 7.Contemp 11.Cottage	Heat Type <b>100% 5 Forced Warm Air</b>	3. 6. 9.
4.Cape 8.Log 12.Gambrel	1.HWBB 5.FWA 9.None	Attic <b>9 None</b>
Dwelling Units <b>1</b>	2.HWCI 6.Monitor 10.UNH2F	1.1/4 Fin 4.Full Fin 7.
Other Units <b>0</b>	3.HWRF 7.Electric 11.Geother	2.1/2 Fin 5.FI/Stair 8.
Stories <b>2 Two Story</b>	4.Steam 8.FI/Wall 12.Heat/Co	3.3/4 Fin 6. 9.None
1.1 4.1.5 7.	Cool Type <b>0% 9 None</b>	Insulation <b>4 Minimal</b>
2.2 5.1.75 8.	1.Central 4.W&C Air 7.	1.Full 4.Minimal 7.
3.3 6.2.5 9.	2.Evapor 5. 8.	2.Heavy 5. 8.
Exterior Walls <b>2 Vinyl/Aluminum</b>	3.H Pump 6. 9.None	3.Capped 6. 9.None
1.Clapboar 5.Stucco 9.B & B	Kitchen Style <b>2 Typical</b>	Unfinished % <b>0%</b>
2.Vin/Al 6.Brick 10.Cemplan	1.Modern 4.Obsolete	Grade & Factor <b>3 Average 100%</b>
3.Compos./ 7.Stone 11.Concret	2.Typical 5. 8.	1.E Grade 4.B Grade 7.SC Grade
4.Asbestos 8.Wood Shi 12.Wood Bo	3.Old Type 6. 9.None	2.O Grade 5.A Grade 8.
Roof Surface <b>1 Asphalt Shingles</b>	Bath(s) Style <b>2 Typical Bath(s)</b>	3.O Grade 6.AA Grade 9.Same
1.Asphalt 4.Composit 7.Other	1.Modern 4.Obsolete 7.	SQFT (Footprint) <b>504</b>
2.Slate 5.Wood 8.	2.Typical 5. 8.	Condition <b>5 Above Average</b>
3.Metal 6.Roll Roo 9.	3.Old Type 6. 9.None	1.Poor 2.Avg 7.V G
SF Masonry Trim <b>0</b>	# Rooms <b>5</b>	2.Fair 3.Good 8.Exc
SOLAR VOLTAIC <b>0</b>	# Bedrooms <b>3</b>	3.Avg- 9.Same
OPEN-4- <b>0</b>	# Full Baths <b>1</b>	Phys. % Good <b>0%</b>
Year Built <b>1900</b>	# Half Baths <b>0</b>	Funct. % Good <b>100%</b>
Year Remodeled <b>0</b>	# Addn Fixtures <b>0</b>	Functional Code <b>9 None</b>
Foundation <b>3 Brick &amp;/or Stone</b>	# Fireplaces <b>0</b>	1.Incomp 4.Delap 5.Delayed
1.Concrete 4.Wood 7.		2.O-Built 5.Bsmt 6.Long term
2.C Block 5.Slab 8.		3.Damage 6.Style 9.None
3.Br/Stone 6.Piers 9.		Econ. % Good <b>95%</b>
Basement <b>4 Full Basement</b>		Economic Code <b>Location</b>
1.1/4 Bmt 4.Full Bmt 7.		0.None 3.No Power 6.Obsolete
2.1/2 Bmt 5.Crwl 8.		1.Location 4.Generate 9.None
3.3/4 Bmt 6. 9.None		2.Encroach 5.Flood Pl 9.
Bsmt Gar # Cars <b>0</b>		Entrance Code <b>5 Estimated</b>
Wet Basement <b>1 Dry Basement</b>		1.Interior 4.Vacant 7.
1.Dry 4. 7.		2.Refusal 5.Estimate 8.
2.Damp 5. 8.	3.Informed 6. 9.	
3.Wet 6. 9.	Information Code <b>5 Estimate</b>	
	1.Owner 4.Agent 7.	
	2.Relative 5.Estimate 8.	
	3.Tenant 6.Other 9.	

Date Inspected 5/30/2024

**Additions, Outbuildings & Improvements**

Type	Year	Units	Grade	Cond	Phys.	Funct.	Sound Value
68 Wood Deck	2009	192	3 100	4	0 %	100 %	
1 One Story Frame	0	420	0 0	0	0 %	100 %	1.One Story Fram
1 One Story Frame	0	160	0 0	0	0 %	100 %	2.Two Story Fram
73 1.25 St Garage	1978	576	2 100	4	0 %	100 %	3.Three Story Fr
24 Frame Shed	0	100	2 100	4	0 %	100 %	4.1 & 1/2 Story
22 Encl Frame Porch	0	48	0 0	0	0 %	100 %	5.1 & 3/4 Story
					%	%	6.2 & 1/2 Story
					%	%	21.Open Frame Por
					%	%	22.Encl Frame Por
					%	%	23.Frame Garage
					%	%	24.Frame Shed
					%	%	25.Frame Bay Wind
					%	%	26.1SFr Overhang
					%	%	27.Unfin Basement
					%	%	28.Unfinished Att
					%	%	29.Finished Attic

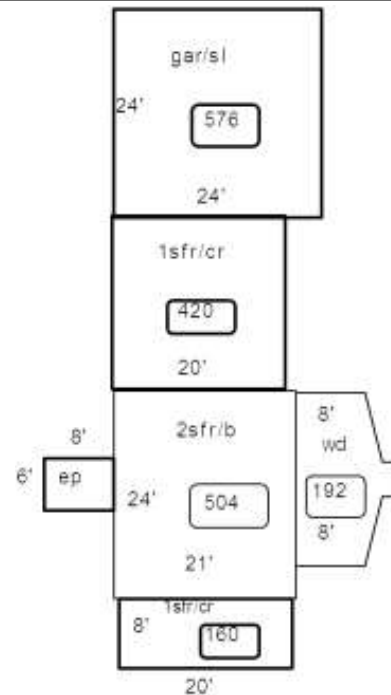

Proposed Value