

CASE, PAMELA  
13 SECOND LEVEL DRIVE  
BRATTLEBORO VT 05301

| Property Data  |             |            | Assessment Record               |                    |                      |                  |                        |
|--|-------------|------------|---------------------------------|--------------------|----------------------|------------------|------------------------|
| Neighborhood <b>82 Average Location</b>              |             |            | Year                            | Land               | Buildings            | Exempt           | Total                  |
| Tree Growth Year <b>0</b>                            |             |            | Calc.                           | 0                  | 4,100                | 0                | 4,100                  |
| REVIEW   |             |            |                                 |                    |                      |                  |                        |
| Building Permit                                      |             |            |                                 |                    |                      |                  |                        |
| Zone/Land Use <b>11 Rural Residential &amp; Agri</b> |             |            |                                 |                    |                      |                  |                        |
| Secondary Zone                                       |             |            |                                 |                    |                      |                  |                        |
| Topography <b>1 Level</b>                            |             |            |                                 |                    |                      |                  |                        |
| 1. Level 4. Below St 7.                              |             |            |                                 |                    |                      |                  |                        |
| 2. Rolling 5. Low 8.                                 |             |            |                                 |                    |                      |                  |                        |
| 3. Above St 6. Swampy 9.                             |             |            |                                 |                    |                      |                  |                        |
| Utilities  |             |            |                                 |                    |                      |                  |                        |
| 1. Public 4. Dr Well/Po 7. Cesspool                  |             |            |                                 |                    |                      |                  |                        |
| 2. Water 5. Dug Well 8. Lake                         |             |            |                                 |                    |                      |                  |                        |
| 3. Holding Ta 6. Septic 9. None                      |             |            |                                 |                    |                      |                  |                        |
| Street <b>3 Gravel</b>                               |             |            |                                 |                    |                      |                  |                        |
| 1. Paved 4. Proposed 8.                              |             |            |                                 |                    |                      |                  |                        |
| 2. Semi Imp 5. R/O/W 6.                              |             |            |                                 |                    |                      |                  |                        |
| 3. Gravel 9. None                                    |             |            |                                 |                    |                      |                  |                        |
| GIS Map <b>63</b>                                    |             |            | Land Data                       |                    |                      |                  |                        |
| Field Review <b>0</b>                                |             |            | <b>Front Foot</b>               | <b>Type</b>        | <b>Effective</b>     | <b>Influence</b> | <b>Influence Codes</b> |
| Inspection Witnessed By:                             |             |            | 11. Water (0-200)               |                    | Frontage             | Factor           | 1. Unimproved          |
| X _____ Date _____                                   |             |            | 12. Water (201-400)             |                    | Depth                | Code             | 2. Excess Frtg         |
| No./Date   | Description | Date Insp. | 13. Water (401-800)             |                    |                      |                  | 3. Topography          |
|  |             |            | 14. Water (801-160)             |                    |                      |                  | 4. Size/Shape          |
|  |             |            | 15. Water (161-32)              |                    |                      |                  | 5. Access              |
|  |             |            |                                 |                    |                      |                  | 6. Restriction         |
|  |             |            |                                 |                    |                      |                  | 7. Open Space          |
|  |             |            |                                 |                    |                      |                  | 8. Environmental       |
|  |             |            | <b>Sale Data</b>                |                    |                      |                  | 9. Condo               |
|  |             |            | Sale Date                       |                    |                      |                  | <b>Acres</b>           |
|  |             |            | Price                           |                    |                      |                  | 30. Blueberry(1-20     |
|  |             |            | Sale Type                       |                    |                      |                  | 31. Blueberry(21 -     |
|  |             |            | 1. Land 4. Mobile 7.COM         | <b>Square Foot</b> | <b>Square Feet</b>   |                  | 32. Crop Land          |
|  |             |            | 2. L & B 5. Other 8.            | 16. Water( 3201-   |                      |                  | 33. Pasture            |
|  |             |            | 3. Building 6. Condo 9.         | 17. Water SF Amen  |                      |                  | 34. Shorefront B       |
|  |             |            | Financing                       | 18. Water View     |                      |                  | 35. Shorefront C       |
|  |             |            | 1. Convent 4. Seller 7.         | 19. Water Influenc |                      |                  | 36. ANTENNA SITE       |
|  |             |            | 2. FHA/VA 5. Private 8.         | 20. ShoreFront A   |                      |                  | 37. Softwood TG        |
|  |             |            | 3. Assumed 6. Cash 9. Unknown   |                    |                      |                  | 38. Mixed Wood TG      |
|  |             |            | Validity                        | <b>Fract. Acre</b> | <b>Acres/Sites</b>   |                  | 39. Hardwood TG        |
|  |             |            | 1. Valid 4. Split 7. Multiple   | 21. Base Lot       |                      |                  | 40. Wasteland          |
|  |             |            | 2. Related 5. Partial 8. Other  | 22. Base Lot Vacan |                      |                  | 41. Woodland           |
|  |             |            | 3. Distress 6. Exempt 9. Estate | 23. Base Lot Unpav |                      |                  | 42. Mobile Home Si     |
|  |             |            | Verified                        | <b>Acres</b>       |                      |                  | 43. Camp Site          |
|  |             |            | 1. Buyer 4. Agent 7. Family     | 24. Acres to 10    |                      |                  | 44. Lot Improvemen     |
|  |             |            | 2. Seller 5. Pub Rec 8. Other   | 25. Acres 11-30    |                      |                  | 45. BA SF - Oce        |
|  |             |            | 3. Lender 6. MLS 9.             | 26. Acres 31-50    |                      |                  | 46. SP Meadow Cond     |
|  |             |            |                                 | 27. Acres 51& over |                      |                  |                        |
|  |             |            |                                 | 28. Acres 71 & Ove |                      |                  |                        |
|  |             |            |                                 | 29. Woods (41+)    | <b>Total Acreage</b> | 0.00             |                        |

Notes:  
5/24-FR=DR

Gray

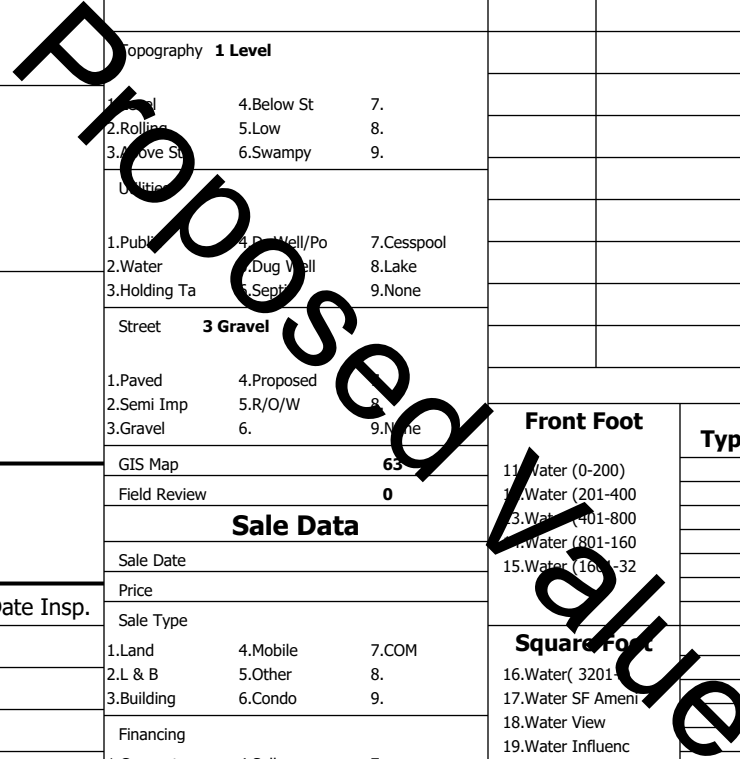

Gray

Map Lot 063-035-304-002

Account 5132

Location 18 NORTHWOODS TR

Card 1

Of 1

8/05/2024

|                          |                              |            |   |                              |            |                                  |
|--------------------------|------------------------------|------------|---|------------------------------|------------|----------------------------------|
| Building Style           | SF Bsmt Living               |            |   | Layout                       |            |                                  |
| 1.Conv.                  | 5.Garrison                   | 9.NE farm  | Fin Bsmt Grade  |                              |            | 1.Typical 4. 7.                  |
| 2.Ranch                  | 6.Split                      | 10.Colonia | Secondary Heat  |                              |            | 2.Inadeq 5. 8.                   |
| 3.R Ranch/               | 7.Contemp                    | 11.Cottage | Heat Type   |                              |            | 3. 6. 9.                         |
| 4.Cape                   | 8.Log                        | 12.Gambrel | 1.HWBB  | 5.FWA                        | 9.None     | Attic                            |
| Dwelling Units           | 2.HWCI                       |            |   | 6.Monitor                    | 10.UNH2F   | 1.1/4 Fin 4.Full Fin 7.          |
| Other Units              | 3.HWRF                       |            |   | 7.Electric                   | 11.Geother | 2.1/2 Fin 5.F/Stair 8.           |
| Stories                  | 4.Steam                      |            |   | 8.F/Wall                     | 12.Heat/Co | 3.3/4 Fin 6. 9.None              |
| 1.1                      | 4.1.5                        | 7.         | Cool Type   |                              |            | Insulation                       |
| 2.2                      | 5.1.75                       | 8.         | 1.Central   | 4.W&C Air                    | 7.         | 1.Full 4.Minimal 7.              |
| 3.3                      | 6.2.5                        | 9.         | 2.Evapor  | 5.                           | 8.         | 2.Heavy 5. 8.                    |
| Exterior Walls           | 3.H Pump                     |            |   | 6.                           | 9.None     | 3.Capped 6. 9.None               |
| 1.Clapboar               | 5.Stucco                     | 9.B & B    | Kitchen Style   |                              |            | Unfinished %                     |
| 2.Vin/Al                 | 6.Brick                      | 10.Cemplan | 1.Modern  | 4.Obsolete                   | 7.         | Grade & Factor                   |
| 3.Compos./               | 7.Stone                      | 11.Concret | 2.Typical   | 5.                           | 8.         | 1.E Grade 4.B Grade 7.SC Grade   |
| 4.Asbestos               | 8.Wood Shi                   | 12.Wood Bo | 3.Old Type  | 6.                           | 9.None     | 2.D Grade 5.A Grade 8.           |
| Roof Surface             | Bath(s) Style                |            |   | 3.E Grade 6.AA Grade 9.Same  |            |                                  |
| 1.Asphalt                | 4.Composit                   | 7.Other    | 1.Modern  | 4.Obsolete                   | 7.         | SQFT (Footprint)                 |
| 2.Slate                  | 5.Wood                       | 8.         | 2.Typical   | 5.                           | 8.         | 1.Poor 2.Avg 3.Good 4.Exc        |
| 3.Metal                  | 6.Roll Roo                   | 9.         | 3.Old Type  | 6.                           | 9.None     | 1.Poor 2.Avg 3.Good 4.Exc        |
| SF Masonry Trim          | # Rooms                      |            |   | 2.Finish 3.Avg 4.Good 5.Same |            |                                  |
| SOLAR VOLTAIC            | # Bedrooms                   |            |   | Phys. % Good                 |            |                                  |
| OPEN-4-                  | # Full Baths                 |            |   | Funct. % Good                |            |                                  |
| Year Built               | # Half Baths                 |            |   | Functional Code              |            |                                  |
| Year Remodeled           | # Addn Fixtures              |            |   | 1.Incomp 4.Delap 5.Layoff    |            |                                  |
| Foundation               | # Fireplaces                 |            |   | 2.O-Built 5.Bsmt 6.Long term |            |                                  |
| 1.Concrete               | 4.Wood                       | 7.         |  |                              |            | 3.Damage 6.Style 7.None          |
| 2.C Block                | 5.Slab                       | 8.         |   |                              |            | Econ. % Good                     |
| 3.Br/Stone               | 6.Piers                      | 9.         |   |                              |            | Economic Code                    |
| Basement                 | 0.None 3.No Power 6.Obsolete |            |   |                              |            |                                  |
| 1.1/4 Bmt                | 4.Full Bmt                   | 7.         |   |                              |            | 1.Location 4.Generate 9.None     |
| 2.1/2 Bmt                | 5.Crwl                       | 8.         |   |                              |            | 2.Encroach 5.Flood Pl 9.         |
| 3.3/4 Bmt                | 6.                           | 9.None     |   |                              |            | Entrance Code <b>5 Estimated</b> |
| Bsmt Gar # Cars          | 1.Interior 4.Vacant 7.       |            |   |                              |            |                                  |
| Wet Basement             | 2.Refusal 5.Estimate 8.      |            |   |                              |            |                                  |
| 1.Dry                    | 4.                           | 7.         |   |                              |            | 3.Informed 6. 9.                 |
| 2.Damp                   | 5.                           | 8.         | Information Code <b>5 Estimate</b>  |                              |            |                                  |
| 3.Wet                    | 6.                           | 9.         | 1.Owner 4.Agent 7.  |                              |            |                                  |
| Date Inspected 5/29/2024 |                              |            | 2.Relative 5.Estimate 8.  |                              |            |                                  |
|                          |                              |            | 3.Tenant 6.Other 9.   |                              |            |                                  |

| Additions, Outbuildings & Improvements |      |       |       |      |       |        |                   |
|--|------|-------|-------|------|-------|--------|-------------------|
| Type                                   | Year | Units | Grade | Cond | Phys. | Funct. | Sound Value       |
| 24 Frame Shed                          | 2022 | 240   | 4 100 | 4    | 0 %   | 100 %  |                   |
|  |      |       |       |      | %     | %      | 1.One Story Fram  |
|  |      |       |       |      | %     | %      | 2.Two Story Fram  |
|  |      |       |       |      | %     | %      | 3.Three Story Fr  |
|  |      |       |       |      | %     | %      | 4.1 & 1/2 Story   |
|  |      |       |       |      | %     | %      | 5.1 & 3/4 Story   |
|  |      |       |       |      | %     | %      | 6.2 & 1/2 Story   |
|  |      |       |       |      | %     | %      | 21.Open Frame Por |
|  |      |       |       |      | %     | %      | 22.Encl Frame Por |
|  |      |       |       |      | %     | %      | 23.Frame Garage   |
|  |      |       |       |      | %     | %      | 24.Frame Shed     |
|  |      |       |       |      | %     | %      | 25.Frame Bay Wind |
|  |      |       |       |      | %     | %      | 26.1SFr Overhang  |
|  |      |       |       |      | %     | %      | 27.Unfin Basement |
|  |      |       |       |      | %     | %      | 28.Unfinished Att |
|  |      |       |       |      | %     | %      | 29.Finished Attic |



Proposed Value