

BLAZEJEWSKI, MATTHEW J
BLAZEJEWSKI, RENEE J
29 POPLAR RIDGE
GRAY ME 04039

B26531P249

Property Data			Assessment Record				
Neighborhood	83 Avg-Good Location		Year	Land	Buildings	Exempt	Total
Tree Growth Year	0		2011	59,540	131,574	0	191,114
REVIEW	0		2012	59,540	131,574	0	191,114
Building Permit	0		2013	59,540	131,574	0	191,114
Zone/Land Use	11 Rural Residential & Agri		2014	59,540	140,058	8,500	191,098
Secondary Zone			2015	59,500	140,100	9,000	190,600
Topography	2 Rolling		2016	59,500	140,100	9,000	190,600
1. Hill	4. Below St	7.	2017	59,500	143,600	13,500	189,600
2. Rolling	5. Low	8.	2018	59,500	143,600	18,000	185,100
3. Above St	6. Swampy	9.	2019	80,500	211,900	20,000	272,400
Utilities	4. Filled Well/Point 6 Septic System		2020	80,500	211,900	20,000	272,400
1. Public	4. Dug Well/Po	7. Cesspool	2021	80,500	211,900	25,000	267,400
2. Water	5. Dug Well	8. Lake	2022	80,500	211,900	25,000	267,400
3. Holding Ta	6. Septic	9. None	2023	80,500	246,300	25,000	301,800
Street	1 Paved		Calc.	152,700	511,400	25,000	639,100
1. Paved	4. Proposed	8.					
2. Semi Imp	5. R/O/W	9.					
3. Gravel	6.						

Inspection Witnessed By:

X	Date	Date Insp.
No./Date	Description	Date Insp.

Notes:
5/24-FR=DR

Gray

Sale Data		
Sale Date	12/19/2008	
Price	261,345	
Sale Type	2 Land & Buildings	
1. Land	4. Mobile	7. COM
2. L & B	5. Other	8.
3. Building	6. Condo	9.
Financing		
1. Convent	4. Seller	7.
2. FHA/VA	5. Private	8.
3. Assumed	6. Cash	9. Unknown
Validity		
1. Valid	4. Split	7. Multiple
2. Related	5. Partial	8. Other
3. Distress	6. Exempt	9. Estate
Verified		
1. Buyer	4. Agent	7. Family
2. Seller	5. Pub Rec	8. Other
3. Lender	6. MLS	9.

Land Data					
Type	Effective		Influence		Influence Codes
	Frontage	Depth	Factor	Code	
11. Water (0-200)			%		1. Unimproved
12. Water (201-400)			%		2. Excess Frtg
13. Water (401-800)			%		3. Topography
14. Water (801-160)			%		4. Size/Shape
15. Water (1601-32)			%		5. Access
			%		6. Restriction
			%		7. Open Space
			%		8. Environmental
			%		9. Condo
Square Foot		Square Feet		Acres	
16. Water (3201			%		30. Blueberry(1-20
17. Water SF Amen			%		31. Blueberry(21 -
18. Water View			%		32. Crop Land
19. Water Influen			%		33. Pasture
20. ShoreFront A			%		34. Shorefront B
			%		35. Shorefront C
			%		36. ANTENNA SITE
21. Base Lot	1.00	100	%	0	37. Softwood TG
22. Base Lot Vacan			%		38. Mixed Wood TG
23. Base Lot Unpav	3.54	100	%	0	39. Hardwood TG
			%		40. Wasteland
			%		41. Woodland
			%		42. Mobile Home Si
			%		43. Camp Site
			%		44. Lot Improvemen
			%		45. BA SF - Oce
			%		46. SP Meadow Cond
Total Acreage		4.54			

Gray

Map Lot 062-022-006-009

Account 1155

Location 29 POPLAR RIDGE RD

Card 1

Of 1

8/05/2024

Building Style 10 Colonial	SF Bsmt Living 0	Layout 1 Typical
1.Conv. 5.Garrison 9.NE farm	Fin Bsmt Grade 0 0	1.Typical 4. 7.
2.Ranch 6.Split 10.Colonia	Secondary Heat 0	2.Inadeq 5. 8.
3.R Ranch/ 7.Contemp 11.Cottage	Heat Type 100% 3 Hot Water Radiant	3. 6. 9.
4.Cape 8.Log 12.Gambrel	1.HWBB 5.FWA Floor 9.None	Attic 9 None
Dwelling Units 1	2.HWCI 6.Monitor 10.UNH2F	1.1/4 Fin 4.Full Fin 7.
Other Units 0	3.HWRF 7.Electric 11.Geother	2.1/2 Fin 5.FI/Stair 8.
Stories 2 Two Story	4.Steam 8.FI/Wall 12.Heat/Co	3.3/4 Fin 6. 9.None
1.1 4.1.5 7.	Cool Type 50% 3 Heat Pump	Insulation 1 Full
2.2 5.1.75 8.	1.Central 4.W&C Air 7.	1.Full 4.Minimal 7.
3.3 6.2.5 9.	2.Evapor 5. 8.	2.Heavy 5. 8.
Exterior Walls 2 Vinyl/Aluminum	3.H Pump 6. 9.None	3.Capped 6. 9.None
1.Clapboar 5.Stucco 9.B & B	Kitchen Style 2 Typical	Unfinished % 0%
2.Vin/Al 6.Brick 10.Cemplan	1.Modern 4.Obsolete	Grade & Factor 3 Average 110%
3.Compos./ 7.Stone 11.Concret	2.Typical 5. 8.	1.E Grade 4.B Grade 7.SC Grade
4.Asbestos 8.Wood Shi 12.Wood Bo	3.Old Type 6. 9.None	2.D Grade 5.A Grade 8.
Roof Surface 1 Asphalt Shingles	Bath(s) Style 2 Typical Bath(s)	3.Grade 6.AA Grade 9.Same
1.Asphalt 4.Composit 7.Other	1.Modern 4.Obsolete 7.	SQFT (Footprint) 884
2.Slate 5.Wood 8.	2.Typical 5. 8.	Condition 4 Average
3.Metal 6.Roll Roo 9.	3.Old Type 6. 9.None	1.Poor 4.Avg 7.V G
SF Masonry Trim 0	# Rooms 6	2.Fair 5.Avg 8.Exc
SOLAR VOLTAIC 0	# Bedrooms 3	3.Avg- 6.Good 9.Same
OPEN-4- 0	# Full Baths 2	Phys. % Good 0%
Year Built 2008	# Half Baths 1	Funct. % Good 100%
Year Remodeled 0	# Addn Fixtures 0	Functional Code 9 None
Foundation 1 Concrete	# Fireplaces 0	1.Incomp 4.Delap 5.Delay
1.Concrete 4.Wood 7.		2.O-Built 5.Bsmt 6.Long term
2.C Block 5.Slab 8.		3.Damage 6.Style 7.None
3.Br/Stone 6.Piers 9.		Econ. % Good 100%
Basement 4 Full Basement		Economic Code None
1.1/4 Bmt 4.Full Bmt 7.		0.None 3.No Power 6.Obsolete
2.1/2 Bmt 5.Crw 8.		1.Location 4.Generate 9.None
3.3/4 Bmt 6. 9.None		2.Encroach 5.Flood Pl 9.
Bsmt Gar # Cars 0		Entrance Code 5 Estimated
Wet Basement 1 Dry Basement		1.Interior 4.Vacant 7.
1.Dry 4. 7.		2.Refusal 5.Estimate 8.
2.Damp 5. 8.	3.Informed 6. 9.	
3.Wet 6. 9.	Information Code 5 Estimate	
	1.Owner 4.Agent 7.	
	2.Relative 5.Estimate 8.	
	3.Tenant 6.Other 9.	

Date Inspected 5/31/2024

Additions, Outbuildings & Improvements

Type	Year	Units	Grade	Cond	Phys.	Funct.	Sound Value
21 Open Frame	0	192	0 0	0	0	100 %	
68 Wood Deck	0	132	0 0	0	0	100 %	
68 Wood Deck	0	136	0 0	0	0	100 %	
24 Frame Shed	2015	192	3 100	4	0	100 %	
68 Wood Deck	2015	96	3 100	4	0	100 %	
62 Patio	0	180	3 100	4	0	100 %	
1 One Story Frame	2024	140	4 100	4	0	61 %	
2 Two Story Frame	2024	260	4 100	4	0	61 %	
1 One Story Frame	2024	660	4 100	4	0	61 %	
76 2 St Garage	2024	1380	4 100	4	0	61 %	

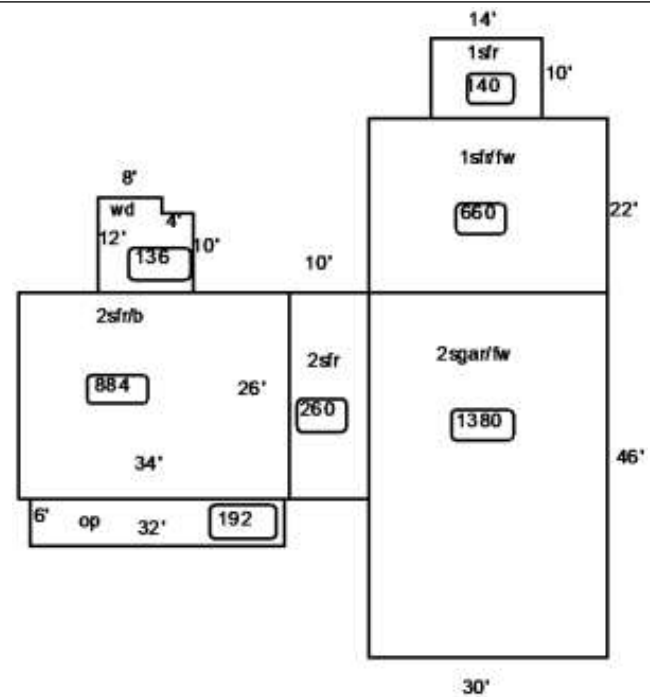

Value