

HAYMAN, TODD J  
DURANT, LORI A  
26 PLEASANT VIEW DR  
GRAY ME 04039

B10360P292

Property Data			Assessment Record					
Neighborhood	83 Avg-Good Location		Year	Land	Buildings	Exempt	Total	
Tree Growth Year	0		2011	66,350	173,253	0	239,603	
REVIEW	0		2012	66,350	173,253	0	239,603	
Building Permit	0		2013	66,350	173,253	0	239,603	
Zone/Land Use	11 Rural Residential & Agri		2014	66,350	173,253	0	239,603	
Secondary Zone			2015	66,400	173,300	0	239,700	
Topography	1 Level		2016	66,400	173,300	0	239,700	
1. Hill	4. Below St	7.	2017	66,400	178,000	0	244,400	
2. Rolling	5. Low	8.	2018	66,400	178,000	0	244,400	
3. Above St	6. Swampy	9.	2019	77,100	266,700	0	343,800	
Utilities	4. Filled Well/Point 6 Septic System		2020	77,100	266,700	0	343,800	
1. Public	4. Dug Well/Po	7. Cesspool	2021	77,100	266,700	0	343,800	
2. Water	5. Dug Well	8. Lake	2022	77,100	296,700	25,000	348,800	
3. Holding Ta	6. Septic	9. None	2023	77,100	327,900	25,000	380,000	
Street	1 Paved		Calc.	137,700	517,400	25,000	630,100	
1. Paved	4. Proposed	8.	<b>Land Data</b>					
2. Semi Imp	5. R/O/W	9.	<b>Front Foot</b>	<b>Type</b>	<b>Effective</b>	<b>Influence</b>	<b>Influence Codes</b>	
3. Gravel	6.	9.	11. Water (0-200)		<b>Frontage</b>	<b>Depth</b>	<b>Factor</b>	<b>Code</b>
GIS Map	61		12. Water (201-400)				%	1. Unimproved
Field Review	1		13. Water (401-800)				%	2. Excess Frtg
<b>Sale Data</b>			14. Water (801-160)				%	3. Topography
Sale Date	10/23/1992		15. Water (161-32)				%	4. Size/Shape
Price			16. Water (321-640)				%	5. Access
Sale Type			17. Water SF Amen				%	6. Restriction
1. Land	4. Mobile	7. COM	18. Water View				%	7. Open Space
2. L & B	5. Other	8.	19. Water Influen				%	8. Environmental
3. Building	6. Condo	9.	20. ShoreFront A				%	9. Condo
Financing			<b>Square Foot</b>		<b>Square Feet</b>			<b>Acres</b>
1. Convent	4. Seller	7.	21. Base Lot				%	30. Blueberry(1-20
2. FHA/VA	5. Private	8.	22. Base Lot Vacan				%	31. Blueberry(21 -
3. Assumed	6. Cash	9. Unknown	23. Base Lot Unpav				%	32. Crop Land
Validity			<b>Fract. Acre</b>		<b>Acres/Sites</b>			33. Pasture
1. Valid	4. Split	7. Multiple	24. Acres to 10	21	1.84	100	%	34. Shorefront B
2. Related	5. Partial	8. Other	25. Acres 11-30	24	0.03	100	%	35. Shorefront C
3. Distress	6. Exempt	9. Estate	26. Acres 31-50				%	36. ANTENNA SITE
Verified			27. Acres 51& over				%	37. Softwood TG
1. Buyer	4. Agent	7. Family	28. Acres 71 & Ove				%	38. Mixed Wood TG
2. Seller	5. Pub Rec	8. Other	29. Woods (41+)				%	39. Hardwood TG
3. Lender	6. MLS	9.					%	40. Wasteland
				<b>Total Acreage 1.87</b>				41. Woodland
								42. Mobile Home Si
								43. Camp Site
								44. Lot Improvemen
								45. BA SF - Oce
								46. SP Meadow Cond

Inspection Witnessed By:

No./Date	Description	Date Insp.
X		

Notes:  
5/24- DR FIELD REVIEW

Gray

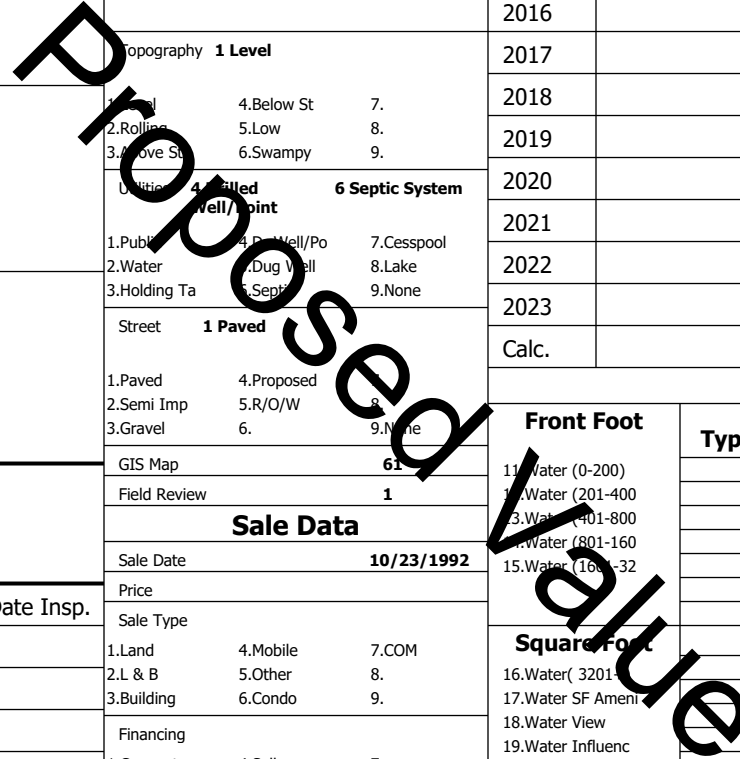

**Gray**

Map Lot 061-022-031-012

Account 1185

Location 26 PLEASANT VIEW DR

Card 1

Of 1

8/05/2024

Building Style <b>4 Cape Cod</b>	SF Bsmt Living <b>0</b>	Layout <b>1 Typical</b>
1.Conv. 5.Garrison 9.NE farm	Fin Bsmt Grade <b>0 0</b>	1.Typical 4. 7.
2.Ranch 6.Split 10.Colonia	Secondary Heat <b>0</b>	2.Inadeq 5. 8.
3.R Ranch/ 7.Contemp 11.Cottage	Heat Type <b>100% 1 Hot Water BB</b>	3. 6. 9.
4.Cape 8.Log 12.Gambrel	1.HWBB 5.FWA 9.None	Attic <b>9 None</b>
Dwelling Units <b>1</b>	2.HWCI 6.Monitor 10.UNH2F	1.1/4 Fin 4.Full Fin 7.
Other Units <b>0</b>	3.HWRF 7.Electric 11.Geother	2.1/2 Fin 5.F/Stair 8.
Stories <b>5 One &amp; 3/4 Story</b>	4.Steam 8.F/Wall 12.Heat/Co	3.3/4 Fin 6. 9.None
1.1 4.1.5 7.	Cool Type <b>0% 9 None</b>	Insulation <b>1 Full</b>
2.2 5.1.75 8.	1.Central 4.W&C Air 7.	1.Full 4.Minimal 7.
3.3 6.2.5 9.	2.Evapor 5. 8.	2.Heavy 5. 8.
Exterior Walls <b>2 Vinyl/Aluminum</b>	3.H Pump 6. 9.None	3.Capped 6. 9.None
1.Clapboard 5.Stucco 9.B & B	Kitchen Style <b>2 Typical</b>	Unfinished % <b>0%</b>
2.Vin/Al 6.Brick 10.Cemplan	1.Modern 4.Obsolete	Grade & Factor <b>3 Average 120%</b>
3.Compos./ 7.Stone 11.Concret	2.Typical 5. 8.	1.E Grade 4.B Grade 7.SC Grade
4.Asbestos 8.Wood Shi 12.Wood Bo	3.Old Type 6. 9.None	2.C Grade 5.A Grade 8.
Roof Surface <b>1 Asphalt Shingles</b>	Bath(s) Style <b>2 Typical Bath(s)</b>	3.Grade 6.AA Grade 9.Same
1.Asphalt 4.Composit 7.Other	1.Modern 4.Obsolete 7.	SQFT (Footprint) <b>1152</b>
2.Slate 5.Wood 8.	2.Typical 5. 8.	Foundation <b>5 Above Average</b>
3.Metal 6.Roll Roo 9.	3.Old Type 6. 9.None	1.Poor 4.Avg 7.V G
SF Masonry Trim <b>0</b>	# Rooms <b>7</b>	2.Fair 5.Avg 8.Exc
SOLAR VOLTAIC <b>0</b>	# Bedrooms <b>3</b>	3.Avg- 6.Good 9.Same
OPEN-4- <b>0</b>	# Full Baths <b>1</b>	Phys. % Good <b>0%</b>
Year Built <b>1992</b>	# Half Baths <b>1</b>	Funct. % Good <b>100%</b>
Year Remodeled <b>0</b>	# Addn Fixtures <b>0</b>	Functional Code <b>9 None</b>
Foundation <b>1 Concrete</b>	# Fireplaces <b>0</b>	1.Incomp 4.Delap 5.Delay
1.Concrete 4.Wood 7.		2.O-Built 5.Bsmt 6.Long term
2.C Block 5.Slab 8.		3.Damage 6.Style None
3.Br/Stone 6.Piers 9.		Econ. % Good <b>100%</b>
Basement <b>4 Full Basement</b>		Economic Code <b>None</b>
1.1/4 Bmt 4.Full Bmt 7.		0.None 3.No Power 6.Obsolete
2.1/2 Bmt 5.Crwl 8.		1.Location 4.Generate 9.None
3.3/4 Bmt 6. 9.None		2.Encroach 5.Flood Pl 9.
Bsmt Gar # Cars <b>0</b>		Entrance Code <b>5 Estimated</b>
Wet Basement <b>1 Dry Basement</b>		1.Interior 4.Vacant 7.
1.Dry 4. 7.		2.Refusal 5.Estimate 8.
2.Damp 5. 8.		3.Informed 6. 9.
3.Wet 6. 9.		Information Code <b>5 Estimate</b>
		1.Owner 4.Agent 7.
		2.Relative 5.Estimate 8.
		3.Tenant 6.Other 9.

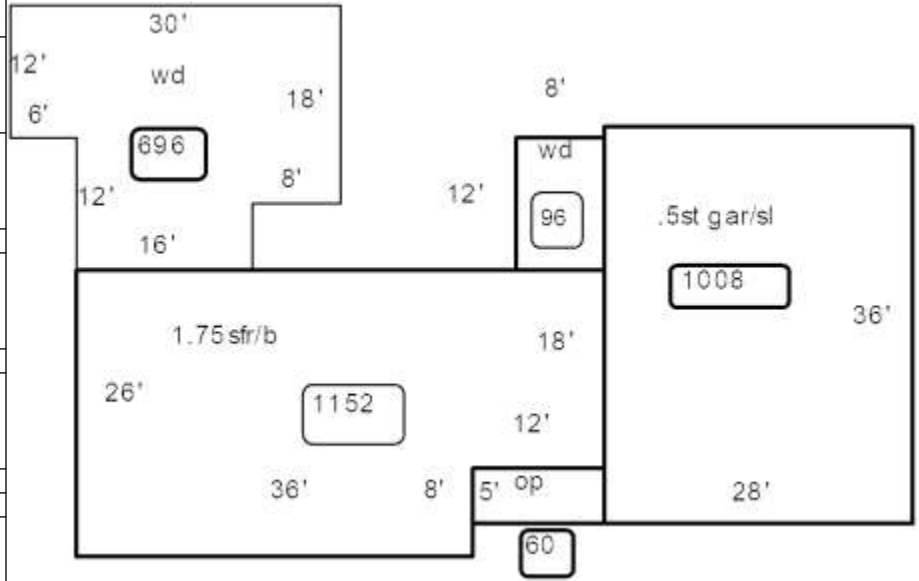

Date Inspected 5/24/2024

Additions, Outbuildings & Improvements							
Type	Year	Units	Grade	Cond	Phys.	Funct.	Sound Value
21 Open Frame	1999	60	0 0	0	0	100 %	
68 Wood Deck	1995	192	0 0	0	0	100 %	
68 Wood Deck	0	96	3 100	4	0	100 %	
24 Frame Shed	0	120	2 100	4	0	100 %	
68 Wood Deck	2010	300	0 0	0	0	100 %	
68 Wood Deck	2010	696	0 0	0	0	100 %	
23 Frame Garage	1999	1008	0 0	0	0	100 %	
79 1/2 St/Garage	1999	1008	0 0	0	0	100 %	
						%	
						%	

