

VREELAND, STEWART T  
VREELAND, MARY B  
311 YARMOUTH RD.  
GRAY ME 04039

B24201P165

Inspection Witnessed By:

No./Date	Description	Date Insp.
X		

Notes:  
5/24 DR FIELD REVIEW

Gray

Property Data			Assessment Record						
Neighborhood <b>82 Average Location</b>			Year	Land	Buildings	Exempt	Total		
Tree Growth Year <b>0</b>			2011	61,850	213,821	0	275,671		
REVIEW <b>0</b>			2012	61,850	213,821	0	275,671		
Building Permit <b>0</b>			2013	61,850	213,821	0	275,671		
Zone/Land Use <b>11 Rural Residential &amp; Agri</b>			2014	61,850	213,821	8,500	267,171		
Secondary Zone			2015	61,900	213,800	9,000	266,700		
Topography <b>1 Level</b>			2016	61,900	213,800	9,000	266,700		
1. Level 4. Below St 7.			2017	61,900	213,800	13,500	262,200		
2. Rolling 5. Low 8.			2018	61,900	213,800	18,000	257,700		
3. Above St 6. Swampy 9.			2019	85,000	321,000	20,000	386,000		
Utilities 2. Public Water 6. Septic System			2020	85,000	321,000	20,000	386,000		
1. Public 4. Dr. Well/Po 7. Cesspool			2021	85,000	321,000	25,000	381,000		
2. Water 8. Dug Well 8. Lake			2022	85,000	321,000	25,000	381,000		
3. Holding Ta 9. None			2023	85,000	353,900	25,000	413,900		
Street <b>1 Paved</b>			Calc.	155,100	578,900	25,000	709,000		
1. Paved 4. Proposed			<b>Land Data</b>						
2. Semi Imp 5. R/O/W			<b>Front Foot</b>	<b>Type</b>	<b>Effective</b>		<b>Influence</b>		<b>Influence Codes</b>
3. Gravel 6. None					<b>Frontage</b>	<b>Depth</b>	<b>Factor</b>	<b>Code</b>	
GIS Map <b>53</b>			11. Water (0-200)				%		1. Unimproved
Field Review <b>1</b>			12. Water (201-400)				%		2. Excess Frtg
<b>Sale Data</b>			13. Water (401-800)				%		3. Topography
Sale Date <b>7/19/2006</b>			14. Water (801-160)				%		4. Size/Shape
Price <b>420,000</b>			15. Water (161-32)				%		5. Access
Sale Type			16. Water (321-640)				%		6. Restriction
1. Land 4. Mobile 7. COM			17. Water SF Amen				%		7. Open Space
2. L & B 5. Other 8.			18. Water View				%		8. Environmental
3. Building 6. Condo 9.			19. Water Influen				%		9. Condo
Financing			20. ShoreFront A				%		30. Blueberry(1-20
1. Convent 4. Seller 7.			<b>Square Foot</b>	<b>Square Feet</b>					31. Blueberry(21 -
2. FHA/VA 5. Private 8.			21. Base Lot						32. Crop Land
3. Assumed 6. Cash 9. Unknown			22. Base Lot Vacan						33. Pasture
Validity			23. Base Lot Unpav						34. Shorefront B
1. Valid 4. Split 7. Multiple			<b>Acres</b>	<b>Acres/Sites</b>					35. Shorefront C
2. Related 5. Partial 8. Other			24. Acres to 10	21	1.84	100	%	0	36. ANTENNA SITE
3. Distress 6. Exempt 9. Estate			25. Acres 11-30	24	5.01	100	%	0	37. Softwood TG
Verified			26. Acres 31-50				%		38. Mixed Wood TG
1. Buyer 4. Agent 7. Family			27. Acres 51& over				%		39. Hardwood TG
2. Seller 5. Pub Rec 8. Other			28. Acres 71 & Ove				%		40. Wasteland
3. Lender 6. MLS 9.			29. Woods (41+)				%		41. Woodland
			<b>Total Acreage</b>		<b>6.85</b>				42. Mobile Home Si
									43. Camp Site
									44. Lot Improvemen
									45. BA SF - Oce
									46. SP Meadow Cond

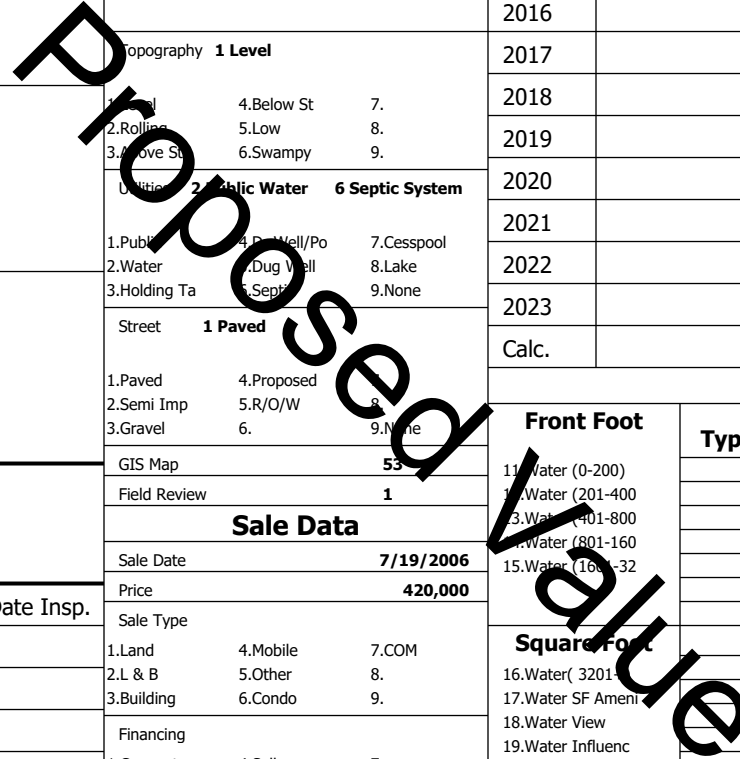

**Gray**

Map Lot 060-043-010-000

Account 2687

Location 311 YARMOUTH RD

Card 1 Of 1

8/05/2024

Building Style <b>10 Colonial</b>	SF Bsmt Living <b>0</b>	Layout <b>1 Typical</b>
1.Conv. 5.Garrison 9.NE farm	Fin Bsmt Grade <b>0 0</b>	1.Typical 4. 7.
2.Ranch 6.Split 10.Colonia	Secondary Heat <b>0</b>	2.Inadeq 5. 8.
3.R Ranch/ 7.Contemp 11.Cottage	Heat Type <b>100% 5 Forced Warm Air</b>	3. 6. 9.
4.Cape 8.Log 12.Gambrel	1.HWBB 5.FWA 9.None	Attic <b>9 None</b>
Dwelling Units <b>1</b>	2.HWCI 6.Monitor 10.UNH2F	1.1/4 Fin 4.Full Fin 7.
Other Units <b>0</b>	3.HWRF 7.Electric 11.Geother	2.1/2 Fin 5.FI/Stair 8.
Stories <b>2 Two Story</b>	4.Steam 8.FI/Wall 12.Heat/Co	3.3/4 Fin 6. 9.None
1.1 4.1.5 7.	Cool Type <b>0% 9 None</b>	Insulation <b>1 Full</b>
2.2 5.1.75 8.	1.Central 4.W&C Air 7.	1.Full 4.Minimal 7.
3.3 6.2.5 9.	2.Evapor 5. 8.	2.Heavy 5. 8.
Exterior Walls <b>6 Brick</b>	3.H Pump 6. 9.None	3.Capped 6. 9.None
1.Clapboar 5.Stucco 9.B & B	Kitchen Style <b>2 Typical</b>	Unfinished % <b>0%</b>
2.Vin/Al 6.Brick 10.Cemplan	1.Modern 4.Obsolete	Grade & Factor <b>3 Average 120%</b>
3.Compos./ 7.Stone 11.Concret	2.Typical 5. 8.	1.E Grade 4.B Grade 7.SC Grade
4.Asbestos 8.Wood Shi 12.Wood Bo	3.Old Type 6. 9.None	2.D Grade 5.A Grade 8.
Roof Surface <b>1 Asphalt Shingles</b>	Bath(s) Style <b>2 Typical Bath(s)</b>	3.E Grade 6.AA Grade 9.Same
1.Asphalt 4.Composit 7.Other	1.Modern 4.Obsolete 7.	SQFT (Footprint) <b>1428</b>
2.Slate 5.Wood 8.	2.Typical 5. 8.	Foundation <b>5 Above Average</b>
3.Metal 6.Roll Roo 9.	3.Old Type 6. 9.None	1.Poor Avg 7.V G
SF Masonry Trim <b>0</b>	# Rooms <b>8</b>	2.Fair Avg 8.Exc
SOLAR VOLTAIC <b>0</b>	# Bedrooms <b>4</b>	3.Avg- Good 9.Same
OPEN-4- <b>0</b>	# Full Baths <b>2</b>	Phys. % Good <b>0%</b>
Year Built <b>1840</b>	# Half Baths <b>1</b>	Funct. % Good <b>100%</b>
Year Remodeled <b>0</b>	# Addn Fixtures <b>1</b>	Functional Code <b>9 None</b>
Foundation <b>3 Brick &amp;/or Stone</b>	# Fireplaces <b>3</b>	1.Incomp 4.Delap 5.Layoff
1.Concrete 4.Wood 7.		2.O-Built 5.Bsmt 6.Long term
2.C Block 5.Slab 8.		3.Damage 6.Style None
3.Br/Stone 6.Piers 9.		Econ. % Good <b>100%</b>
Basement <b>4 Full Basement</b>		Economic Code <b>None</b>
1.1/4 Bmt 4.Full Bmt 7.		0.None 3.No Power 6.Obsolete
2.1/2 Bmt 5.Crw1 8.		1.Location 4.Generate 9.None
3.3/4 Bmt 6. 9.None		2.Encroach 5.Flood Pl 9.
Bsmt Gar # Cars <b>0</b>		Entrance Code <b>5 Estimated</b>
Wet Basement <b>1 Dry Basement</b>		1.Interior 4.Vacant 7.
1.Dry 4. 7.		2.Refusal 5.Estimate 8.
2.Damp 5. 8.		3.Informed 6. 9.
3.Wet 6. 9.		Information Code <b>5 Estimate</b>
		1.Owner 4.Agent 7.
		2.Relative 5.Estimate 8.
		3.Tenant 6.Other 9.

Date Inspected 5/28/2024

**Additions, Outbuildings & Improvements**

Type	Year	Units	Grade	Cond	Phys.	Funct.	Sound Value
22 Encl Frame Porch	0	180	0 0	0	0 %	100 %	
62 Patio	0	204	3 100	4	0 %	100 %	
56 1.25 St Barn	0	660	3 100	5	0 %	100 %	1.One Story Fram
57 1.5 St Barn	0	2200	3 100	5	0 %	100 %	2.Two Story Fram
22 Encl Frame Porch	0	144	0 0	0	0 %	100 %	3.Three Story Fr
23 Frame Garage	1970	480	2 100	4	0 %	100 %	4.1 & 1/2 Story
24 Frame Shed	1970	308	2 100	4	0 %	100 %	5.1 & 3/4 Story
22 Encl Frame Porch	2000	128	0 0	0	0 %	100 %	6.2 & 1/2 Story
21 Open Frame	0	21	0 0	0	0 %	100 %	21.Open Frame Por
					%	%	22.Encl Frame Por
							23.Frame Garage
							24.Frame Shed
							25.Frame Bay Wind
							26.1SFr Overhang
							27.Unfin Basement
							28.Unfinished Att
							29.Finished Attic

