

BATURA, CHRISTOPHER J  
BATURA, JENNIFER L  
18 PRISCILLA LANE  
GRAY ME 04039

B28160P19

Inspection Witnessed By:

X	Date	Date Insp.
No./Date	Description	Date Insp.

Notes:  
5/24 DR FIELD REVIEW

Gray

Property Data			Assessment Record					
Neighborhood	82 Average Location		Year	Land	Buildings	Exempt	Total	
Tree Growth Year	0		2011	56,300	89,858	8,500	137,658	
REVIEW	0		2012	56,300	89,858	8,500	137,658	
Building Permit	0		2013	56,300	89,858	8,500	137,658	
Zone/Land Use	11 Rural Residential & Agri		2014	56,300	89,858	8,500	137,658	
Secondary Zone	24 Resource Protection		2015	56,300	89,900	9,000	137,200	
Topography	1 Level		2016	56,300	89,900	9,000	137,200	
1. Hill	4. Below St	7.	2017	56,300	89,900	13,500	132,700	
2. Rolling	5. Low	8.	2018	56,300	89,900	18,000	128,200	
3. Above St	6. Swampy	9.	2019	55,100	151,900	20,000	187,000	
Utilities	4. Filled Well/Point		2020	55,100	151,900	20,000	187,000	
1. Public	4. Dug Well/Po	7. Cesspool	2021	55,100	151,900	25,000	182,000	
2. Water	8. Lake	9. None	2022	55,100	165,200	25,000	195,300	
3. Holding Ta	5. Septic		2023	55,100	187,000	25,000	217,100	
Street	3 Gravel		Calc.	120,100	235,100	25,000	330,200	
1. Paved	4. Proposed	8.	<b>Land Data</b>					
2. Semi Imp	5. R/O/W	9.	<b>Front Foot</b>	<b>Type</b>	<b>Effective</b>	<b>Influence</b>	<b>Influence Codes</b>	
3. Gravel	6.		11. Water (0-200)		Frontage	Depth	Factor	Code
GIS Map	52		12. Water (201-400)				%	1. Unimproved
Field Review	1		13. Water (401-800)				%	2. Excess Frtg
<b>Sale Data</b>			14. Water (801-160)				%	3. Topography
Sale Date	9/24/2010		15. Water (161-320)				%	4. Size/Shape
Price			16. Water (3201-6400)				%	5. Access
Sale Type			17. Water SF Amenities				%	6. Restriction
1. Land	4. Mobile	7. COM	18. Water View				%	7. Open Space
2. L & B	5. Other	8.	19. Water Influenced				%	8. Environmental
3. Building	6. Condo	9.	20. ShoreFront A				%	9. Condo
Financing			<b>Square Foot</b>	<b>Square Feet</b>				<b>Acres</b>
1. Convent	4. Seller	7.	16. Water ( 3201-6400)				%	30. Blueberry(1-20
2. FHA/VA	5. Private	8.	17. Water SF Amenities				%	31. Blueberry(21 -
3. Assumed	6. Cash	9. Unknown	18. Water View				%	32. Crop Land
Validity			19. Water Influenced				%	33. Pasture
1. Valid	4. Split	7. Multiple	20. ShoreFront A				%	34. Shorefront B
2. Related	5. Partial	8. Other	<b>Fract. Acre</b>				%	35. Shorefront C
3. Distress	6. Exempt	9. Estate	21. Base Lot	23	1.84	100	%	36. ANTENNA SITE
Verified			22. Base Lot Vacant	24	0.02	100	%	37. Softwood TG
1. Buyer	4. Agent	7. Family	23. Base Lot Unpaved				%	38. Mixed Wood TG
2. Seller	5. Pub Rec	8. Other	<b>Acres</b>				%	39. Hardwood TG
3. Lender	6. MLS	9.	24. Acres to 10				%	40. Wasteland
			25. Acres 11-30				%	41. Woodland
			26. Acres 31-50				%	42. Mobile Home Si
			27. Acres 51& over				%	43. Camp Site
			28. Acres 71 & Over				%	44. Lot Improvemen
			29. Woods (41+)				%	45. BA SF - Oce
			<b>Total Acreage</b>	1.86				46. SP Meadow Cond

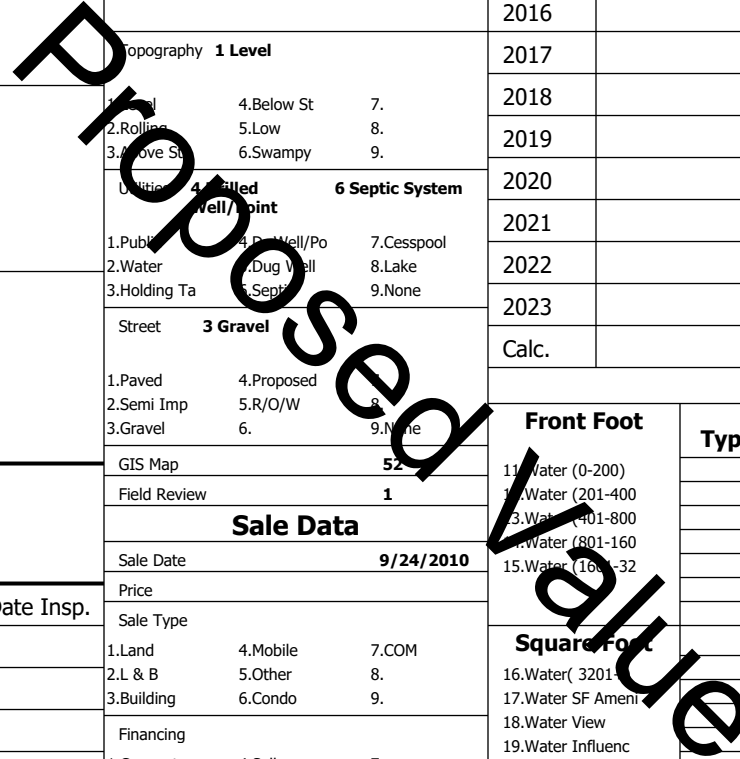

**Gray**

Map Lot 059-037-002-000

Account 2184

Location 18 PRISCILLA LN

Card 1

Of 1

8/05/2024

Building Style <b>3 Raised Ranch/Split</b>	SF Bsmt Living <b>800</b>	Layout <b>1 Typical</b>
1.Conv. 5.Garrison 9.NE farm	Fin Bsmt Grade <b>3 100</b>	1.Typical 4. 7.
2.Ranch 6.Split 10.Colonia	Secondary Heat <b>0</b>	2.Inadeq 5. 8.
3.R Ranch/ 7.Contemp 11.Cottage	Heat Type <b>100% 1 Hot Water BB</b>	3. 6. 9.
4.Cape 8.Log 12.Gambrel	1.HWBB 5.FWA 9.None	Attic <b>9 None</b>
Dwelling Units <b>1</b>	2.HWCI 6.Monitor 10.UNH2F	1.1/4 Fin 4.Full Fin 7.
Other Units <b>0</b>	3.HWRF 7.Electric 11.Geother	2.1/2 Fin 5.FI/Stair 8.
Stories <b>1 One Story</b>	4.Steam 8.FI/Wall 12.Heat/Co	3.3/4 Fin 6. 9.None
1.1 4.1.5 7.	Cool Type <b>0% 9 None</b>	Insulation <b>1 Full</b>
2.2 5.1.75 8.	1.Central 4.W&C Air 7.	1.Full 4.Minimal 7.
3.3 6.2.5 9.	2.Evapor 5. 8.	2.Heavy 5. 8.
Exterior Walls <b>2 Vinyl/Aluminum</b>	3.H Pump 6. 9.None	3.Capped 6. 9.None
1.Clapboar 5.Stucco 9.B & B	Kitchen Style <b>2 Typical</b>	Unfinished % <b>0%</b>
2.Vin/Al 6.Brick 10.Cemplan	1.Modern 4.Obsolete	Grade & Factor <b>3 Average 100%</b>
3.Compos./ 7.Stone 11.Concret	2.Typical 5. 8.	1.E Grade 4.B Grade 7.SC Grade
4.Asbestos 8.Wood Shi 12.Wood Bo	3.Old Type 6. 9.None	2.D Grade 5.A Grade 8.
Roof Surface <b>1 Asphalt Shingles</b>	Bath(s) Style <b>2 Typical Bath(s)</b>	3.C Grade 6.AA Grade 9.Same
1.Asphalt 4.Composit 7.Other	1.Modern 4.Obsolete 7.	SQFT (Footprint) <b>1008</b>
2.Slate 5.Wood 8.	2.Typical 5. 8.	Foundation <b>4 Average</b>
3.Metal 6.Roll Roo 9.	3.Old Type 6. 9.None	1.Poor 2.Avg 7.V G
SF Masonry Trim <b>0</b>	# Rooms <b>5</b>	2.Fair 3.Good 8.Exc
SOLAR VOLTAIC <b>0</b>	# Bedrooms <b>3</b>	3.Avg- 9.Same
OPEN-4- <b>0</b>	# Full Baths <b>1</b>	Phys. % Good <b>0%</b>
Year Built <b>2000</b>	# Half Baths <b>0</b>	Funct. % Good <b>100%</b>
Year Remodeled <b>0</b>	# Addn Fixtures <b>0</b>	Functional Code <b>9 None</b>
Foundation <b>1 Concrete</b>	# Fireplaces <b>0</b>	1.Incomp 4.Delap 7.Poor
1.Concrete 4.Wood 7.		2.O-Built 5.Bsmt 8.Long term
2.C Block 5.Slab 8.		3.Damage 6.Style 9.None
3.Br/Stone 6.Piers 9.		Econ. % Good <b>100%</b>
Basement <b>4 Full Basement</b>		Economic Code <b>None</b>
1.1/4 Bmt 4.Full Bmt 7.		0.None 3.No Power 6.Obsolete
2.1/2 Bmt 5.Crwl 8.		1.Location 4.Generate 9.None
3.3/4 Bmt 6. 9.None		2.Encroach 5.Flood Pl 9.
Bsmt Gar # Cars <b>2</b>		Entrance Code <b>5 Estimated</b>
Wet Basement <b>1 Dry Basement</b>		1.Interior 4.Vacant 7.
1.Dry 4. 7.		2.Refusal 5.Estimate 8.
2.Damp 5. 8.		3.Informed 6. 9.
3.Wet 6. 9.		Information Code <b>5 Estimate</b>
		1.Owner 4.Agent 7.
		2.Relative 5.Estimate 8.
		3.Tenant 6.Other 9.

Date Inspected 5/28/2024

**Additions, Outbuildings & Improvements**

Type	Year	Units	Grade	Cond	Phys.	Funct.	Sound Value	
26 1Sfr Overhang	0	35	0 0	0	0	100 %		1.One Story Fram
68 Wood Deck	0	144	0 0	0	0	100 %		2.Two Story Fram
68 Wood Deck	0	28	0 0	0	0	100 %		3.Three Story Fr
62 Patio	0	247	0 0	0	0	100 %		4.1 & 1/2 Story
								5.1 & 3/4 Story
								6.2 & 1/2 Story
								21.Open Frame Por
								22.Encl Frame Por
								23.Frame Garage
								24.Frame Shed
								25.Frame Bay Wind
								26.1SFr Overhang
								27.Unfin Basement
								28.Unfinished Att
								29.Finished Attic

