

BEKIT, MAAKELE
44 SUMMIT ROAD
GRAY ME 04039

B12702P132

Inspection Witnessed By:

X	Date	Date Insp.
No./Date	Description	Date Insp.

Notes:
5/24-FR=DR

Gray

Property Data		
Neighborhood	82 Average Location	
Tree Growth Year	0	
REVIEW	0	
Building Permit	0	
Zone/Land Use	11 Rural Residential & Agri	
Secondary Zone		
Topography	1 Level	
1. Hill	4. Below St	7.
2. Rolling	5. Low	8.
3. Above St	6. Swampy	9.
Utilities	4. Filled Well/Point 6 Septic System	
1. Public	4. Dug Well/Po	7. Cesspool
2. Water	5. Dug Well	8. Lake
3. Holding Ta	6. Septic	9. None
Street	3 Gravel	
1. Paved	4. Proposed	8.
2. Semi Imp	5. R/O/W	9.
3. Gravel	6.	9. None
GIS Map	58	
Field Review	1	
Sale Data		
Sale Date	9/03/1996	
Price		
Sale Type		
1. Land	4. Mobile	7. COM
2. L & B	5. Other	8.
3. Building	6. Condo	9.
Financing		
1. Convent	4. Seller	7.
2. FHA/VA	5. Private	8.
3. Assumed	6. Cash	9. Unknown
Validity		
1. Valid	4. Split	7. Multiple
2. Related	5. Partial	8. Other
3. Distress	6. Exempt	9. Estate
Verified		
1. Buyer	4. Agent	7. Family
2. Seller	5. Pub Rec	8. Other
3. Lender	6. MLS	9.

Assessment Record					
Year	Land	Buildings	Exempt	Total	
2011	48,700	133,127	8,500	173,327	
2012	48,700	148,576	8,500	188,776	
2013	48,700	148,576	8,500	188,776	
2014	48,700	150,691	8,500	190,891	
2015	48,700	150,700	9,000	190,400	
2016	48,700	150,700	9,000	190,400	
2017	48,700	150,700	13,500	185,900	
2018	48,700	150,700	18,000	181,400	
2019	60,600	224,700	20,000	265,300	
2020	60,600	224,700	20,000	265,300	
2021	60,600	224,700	25,000	260,300	
2022	60,600	224,700	25,000	260,300	
2023	60,600	250,800	25,000	286,400	
Calc.	131,200	321,200	25,000	427,400	

Land Data					
Type	Effective		Influence		Influence Codes
	Frontage	Depth	Factor	Code	
1. Water (0-200)			%		1. Unimproved
2. Water (201-400)			%		2. Excess Frtg
3. Water (401-800)			%		3. Topography
4. Water (801-160)			%		4. Size/Shape
5. Water (1601-32)			%		5. Access
			%		6. Restriction
			%		7. Open Space
			%		8. Environmental
			%		9. Condo
Square Foot		Square Feet		Acres	
16. Water (3201-			%		30. Blueberry(1-20
17. Water SF Amen			%		31. Blueberry(21 -
18. Water View			%		32. Crop Land
19. Water Influen			%		33. Pasture
20. ShoreFront A			%		34. Shorefront B
			%		35. Shorefront C
			%		36. ANTENNA SITE
23	1.84	100	%	0	37. Softwood TG
24	1.86	100	%	0	38. Mixed Wood TG
			%		39. Hardwood TG
			%		40. Wasteland
			%		41. Woodland
			%		42. Mobile Home Si
			%		43. Camp Site
			%		44. Lot Improvemen
			%		45. BA SF - Oce
			%		46. SP Meadow Cond
Total Acreage		3.70			

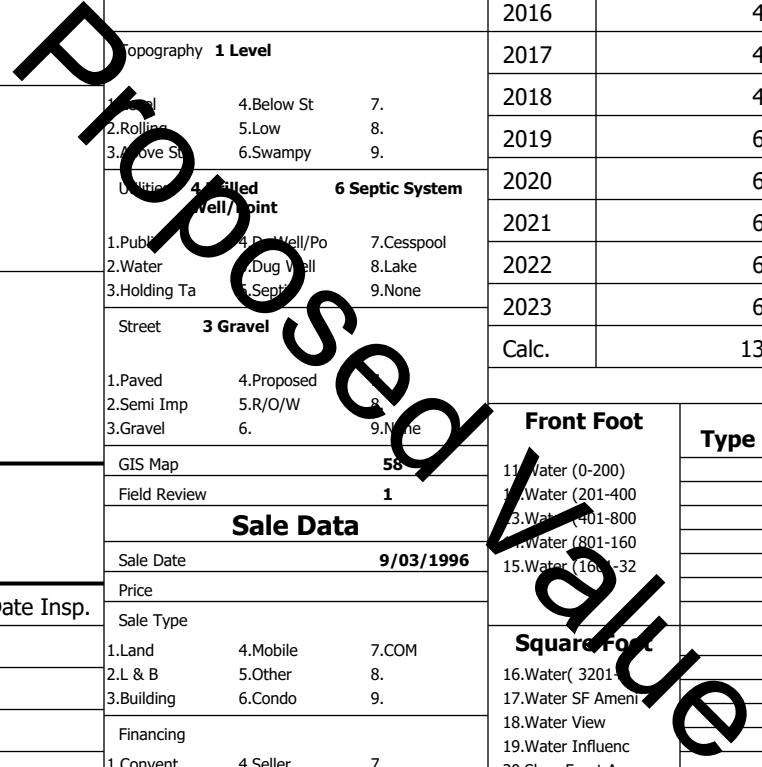

Gray

Map Lot 058-031-024-001

Account 1822

Location 44 SUMMIT RD

Card 1

Of 1

8/05/2024

Building Style 1 Conventional	SF Bsmt Living 900	Layout 1 Typical
1.Conv. 5.Garrison 9.NE farm	Fin Bsmt Grade 2 100	1.Typical 4. 7.
2.Ranch 6.Split 10.Colonia	Secondary Heat 0	2.Inadeq 5. 8.
3.R Ranch/ 7.Contemp 11.Cottage	Heat Type 100% 1 Hot Water BB	3. 6. 9.
4.Cape 8.Log 12.Gambrel	1.HWBB 5.FWA 9.None	Attic 9 None
Dwelling Units 1	2.HWCI 6.Monitor 10.UNH2F	1.1/4 Fin 4.Full Fin 7.
Other Units 0	3.HWRF 7.Electric 11.Geother	2.1/2 Fin 5.F/Stair 8.
Stories 4 One & 1/2 Story	4.Steam 8.F/Wall 12.Heat/Co	3.3/4 Fin 6. 9.None
1.1 4.1.5 7.	Cool Type 0% 9 None	Insulation 1 Full
2.2 5.1.75 8.	1.Central 4.W&C Air 7.	1.Full 4.Minimal 7.
3.3 6.2.5 9.	2.Evapor 5. 8.	2.Heavy 5. 8.
Exterior Walls 8 Wood Shingle	3.H Pump 6. 9.None	3.Capped 6. 9.None
1.Clapboard 5.Stucco 9.B & B	Kitchen Style 2 Typical	Unfinished % 0%
2.Vin/Al 6.Brick 10.Cemplan	1.Modern 4.Obsolete	Grade & Factor 3 Average 100%
3.Compos./ 7.Stone 11.Concret	2.Typical 5. 8.	1.E Grade 4.B Grade 7.SC Grade
4.Asbestos 8.Wood Shi 12.Wood Bo	3.Old Type 6. 9.None	2.C Grade 5.A Grade 8.
Roof Surface 1 Asphalt Shingles	Bath(s) Style 2 Typical Bath(s)	3.D Grade 6.AA Grade 9.Same
1.Asphalt 4.Composit 7.Other	1.Modern 4.Obsolete 7.	SQFT (Footprint) 952
2.Slate 5.Wood 8.	2.Typical 5. 8.	Condition 4 Average
3.Metal 6.Roll Roo 9.	3.Old Type 6. 9.None	1.Poor 2.Avg 7.V G
SF Masonry Trim 0	# Rooms 6	2.Fair 3.Good 8.Exc
SOLAR VOLTAIC 0	# Bedrooms 3	3.Avg- 4.Good 9.Same
OPEN-4- 0	# Full Baths 2	Phys. % Good 0%
Year Built 1987	# Half Baths 0	Funct. % Good 100%
Year Remodeled 0	# Addn Fixtures 0	Functional Code 9 None
Foundation 1 Concrete	# Fireplaces 1	1.Incomp 4.Delap 5.Playo
1.Concrete 4.Wood 7.		2.O-Built 5.Bsmt 6.Long term
2.C Block 5.Slab 8.		3.Damage 6.Style 7.None
3.Br/Stone 6.Piers 9.		Econ. % Good 100%
Basement 4 Full Basement		Economic Code None
1.1/4 Bmt 4.Full Bmt 7.		0.None 3.No Power 6.Obsolete
2.1/2 Bmt 5.Crwl 8.		1.Location 4.Generate 9.None
3.3/4 Bmt 6. 9.None		2.Encroach 5.Flood Pl 9.
Bsmt Gar # Cars 0		Entrance Code 5 Estimated
Wet Basement 1 Dry Basement		1.Interior 4.Vacant 7.
1.Dry 4. 7.		2.Refusal 5.Estimate 8.
2.Damp 5. 8.		3.Informed 6. 9.
3.Wet 6. 9.		Information Code 5 Estimate
		1.Owner 4.Agent 7.
		2.Relative 5.Estimate 8.
		3.Tenant 6.Other 9.



Date Inspected 5/29/2024

Additions, Outbuildings & Improvements							
Type	Year	Units	Grade	Cond	Phys.	Funct.	Sound Value
11 1 Story/Basement	0	330	0 0	0	0	100 %	
21 Open Frame	0	154	0 0	0	0	100 %	
68 Wood Deck	0	120	0 0	0	0	100 %	
23 Frame Garage	2010	1080	3 100	4	0	100 %	
21 Open Frame	0	154	0 0	0	0	100 %	
89 DH Bsmt Entry	0	1	0 0	0	0	100 %	
24 Frame Shed	2013	288	1 100	3	0	100 %	
						%	
						%	
						%	

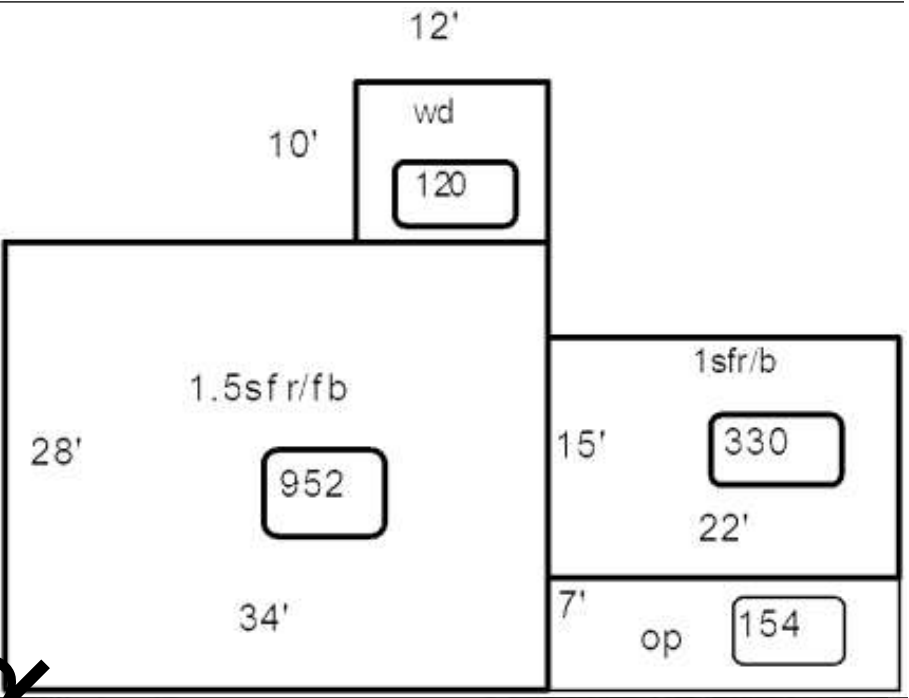

Value