

CONNELL, GARY M  
CONNELL, MELISSA J  
118 LAWRENCE RD  
GRAY ME 04039

B33679P318

Previous Owner  
GRONDIN, PHILIP H  
GRONDIN, BETTE J  
27 WESTCUSTOGO PT  
YARMOUTH ME 04096  
Sale Date: 12/09/2016

Inspection Witnessed By:

X Date

No./Date	Description	Date Insp.

Notes:  
5/24-FR=DR

Gray

Property Data		
Neighborhood	82 Average Location	
Tree Growth Year	0	
REVIEW	0	
Building Permit	0	
Zone/Land Use	11 Rural Residential & Agri	
Secondary Zone		
Topography	2 Rolling	
1. Well	4. Below St	7.
2. Rolling	5. Low	8.
3. Above St	6. Swampy	9.
Utilities	4. Filled Well/Point 6 Septic System	
1. Public	4. Dug Well/Po	7. Cesspool
2. Water	5. Dug Well	8. Lake
3. Holding Ta	6. Septic	9. None
Street	1 Paved	
1. Paved	4. Proposed	8.
2. Semi Imp	5. R/O/W	9.
3. Gravel	6.	9. None
GIS Map	57	
Field Review	1	
Sale Data		
Sale Date	12/09/2016	
Price	415,000	
Sale Type	2 Land & Buildings	
1. Land	4. Mobile	7. COM
2. L & B	5. Other	8.
3. Building	6. Condo	9.
Financing	9 Unknown	
1. Convent	4. Seller	7.
2. FHA/VA	5. Private	8.
3. Assumed	6. Cash	9. Unknown
Validity	1 Arms Length Sale	
1. Valid	4. Split	7. Multiple
2. Related	5. Partial	8. Other
3. Distress	6. Exempt	9. Estate
Verified	5 Public Record	
1. Buyer	4. Agent	7. Family
2. Seller	5. Pub Rec	8. Other
3. Lender	6. MLS	9.

Assessment Record				
Year	Land	Buildings	Exempt	Total
2011	83,000	228,321	0	311,321
2012	83,000	228,321	0	311,321
2013	83,000	228,321	0	311,321
2014	83,000	232,992	0	315,992
2015	83,000	233,000	0	316,000
2016	83,000	233,000	0	316,000
2017	83,000	233,000	0	316,000
2018	83,000	233,000	0	316,000
2019	90,400	319,900	0	410,300
2020	90,400	350,400	20,000	420,800
2021	90,400	350,400	25,000	415,800
2022	90,400	350,400	25,000	415,800
2023	90,400	371,200	25,000	436,600
Calc.	202,400	622,000	25,000	799,400

Land Data					
Type	Effective		Influence		Influence Codes
	Frontage	Depth	Factor	Code	
11. Water (0-200)					1. Unimproved
12. Water (201-400)					2. Excess Frtg
13. Water (401-800)					3. Topography
14. Water (801-1600)					4. Size/Shape
15. Water (1601-3200)					5. Access
					6. Restriction
					7. Open Space
					8. Environmental
					9. Condo
Square Foot	Square Feet		Acres		Acres
16. Water (3201-6400)					
17. Water SF Amen					31. Blueberry(21 -
18. Water View					32. Crop Land
19. Water Influen					33. Pasture
20. ShoreFront A					34. Shorefront B
					35. Shorefront C
					36. ANTENNA SITE
					37. Softwood TG
					38. Mixed Wood TG
					39. Hardwood TG
					40. Wasteland
					41. Woodland
					42. Mobile Home Si
					43. Camp Site
					44. Lot Improvemen
					45. BA SF - Oce
					46. SP Meadow Cond
21. Base Lot	21	1.84	100 %	0	
22. Base Lot Vacan	24	10.00	100 %	0	
23. Base Lot Unpav	25	3.16	100 %	0	
24. Acres to 10					
25. Acres 11-30					
26. Acres 31-50					
27. Acres 51& over					
28. Acres 71 & Ove					
29. Woods (41+)					
Total Acreage			15.00		

**Gray**

Map Lot 057-022-002-000

Account 1140

Location 5 CAMION LANE

Card 1

Of 1

8/05/2024

Building Style <b>2 Ranch</b>	SF Bsmt Living <b>2351</b>	Layout <b>1 Typical</b>
1.Conv. 5.Garrison 9.NE farm	Fin Bsmt Grade <b>3 100</b>	1.Typical 4. 7.
2.Ranch 6.Split 10.Colonia	Secondary Heat <b>2</b>	2.Inadeq 5. 8.
3.R Ranch/ 7.Contemp 11.Cottage	Heat Type <b>100% 1 Hot Water BB</b>	3. 6. 9.
4.Cape 8.Log 12.Gambrel	1.HWBB 5.FWA 9.None	Attic <b>9 None</b>
Dwelling Units <b>1</b>	2.HWCI 6.Monitor 10.UNH2F	1.1/4 Fin 4.Full Fin 7.
Other Units <b>0</b>	3.HWRF 7.Electric 11.Geother	2.1/2 Fin 5.FI/Stair 8.
Stories <b>1 One Story</b>	4.Steam 8.FI/Wall 12.Heat/Co	3.3/4 Fin 6. 9.None
1.1 4.1.5 7.	Cool Type <b>0% 9 None</b>	Insulation <b>1 Full</b>
2.2 5.1.75 8.	1.Central 4.W&C Air 7.	1.Full 4.Minimal 7.
3.3 6.2.5 9.	2.Evapor 5. 8.	2.Heavy 5. 8.
Exterior Walls <b>2 Vinyl/Aluminum</b>	3.H Pump 6. 9.None	3.Capped 6. 9.None
1.Clapboard 5.Stucco 9.B & B	Kitchen Style <b>2 Typical</b>	Unfinished % <b>0%</b>
2.Vin/Al 6.Brick 10.Cemplan	1.Modern 4.Obsolete	Grade & Factor <b>4 Good 100%</b>
3.Compos./ 7.Stone 11.Concret	2.Typical 5. 8.	1.E Grade 4.B Grade 7.SC Grade
4.Asbestos 8.Wood Shi 12.Wood Bo	3.Old Type 6. 9.None	2.D Grade 5.A Grade 8.
Roof Surface <b>1 Asphalt Shingles</b>	Bath(s) Style <b>2 Typical Bath(s)</b>	3.C Grade 6.AA Grade 9.Same
1.Asphalt 4.Composit 7.Other	1.Modern 4.Obsolete 7.	SQFT (Footprint) <b>2351</b>
2.Slate 5.Wood 8.	2.Typical 5. 8.	Condition <b>5 Above Average</b>
3.Metal 6.Roll Roo 9.	3.Old Type 6. 9.None	1.Poor Avg 7.V G
SF Masonry Trim <b>704</b>	# Rooms <b>6</b>	2.Fair Avg 8.Exc
SOLAR VOLTAIC <b>0</b>	# Bedrooms <b>3</b>	3.Avg- Good 9.Same
OPEN-4- <b>0</b>	# Full Baths <b>2</b>	Phys. % Good <b>0%</b>
Year Built <b>1979</b>	# Half Baths <b>1</b>	Funct. % Good <b>100%</b>
Year Remodeled <b>0</b>	# Addn Fixtures <b>0</b>	Functional Code <b>9 None</b>
Foundation <b>1 Concrete</b>	# Fireplaces <b>0</b>	1.Incomp 4.Delap 5.Delay
1.Concrete 4.Wood 7.		2.O-Built 5.Bsmt 6.Land Term
2.C Block 5.Slab 8.		3.Damage 6.Style None
3.Br/Stone 6.Piers 9.		Econ. % Good <b>100%</b>
Basement <b>4 Full Basement</b>		Economic Code <b>None</b>
1.1/4 Bmt 4.Full Bmt 7.		0.None 3.No Power 6.Obsolete
2.1/2 Bmt 5.Crw 8.		1.Location 4.Generate 9.None
3.3/4 Bmt 6. 9.None		2.Encroach 5.Flood Pl 9.
Bsmt Gar # Cars <b>0</b>		Entrance Code <b>5 Estimated</b>
Wet Basement <b>1 Dry Basement</b>		1.Interior 4.Vacant 7.
1.Dry 4. 7.		2.Refusal 5.Estimate 8.
2.Damp 5. 8.		3.Informed 6. 9.
3.Wet 6. 9.		Information Code <b>5 Estimate</b>
		1.Owner 4.Agent 7.
		2.Relative 5.Estimate 8.
		3.Tenant 6.Other 9.

Date Inspected 5/29/2024

**Additions, Outbuildings & Improvements**

Type	Year	Units	Grade	Cond	Phys.	Funct.	Sound Value
73 1.25 St Garage	1987	1200	0 0	0	0	100 %	1.One Story Fram
68 Wood Deck	1987	232	0 0	0	0	100 %	2.Two Story Fram
41 2S Open Fr Porch	0	180	0 0	0	0	100 %	3.Three Story Fr
26 1SFr Overhang	0	56	0 0	0	0	100 %	4.1 & 1/2 Story
23 Frame Garage	0	432	3 100	2	0	100 %	5.1 & 3/4 Story
73 1.25 St Garage	2018	1600	3 100	4	0	100 %	6.2 & 1/2 Story
						%	21.Open Frame Por
						%	22.Encl Frame Por
						%	23.Frame Garage
						%	24.Frame Shed
						%	25.Frame Bay Wind
						%	26.1SFr Overhang
						%	27.Unfin Basement
						%	28.Unfinished Att
						%	29.Finished Attic

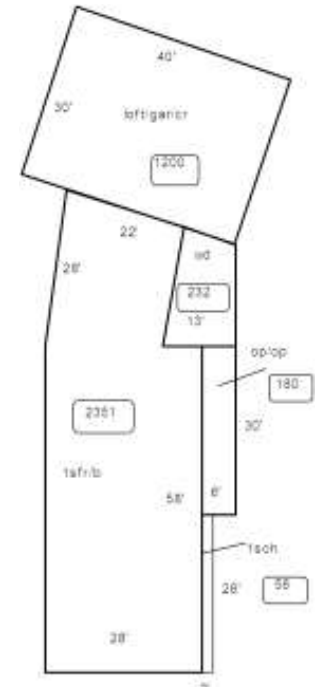

Proposed

Entrance Value