

RICHTER, JONATHAN D  
RICHTER, BRENDA J  
19 CABELL SHORE RD  
GRAY ME 04039

B4975P94

Inspection Witnessed By:

No./Date	Description	Date Insp.
X		

Notes:  
5/24- DR FIELD REVIEW

Gray

Property Data			Assessment Record				
Neighborhood	82 Average Location		Year	Land	Buildings	Exempt	Total
Tree Growth Year	0		2011	49,500	138,873	8,500	179,873
REVIEW	0		2012	49,500	138,873	8,500	179,873
Building Permit	0		2013	49,500	138,873	8,500	179,873
Zone/Land Use	11 Rural Residential & Agri		2014	49,500	140,310	8,500	181,310
Secondary Zone	25 Stream Protection		2015	49,500	140,300	9,000	180,800
Topography	2 Rolling		2016	49,500	140,300	9,000	180,800
1. Hill	4. Below St	7.	2017	47,500	140,300	13,500	174,300
2. Rolling	5. Low	8.	2018	47,500	140,300	18,000	169,800
3. Above St	6. Swampy	9.	2019	72,000	189,200	20,000	241,200
Utilities	4. Filled Well/Point		2020	72,000	189,200	20,000	241,200
1. Public	4. Dug Well/Po	7. Cesspool	2021	72,000	189,200	25,000	236,200
2. Water	5. Dug Well	8. Lake	2022	72,000	189,200	25,000	236,200
3. Holding Ta	6. Septic	9. None	2023	72,000	213,700	25,000	260,700
Street	1 Paved		Calc.	129,000	299,000	25,000	403,000
1. Paved	4. Proposed	8.	<b>Land Data</b>				
2. Semi Imp	5. R/O/W	9.	<b>Front Foot</b>	<b>Type</b>	<b>Effective</b>	<b>Influence</b>	<b>Influence</b>
3. Gravel	6.	9. None	11. Water (0-200)		<b>Frontage</b>	<b>Depth</b>	<b>Factor</b>
GIS Map	56		12. Water (201-400)				<b>Code</b>
Field Review	1		13. Water (401-800)				1. Unimproved
<b>Sale Data</b>			14. Water (801-160)				2. Excess Frtg
Sale Date			15. Water (161-32)				3. Topography
Price			<b>Square Foot</b>				4. Size/Shape
Sale Type			16. Water (3201-)				5. Access
1. Land	4. Mobile	7. COM	17. Water SF Amen				6. Restriction
2. L & B	5. Other	8.	18. Water View				7. Open Space
3. Building	6. Condo	9.	19. Water Influen				8. Environmental
Financing			20. ShoreFront A				9. Condo
1. Convent	4. Seller	7.	<b>Fract. Acre</b>				<b>Acres</b>
2. FHA/VA	5. Private	8.	21. Base Lot	21	1.84	100 %	30. Blueberry(1-20
3. Assumed	6. Cash	9. Unknown	22. Base Lot Vacan	24	0.66	100 %	31. Blueberry(21 -
Validity			23. Base Lot Unpav				32. Crop Land
1. Valid	4. Split	7. Multiple	<b>Acres</b>				33. Pasture
2. Related	5. Partial	8. Other	24. Acres to 10				34. Shorefront B
3. Distress	6. Exempt	9. Estate	25. Acres 11-30				35. Shorefront C
Verified			26. Acres 31-50				36. ANTENNA SITE
1. Buyer	4. Agent	7. Family	27. Acres 51& over				37. Softwood TG
2. Seller	5. Pub Rec	8. Other	28. Acres 71 & Ove				38. Mixed Wood TG
3. Lender	6. MLS	9.	29. Woods (41+)				39. Hardwood TG
				<b>Total Acreage</b>		2.50	40. Wasteland
							41. Woodland
							42. Mobile Home Si
							43. Camp Site
							44. Lot Improvemen
							45. BA SF - Oce
							46. SP Meadow Cond

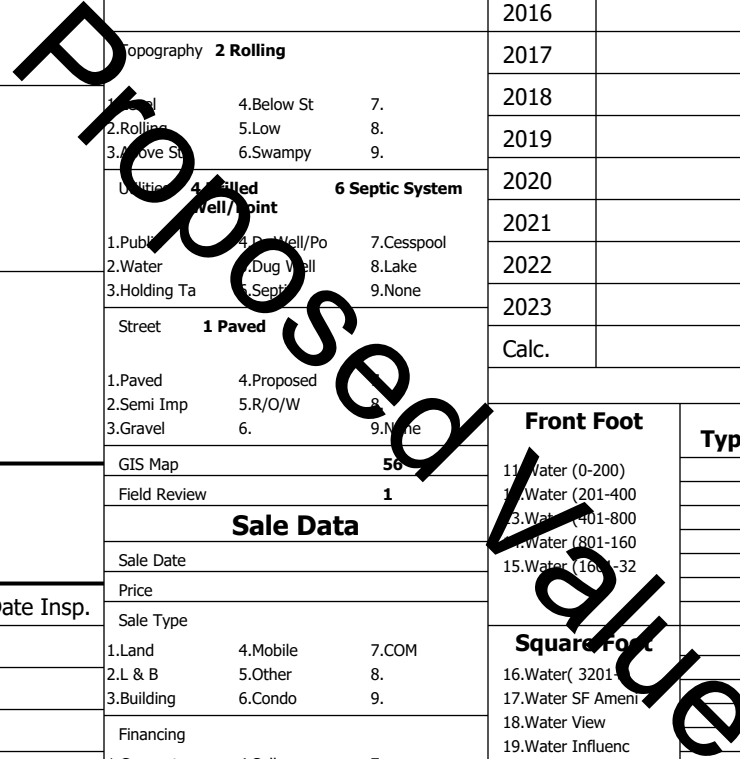

**Gray**

Map Lot 056-017-016-001

Account 828

Location 19 CABELL SHORE RD

Card 1

Of 1

8/05/2024

Building Style <b>12 Gambrel</b>	SF Bsmt Living <b>0</b>	Layout <b>1 Typical</b>
1.Conv. 5.Garrison 9.NE farm	Fin Bsmt Grade <b>0 0</b>	1.Typical 4. 7.
2.Ranch 6.Split 10.Colonia	Secondary Heat <b>0</b>	2.Inadeq 5. 8.
3.R Ranch/ 7.Contemp 11.Cottage	Heat Type <b>100% 5 Forced Warm Air</b>	3. 6. 9.
4.Cape 8.Log 12.Gambrel	1.HWBB 5.FWA 9.None	Attic <b>9 None</b>
Dwelling Units <b>1</b>	2.HWCI 6.Monitor 10.UNH2F	1.1/4 Fin 4.Full Fin 7.
Other Units <b>0</b>	3.HWRF 7.Electric 11.Geother	2.1/2 Fin 5.FI/Stair 8.
Stories <b>5 One &amp; 3/4 Story</b>	4.Steam 8.FI/Wall 12.Heat/Co	3.3/4 Fin 6. 9.None
1.1 4.1.5 7.	Cool Type <b>0% 9 None</b>	Insulation <b>1 Full</b>
2.2 5.1.75 8.	1.Central 4.W&C Air 7.	1.Full 4.Minimal 7.
3.3 6.2.5 9.	2.Evapor 5. 8.	2.Heavy 5. 8.
Exterior Walls <b>16 Vertical Boards</b>	3.H Pump 6. 9.None	3.Capped 6. 9.None
1.Clapboar 5.Stucco 9.B & B	Kitchen Style <b>2 Typical</b>	Unfinished % <b>0%</b>
2.Vin/Al 6.Brick 10.Cemplan	1.Modern 4.Obsolete	Grade & Factor <b>3 Average 110%</b>
3.Compos./ 7.Stone 11.Concret	2.Typical 5. 8.	1.E Grade 4.B Grade 7.SC Grade
4.Asbestos 8.Wood Shi 12.Wood Bo	3.Old Type 6. 9.None	2.D Grade 5.A Grade 8.
Roof Surface <b>1 Asphalt Shingles</b>	Bath(s) Style <b>2 Typical Bath(s)</b>	3.O Grade 6.AA Grade 9.Same
1.Asphalt 4.Composit 7.Other	1.Modern 4.Obsolete 7.	SQFT (Footprint) <b>936</b>
2.Slate 5.Wood 8.	2.Typical 5. 8.	Foundation <b>4 Average</b>
3.Metal 6.Roll Roo 9.	3.Old Type 6. 9.None	1.Poor 4.Avg 7.V G
SF Masonry Trim <b>0</b>	# Rooms <b>5</b>	2.Fair 5.Avg 8.Exc
SOLAR VOLTAIC <b>0</b>	# Bedrooms <b>3</b>	3.Avg- 6.Good 9.Same
OPEN-4- <b>0</b>	# Full Baths <b>1</b>	Phys. % Good <b>0%</b>
Year Built <b>1983</b>	# Half Baths <b>1</b>	Funct. % Good <b>0%</b>
Year Remodeled <b>0</b>	# Addn Fixtures <b>0</b>	Functional Code <b>9 None</b>
Foundation <b>1 Concrete</b>	# Fireplaces <b>1</b>	1.Incomp 4.Delap 5.Layoff
1.Concrete 4.Wood 7.		2.O-Built 5.Bsmt 6.Long term
2.C Block 5.Slab 8.		3.Damage 6.Style None
3.Br/Stone 6.Piers 9.		Econ. % Good <b>100%</b>
Basement <b>4 Full Basement</b>		Economic Code <b>None</b>
1.1/4 Bmt 4.Full Bmt 7.		0.None 3.No Power 6.Obsolete
2.1/2 Bmt 5.CrwI 8.		1.Location 4.Generate 9.None
3.3/4 Bmt 6. 9.None		2.Encroach 5.Flood Pl 9.
Bsmt Gar # Cars <b>0</b>		Entrance Code <b>5 Estimated</b>
Wet Basement <b>1 Dry Basement</b>		1.Interior 4.Vacant 7.
1.Dry 4. 7.		2.Refusal 5.Estimate 8.
2.Damp 5. 8.		3.Informed 6. 9.
3.Wet 6. 9.		Information Code <b>5 Estimate</b>
		1.Owner 4.Agent 7.
		2.Relative 5.Estimate 8.
		3.Tenant 6.Other 9.

Date Inspected 5/24/2024

**Additions, Outbuildings & Improvements**

Type	Year	Units	Grade	Cond	Phys.	Funct.	Sound Value
22 Encl Frame Porch	0	200	0 0	0	0	100 %	
27 Unfin Basement	0	200	0 0	0	0	100 %	
68 Wood Deck	0	304	0 0	0	0	100 %	
22 Encl Frame Porch	0	72	0 0	0	0	100 %	
43 2S Frame Garage	0	720	0 0	0	0	100 %	
71 Carport	0	336	0 0	0	0	100 %	
61 Canopy	2010	120	0 0	0	0	100 %	
24 Frame Shed	2010	1008	3 100	3	0	100 %	
61 Canopy	2000	288	3 100	3	0	100 %	

