

BAILEY, NEILS G  
BAILEY, GLORIA R  
2 BAILEY DR  
GRAY ME 04039

B4692P1 B34855P253

<b>Property Data</b>		
Neighborhood	82 Average Location	
Tree Growth Year	0	
REVIEW	0	
Building Permit	0	
Zone/Land Use	11 Rural Residential & Agri	
Secondary Zone		
Topography	2 Rolling	
1. Hill	4. Below St	7.
2. Rolling	5. Low	8.
3. Above St	6. Swampy	9.
Utilities	2 Public Water 6 Septic System	
1. Public	4. Drilled Well/Po	7. Cesspool
2. Water	5. Dug Well	8. Lake
3. Holding Ta	6. Septic	9. None
Street	3 Gravel	
1. Paved	4. Proposed	8.
2. Semi Imp	5. R/O/W	9.
3. Gravel	6.	
GIS Map	53	
Field Review	1	

Inspection Witnessed By:

X		Date
No./Date	Description	Date Insp.

Notes:  
5/24 DR FIELD REVIEW

Gray

<b>Assessment Record</b>				
Year	Land	Buildings	Exempt	Total
2011	77,000	237,683	8,500	306,183
2012	77,000	237,683	8,500	306,183
2013	77,000	237,683	8,500	306,183
2014	77,000	241,520	8,500	310,020
2015	77,000	241,500	9,000	309,500
2016	77,000	241,500	9,000	309,500
2017	77,000	241,500	13,500	305,000
2018	77,000	241,500	18,000	300,500
2019	105,300	335,800	20,000	421,100
2020	100,800	335,800	20,000	416,600
2021	100,800	335,800	25,000	411,600
2022	100,800	377,900	25,000	453,700
2023	100,800	405,200	25,000	481,000
Calc.	223,300	582,400	25,000	780,700

<b>Land Data</b>						
<b>Front Foot</b>	<b>Type</b>	<b>Effective</b>		<b>Influence</b>		<b>Influence Codes</b>
		<b>Frontage</b>	<b>Depth</b>	<b>Factor</b>	<b>Code</b>	
11. Water (0-200)				%		1. Unimproved
12. Water (201-400)				%		2. Excess Frtg
13. Water (401-800)				%		3. Topography
14. Water (801-160)				%		4. Size/Shape
15. Water (1601-32)				%		5. Access
				%		6. Restriction
				%		7. Open Space
				%		8. Environmental
				%		9. Condo
<b>Square Foot</b>		<b>Square Feet</b>				<b>Acres</b>
16. Water (3201-				%		30. Blueberry(1-20
17. Water SF Amen				%		31. Blueberry(21 -
18. Water View				%		32. Crop Land
19. Water Influen				%		33. Pasture
20. ShoreFront A				%		34. Shorefront B
				%		35. Shorefront C
<b>Fract. Acre</b>		<b>Acreege/Sites</b>				36. ANTENNA SITE
21. Base Lot	23	1.84	100	%	0	37. Softwood TG
22. Base Lot Vacan	24	10.00	100	%	0	38. Mixed Wood TG
23. Base Lot Unpav	25	7.88	100	%	0	39. Hardwood TG
<b>Acres</b>				%		40. Wasteland
24. Acres to 10				%		41. Woodland
25. Acres 11-30				%		42. Mobile Home Si
26. Acres 31-50				%		43. Camp Site
27. Acres 51& over				%		44. Lot Improvemen
28. Acres 71 & Ove				%		45. BA SF - Oce
29. Woods (41+)				%		46. SP Meadow Cond
<b>Total Acreage</b>				19.72		

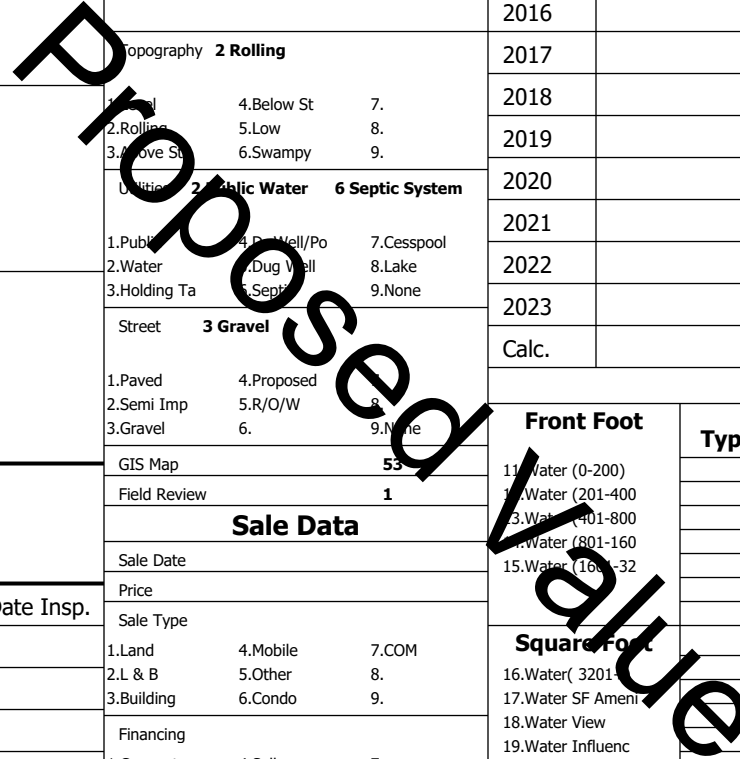

**Gray**

Map Lot 053-043-022-000

Account 2709

Location 2 BAILEY DR

Card 1

Of 1

8/05/2024

Building Style <b>4 Cape Cod</b>	SF Bsmt Living <b>900</b>	Layout <b>1 Typical</b>
1.Conv. 5.Garrison 9.NE farm	Fin Bsmt Grade <b>3 100</b>	1.Typical 4. 7.
2.Ranch 6.Split 10.Colonia	Secondary Heat <b>0</b>	2.Inadeq 5. 8.
3.R Ranch/ 7.Contemp 11.Cottage	Heat Type <b>100% 1 Hot Water BB</b>	3. 6. 9.
4.Cape 8.Log 12.Gambrel	1.HWBB 5.FWA 9.None	Attic <b>9 None</b>
Dwelling Units <b>1</b>	2.HWCI 6.Monitor 10.UNH2F	1.1/4 Fin 4.Full Fin 7.
Other Units <b>0</b>	3.HWRF 7.Electric 11.Geother	2.1/2 Fin 5.FI/Stair 8.
Stories <b>4 One &amp; 1/2 Story</b>	4.Steam 8.FI/Wall 12.Heat/Co	3.3/4 Fin 6. 9.None
1.1 4.1.5 7.	Cool Type <b>0% 9 None</b>	Insulation <b>1 Full</b>
2.2 5.1.75 8.	1.Central 4.W&C Air 7.	1.Full 4.Minimal 7.
3.3 6.2.5 9.	2.Evapor 5. 8.	2.Heavy 5. 8.
Exterior Walls <b>2 Vinyl/Aluminum</b>	3.H Pump 6. 9.None	3.Capped 6. 9.None
1.Clapboar 5.Stucco 9.B & B	Kitchen Style <b>2 Typical</b>	Unfinished % <b>0%</b>
2.Vin/Al 6.Brick 10.Cemplan	1.Modern 4.Obsolete	Grade & Factor <b>3 Average 110%</b>
3.Compos./ 7.Stone 11.Concret	2.Typical 5. 8.	1.E Grade 4.B Grade 7.SC Grade
4.Asbestos 8.Wood Shi 12.Wood Bo	3.Old Type 6. 9.None	2.A Grade 5.A Grade 8.
Roof Surface <b>1 Asphalt Shingles</b>	Bath(s) Style <b>2 Typical Bath(s)</b>	3.C Grade 6.AA Grade 9.Same
1.Asphalt 4.Composit 7.Other	1.Modern 4.Obsolete 7.	SQFT (Footprint) <b>900</b>
2.Slate 5.Wood 8.	2.Typical 5. 8.	Condition <b>5 Good</b>
3.Metal 6.Roll Roo 9.	3.Old Type 6. 9.None	1.Poor 2.Avg 7.V G
SF Masonry Trim <b>0</b>	# Rooms <b>6</b>	2.Fair 3.Good 8.Exc
SOLAR VOLTAIC <b>0</b>	# Bedrooms <b>3</b>	3.Avg- 4.Good 9.Same
OPEN-4- <b>0</b>	# Full Baths <b>2</b>	Phys. % Good <b>0%</b>
Year Built <b>1973</b>	# Half Baths <b>1</b>	Funct. % Good <b>100%</b>
Year Remodeled <b>2004</b>	# Addn Fixtures <b>1</b>	Functional Code <b>9 None</b>
Foundation <b>1 Concrete</b>	# Fireplaces <b>1</b>	1.Incomp 4.Delap 5.Damage
1.Concrete 4.Wood 7.		2.O-Built 5.Bsmt 6.Long term
2.C Block 5.Slab 8.		3.Damage 6.Style 7.None
3.Br/Stone 6.Piers 9.		Econ. % Good <b>100%</b>
Basement <b>4 Full Basement</b>		Economic Code <b>None</b>
1.1/4 Bmt 4.Full Bmt 7.		0.None 3.No Power 6.Obsolete
2.1/2 Bmt 5.Crwl 8.		1.Location 4.Generate 9.None
3.3/4 Bmt 6. 9.None		2.Encroach 5.Flood Pl 9.
Bsmt Gar # Cars <b>0</b>		Entrance Code <b>5 Estimated</b>
Wet Basement <b>1 Dry Basement</b>		1.Interior 4.Vacant 7.
1.Dry 4. 7.		2.Refusal 5.Estimate 8.
2.Damp 5. 8.		3.Informed 6. 9.
3.Wet 6. 9.		Information Code <b>5 Estimate</b>
		1.Owner 4.Agent 7.
		2.Relative 5.Estimate 8.
		3.Tenant 6.Other 9.

Date Inspected 5/28/2024

**Additions, Outbuildings & Improvements**

Type	Year	Units	Grade	Cond	Phys.	Funct.	Sound Value
11 1 Story/Basement	1979	360	0 0	0	0	100 %	1.One Story Fram
1 One Story Frame	2001	240	0 0	0	0	100 %	2.Two Story Fram
41 2S Open Fr Porch	0	240	0 0	0	0	100 %	3.Three Story Fr
24 Frame Shed	0	216	2 100	4	0	100 %	4.1 & 1/2 Story
63 Swimming Pool	0	800	3 100	4	0	50 %	5.1 & 3/4 Story
75 1.75 St Garage	2004	864	0 0	0	0	100 %	6.2 & 1/2 Story
68 Wood Deck	2004	48	0 0	0	0	100 %	21.Open Frame Por
24 Frame Shed	0	0	0 0	0	0	100 %	22.Encl Frame Por
23 Frame Garage	1979	1536	0 0	0	0	100 %	23.Frame Garage
80 3/4 St/Garage	1979	1536	0 0	0	0	100 %	24.Frame Shed
							25.Frame Bay Wind
							26.1SFr Overhang
							27.Unfin Basement
							28.Unfinished Att
							29.Finished Attic

