

COLELLO, PETER D
280 YARMOUTH RD
GRAY ME 04039

B15135P221

Property Data			Assessment Record				
Neighborhood	82 Average Location		Year	Land	Buildings	Exempt	Total
Tree Growth Year	0		2011	51,600	41,990	8,500	85,090
REVIEW	0		2012	51,600	41,990	8,500	85,090
Building Permit	0		2013	51,600	41,990	8,500	85,090
Zone/Land Use	11 Rural Residential & Agri		2014	51,600	41,990	8,500	85,090
Secondary Zone			2015	51,600	42,000	9,000	84,600
Topography	2 Rolling		2016	51,600	42,000	9,000	84,600
1. Hill	4. Below St	7.	2017	51,600	42,000	13,500	80,100
2. Rolling	5. Low	8.	2018	51,600	42,000	18,000	75,600
3. Above St	6. Swampy	9.	2019	84,300	68,400	20,000	132,700
Utilities	2 Public Water	6 Septic System	2020	84,300	68,400	20,000	132,700
1. Public	4. Dr. Well/Po	7. Cesspool	2021	84,300	68,400	25,000	127,700
2. Water	8. Dug Well	8. Lake	2022	84,300	68,400	25,000	127,700
3. Holding Ta	5. Septic	9. None	2023	84,300	68,400	25,000	127,700
Street	1 Paved		Calc.	153,600	97,300	25,000	225,900
1. Paved	4. Proposed	8.	Land Data				
2. Semi Imp	5. R/O/W	9.	Front Foot	Type	Effective	Influence	Influence
3. Gravel	6.	9. None	11. Water (0-200)		Frontage	Depth	Factor
GIS Map	53		12. Water (201-400)				Code
Field Review	1		13. Water (401-800)				1. Unimproved
Sale Data			14. Water (801-160)				2. Excess Frtg
Sale Date	10/28/1999		15. Water (161-32)				3. Topography
Price			Square Foot				4. Size/Shape
Sale Type			16. Water(3201-				5. Access
1. Land	4. Mobile	7.COM	17. Water SF Amen				6. Restriction
2. L & B	5. Other	8.	18. Water View				7. Open Space
3. Building	6. Condo	9.	19. Water Influen				8. Environmental
Financing			20. ShoreFront A				9. Condo
1. Convent	4. Seller	7.	Fract. Acre				Acres
2. FHA/VA	5. Private	8.	21. Base Lot	21	1.84	100 %	30. Blueberry(1-20
3. Assumed	6. Cash	9. Unknown	22. Base Lot Vacan	24	4.76	100 %	31. Blueberry(21 -
Validity			23. Base Lot Unpav				32. Crop Land
1. Valid	4. Split	7. Multiple	Acres				33. Pasture
2. Related	5. Partial	8. Other	24. Acres to 10				34. Shorefront B
3. Distress	6. Exempt	9. Estate	25. Acres 11-30				35. Shorefront C
Verified			26. Acres 31-50				36. ANTENNA SITE
1. Buyer	4. Agent	7. Family	27. Acres 51& over				37. Softwood TG
2. Seller	5. Pub Rec	8. Other	28. Acres 71 & Ove				38. Mixed Wood TG
3. Lender	6. MLS	9.	29. Woods (41+)				39. Hardwood TG
				Total Acreage		6.60	40. Wasteland
							41. Woodland
							42. Mobile Home Si
							43. Camp Site
							44. Lot Improvemen
							45. BA SF - Oce
							46. SP Meadow Cond

Inspection Witnessed By:

X	Date	Date Insp.
No./Date	Description	Date Insp.

Notes:
5/24 DR FIELD REVIEW

Gray

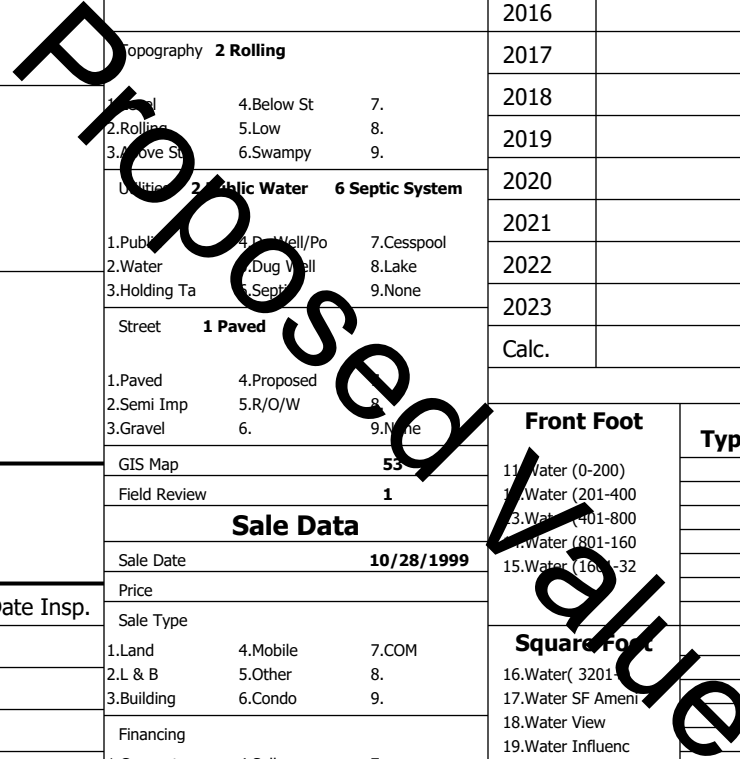

Gray

Map Lot 053-043-008-003

Account 2727

Location 280 YARMOUTH RD

Card 1

Of 1

8/05/2024

Building Style 0	SF Bsmt Living 0	Layout 0
1.Conv. 5.Garrison 9.NE farm	Fin Bsmt Grade 0 0	1.Typical 4. 7.
2.Ranch 6.Split 10.Colonia	Secondary Heat 0	2.Inadeq 5. 8.
3.R Ranch/ 7.Contemp 11.Cottage	Heat Type 100% 0	3. 6. 9.
4.Cape 8.Log 12.Gambrel	1.HWBB 5.FWA 9.None	Attic 0
Dwelling Units 0	2.HWCI 6.Monitor 10.UNH2F	1.1/4 Fin 4.Full Fin 7.
Other Units 0	3.HWRF 7.Electric 11.Geother	2.1/2 Fin 5.FI/Stair 8.
Stories 0	4.Steam 8.FI/Wall 12.Heat/Co	3.3/4 Fin 6. 9.None
1.1 4.1.5 7.	Cool Type 0% 9 None	Insulation 0
2.2 5.1.75 8.	1.Central 4.W&C Air 7.	1.Full 4.Minimal 7.
3.3 6.2.5 9.	2.Evapor 5. 8.	2.Heavy 5. 8.
Exterior Walls 0	3.H Pump 6. 9.None	3.Capped 6. 9.None
1.Clapboa 5.Stucco 9.B & B	Kitchen Style 0	Unfinished % 0%
2.Vin/Al 6.Brick 10.Cemplan	1.Modern 4.Obsolete	Grade & Factor 0 0%
3.Compos./ 7.Stone 11.Concret	2.Typical 5. 8.	1.E Grade 4.B Grade 7.SC Grade
4.Asbestos 8.Wood Shi 12.Wood Bo	3.Old Type 6. 9.None	2.D Grade 5.A Grade 8.
Roof Surface 0	Bath(s) Style 0	3.C Grade 6.AA Grade 9.Same
1.Asphalt 4.Composit 7.Other	1.Modern 4.Obsolete 7.	SQFT (Footprint) 0
2.Slate 5.Wood 8.	2.Typical 5. 8.	1.Poor 2.Avg 7.V G
3.Metal 6.Roll Roo 9.	3.Old Type 6. 9.None	2.Fair 3.Good 8.Exc
SF Masonry Trim 0	# Rooms 0	3.Avg- 4.Good 9.Same
SOLAR VOLTAIC 0	# Bedrooms 0	Phys. % Good 0%
OPEN-4- 0	# Full Baths 0	Funct. % Good 100%
Year Built 0	# Half Baths 0	Functional Code 9 None
Year Remodeled 0	# Addn Fixtures 0	1.Incomp 4.Delap 5.Layoff
Foundation 0	# Fireplaces 0	2.O-Built 5.Bsmt 6.Long term
1.Concrete 4.Wood 7.		3.Damage 6.Style None
2.C Block 5.Slab 8.		Econ. % Good 100%
3.Br/Stone 6.Piers 9.		Economic Code None
Basement 0		0.None 3.No Power 6.Obsolete
1.1/4 Bmt 4.Full Bmt 7.		1.Location 4.Generate 9.None
2.1/2 Bmt 5.Crwl 8.		2.Encroach 5.Flood Pl 9.
3.3/4 Bmt 6. 9.None		Entrance Code 5 Estimated
Bsmt Gar # Cars 0		1.Interior 4.Vacant 7.
Wet Basement 0		2.Refusal 5.Estimate 8.
1.Dry 4. 7.		3.Informed 6. 9.
2.Damp 5. 8.		Information Code 5 Estimate
3.Wet 6. 9.		1.Owner 4.Agent 7.
		2.Relative 5.Estimate 8.
		3.Tenant 6.Other 9.

Date Inspected 5/28/2024

Additions, Outbuildings & Improvements

Type	Year	Units	Grade	Cond	Phys.	Funct.	Sound Value
998 14Mobile Home	1978	14x60	2 100	4	0 %	100 %	
23 Frame Garage	2009	1320	3 100	4	0 %	100 %	
11 1 Story/Basement	0	360	2 100	0	0 %	100 %	
68 Wood Deck	0	168	3 100	0	0 %	100 %	
24 Frame Shed	2009	186	2 100	4	0 %	100 %	
27 Unfin Basement	1978	840	2 100	0	0 %	100 %	
					%	%	
					%	%	
					%	%	
					%	%	
					%	%	

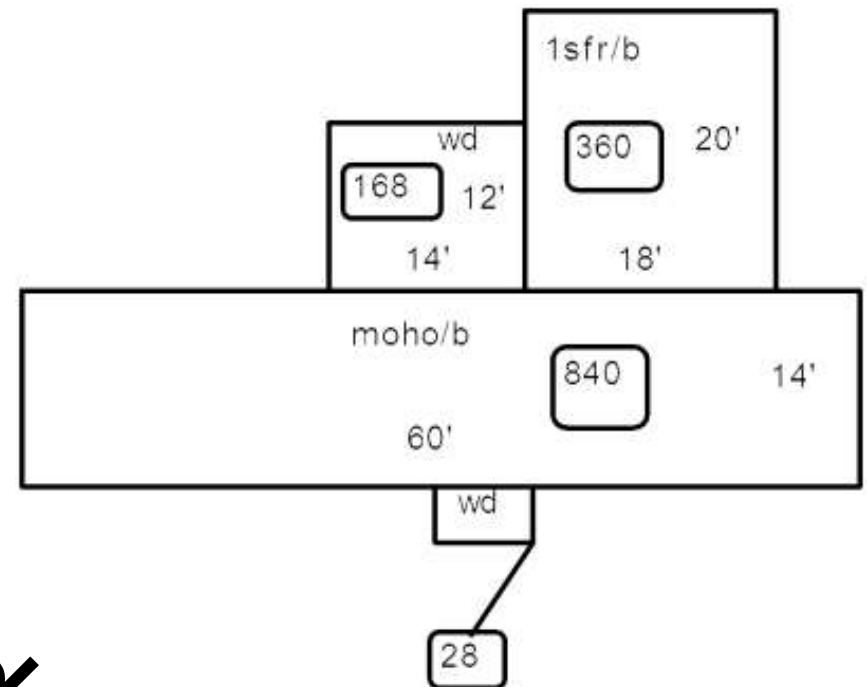

Proposed Value