

TRACY, JENNIFER K
TRACY, TYLER H
231 YARMOUTH ROAD
GRAY ME 04039

B38555P109

Previous Owner
HOWARD, JOHN C
HARRIS, STEPHEN P
231 YARMOUTH ROAD
GRAY ME 04039
Sale Date: 8/17/2021

Property Data		
Neighborhood	82 Average Location	
Tree Growth Year	0	
REVIEW	0	
Building Permit	0	
Zone/Land Use	11 Rural Residential & Agri	
Secondary Zone		
Topography	1 Level	
1. Well	4. Below St	7.
2. Rolling	5. Low	8.
3. Above St	6. Swampy	9.
Utilities	2 Public Water 6 Septic System	
1. Public	4. Dr. Well/Po	7. Cesspool
2. Water	5. Dug Well	8. Lake
3. Holding Ta	6. Septic	9. None
Street	1 Paved	
1. Paved	4. Proposed	8.
2. Semi Imp	5. R/O/W	9.
3. Gravel	6.	
GIS Map	53	
Field Review	1	
Sale Data		
Sale Date	8/17/2021	
Price	320,000	
Sale Type	2 Land & Buildings	
1. Land	4. Mobile	7. COM
2. L & B	5. Other	8.
3. Building	6. Condo	9.
Financing	1 Conventional	
1. Convent	4. Seller	7.
2. FHA/VA	5. Private	8.
3. Assumed	6. Cash	9. Unknown
Validity	1 Arms Length Sale	
1. Valid	4. Split	7. Multiple
2. Related	5. Partial	8. Other
3. Distress	6. Exempt	9. Estate
Verified	5 Public Record	
1. Buyer	4. Agent	7. Family
2. Seller	5. Pub Rec	8. Other
3. Lender	6. MLS	9.

Assessment Record				
Year	Land	Buildings	Exempt	Total
2011	44,000	132,130	0	176,130
2012	44,000	132,130	0	176,130
2013	44,000	132,130	0	176,130
2014	44,000	133,629	0	177,629
2015	44,000	133,600	0	177,600
2016	44,000	133,600	0	177,600
2017	44,000	133,600	0	177,600
2018	44,000	133,600	0	177,600
2019	65,400	157,900	0	223,300
2020	65,400	157,900	0	223,300
2021	65,400	157,900	0	223,300
2022	65,400	157,900	0	223,300
2023	65,400	181,200	25,000	221,600
Calc.	121,600	279,200	25,000	375,800

Land Data					
Type	Effective		Influence		Influence Codes
	Frontage	Depth	Factor	Code	
1. Water (0-200)			%		1. Unimproved
2. Water (201-400)			%		2. Excess Frtg
3. Water (401-800)			%		3. Topography
4. Water (801-1600)			%		4. Size/Shape
5. Water (1601-3200)			%		5. Access
6. Water (3201-6400)			%		6. Restriction
7. Water (6401-12800)			%		7. Open Space
8. Water (12801-25600)			%		8. Environmental
9. Water (25601-51200)			%		9. Condo
10. Water (51201-102400)			%		
11. Water (102401-204800)			%		
12. Water (204801-409600)			%		
13. Water (409601-819200)			%		
14. Water (819201-1638400)			%		
15. Water (1638401-3276800)			%		
16. Water (3276801-6553600)			%		
17. Water SF Amen			%		
18. Water View			%		
19. Water Influen			%		
20. ShoreFront A			%		
21. Base Lot			%		
22. Base Lot Vacan			%		
23. Base Lot Unpav			%		
24. Acres to 10			%		
25. Acres 11-30			%		
26. Acres 31-50			%		
27. Acres 51& over			%		
28. Acres 71 & Ove			%		
29. Woods (41+)			%		
Total Acreage				1.40	

Inspection Witnessed By:

No./Date	Description	Date Insp.
X		

Notes:
5/24 DR FIELD REVIEW

Gray

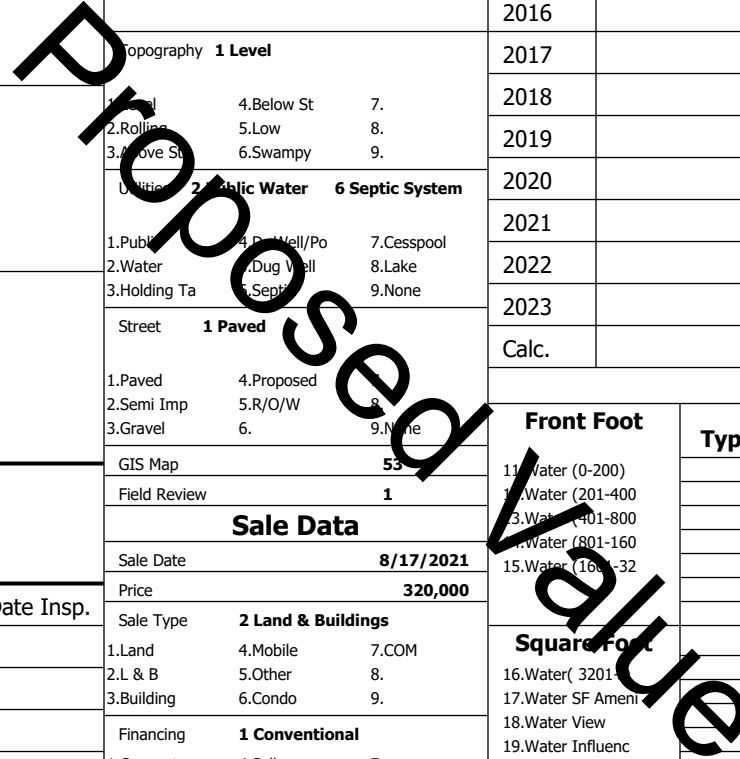

Gray

Map Lot 053-038-008-000

Account 2245

Location 231 YARMOUTH RD

Card 1

Of 1

8/05/2024

Building Style 7 Contemporary	SF Bsmt Living 0	Layout 1 Typical
1.Conv. 5.Garrison 9.NE farm	Fin Bsmt Grade 0 0	1.Typical 4. 7.
2.Ranch 6.Split 10.Colonia	Secondary Heat 0	2.Inadeq 5. 8.
3.R Ranch/ 7.Contemp 11.Cottage	Heat Type 100% 5 Forced Warm Air	3. 6. 9.
4.Cape 8.Log 12.Gambrel	1.HWBB 5.FWA 9.None	Attic 9 None
Dwelling Units 1	2.HWCI 6.Monitor 10.UNH2F	1.1/4 Fin 4.Full Fin 7.
Other Units 0	3.HWRF 7.Electric 11.Geother	2.1/2 Fin 5.FI/Stair 8.
Stories 5 One & 3/4 Story	4.Steam 8.FI/Wall 12.Heat/Co	3.3/4 Fin 6. 9.None
1.1 4.1.5 7.	Cool Type 0% 9 None	Insulation 1 Full
2.2 5.1.75 8.	1.Central 4.W&C Air 7.	1.Full 4.Minimal 7.
3.3 6.2.5 9.	2.Evapor 5. 8.	2.Heavy 5. 8.
Exterior Walls 1 Clapboard	3.H Pump 6. 9.None	3.Capped 6. 9.None
1.Clapboar 5.Stucco 9.B & B	Kitchen Style 2 Typical	Unfinished % 0%
2.Vin/Al 6.Brick 10.Cemplan	1.Modern 4.Obsolete	Grade & Factor 3 Average 100%
3.Compos./ 7.Stone 11.Concret	2.Typical 5. 8.	1.E Grade 4.B Grade 7.SC Grade
4.Asbestos 8.Wood Shi 12.Wood Bo	3.Old Type 6. 9.None	2.O Grade 5.A Grade 8.
Roof Surface 1 Asphalt Shingles	Bath(s) Style 2 Typical Bath(s)	3.O Grade 6.AA Grade 9.Same
1.Asphalt 4.Composit 7.Other	1.Modern 4.Obsolete 7.	SQFT (Footprint) 528
2.Slate 5.Wood 8.	2.Typical 5. 8.	Foundation 4 Average
3.Metal 6.Roll Roo 9.	3.Old Type 6. 9.None	1.Poor 2.Avg 7.V G
SF Masonry Trim 0	# Rooms 6	2.Fair 3.Avg 8.Exc
SOLAR VOLTAIC 0	# Bedrooms 3	3.Avg- 4.Good 9.Same
OPEN-4- 0	# Full Baths 1	Phys. % Good 0%
Year Built 1970	# Half Baths 1	Funct. % Good 100%
Year Remodeled 0	# Addn Fixtures 0	Functional Code 9 None
Foundation 1 Concrete	# Fireplaces 0	1.Incomp 4.Delap 5.Playo
1.Concrete 4.Wood 7.		2.O-Built 5.Bsmt 6.Long term
2.C Block 5.Slab 8.		3.Damage 6.Style 7.None
3.Br/Stone 6.Piers 9.		Econ. % Good 100%
Basement 4 Full Basement		Economic Code None
1.1/4 Bmt 4.Full Bmt 7.		0.None 3.No Power 6.Obsolete
2.1/2 Bmt 5.Crwl 8.		1.Location 4.Generate 9.None
3.3/4 Bmt 6. 9.None		2.Encroach 5.Flood Pl 9.
Bsmt Gar # Cars 0		Entrance Code 5 Estimated
Wet Basement 1 Dry Basement		1.Interior 4.Vacant 7.
1.Dry 4. 7.		2.Refusal 5.Estimate 8.
2.Damp 5. 8.	3.Informed 6. 9.	
3.Wet 6. 9.	Information Code 5 Estimate	
	1.Owner 4.Agent 7.	
	2.Relative 5.Estimate 8.	
	3.Tenant 6.Other 9.	

Date Inspected 5/28/2024

Additions, Outbuildings & Improvements

Type	Year	Units	Grade	Cond	Phys.	Funct.	Sound Value
12 2 Story/Basement	0	512	3 110	6	0	% 100 %	
1 One Story Frame	0	52	3 100	6	0	% 100 %	1.One Story Fram
1 One Story Frame	0	64	3 100	6	0	% 100 %	2.Two Story Fram
68 Wood Deck	0	56	2 100	4	0	% 100 %	3.Three Story Fr
68 Wood Deck	0	648	3 100	6	0	% 100 %	4.1 & 1/2 Story
23 Frame Garage	0	286	2 100	4	0	% 100 %	5.1 & 3/4 Story
						% %	6.2 & 1/2 Story
						% %	21.Open Frame Por
						% %	22.Encl Frame Por
						% %	23.Frame Garage
						% %	24.Frame Shed
						% %	25.Frame Bay Wind
						% %	26.1SFr Overhang
						% %	27.Unfin Basement
						% %	28.Unfinished Att
						% %	29.Finished Attic

