

LAMONTAGNE, CAROLYN J  
106 CENTER RD  
GRAY ME 04039

B6406P14

Property Data			Assessment Record					
Neighborhood	82 Average Location		Year	Land	Buildings	Exempt	Total	
Tree Growth Year	0		2011	42,000	18,137	8,500	51,637	
REVIEW	0		2012	42,000	18,137	8,500	51,637	
Building Permit	0		2013	42,000	18,137	8,500	51,637	
Zone/Land Use	11 Rural Residential & Agri		2014	42,000	18,137	8,500	51,637	
Secondary Zone			2015	42,000	18,100	9,000	51,100	
Topography	1 Level		2016	42,000	18,100	9,000	51,100	
1. Hill	4. Below St	7.	2017	42,000	18,100	13,500	46,600	
2. Rolling	5. Low	8.	2018	42,000	18,100	18,000	42,100	
3. Above St	6. Swampy	9.	2019	60,100	20,500	20,000	60,600	
Utilities	4. Filled Well/Point 6 Septic System		2020	60,100	20,500	20,000	60,600	
1. Public	4. Dug Well/Po	7. Cesspool	2021	60,100	20,500	25,000	55,600	
2. Water	5. Dug Well	8. Lake	2022	60,100	20,500	25,000	55,600	
3. Holding Ta	6. Septic	9. None	2023	60,100	20,500	25,000	55,600	
Street	1 Paved		Calc.	117,600	22,600	25,000	115,200	
1. Paved	4. Proposed	8.	<b>Land Data</b>					
2. Semi Imp	5. R/O/W	9.	<b>Front Foot</b>	<b>Type</b>	<b>Effective</b>	<b>Influence</b>	<b>Influence Codes</b>	
3. Gravel	6.	9.	11. Water (0-200)		Frontage	Depth	Factor	Code
GIS Map	51		12. Water (201-400)				%	1. Unimproved
Field Review	1		13. Water (401-800)				%	2. Excess Frtg
<b>Sale Data</b>			14. Water (801-160)				%	3. Topography
Sale Date			15. Water (161-32)				%	4. Size/Shape
Price			16. Water (3201-)				%	5. Access
Sale Type			17. Water SF Amen				%	6. Restriction
1. Land	4. Mobile	7.COM	18. Water View				%	7. Open Space
2. L & B	5. Other	8.	19. Water Influen				%	8. Environmental
3. Building	6. Condo	9.	20. ShoreFront A				%	9. Condo
Financing			<b>Square Foot</b>		<b>Square Feet</b>			<b>Acres</b>
1. Convent	4. Seller	7.	16. Water (3201-)				%	30. Blueberry(1-20
2. FHA/VA	5. Private	8.	17. Water SF Amen				%	31. Blueberry(21 -
3. Assumed	6. Cash	9.Unknown	18. Water View				%	32. Crop Land
Validity			19. Water Influen				%	33. Pasture
1. Valid	4. Split	7. Multiple	20. ShoreFront A				%	34. Shorefront B
2. Related	5. Partial	8. Other	<b>Fract. Acre</b>		<b>Acres/Sites</b>			35. Shorefront C
3. Distress	6. Exempt	9. Estate	21. Base Lot	21	1.00	100	%	36. ANTENNA SITE
Verified			22. Base Lot Vacan				%	37. Softwood TG
1. Buyer	4. Agent	7. Family	23. Base Lot Unpav				%	38. Mixed Wood TG
2. Seller	5. Pub Rec	8. Other	<b>Acres</b>				%	39. Hardwood TG
3. Lender	6. MLS	9.	24. Acres to 10				%	40. Wasteland
			25. Acres 11-30				%	41. Woodland
			26. Acres 31-50				%	42. Mobile Home Si
			27. Acres 51& over				%	43. Camp Site
			28. Acres 71 & Ove				%	44. Lot Improvemen
			29. Woods (41+)				%	45. BA SF - Oce
			<b>Total Acreage</b>	<b>1.00</b>				46. SP Meadow Cond

Inspection Witnessed By:

No./Date	Description	Date Insp.
X		

Notes:  
5/24 DR FIELD REVIEW

Gray

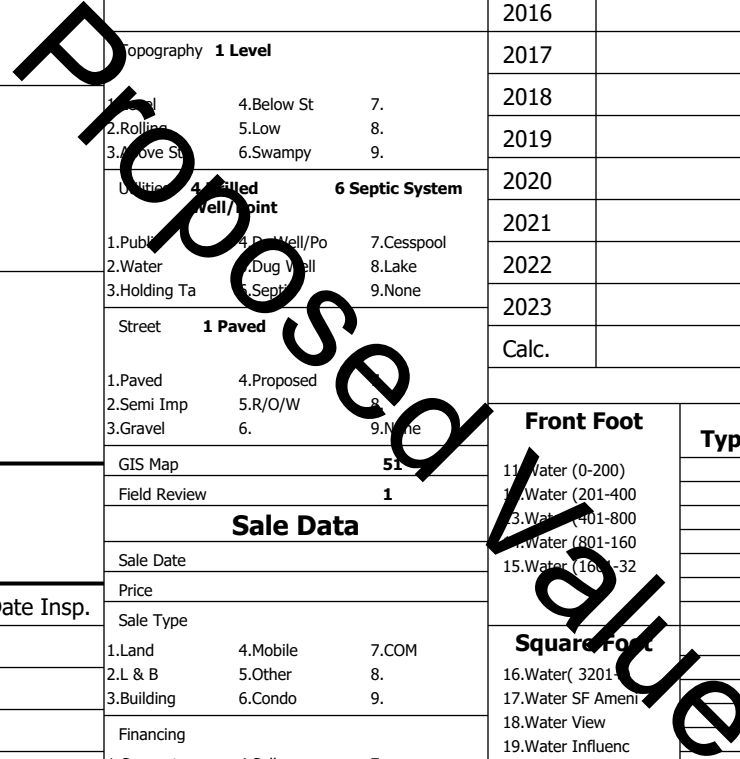

**Gray**

Map Lot 051-028-001-000

Account 1661

Location 106 CENTER RD

Card 1

Of 1

8/05/2024

Building Style <b>0</b>	SF Bsmt Living <b>0</b>	Layout <b>0</b>
1.Conv. 5.Garrison 9.NE farm	Fin Bsmt Grade <b>0 0</b>	1.Typical 4. 7.
2.Ranch 6.Split 10.Colonia	Secondary Heat <b>0</b>	2.Inadeq 5. 8.
3.R Ranch/ 7.Contemp 11.Cottage	Heat Type <b>100% 0</b>	3. 6. 9.
4.Cape 8.Log 12.Gambrel	1.HWBB 5.FWA 9.None	Attic <b>0</b>
Dwelling Units <b>0</b>	2.HWCI 6.Monitor 10.UNH2F	1.1/4 Fin 4.Full Fin 7.
Other Units <b>0</b>	3.HWRF 7.Electric 11.Geother	2.1/2 Fin 5.FI/Stair 8.
Stories <b>0</b>	4.Steam 8.FI/Wall 12.Heat/Co	3.3/4 Fin 6. 9.None
1.1 4.1.5 7.	Cool Type <b>0% 9 None</b>	Insulation <b>0</b>
2.2 5.1.75 8.	1.Central 4.W&C Air 7.	1.Full 4.Minimal 7.
3.3 6.2.5 9.	2.Evapor 5. 8.	2.Heavy 5. 8.
Exterior Walls <b>0</b>	3.H Pump 6. 9.None	3.Capped 6. 9.None
1.Clapboar 5.Stucco 9.B & B	Kitchen Style <b>0</b>	Unfinished % <b>0%</b>
2.Vin/Al 6.Brick 10.Cemplan	1.Modern 4.Obsolete	Grade & Factor <b>0 0%</b>
3.Compos./ 7.Stone 11.Concret	2.Typical 5. 8.	1.E Grade 4.B Grade 7.SC Grade
4.Asbestos 8.Wood Shi 12.Wood Bo	3.Old Type 6. 9.None	2.C Grade 5.A Grade 8.
Roof Surface <b>0</b>	Bath(s) Style <b>0</b>	3.E Grade 6.AA Grade 9.Same
1.Asphalt 4.Composit 7.Other	1.Modern 4.Obsolete 7.	SQFT (Footprint) <b>0</b>
2.Slate 5.Wood 8.	2.Typical 5. 8.	1.Poor 2.Avg 7.V G
3.Metal 6.Roll Roo 9.	3.Old Type 6. 9.None	2.Fair 3.Good 8.Exc
SF Masonry Trim <b>0</b>	# Rooms <b>0</b>	3.Avg- 4.Good 9.Same
SOLAR VOLTAIC <b>0</b>	# Bedrooms <b>0</b>	Phys. % Good <b>0%</b>
OPEN-4- <b>0</b>	# Full Baths <b>0</b>	Funct. % Good <b>100%</b>
Year Built <b>0</b>	# Half Baths <b>0</b>	Functional Code <b>9 None</b>
Year Remodeled <b>0</b>	# Addn Fixtures <b>0</b>	1.Incomp 4.Delap 5.Delay
Foundation <b>0</b>	# Fireplaces <b>0</b>	2.O-Built 5.Bsmt 6.Long term
1.Concrete 4.Wood 7.		3.Damage 6.Style
2.C Block 5.Slab 8.		Econ. % Good <b>100%</b>
3.Br/Stone 6.Piers 9.		Economic Code <b>None</b>
Basement <b>0</b>		0.None 3.No Power 6.Obsolete
1.1/4 Bmt 4.Full Bmt 7.		1.Location 4.Generate 9.None
2.1/2 Bmt 5.Crwl 8.		2.Encroach 5.Flood Pl 9.
3.3/4 Bmt 6. 9.None		Entrance Code <b>5 Estimated</b>
Bsmt Gar # Cars <b>0</b>		1.Interior 4.Vacant 7.
Wet Basement <b>0</b>		2.Refusal 5.Estimate 8.
1.Dry 4. 7.		3.Informed 6. 9.
2.Damp 5. 8.		Information Code <b>5 Estimate</b>
3.Wet 6. 9.		1.Owner 4.Agent 7.
		2.Relative 5.Estimate 8.
		3.Tenant 6.Other 9.

Date Inspected 5/28/2024

**Additions, Outbuildings & Improvements**

Type	Year	Units	Grade	Cond	Phys.	Funct.	Sound Value
998 14Mobile Home	1974	14x66	2 100	4	0 %	100 %	1.One Story Fram 2.Two Story Fram 3.Three Story Fr
68 Wood Deck	0	192	2 100	0	0 %	100 %	4.1 & 1/2 Story 5.1 & 3/4 Story 6.2 & 1/2 Story
68 Wood Deck	0	32	2 100	0	0 %	100 %	21.Open Frame Por 22.Encl Frame Por 23.Frame Garage
24 Frame Shed	0	144	2 100	4	0 %	100 %	24.Frame Shed 25.Frame Bay Wind 26.1SFr Overhang
					%	%	27.Unfin Basement 28.Unfinished Att 29.Finished Attic

