

STROUT - DEVISEES, LUCILLE T
C/O MATTHEW JOHN TANGUAY
PERSONAL REPRESENTATIVE 218 WEST GRAY RD
GRAY ME 04039

B8838P325

Previous Owner
STROUT, LUCILLE T
217 W GRAY RD

GRAY ME 04039
Sale Date: 11/17/2023

Property Data			Assessment Record				
Neighborhood	81 Fair-Traffic		Year	Land	Buildings	Exempt	Total
Tree Growth Year	0		2011	46,450	185,317	8,500	223,267
REVIEW	0		2012	46,450	185,317	8,500	223,267
Building Permit	0		2013	46,450	185,317	8,500	223,267
Zone/Land Use	11 Rural Residential & Agri		2014	46,450	189,755	8,500	227,705
Secondary Zone			2015	46,500	189,800	9,000	227,300
Topography	2 Rolling	4 Below Street	2016	46,500	189,800	9,000	227,300
			2017	46,500	194,200	13,500	227,200
			2018	46,500	194,200	18,000	222,700
			2019	59,600	230,100	20,000	269,700
			2020	59,600	230,100	20,000	269,700
			2021	59,600	230,100	25,000	264,700
			2022	59,600	230,100	25,000	264,700
			2023	59,600	260,300	25,000	294,900
			Calc.	119,000	409,000	0	528,000

Land Data		Front Foot		Effective		Influence		Influence Codes	
Type		Frontage	Depth	Factor	Code				
1. Water (0-200)				%				1. Unimproved	
2. Water (201-400)				%				2. Excess Frtg	
3. Water (401-800)				%				3. Topography	
4. Water (801-1600)				%				4. Size/Shape	
5. Water (1601-3200)				%				5. Access	
				%				6. Restriction	
				%				7. Open Space	
				%				8. Environmental	
				%				9. Condo	
				%				30. Blueberry(1-20	
				%				31. Blueberry(21 -	
				%				32. Crop Land	
				%				33. Pasture	
				%				34. Shorefront B	
				%				35. Shorefront C	
				%				36. ANTENNA SITE	
				%				37. Softwood TG	
				%				38. Mixed Wood TG	
				%				39. Hardwood TG	
				%				40. Wasteland	
				%				41. Woodland	
				%				42. Mobile Home Si	
				%				43. Camp Site	
				%				44. Lot Improvemen	
				%				45. BA SF - Oce	
				%				46. SP Meadow Cond	
		Total Acreage		1.89					

Inspection Witnessed By:

X	Date	Date Insp.
No./Date	Description	Date Insp.

Notes:
5/24- DR FIELD REVIEW

Gray

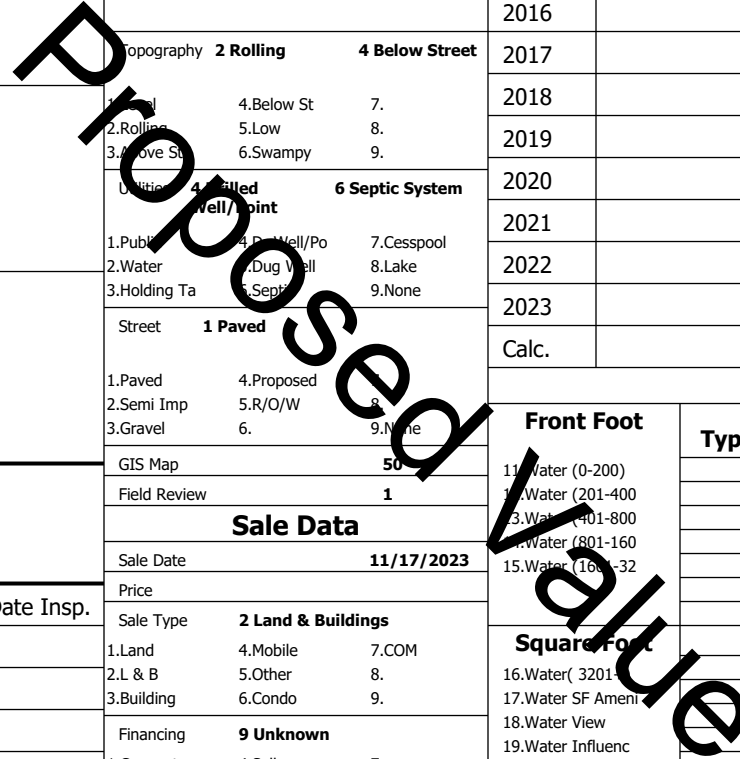

Gray

Map Lot 050-023-012-003

Account 1259

Location 217 WEST GRAY RD

Card 1

Of 1

8/05/2024

Building Style 4 Cape Cod	SF Bsmt Living 0	Layout 1 Typical
1.Conv. 5.Garrison 9.NE farm	Fin Bsmt Grade 0 0	1.Typical 4. 7.
2.Ranch 6.Split 10.Colonia	Secondary Heat 0	2.Inadeq 5. 8.
3.R Ranch/ 7.Contemp 11.Cottage	Heat Type 100% 1 Hot Water BB	3. 6. 9.
4.Cape 8.Log 12.Gambrel	1.HWBB 5.FWA 9.None	Attic 9 None
Dwelling Units 1	2.HWCI 6.Monitor 10.UNH2F	1.1/4 Fin 4.Full Fin 7.
Other Units 0	3.HWRF 7.Electric 11.Geother	2.1/2 Fin 5.FI/Stair 8.
Stories 5 One & 3/4 Story	4.Steam 8.FI/Wall 12.Heat/Co	3.3/4 Fin 6. 9.None
1.1 4.1.5 7.	Cool Type 0% 9 None	Insulation 1 Full
2.2 5.1.75 8.	1.Central 4.W&C Air 7.	1.Full 4.Minimal 7.
3.3 6.2.5 9.	2.Evapor 5. 8.	2.Heavy 5. 8.
Exterior Walls 8 Wood Shingle	3.H Pump 6. 9.None	3.Capped 6. 9.None
1.Clapboard 5.Stucco 9.B & B	Kitchen Style 2 Typical	Unfinished % 0%
2.Vin/Al 6.Brick 10.Cemplan	1.Modern 4.Obsolete	Grade & Factor 3 Average 110%
3.Compos./ 7.Stone 11.Concret	2.Typical 5. 8.	1.E Grade 4.B Grade 7.SC Grade
4.Asbestos 8.Wood Shi 12.Wood Bo	3.Old Type 6. 9.None	2.D Grade 5.A Grade 8.
Roof Surface 1 Asphalt Shingles	Bath(s) Style 2 Typical Bath(s)	3.Grade 6.AA Grade 9.Same
1.Asphalt 4.Composit 7.Other	1.Modern 4.Obsolete 7.	SQFT (Footprint) 768
2.Slate 5.Wood 8.	2.Typical 5. 8.	Foundation 4 Average
3.Metal 6.Roll Roo 9.	3.Old Type 6. 9.None	1.Poor 4.Avg 7.V G
SF Masonry Trim 0	# Rooms 6	2.Fair 5.Avg 8.Exc
SOLAR VOLTAIC 0	# Bedrooms 3	3.Avg- 6.Good 9.Same
OPEN-4- 0	# Full Baths 2	Phys. % Good 0%
Year Built 1997	# Half Baths 1	Funct. % Good 100%
Year Remodeled 0	# Addn Fixtures 0	Functional Code 9 None
Foundation 1 Concrete	# Fireplaces 0	1.Incomp 4.Delap 5.Playoff
1.Concrete 4.Wood 7.		2.O-Built 5.Bsmt 6.Long term
2.C Block 5.Slab 8.		3.Damage 6.Style 7.None
3.Br/Stone 6.Piers 9.		Econ. % Good 100%
Basement 4 Full Basement		Economic Code None
1.1/4 Bmt 4.Full Bmt 7.		0.None 3.No Power 6.Obsolete
2.1/2 Bmt 5.CrwI 8.		1.Location 4.Generate 9.None
3.3/4 Bmt 6. 9.None		2.Encroach 5.Flood Pl 9.
Bsmt Gar # Cars 0		Entrance Code 5 Estimated
Wet Basement 1 Dry Basement		1.Interior 4.Vacant 7.
1.Dry 4. 7.		2.Refusal 5.Estimate 8.
2.Damp 5. 8.		3.Informed 6. 9.
3.Wet 6. 9.		Information Code 5 Estimate
		1.Owner 4.Agent 7.
		2.Relative 5.Estimate 8.
		3.Tenant 6.Other 9.

Date Inspected 5/24/2024

Additions, Outbuildings & Improvements

Type	Year	Units	Grade	Cond	Phys.	Funct.	Sound Value
11 1 Story/Basement	0	171	0 0	0	0	% 100 %	1.One Story Fram
11 1 Story/Basement	0	240	0 0	0	0	% 100 %	2.Two Story Fram
11 1 Story/Basement	0	384	0 0	0	0	% 100 %	3.Three Story Fr
21 Open Frame	0	180	0 0	0	0	% 100 %	4.1 & 1/2 Story
68 Wood Deck	0	786	0 0	0	0	% 100 %	5.1 & 3/4 Story
61 Canopy	2005	323	3 100	4	0	% 100 %	6.2 & 1/2 Story
24 Frame Shed	2000	192	3 100	4	0	% 100 %	21.Open Frame Por
						% %	22.Encl Frame Por
						% %	23.Frame Garage
						% %	24.Frame Shed
						% %	25.Frame Bay Wind
						% %	26.1SFr Overhang
						% %	27.Unfin Basement
						% %	28.Unfinished Att
						% %	29.Finished Attic

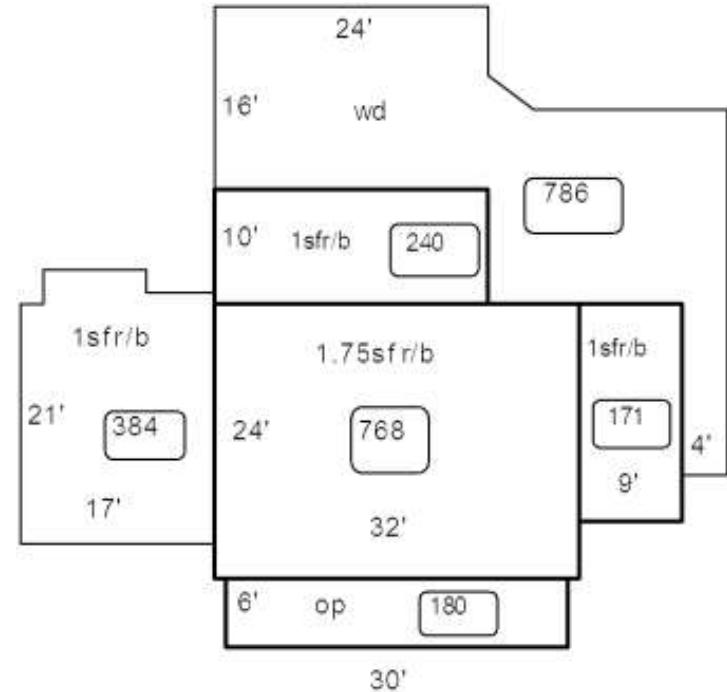

Proposed Value