

ST PETER, CARISSA
ST PETER, ANTHONY
3 MANNETT DRIVE
GRAY ME 04097

B33221P155

Previous Owner
BUTLER, BRYAN M
BUTLER, APRIL
3 MANNETT DR
GRAY ME 04039
Sale Date: 6/24/2016

Inspection Witnessed By:

X _____ Date _____

No./Date	Description	Date Insp.

Notes:
5/24-FR=DR

Gray

Property Data		
Neighborhood	82 Average Location	
Tree Growth Year	0	
REVIEW	0	
Building Permit	0	
Zone/Land Use	11 Rural Residential & Agri	
Secondary Zone		
Topography	2 Rolling	
1. Hill	4. Below St	7.
2. Rolling	5. Low	8.
3. Above St	6. Swampy	9.
Utilities	4. Filled Well/Point 6 Septic System	
1. Public	4. Driv Well/Po	7. Cesspool
2. Water	5. Dug Well	8. Lake
3. Holding Ta	6. Septic	9. None
Street	1 Paved	
1. Paved	4. Proposed	8.
2. Semi Imp	5. R/O/W	9.
3. Gravel	6.	9. None
GIS Map	50	
Field Review	1	
Sale Data		
Sale Date	6/24/2016	
Price	259,000	
Sale Type	2 Land & Buildings	
1. Land	4. Mobile	7. COM
2. L & B	5. Other	8.
3. Building	6. Condo	9.
Financing	9 Unknown	
1. Convent	4. Seller	7.
2. FHA/VA	5. Private	8.
3. Assumed	6. Cash	9. Unknown
Validity	1 Arms Length Sale	
1. Valid	4. Split	7. Multiple
2. Related	5. Partial	8. Other
3. Distress	6. Exempt	9. Estate
Verified	5 Public Record	
1. Buyer	4. Agent	7. Family
2. Seller	5. Pub Rec	8. Other
3. Lender	6. MLS	9.

Assessment Record				
Year	Land	Buildings	Exempt	Total
2011	46,200	149,454	0	195,654
2012	46,200	149,454	0	195,654
2013	46,200	149,454	0	195,654
2014	46,500	151,128	0	197,628
2015	46,500	151,100	0	197,600
2016	46,500	151,100	0	197,600
2017	46,500	151,100	0	197,600
2018	46,500	151,100	0	197,600
2019	58,800	210,500	0	269,300
2020	58,800	210,500	0	269,300
2021	58,800	210,500	0	269,300
2022	58,800	210,500	0	269,300
2023	58,800	241,200	25,000	275,000
Calc.	124,400	365,500	25,000	464,900

Land Data					
Type	Effective		Influence		Influence Codes
	Frontage	Depth	Factor	Code	
1. Water (0-200)			%		1. Unimproved
2. Water (201-400)			%		2. Excess Frtg
3. Water (401-800)			%		3. Topography
4. Water (801-1600)			%		4. Size/Shape
5. Water (1601-3200)			%		5. Access
6. Water (3201-6400)			%		6. Restriction
7. Water (6401-12800)			%		7. Open Space
8. Water (12801-25600)			%		8. Environmental
9. Water (25601-51200)			%		9. Condo
10. Water (51201-102400)			%		30. Blueberry(1-20
11. Water (102401-204800)			%		31. Blueberry(21 -
12. Water (204801-409600)			%		32. Crop Land
13. Water (409601-819200)			%		33. Pasture
14. Water (819201-1638400)			%		34. Shorefront B
15. Water (1638401-3276800)			%		35. Shorefront C
16. Water (3276801-6553600)			%		36. ANTENNA SITE
17. Water SF Amenities			%		37. Softwood TG
18. Water View			%		38. Mixed Wood TG
19. Water Influen			%		39. Hardwood TG
20. ShoreFront A			%		40. Wasteland
21. Base Lot			%		41. Woodland
22. Base Lot Vacan			%		42. Mobile Home Si
23. Base Lot Unpav			%		43. Camp Site
24. Acres to 10			%		44. Lot Improvemen
25. Acres 11-30			%		45. BA SF - Oce
26. Acres 31-50			%		46. SP Meadow Cond
27. Acres 51& over			%		
28. Acres 71 & Ove			%		
29. Woods (41+)			%		
Total Acreage			1.76		

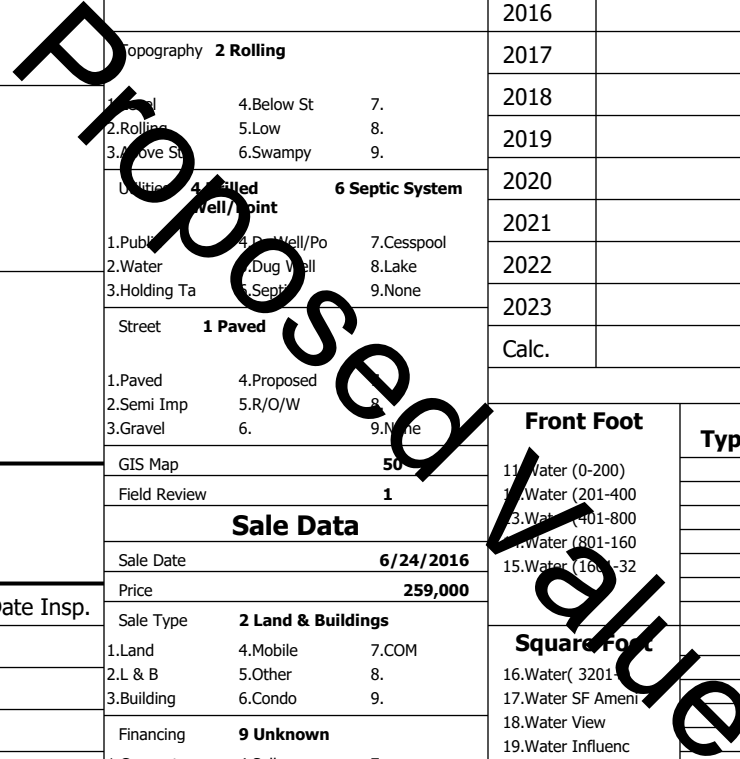

Gray

Map Lot 050-023-005-003

Account 1265

Location 3 MANNETT DR

Card 1

Of 1

8/05/2024

Building Style 10 Colonial	SF Bsmt Living 0	Layout 1 Typical
1.Conv. 5.Garrison 9.NE farm	Fin Bsmt Grade 0 0	1.Typical 4. 7.
2.Ranch 6.Split 10.Colonia	Secondary Heat 0	2.Inadeq 5. 8.
3.R Ranch/ 7.Contemp 11.Cottage	Heat Type 100% 1 Hot Water BB	3. 6. 9.
4.Cape 8.Log 12.Gambrel	1.HWBB 5.FWA 9.None	Attic 9 None
Dwelling Units 1	2.HWCI 6.Monitor 10.UNH2F	1.1/4 Fin 4.Full Fin 7.
Other Units 0	3.HWRF 7.Electric 11.Geother	2.1/2 Fin 5.FI/Stair 8.
Stories 2 Two Story	4.Steam 8.FI/Wall 12.Heat/Co	3.3/4 Fin 6. 9.None
1.1 4.1.5 7.	Cool Type 0% 9 None	Insulation 1 Full
2.2 5.1.75 8.	1.Central 4.W&C Air 7.	1.Full 4.Minimal 7.
3.3 6.2.5 9.	2.Evapor 5. 8.	2.Heavy 5. 8.
Exterior Walls 2 Vinyl/Aluminum	3.H Pump 6. 9.None	3.Capped 6. 9.None
1.Clapboar 5.Stucco 9.B & B	Kitchen Style 2 Typical	Unfinished % 0%
2.Vin/Al 6.Brick 10.Cemplan	1.Modern 4.Obsolete	Grade & Factor 3 Average 110%
3.Compos./ 7.Stone 11.Concret	2.Typical 5. 8.	1.E Grade 4.B Grade 7.SC Grade
4.Asbestos 8.Wood Shi 12.Wood Bo	3.Old Type 6. 9.None	2.C Grade 5.A Grade 8.
Roof Surface 1 Asphalt Shingles	Bath(s) Style 2 Typical Bath(s)	3.O Grade 6.AA Grade 9.Same
1.Asphalt 4.Composit 7.Other	1.Modern 4.Obsolete 7.	SQFT (Footprint) 952
2.Slate 5.Wood 8.	2.Typical 5. 8.	Condition 4 Average
3.Metal 6.Roll Roo 9.	3.Old Type 6. 9.None	1.Poor 2.Avg 7.V G
SF Masonry Trim 0	# Rooms 6	2.Fair 3.Avg 8.
SOLAR VOLTAIC 0	# Bedrooms 3	3.Avg- 4.Good 9.Same
OPEN-4- 0	# Full Baths 2	Phys. % Good 0%
Year Built 2007	# Half Baths 1	Funct. % Good 100%
Year Remodeled 0	# Addn Fixtures 0	Functional Code 9 None
Foundation 1 Concrete	# Fireplaces 0	1.Incomp 4.Delap 5.Delay
1.Concrete 4.Wood 7.		2.O-Built 5.Bsmt 6.Long term
2.C Block 5.Slab 8.		3.Damage 6.Style
3.Br/Stone 6.Piers 9.		Econ. % Good 100%
Basement 4 Full Basement		Economic Code None
1.1/4 Bmt 4.Full Bmt 7.		0.None 3.No Power 6.Obsolete
2.1/2 Bmt 5.Crwl 8.		1.Location 4.Generate 9.None
3.3/4 Bmt 6. 9.None		2.Encroach 5.Flood Pl 9.
Bsmt Gar # Cars 0		Entrance Code 5 Estimated
Wet Basement 1 Dry Basement		1.Interior 4.Vacant 7.
1.Dry 4. 7.		2.Refusal 5.Estimate 8.
2.Damp 5. 8.	3.Informed 6. 9.	
3.Wet 6. 9.	Information Code 5 Estimate	
	1.Owner 4.Agent 7.	
	2.Relative 5.Estimate 8.	
	3.Tenant 6.Other 9.	

Date Inspected 5/23/2024

Additions, Outbuildings & Improvements

Type	Year	Units	Grade	Cond	Phys.	Funct.	Sound Value
23 Frame Garage	0	676	0 0	0	0	100 %	
21 Open Frame	0	40	0 0	0	0	100 %	
68 Wood Deck	0	288	0 0	0	0	100 %	
						% %	
						% %	
						% %	
						% %	
						% %	
						% %	
						% %	
						% %	
						% %	
						% %	
						% %	
						% %	
						% %	
						% %	
						% %	
						% %	
						% %	
						% %	
						% %	

