

COBB, JOHN M
CHOI, YUN-SON
117 CABELL SHORE RD
GRAY ME 04039

B17231P15

Property Data			Assessment Record					
Neighborhood	82 Average Location		Year	Land	Buildings	Exempt	Total	
Tree Growth Year	0		2011	53,300	151,498	8,500	196,298	
REVIEW	0		2012	53,300	151,498	8,500	196,298	
Building Permit	0		2013	53,300	151,498	8,500	196,298	
Zone/Land Use	11 Rural Residential & Agri		2014	53,300	153,544	8,500	198,344	
Secondary Zone			2015	53,300	153,500	9,000	197,800	
Topography	2 Rolling		2016	53,300	153,500	9,000	197,800	
1. Hill	4. Below St	7.	2017	53,300	153,500	13,500	193,300	
2. Rolling	5. Low	8.	2018	53,300	153,500	18,000	188,800	
3. Above St	6. Swampy	9.	2019	89,400	279,900	20,000	349,300	
Utilities	4. Filled Well/Point		2020	89,400	279,900	20,000	349,300	
1. Public	4. Dug Well/Po	7. Cesspool	2021	89,400	279,900	25,000	344,300	
2. Water	8. Lake	8. Lake	2022	89,400	279,900	25,000	344,300	
3. Holding Ta	9. None	9. None	2023	89,400	306,500	25,000	370,900	
Street	1 Paved		Calc.	163,800	605,200	25,000	744,000	
1. Paved	4. Proposed	8.	Land Data					
2. Semi Imp	5. R/O/W	9.	Front Foot	Type	Effective	Influence	Influence Codes	
3. Gravel	6.	9. None	11. Water (0-200)		Frontage	Depth	Factor	Code
GIS Map	49		12. Water (201-400)				%	1. Unimproved
Field Review	1		13. Water (401-800)				%	2. Excess Frtg
Sale Data			14. Water (801-160)				%	3. Topography
Sale Date	1/22/2002		15. Water (161-32)				%	4. Size/Shape
Price			Square Foot				%	5. Access
Sale Type			16. Water (3201-				%	6. Restriction
1. Land	4. Mobile	7.COM	17. Water SF Amen				%	7. Open Space
2. L & B	5. Other	8.	18. Water View				%	8. Environmental
3. Building	6. Condo	9.	19. Water Influen				%	9. Condo
Financing			20. ShoreFront A				%	Acres
1. Convent	4. Seller	7.	Fract. Acre				%	30. Blueberry(1-20
2. FHA/VA	5. Private	8.	21. Base Lot	21	1.84	100	%	31. Blueberry(21 -
3. Assumed	6. Cash	9. Unknown	22. Base Lot Vacan	24	6.46	100	%	32. Crop Land
Validity			23. Base Lot Unpav				%	33. Pasture
1. Valid	4. Split	7. Multiple	Acres				%	34. Shorefront B
2. Related	5. Partial	8. Other	24. Acres to 10				%	35. Shorefront C
3. Distress	6. Exempt	9. Estate	25. Acres 11-30				%	36. ANTENNA SITE
Verified			26. Acres 31-50				%	37. Softwood TG
1. Buyer	4. Agent	7. Family	27. Acres 51& over				%	38. Mixed Wood TG
2. Seller	5. Pub Rec	8. Other	28. Acres 71 & Ove				%	39. Hardwood TG
3. Lender	6. MLS	9.	29. Woods (41+)				%	40. Wasteland
				Total Acreage 8.30				41. Woodland
								42. Mobile Home Si
								43. Camp Site
								44. Lot Improvemen
								45. BA SF - Oce
								46. SP Meadow Cond

Inspection Witnessed By:

No./Date	Description	Date Insp.
X		

Notes:

Gray

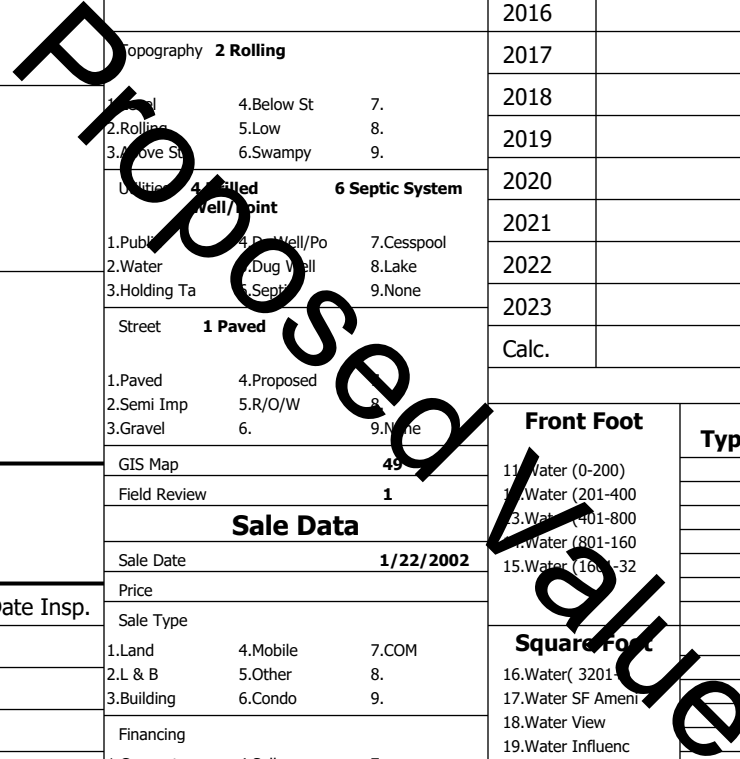

Gray

Map Lot 049-012-003-000

Account 469

Location 117 CABELL SHORE RD

Card 1

Of 1

8/05/2024

Building Style 9 NewEnglandFarm	SF Bsmt Living 0	Layout 1 Typical
1.Conv. 5.Garrison 9.NE farm	Fin Bsmt Grade 0 0	1.Typical 4. 7.
2.Ranch 6.Split 10.Colonia	Secondary Heat 0	2.Inadeq 5. 8.
3.R Ranch/ 7.Contemp 11.Cottage	Heat Type 100% 1 Hot Water BB	3. 6. 9.
4.Cape 8.Log 12.Gambrel	1.HWBB 5.FWA 9.None	Attic 9 None
Dwelling Units 1	2.HWCI 6.Monitor 10.UNH2F	1.1/4 Fin 4.Full Fin 7.
Other Units 0	3.HWRF 7.Electric 11.Geother	2.1/2 Fin 5.FI/Stair 8.
Stories 5 One & 3/4 Story	4.Steam 8.FI/Wall 12.Heat/Co	3.3/4 Fin 6. 9.None
1.1 4.1.5 7.	Cool Type 0% 9 None	Insulation 1 Full
2.2 5.1.75 8.	1.Central 4.W&C Air 7.	1.Full 4.Minimal 7.
3.3 6.2.5 9.	2.Evapor 5. 8.	2.Heavy 5. 8.
Exterior Walls 2 Vinyl/Aluminum	3.H Pump 6. 9.None	3.Capped 6. 9.None
1.Clapboar 5.Stucco 9.B & B	Kitchen Style 2 Typical	Unfinished % 0%
2.Vin/Al 6.Brick 10.Cemplan	1.Modern 4.Obsolete	Grade & Factor 3 Average 110%
3.Compos./ 7.Stone 11.Concret	2.Typical 5. 8.	1.E Grade 4.B Grade 7.SC Grade
4.Asbestos 8.Wood Shi 12.Wood Bo	3.Old Type 6. 9.None	2.D Grade 5.A Grade 8.
Roof Surface 1 Asphalt Shingles	Bath(s) Style 2 Typical Bath(s)	3.C Grade 6.AA Grade 9.Same
1.Asphalt 4.Composit 7.Other	1.Modern 4.Obsolete 7.	SQFT (Footprint) 1150
2.Slate 5.Wood 8.	2.Typical 5. 8.	Condition 7 Very Good
3.Metal 6.Roll Roo 9.	3.Old Type 6. 9.None	1.Poor 2.Avg 7.V G
SF Masonry Trim 0	# Rooms 6	2.Fair 3.Avg 8.Exc
SOLAR VOLTAIC 0	# Bedrooms 3	3.Avg- 4.Good 9.Same
OPEN-4- 0	# Full Baths 2	Phys. % Good 0%
Year Built 1850	# Half Baths 0	Funct. % Good 100%
Year Remodeled 2012	# Addn Fixtures 0	Functional Code 9 None
Foundation 3 Brick &/or Stone	# Fireplaces 0	1.Incomp 4.Delap 5.Playoff
1.Concrete 4.Wood 7.		2.O-Built 5.Bsmt 6.Long term
2.C Block 5.Slab 8.		3.Damage 6.Style 7.None
3.Br/Stone 6.Piers 9.		Econ. % Good 100%
Basement 3 3/4 Basement		Economic Code None
1.1/4 Bmt 4.Full Bmt 7.		0.None 3.No Power 6.Obsolete
2.1/2 Bmt 5.Crwl 8.		1.Location 4.Generate 9.None
3.3/4 Bmt 6. 9.None		2.Encroach 5.Flood Pl 9.
Bsmt Gar # Cars 0		Entrance Code 5 Estimated
Wet Basement 1 Dry Basement		1.Interior 4.Vacant 7.
1.Dry 4. 7.		2.Refusal 5.Estimate 8.
2.Damp 5. 8.		3.Informed 6. 9.
3.Wet 6. 9.		Information Code 5 Estimate
		1.Owner 4.Agent 7.
		2.Relative 5.Estimate 8.
		3.Tenant 6.Other 9.

Date Inspected 8/31/2015

Additions, Outbuildings & Improvements

Type	Year	Units	Grade	Cond	Phys.	Funct.	Sound Value
23 Frame Garage	0	600	3 100	4	0 %	100 %	
57 1.5 St Barn	1854	2400	0 0	4	0 %	100 %	
4 1 & 1/2 Story Fr	2012	900	0 0	0	0 %	100 %	
27 Unfin Basement	1854	2400	0 0	4	75 %	100 %	
					%	%	1.One Story Fram
					%	%	2.Two Story Fram
					%	%	3.Three Story Fr
					%	%	4.1 & 1/2 Story
					%	%	5.1 & 3/4 Story
					%	%	6.2 & 1/2 Story
					%	%	21.Open Frame Por
					%	%	22.Encl Frame Por
					%	%	23.Frame Garage
					%	%	24.Frame Shed
					%	%	25.Frame Bay Wind
					%	%	26.1SFr Overhang
					%	%	27.Unfin Basement
					%	%	28.Unfinished Att
					%	%	29.Finished Attic

