

DUNNETT, NICHOLAS
30 YARMOUTH ROAD
GRAY ME 04039

B38324P225

Previous Owner
KEITES, MARC W
PO BOX 284

GRAY ME 04039
Sale Date: 6/17/2021

Property Data			Assessment Record						
Neighborhood 51 Gray Village			Year	Land	Buildings	Exempt	Total		
Tree Growth Year 0			2011	39,900	92,239	8,500	123,639		
REVIEW 0			2012	39,900	92,239	8,500	123,639		
Building Permit 0			2013	39,900	92,239	8,500	123,639		
Zone/Land Use 20 Village Center Proper			2014	39,900	92,239	8,500	123,639		
Secondary Zone			2015	39,900	92,200	9,000	123,100		
Topography 2 Rolling			2016	39,900	92,200	9,000	123,100		
1. Above St 2. Below St 3. Below St 4. Below St 5. Low 6. Swampy 7. 8. 9.			2017	39,900	91,900	13,500	118,300		
1. Public 2. Public Water 3. Public Water 4. Public Water 5. Public Water 6. Septic System 7. Septic System 8. Septic System 9. Septic System			2018	39,900	91,900	18,000	113,800		
1. Public 2. Water 3. Holding Ta 4. Dug Well/Po 5. Dug Well 6. Dug Well 7. Cesspool 8. Lake 9. None			2019	61,200	158,200	20,000	199,400		
Street 1 Paved			2020	61,200	158,200	20,000	199,400		
1. Paved 2. Semi Imp 3. Gravel 4. Proposed 5. R/O/W 6. 7. 8. 9. None			2021	61,200	158,200	25,000	194,400		
GIS Map 44			2022	61,200	158,200	25,000	194,400		
Field Review 1			2023	61,200	181,300	0	242,500		
Sale Date 6/17/2021			Calc.	130,400	294,400	25,000	399,800		
Price 314,900			Land Data						
Sale Type 2 Land & Buildings			Front Foot	Type	Effective		Influence		Influence Codes
1. Land 2. L & B 3. Building 4. Mobile 5. Other 6. Condo 7. COM 8. 9.					Frontage	Depth	Factor	Code	
Financing 1 Conventional			Square Foot						
1. Convent 2. FHA/VA 3. Assumed 4. Seller 5. Private 6. Cash 7. 8. 9. Unknown									
Validity 1 Arms Length Sale			Fract. Acre		Acres/Sites				
1. Valid 2. Related 3. Distress 4. Split 5. Partial 6. Exempt 7. Multiple 8. Other 9. Estate									
Verified 1 Buyer									
1. Buyer 2. Seller 3. Lender 4. Agent 5. Pub Rec 6. MLS 7. Family 8. Other 9.									

Inspection Witnessed By:

X	Date	Description	Date Insp.

Notes:
5/24 DR FIELD REVIEW

Gray

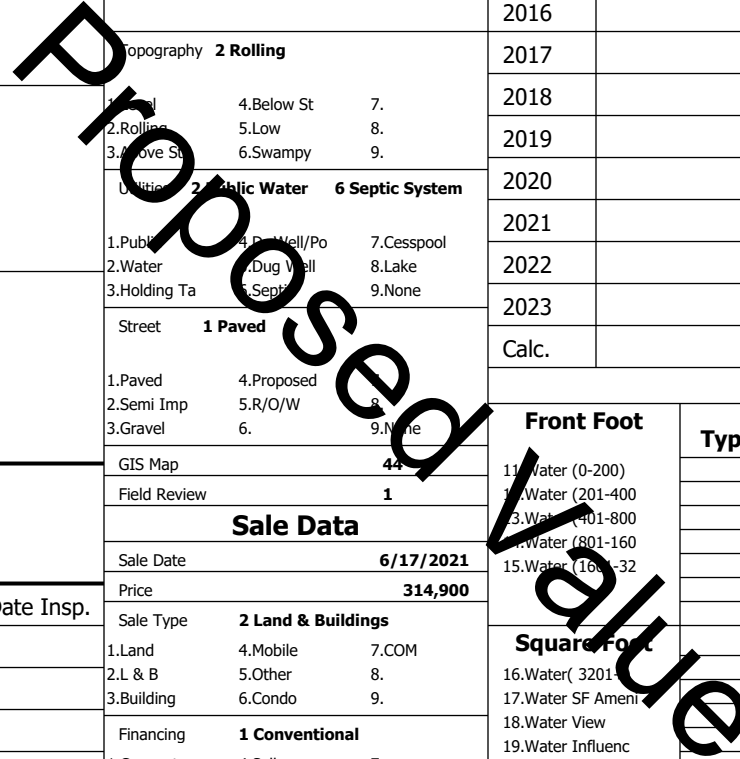

Type	Effective		Influence		Influence Codes
	Frontage	Depth	Factor	Code	
			%		1. Unimproved
			%		2. Excess Frtg
			%		3. Topography
			%		4. Size/Shape
			%		5. Access
			%		6. Restriction
			%		7. Open Space
			%		8. Environmental
			%		9. Condo
			%		Acres
			%		30. Blueberry(1-20
			%		31. Blueberry(21 -
			%		32. Crop Land
			%		33. Pasture
			%		34. Shorefront B
			%		35. Shorefront C
			%		36. ANTENNA SITE
			%		37. Softwood TG
			%		38. Mixed Wood TG
			%		39. Hardwood TG
			%		40. Wasteland
			%		41. Woodland
			%		42. Mobile Home Si
			%		43. Camp Site
			%		44. Lot Improvemen
			%		45. BA SF - Oce
			%		46. SP Meadow Cond
Total Acreeage 0.85					

