

REID, RONALD ALEXANDER
198 PAYNE ROAD
SCARBOROUGH ME 04074

B40242P18

Previous Owner
MCSTOWE, JAYMZ L
THORNTON, JENNIFER R
14 PARTRIDGE LANE
GRAY ME 04039
Sale Date: 7/14/2023

Previous Owner
ELLIOTT, SHAWN
14 PARTRIDGE LANE
GRAY ME 04039
Sale Date: 3/12/2019

GRAY ME 04039
Sale Date: 3/12/2019

Inspection Witnessed By:

X Date

No./Date	Description	Date Insp.

Notes:
5/24 DR FIELD REVIEW

Gray

Property Data		
Neighborhood	83 Avg-Good Location	
Tree Growth Year	0	
REVIEW	0	
Building Permit	0	
Zone/Land Use	18 Medium Density	
Secondary Zone		
Topography	2 Rolling	
1. Well	4. Below St	7.
2. Rolling	5. Low	8.
3. Above St	6. Swampy	9.
Utilities	2 Public Water 6 Septic System	
1. Public	4. Dr. Well/Po	7. Cesspool
2. Water	5. Dug Well	8. Lake
3. Holding Ta	6. Septic	9. None
Street	1 Paved	
1. Paved	4. Proposed	8.
2. Semi Imp	5. R/O/W	9.
3. Gravel	6.	9. None
GIS Map	44	
Field Review	1	
Sale Data		
Sale Date	7/14/2023	
Price	440,000	
Sale Type	2 Land & Buildings	
1. Land	4. Mobile	7. COM
2. L & B	5. Other	8.
3. Building	6. Condo	9.
Financing	1 Conventional	
1. Convent	4. Seller	7.
2. FHA/VA	5. Private	8.
3. Assumed	6. Cash	9. Unknown
Validity	1 Arms Length Sale	
1. Valid	4. Split	7. Multiple
2. Related	5. Partial	8. Other
3. Distress	6. Exempt	9. Estate
Verified	5 Public Record	
1. Buyer	4. Agent	7. Family
2. Seller	5. Pub Rec	8. Other
3. Lender	6. MLS	9.

Assessment Record				
Year	Land	Buildings	Exempt	Total
2011	34,580	111,080	8,500	137,160
2012	34,580	111,080	8,500	137,160
2013	34,580	115,808	8,500	141,888
2014	34,580	116,037	8,500	142,117
2015	34,600	116,000	9,000	141,600
2016	34,600	116,000	9,000	141,600
2017	34,600	116,400	13,500	137,500
2018	34,600	116,400	18,000	133,000
2019	55,600	165,500	20,000	201,100
2020	55,600	165,500	0	221,100
2021	55,600	165,500	0	221,100
2022	55,600	165,500	25,000	196,100
2023	55,600	195,200	25,000	225,800
Calc.	120,000	256,500	0	376,500

Land Data					
Type	Effective		Influence		Influence Codes
	Frontage	Depth	Factor	Code	
11. Water (0-200)			%		1. Unimproved
12. Water (201-400)			%		2. Excess Frtg
13. Water (401-800)			%		3. Topography
14. Water (801-1600)			%		4. Size/Shape
15. Water (1601-3200)			%		5. Access
			%		6. Restriction
			%		7. Open Space
			%		8. Environmental
			%		9. Condo
			%		30. Blueberry(1-20
			%		31. Blueberry(21 -
			%		32. Crop Land
			%		33. Pasture
			%		34. Shorefront B
			%		35. Shorefront C
			%		36. ANTENNA SITE
			%		37. Softwood TG
			%		38. Mixed Wood TG
			%		39. Hardwood TG
			%		40. Wasteland
			%		41. Woodland
			%		42. Mobile Home Si
			%		43. Camp Site
			%		44. Lot Improvemen
			%		45. BA SF - Oce
			%		46. SP Meadow Cond
Total Acreage			0.47		

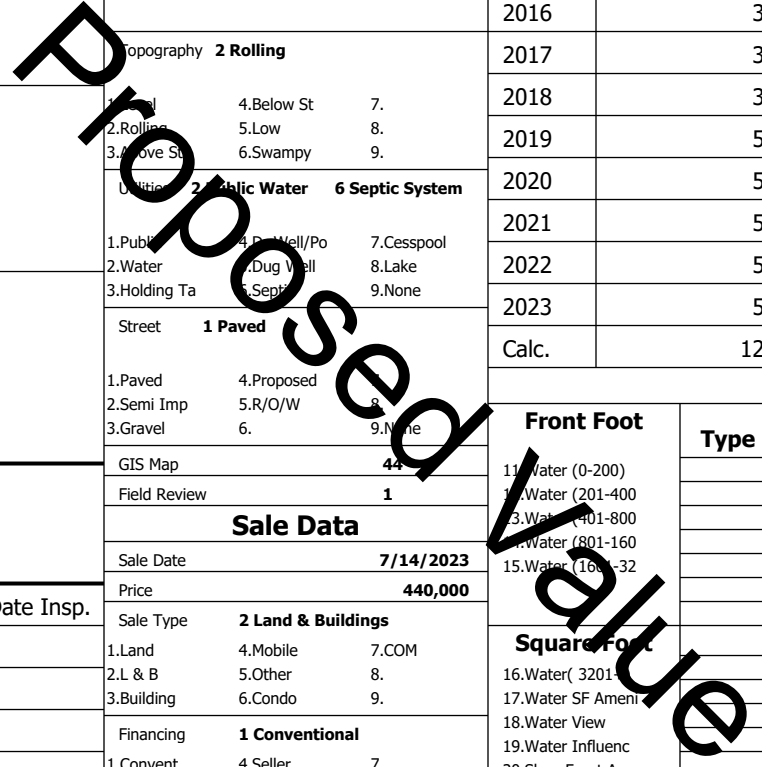

Gray

Map Lot 044-032-074-011

Account 1909

Location 14 PARTRIDGE LN

Card 1

Of 1

8/05/2024

Building Style 10 Colonial	SF Bsmt Living 480	Layout 1 Typical
1.Conv. 5.Garrison 9.NE farm	Fin Bsmt Grade 3 100	1.Typical 4. 7.
2.Ranch 6.Split 10.Colonia	Secondary Heat 0	2.Inadeq 5. 8.
3.R Ranch/ 7.Contemp 11.Cottage	Heat Type 100% 1 Hot Water BB	3. 6. 9.
4.Cape 8.Log 12.Gambrel	1.HWBB 5.FWA 9.None	Attic 9 None
Dwelling Units 1	2.HWCI 6.Monitor 10.UNH2F	1.1/4 Fin 4.Full Fin 7.
Other Units 0	3.HWRF 7.Electric 11.Geother	2.1/2 Fin 5.F/Stair 8.
Stories 2 Two Story	4.Steam 8.F/Wall 12.Heat/Co	3.3/4 Fin 6. 9.None
1.1 4.1.5 7.	Cool Type 0% 9 None	Insulation 1 Full
2.2 5.1.75 8.	1.Central 4.W&C Air 7.	1.Full 4.Minimal 7.
3.3 6.2.5 9.	2.Evapor 5. 8.	2.Heavy 5. 8.
Exterior Walls 2 Vinyl/Aluminum	3.H Pump 6. 9.None	3.Capped 6. 9.None
1.Clapboar 5.Stucco 9.B & B	Kitchen Style 2 Typical	Unfinished % 0%
2.Vin/Al 6.Brick 10.Cemplan	1.Modern 4.Obsolete	Grade & Factor 3 Average 100%
3.Compos./ 7.Stone 11.Concret	2.Typical 5. 8.	1.E Grade 4.B Grade 7.SC Grade
4.Asbestos 8.Wood Shi 12.Wood Bo	3.Old Type 6. 9.None	2.O Grade 5.A Grade 8.
Roof Surface 3 Metal	Bath(s) Style 2 Typical Bath(s)	3.O Grade 6.AA Grade 9.Same
1.Asphalt 4.Composit 7.Other	1.Modern 4.Obsolete 7.	SQFT (Footprint) 768
2.Slate 5.Wood 8.	2.Typical 5. 8.	Condition 4 Average
3.Metal 6.Roll Roo 9.	3.Old Type 6. 9.None	1.Poor 4.Avg 7.V G
SF Masonry Trim 0	# Rooms 6	2.Fair 5.Avg 8.Exc
SOLAR VOLTAIC 0	# Bedrooms 3	3.Avg- 6.Good 9.Same
OPEN-4- 0	# Full Baths 1	Phys. % Good 0%
Year Built 1992	# Half Baths 1	Funct. % Good 100%
Year Remodeled 0	# Addn Fixtures 0	Functional Code 9 None
Foundation 1 Concrete	# Fireplaces 0	1.Incomp 4.Delap 5.Delay
1.Concrete 4.Wood 7.		2.O-Built 5.Bsmt 6.Long term
2.C Block 5.Slab 8.		3.Damage 6.Style 7.None
3.Br/Stone 6.Piers 9.		Econ. % Good 100%
Basement 4 Full Basement		Economic Code None
1.1/4 Bmt 4.Full Bmt 7.		0.None 3.No Power 6.Obsolete
2.1/2 Bmt 5.Crw1 8.		1.Location 4.Generate 9.None
3.3/4 Bmt 6. 9.None		2.Encroach 5.Flood Pl 9.
Bsmt Gar # Cars 0		Entrance Code 5 Estimated
Wet Basement 1 Dry Basement		1.Interior 4.Vacant 7.
1.Dry 4. 7.		2.Refusal 5.Estimate 8.
2.Damp 5. 8.		3.Informed 6. 9.
3.Wet 6. 9.		Information Code 5 Estimate
		1.Owner 4.Agent 7.
		2.Relative 5.Estimate 8.
		3.Tenant 6.Other 9.

Date Inspected 5/24/2024

Additions, Outbuildings & Improvements

Type	Year	Units	Grade	Cond	Phys.	Funct.	Sound Value
21 Open Frame	0	156	0 0	0	0	% 100 %	1.One Story Fram
68 Wood Deck	0	216	0 0	0	0	% 100 %	2.Two Story Fram
24 Frame Shed	0	96	2 100	4	0	% 100 %	3.Three Story Fr
89 DH Bsmt Entry	0	1	0 0	0	0	% 100 %	4.1 & 1/2 Story
68 Wood Deck	0	36	0 0	0	0	% 100 %	5.1 & 3/4 Story
						% %	6.2 & 1/2 Story
						% %	21.Open Frame Por
						% %	22.Encl Frame Por
						% %	23.Frame Garage
						% %	24.Frame Shed
						% %	25.Frame Bay Wind
						% %	26.1SFr Overhang
						% %	27.Unfin Basement
						% %	28.Unfinished Att
						% %	29.Finished Attic

