

TOMBARELLI, KEVIN M  
TOMBARELLI, KATHY L  
7 GRAY PARK  
GRAY ME 04039

B12137P115

Inspection Witnessed By:

No./Date	Description	Date Insp.
X		

Notes:  
5/24 DR FIELD REVIEW

Gray

Property Data			Assessment Record						
Neighborhood <b>51 Gray Village</b>			Year	Land	Buildings	Exempt	Total		
Tree Growth Year <b>0</b>			2011	52,400	149,827	0	202,227		
REVIEW <b>0</b>			2012	52,400	149,827	0	202,227		
Building Permit <b>0</b>			2013	52,400	149,827	0	202,227		
Zone/Land Use <b>20 Village Center Proper</b>			2014	52,400	149,827	0	202,227		
Secondary Zone			2015	52,400	149,800	0	202,200		
Topography <b>1 Level</b>			2016	52,400	149,800	0	202,200		
1. Valid 4. Below St 7.			2017	52,400	149,800	0	202,200		
2. Rolling 5. Low 8.			2018	52,400	149,800	0	202,200		
3. Above St 6. Swampy 9.			2019	42,600	327,900	0	370,500		
Utilities <b>2 Public Water 6 Septic System</b>			2020	42,600	327,900	0	370,500		
1. Public 4. Dr. Well/Po 7. Cesspool			2021	42,600	327,900	0	370,500		
2. Water 8. Lake			2022	42,600	327,900	0	370,500		
3. Holding Ta 9. None			2023	42,600	357,300	0	399,900		
Street <b>1 Paved</b>			Calc.	95,000	604,300	0	699,300		
1. Paved 4. Proposed			<b>Land Data</b>						
2. Semi Imp 5. R/O/W			<b>Front Foot</b>	<b>Type</b>	<b>Effective</b>		<b>Influence</b>		<b>Influence Codes</b>
3. Gravel 6. None					<b>Frontage</b>	<b>Depth</b>	<b>Factor</b>	<b>Code</b>	
GIS Map <b>43</b>			11. Water (0-200)				%		1. Unimproved
Field Review <b>1</b>			12. Water (201-400)				%		2. Excess Frtg
<b>Sale Data</b>			13. Water (401-800)				%		3. Topography
Sale Date <b>9/28/1995</b>			14. Water (801-160)				%		4. Size/Shape
Price			15. Water (161-32)				%		5. Access
Sale Type							%		6. Restriction
1. Land 4. Mobile 7.COM			<b>Square Foot</b>	<b>Square Feet</b>					7. Open Space
2. L & B 5. Other 8.			16. Water ( 3201-				%		8. Environmental
3. Building 6. Condo 9.			17. Water SF Amen				%		9. Condo
Financing			18. Water View				%		<b>Acres</b>
1. Convent 4. Seller 7.			19. Water Influen				%		30. Blueberry(1-20
2. FHA/VA 5. Private 8.			20. ShoreFront A				%		31. Blueberry(21 -
3. Assumed 6. Cash 9.Unknown							%		32. Crop Land
Validity			<b>Fract. Acre</b>	<b>Acreege/Sites</b>					33. Pasture
1. Valid 4. Split 7. Multiple			21. Base Lot	21	0.30	100	%	0	34. Shorefront B
2. Related 5. Partial 8. Other			22. Base Lot Vacan				%		35. Shorefront C
3. Distress 6. Exempt 9. Estate			23. Base Lot Unpav				%		36. ANTENNA SITE
Verified			<b>Acres</b>				%		37. Softwood TG
1. Buyer 4. Agent 7. Family			24. Acres to 10				%		38. Mixed Wood TG
2. Seller 5. Pub Rec 8. Other			25. Acres 11-30				%		39. Hardwood TG
3. Lender 6. MLS 9.			26. Acres 31-50				%		40. Wasteland
			27. Acres 51& over				%		41. Woodland
			28. Acres 71 & Ove				%		42. Mobile Home Si
			29. Woods (41+)				%		43. Camp Site
			<b>Total Acreage</b>		<b>0.30</b>				44. Lot Improvemen
									45. BA SF - Oce
									46. SP Meadow Cond

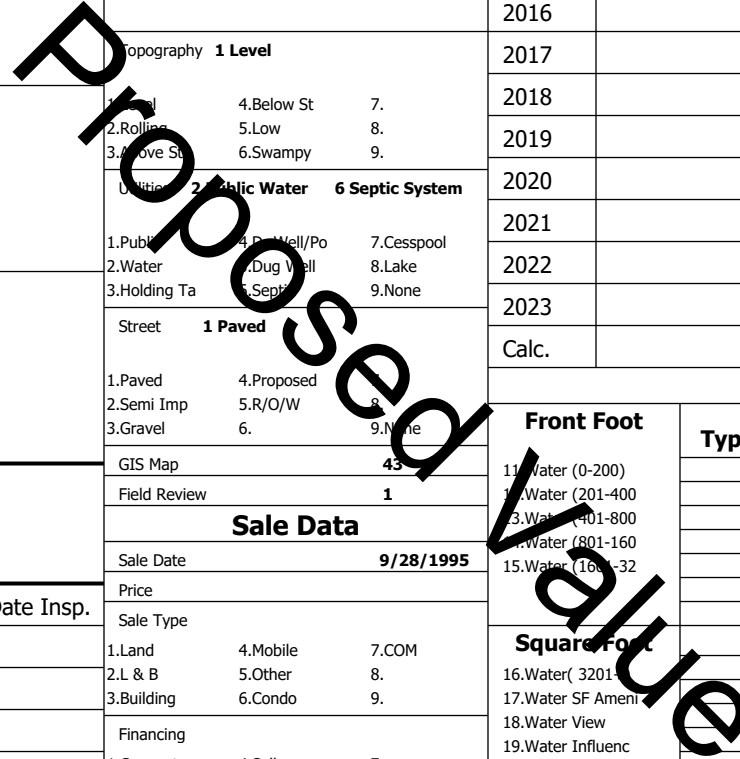

**Gray**

Map Lot 043-405-018-000

Account 4476

Location 9 YARMOUTH RD

Card 1 Of 1

8/05/2024

Building Style <b>31 Three Unit Apt</b>	SF Bsmt Living <b>0</b>	Layout <b>1 Typical</b>
1.Conv. 5.Garrison 9.NE farm	Fin Bsmt Grade <b>0 0</b>	1.Typical 4. 7.
2.Ranch 6.Split 10.Colonia	Secondary Heat <b>2</b>	2.Inadeq 5. 8.
3.R Ranch/ 7.Contemp 11.Cottage	Heat Type <b>100% 1 Hot Water BB</b>	3. 6. 9.
4.Cape 8.Log 12.Gambrel	1.HWBB 5.FWA 9.None	Attic <b>5 Floor &amp; Stairs</b>
Dwelling Units <b>3</b>	2.HWCI 6.Monitor 10.UNH2F	1.1/4 Fin 4.Full Fin 7.
Other Units <b>0</b>	3.HWRF 7.Electric 11.Geother	2.1/2 Fin 5.F/1Stair 8.
Stories <b>2 Two Story</b>	4.Steam 8.F/Wall 12.Heat/Co	3.3/4 Fin 6. 9.None
1.1 4.1.5 7.	Cool Type <b>0% 9 None</b>	Insulation <b>5</b>
2.2 5.1.75 8.	1.Central 4.W&C Air 7.	1.Full 4.Minimal 7.
3.3 6.2.5 9.	2.Evapor 5. 8.	2.Heavy 5. 8.
Exterior Walls <b>1 Clapboard</b>	3.H Pump 6. 9.None	3.Capped 6. 9.None
1.Clapboar 5.Stucco 9.B & B	Kitchen Style <b>2 Typical</b>	Unfinished % <b>0%</b>
2.Vin/Al 6.Brick 10.Cemplan	1.Modern 4.Obsolete	Grade & Factor <b>3 Average 110%</b>
3.Compos./ 7.Stone 11.Concret	2.Typical 5. 8.	1.E Grade 4.B Grade 7.SC Grade
4.Asbestos 8.Wood Shi 12.Wood Bo	3.Old Type 6. 9.None	2.D Grade 5.A Grade 8.
Roof Surface <b>1 Asphalt Shingles</b>	Bath(s) Style <b>2 Typical Bath(s)</b>	3.C Grade 6.AA Grade 9.Same
1.Asphalt 4.Composit 7.Other	1.Modern 4.Obsolete 7.	SQFT (Footprint) <b>1400</b>
2.Slate 5.Wood 8.	2.Typical 5. 8.	Condition <b>4 Average</b>
3.Metal 6.Roll Roo 9.	3.Old Type 6. 9.None	1.Poor 4.Avg 7.V G
SF Masonry Trim <b>0</b>	# Rooms <b>12</b>	2.Fair 5.Avg 8.Exc
SOLAR VOLTAIC <b>0</b>	# Bedrooms <b>5</b>	3.Avg- 6.Good 9.Same
OPEN-4- <b>0</b>	# Full Baths <b>3</b>	Phys. % Good <b>0%</b>
Year Built <b>1860</b>	# Half Baths <b>1</b>	Funct. % Good <b>100%</b>
Year Remodeled <b>1995</b>	# Addn Fixtures <b>2</b>	Functional Code <b>9 None</b>
Foundation <b>3 Brick &amp;/or Stone</b>	# Fireplaces <b>2</b>	1.Incomp 4.Delap 5.Delay
1.Concrete 4.Wood 7.		2.O-Built 5.Bsmt 6.Long term
2.C Block 5.Slab 8.		3.Damage 6.Style None
3.Br/Stone 6.Piers 9.		Econ. % Good <b>100%</b>
Basement <b>4 Full Basement</b>		Economic Code <b>None</b>
1.1/4 Bmt 4.Full Bmt 7.		0.None 3.No Power 6.Obsolete
2.1/2 Bmt 5.Crwl 8.		1.Location 4.Generate 9.None
3.3/4 Bmt 6. 9.None		2.Encroach 5.Flood Pl 9.
Bsmt Gar # Cars <b>0</b>		Entrance Code <b>5 Estimated</b>
Wet Basement <b>1 Dry Basement</b>		1.Interior 4.Vacant 7.
1.Dry 4. 7.		2.Refusal 5.Estimate 8.
2.Damp 5. 8.		3.Informed 6. 9.
3.Wet 6. 9.		Information Code <b>5 Estimate</b>
		1.Owner 4.Agent 7.
		2.Relative 5.Estimate 8.
		3.Tenant 6.Other 9.

Date Inspected 5/24/2024

**Additions, Outbuildings & Improvements**

Type	Year	Units	Grade	Cond	Phys.	Funct.	Sound Value
68 Wood Deck	1998	350	3 100	4	0 %	100 %	
21 Open Frame	0	264	0 0	0	0 %	100 %	
2 Two Story Frame	0	352	0 0	0	0 %	100 %	
2 Two Story Frame	0	27	0 0	0	0 %	100 %	
2 Two Story Frame	0	27	0 0	0	0 %	100 %	
1 One Story Frame	0	110	0 0	0	0 %	100 %	
5 1 & 3/4 Story Fr	0	1152	3 100	6	0 %	100 %	
24 Frame Shed	2017	160	3 100	4	0 %	100 %	
					%	%	
					%	%	

- 1.One Story Fram
- 2.Two Story Fram
- 3.Three Story Fr
- 4.1 & 1/2 Story
- 5.1 & 3/4 Story
- 6.2 & 1/2 Story
- 21.Open Frame Por
- 22.Encl Frame Por
- 23.Frame Garage
- 24.Frame Shed
- 25.Frame Bay Wind
- 26.1SFr Overhang
- 27.Unfin Basement
- 28.Unfinished Att
- 29.Finished Attic

