

NANNICELLI, ANGELEA
BOYLE, JONATHAN
11 FROST RD
GRAY ME 04039

B38582P176

Previous Owner
CHELLIS, CAITLIN T
CHELLIS, MATTHEW S
11 FROST ROAD
GRAY ME 04039
Sale Date: 8/24/2021

Previous Owner
HOWELL, STEVEN
11 FROST RD

GRAY ME 04039
Sale Date: 10/23/2017

Inspection Witnessed By:

X	Date	Date Insp.
No./Date	Description	Date Insp.

Notes:
5/24-FR=DR

Gray

Property Data		
Neighborhood	82 Average Location	
Tree Growth Year	0	
REVIEW	0	
Building Permit	0	
Zone/Land Use	15 Business Development	
Secondary Zone		
Topography	2 Rolling	
1.Well	4.Below St	7.
2.Rolling	5.Low	8.
3.Above St	6.Swampy	9.
Utilities	4. Filled Well/Point 6 Septic System	
1.Public	4.Drain Well/Po	7.Cesspool
2.Water	5.Dug Well	8.Lake
3.Holding Ta	6.Sepic	9.None
Street	1 Paved	
1.Paved	4.Proposed	8.
2.Semi Imp	5.R/O/W	9.
3.Gravel	6.	9.None
GIS Map	43	
Field Review	1	
Sale Data		
Sale Date	8/24/2021	
Price	315,000	
Sale Type	2 Land & Buildings	
1.Land	4.Mobile	7.COM
2.L & B	5.Other	8.
3.Building	6.Condo	9.
Financing	1 Conventional	
1.Convent	4.Seller	7.
2.FHA/VA	5.Private	8.
3.Assumed	6.Cash	9.Unknown
Validity	1 Arms Length Sale	
1.Valid	4.Split	7.Multiple
2.Related	5.Partial	8.Other
3.Distress	6.Exempt	9.Estate
Verified	1 Buyer	
1.Buyer	4.Agent	7.Family
2.Seller	5.Pub Rec	8.Other
3.Lender	6.MLS	9.

Assessment Record				
Year	Land	Buildings	Exempt	Total
2011	44,500	90,263	0	134,763
2012	44,500	90,263	0	134,763
2013	44,500	90,263	0	134,763
2014	44,500	91,938	8,500	127,938
2015	44,500	91,900	9,000	127,400
2016	44,500	91,900	9,000	127,400
2017	44,500	91,900	13,500	122,900
2018	44,500	91,900	18,000	118,400
2019	59,600	159,600	0	219,200
2020	59,600	159,600	0	219,200
2021	59,600	159,600	0	219,200
2022	59,600	159,600	0	219,200
2023	59,600	188,900	0	248,500
Calc.	122,500	273,900	0	396,400

Land Data					
Type	Effective		Influence		Influence Codes
	Frontage	Depth	Factor	Code	
11. Water (0-200)			%		1.Unimproved
12. Water (201-400)			%		2.Excess Frtg
13. Water (401-800)			%		3.Topography
14. Water (801-1600)			%		4.Size/Shape
15. Water (1601-3200)			%		5.Access
			%		6.Restriction
			%		7.Open Space
			%		8.Environmental
			%		9.Condo
Square Foot		Square Feet		Acres	
16. Water (3201-6400)			%		30.Blueberry(1-20
17. Water SF Amen			%		31.Blueberry(21 -
18. Water View			%		32.Crop Land
19. Water Influen			%		33.Pasture
20. ShoreFront A			%		34.Shorefront B
			%		35.Shorefront C
			%		36.ANTENNA SITE
			%		37.Softwood TG
			%		38.Mixed Wood TG
			%		39.Hardwood TG
			%		40.Wasteland
			%		41.Woodland
			%		42.Mobile Home Si
			%		43.Camp Site
			%		44.Lot Improvemen
			%		45.BA SF - Oce
			%		46.SP Meadow Cond
Total Acreage		1.50			

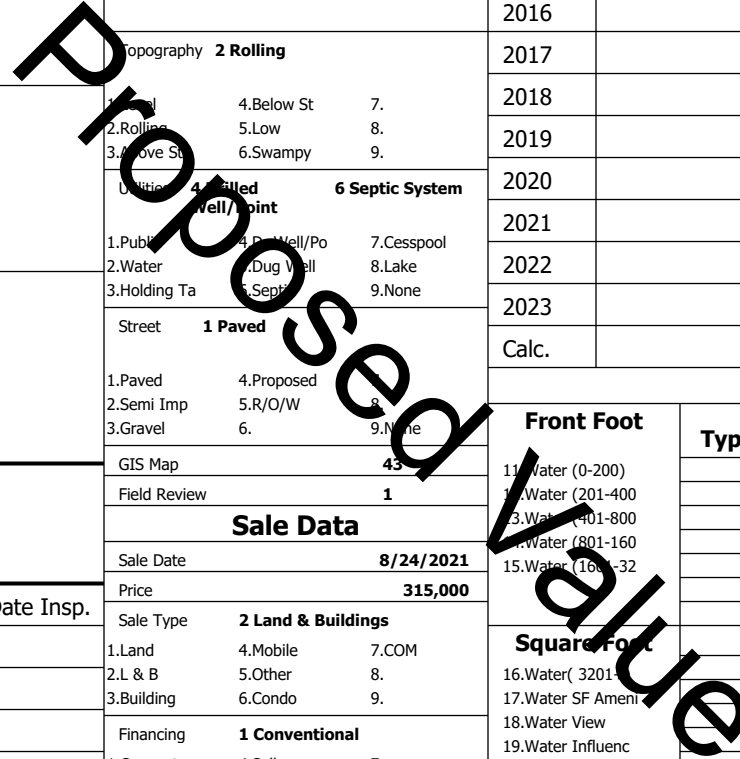

Gray

Map Lot 043-024-022-000

Account 1303

Location 11 FROST RD

Card 1

Of 1

8/05/2024

Building Style 6 Split Level	SF Bsmt Living 0	Layout 1 Typical
1.Conv. 5.Garrison 9.NE farm	Fin Bsmt Grade 0 0	1.Typical 4. 7.
2.Ranch 6.Split 10.Colonia	Secondary Heat 2	2.Inadeq 5. 8.
3.R Ranch/ 7.Contemp 11.Cottage	Heat Type 100% 1 Hot Water BB	3. 6. 9.
4.Cape 8.Log 12.Gambrel	1.HWBB 5.FWA 9.None	Attic 9 None
Dwelling Units 1	2.HWCI 6.Monitor 10.UNH2F	1.1/4 Fin 4.Full Fin 7.
Other Units 0	3.HWRF 7.Electric 11.Geother	2.1/2 Fin 5.FI/Stair 8.
Stories 2 Two Story	4.Steam 8.FI/Wall 12.Heat/Co	3.3/4 Fin 6. 9.None
1.1 4.1.5 7.	Cool Type 0% 9 None	Insulation 1 Full
2.2 5.1.75 8.	1.Central 4.W&C Air 7.	1.Full 4.Minimal 7.
3.3 6.2.5 9.	2.Evapor 5. 8.	2.Heavy 5. 8.
Exterior Walls 2 Vinyl/Aluminum	3.H Pump 6. 9.None	3.Capped 6. 9.None
1.Clapboa 5.Stucco 9.B & B	Kitchen Style 2 Typical	Unfinished % 0%
2.Vin/Al 6.Brick 10.Cemplan	1.Modern 4.Obsolete	Grade & Factor 3 Average 100%
3.Compos./ 7.Stone 11.Concret	2.Typical 5. 8.	1.E Grade 4.B Grade 7.SC Grade
4.Asbestos 8.Wood Shi 12.Wood Bo	3.Old Type 6. 9.None	2.C Grade 5.A Grade 8.
Roof Surface 1 Asphalt Shingles	Bath(s) Style 2 Typical Bath(s)	3.D Grade 6.AA Grade 9.Same
1.Asphalt 4.Composit 7.Other	1.Modern 4.Obsolete 7.	SQFT (Footprint) 576
2.Slate 5.Wood 8.	2.Typical 5. 8.	Condition 4 Average
3.Metal 6.Roll Roo 9.	3.Old Type 6. 9.None	1.Poor Avg 7.V G
SF Masonry Trim 0	# Rooms 5	2.Fair Avg 8.Exc
SOLAR VOLTAIC 0	# Bedrooms 3	3.Avg- Good 9.Same
OPEN-4- 0	# Full Baths 1	Phys. % Good 0%
Year Built 1999	# Half Baths 1	Funct. % Good 100%
Year Remodeled 0	# Addn Fixtures 0	Functional Code 9 None
Foundation 1 Concrete	# Fireplaces 0	1.Incomp 4.Delap 9.Layoff
1.Concrete 4.Wood 7.		2.O-Built 5.Bsmt 8.Long term
2.C Block 5.Slab 8.		3.Damage 6.Style 9.None
3.Br/Stone 6.Piers 9.		Econ. % Good 100%
Basement 5 Crawl Space		Economic Code None
1.1/4 Bmt 4.Full Bmt 7.		0.None 3.No Power 6.Obsolete
2.1/2 Bmt 5.Crwl 8.		1.Location 4.Generate 9.None
3.3/4 Bmt 6. 9.None		2.Encroach 5.Flood Pl 9.
Bsmt Gar # Cars 0		Entrance Code 5 Estimated
Wet Basement 9 No Basement		1.Interior 4.Vacant 7.
1.Dry 4. 7.		2.Refusal 5.Estimate 8.
2.Damp 5. 8.	3.Informed 6. 9.	
3.Wet 6. 9.	Information Code 5 Estimate	
	1.Owner 4.Agent 7.	
	2.Relative 5.Estimate 8.	
	3.Tenant 6.Other 9.	

Date Inspected 5/21/2024

Additions, Outbuildings & Improvements

Type	Year	Units	Grade	Cond	Phys.	Funct.	Sound Value
26 1Sfr Overhang	0	48	0 0	0	0 %	100 %	
24 Frame Shed	0	64	2 100	4	0 %	100 %	
68 Wood Deck	2010	220	0 0	0	0 %	100 %	
1 One Story Frame	0	384	0 0	0	0 %	100 %	
					%	%	
					%	%	
					%	%	
					%	%	
					%	%	
					%	%	
					%	%	

