

KIMBALL, KEVIN
DUBE, ROBERT JR
23 FROST RD
GRAY ME 04039

B37150P87

Inspection Witnessed By:

| X | Date | Date Insp. |
|----------|-------------|------------|
| No./Date | Description | Date Insp. |
| | | |
| | | |
| | | |

Notes:
3136sq. ft Pole Barn

Gray

| Property Data | | | Assessment Record | | | | | |
|--|--|--|----------------------|--------------------|------------------|------------------|------------------|--------------------|
| Neighborhood 71 COMML USE | | | Year | Land | Buildings | Exempt | Total | |
| Tree Growth Year 0 | | | 2011 | 78,534 | 148,840 | 0 | 227,374 | |
| REVIEW c | | | 2012 | 78,534 | 148,840 | 0 | 227,374 | |
| Building Permit 0 | | | 2013 | 78,534 | 148,840 | 0 | 227,374 | |
| Zone/Land Use 15 Business Development | | | 2014 | 78,534 | 148,840 | 0 | 227,374 | |
| Secondary Zone 14 Limited Comm | | | 2015 | 78,500 | 148,800 | 0 | 227,300 | |
| Topography 1 Level | | | 2016 | 78,500 | 148,800 | 0 | 227,300 | |
| 1. Hill 4. Below St 7. | | | 2017 | 78,500 | 184,500 | 0 | 263,000 | |
| 2. Rolling 5. Low 8. | | | 2018 | 78,500 | 184,500 | 0 | 263,000 | |
| 3. Above St 6. Swampy 9. | | | 2019 | 99,100 | 215,200 | 0 | 314,300 | |
| 4. Filled Well/Point 6 Septic System | | | 2020 | 99,100 | 215,200 | 0 | 314,300 | |
| 1. Public 4. Dug Well/Po 7. Cesspool | | | 2021 | 99,100 | 215,200 | 0 | 314,300 | |
| 2. Water 8. Lake | | | 2022 | 99,100 | 215,200 | 0 | 314,300 | |
| 3. Holding Ta 9. None | | | 2023 | 99,100 | 215,200 | 0 | 314,300 | |
| Street 1 Paved | | | Calc. | 164,700 | 387,300 | 0 | 552,000 | |
| 1. Paved 4. Proposed | | | Land Data | | | | | |
| 2. Semi Imp 5. R/O/W | | | Front Foot | Type | Effective | Influence | Influence | |
| 3. Gravel 6. None | | | 11. Water (0-200) | | Frontage | Depth | Factor | Code |
| GIS Map 43 | | | 12. Water (201-400) | | | | % | 1. Unimproved |
| Field Review 1 | | | 13. Water (401-800) | | | | % | 2. Excess Frtg |
| Sale Data | | | 14. Water (801-160) | | | | % | 3. Topography |
| Sale Date 9/08/2020 | | | 15. Water (161-32) | | | | % | 4. Size/Shape |
| Price | | | 16. Water (3201-) | | | | % | 5. Access |
| 2 Land & Buildings | | | 17. Water SF Amen | | | | % | 6. Restriction |
| 1. Land 4. Mobile 7. COM | | | 18. Water View | | | | % | 7. Open Space |
| 2. L & B 5. Other 8. | | | 19. Water Influen | | | | % | 8. Environmental |
| 3. Building 6. Condo 9. | | | 20. ShoreFront A | | | | % | 9. Condo |
| Financing 9 Unknown | | | Square Foot | Square Feet | | | | Acres |
| 1. Convent 4. Seller 7. | | | 16. Water (3201- | | | | % | 30. Blueberry(1-20 |
| 2. FHA/VA 5. Private 8. | | | 17. Water SF Amen | | | | % | 31. Blueberry(21 - |
| 3. Assumed 6. Cash 9. Unknown | | | 18. Water View | | | | % | 32. Crop Land |
| Validity 2 Related Parties | | | 19. Water Influen | | | | % | 33. Pasture |
| 1. Valid 4. Split 7. Multiple | | | 20. ShoreFront A | | | | % | 34. Shorefront B |
| 2. Related 5. Partial 8. Other | | | Fract. Acre | Acres/Sites | | | | 35. Shorefront C |
| 3. Distress 6. Exempt 9. Estate | | | 21. Base Lot | 76 | 2.00 | 100 | % | 0 |
| Verified 5 Public Record | | | 22. Base Lot Vacan | 79 | 2.67 | 100 | % | 0 |
| 1. Buyer 4. Agent 7. Family | | | 23. Base Lot Unpav | | | | % | |
| 2. Seller 5. Pub Rec 8. Other | | | Acres | | | | % | |
| 3. Lender 6. MLS 9. | | | 24. Acres to 10 | | | | % | |
| | | | 25. Acres 11-30 | | | | % | |
| | | | 26. Acres 31-50 | | | | % | |
| | | | 27. Acres 51& over | | | | % | |
| | | | 28. Acres 71 & Ove | | | | % | |
| | | | 29. Woods (41+) | | | | % | |
| | | | Total Acreage | 4.67 | | | | |

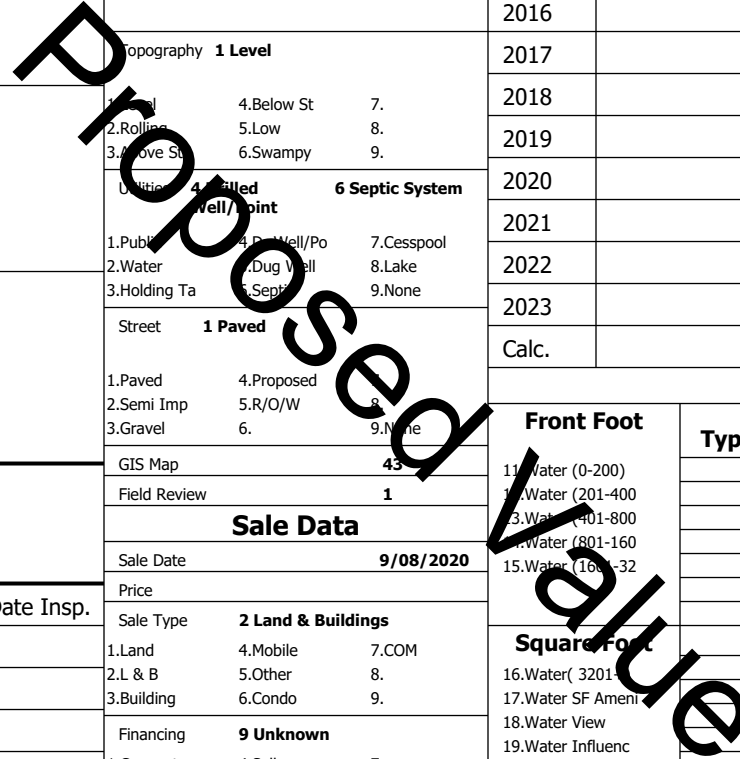

46.SP Meadow Cond

