

LABRECQUE, MICHAEL E  
75 NORTHERN OAKS DR  
RAYMOND ME 04071

B7681P36

Inspection Witnessed By:

No./Date	Description	Date Insp.
X		

Notes:

Gray

Property Data			Assessment Record					
Neighborhood <b>5 Little Sebago</b>			Year	Land	Buildings	Exempt	Total	
Tree Growth Year <b>0</b>			2011	9,750	597	0	10,347	
REVIEW <b>0</b>			2012	9,750	597	0	10,347	
Building Permit <b>0</b>			2013	9,750	597	0	10,347	
Zone/Land Use <b>12 Limited Residential</b>			2014	9,750	597	0	10,347	
Secondary Zone <b>23 Lake District</b>			2015	9,800	600	0	10,400	
Topography <b>2 Rolling</b>			2016	9,800	600	0	10,400	
1. Hill 4. Below St 7.			2017	9,800	600	0	10,400	
2. Rolling 5. Low 8.			2018	9,800	600	0	10,400	
3. Above St 6. Swampy 9.			2019	11,500	700	0	12,200	
4. Utility			2020	14,300	700	0	15,000	
1. Public 4. Dr. Well/Po 7. Cesspool			2021	14,300	700	0	15,000	
2. Water 5. Dug Well 8. Lake			2022	14,300	700	0	15,000	
3. Holding Ta 6. Septic 9. None			2023	15,500	700	0	16,200	
Street <b>3 Gravel</b>			Calc.	35,700	1,000	0	36,700	
1. Paved 4. Proposed			<b>Land Data</b>					
2. Semi Imp 5. R/O/W			<b>Front Foot</b>	<b>Type</b>	<b>Effective</b>		<b>Influence</b>	
3. Gravel 6. None 9. None			11. Water (0-200)		<b>Frontage</b>	<b>Depth</b>	<b>Factor</b>	<b>Code</b>
GIS Map <b>40</b>			12. Water (201-400)				%	1. Unimproved
Field Review <b>50</b>			13. Water (401-800)				%	2. Excess Frtg
<b>Sale Data</b>			14. Water (801-160)				%	3. Topography
Sale Date			15. Water (161-32)				%	4. Size/Shape
Price			16. Water (3201-)				%	5. Access
Sale Type			17. Water SF Amen				%	6. Restriction
1. Land 4. Mobile 7. COM			18. Water View				%	7. Open Space
2. L & B 5. Other 8.			19. Water Influen				%	8. Environmental
3. Building 6. Condo 9.			20. ShoreFront A				%	9. Condo
Financing			<b>Square Foot</b>	<b>Square Feet</b>				<b>Acres</b>
1. Convent 4. Seller 7.			21. Base Lot				%	30. Blueberry(1-20
2. FHA/VA 5. Private 8.			22. Base Lot Vacan				%	31. Blueberry(21 -
3. Assumed 6. Cash 9. Unknown			23. Base Lot Unpav				%	32. Crop Land
Validity			<b>Fract. Acre</b>	<b>Acres/Sites</b>				33. Pasture
1. Valid 4. Split 7. Multiple			24. Acres to 10	22	0.41	25	%	34. Shorefront B
2. Related 5. Partial 8. Other			25. Acres 11-30				%	35. Shorefront C
3. Distress 6. Exempt 9. Estate			26. Acres 31-50				%	36. ANTENNA SITE
Verified			27. Acres 51& over				%	37. Softwood TG
1. Buyer 4. Agent 7. Family			28. Acres 71 & Ove				%	38. Mixed Wood TG
2. Seller 5. Pub Rec 8. Other			29. Woods (41+)				%	39. Hardwood TG
3. Lender 6. MLS 9.			<b>Total Acreage</b>		0.41			40. Wasteland
								41. Woodland
								42. Mobile Home Si
								43. Camp Site
								44. Lot Improvemen
								45. BA SF - Oce
								46. SP Meadow Cond

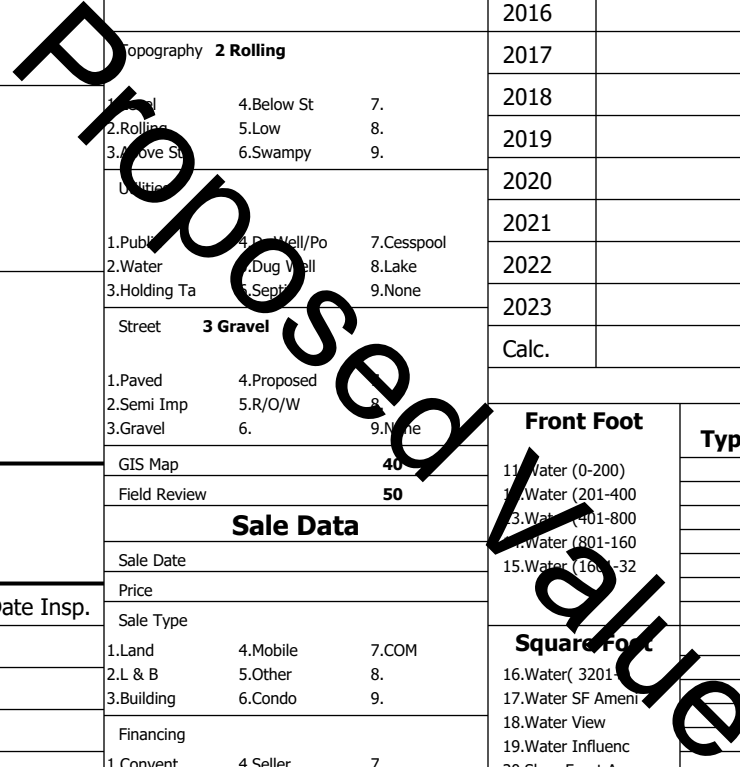

Gray

Map Lot 040-317-036-000

Account 4195

Location NORTHERN OAKS DR

Card 1

Of 1

8/05/2024

Building Style <b>0</b>	SF Bsmt Living <b>0</b>	Layout <b>0</b>
1.Conv. 5.Garrison 9.NE farm	Fin Bsmt Grade <b>0 0</b>	1.Typical 4. 7.
2.Ranch 6.Split 10.Colonia	Secondary Heat <b>0</b>	2.Inadeq 5. 8.
3.R Ranch/ 7.Contemp 11.Cottage	Heat Type <b>100% 0</b>	3. 6. 9.
4.Cape 8.Log 12.Gambrel	1.HWBB 5.FWA 9.None	Attic <b>0</b>
Dwelling Units <b>0</b>	2.HWCI 6.Monitor 10.UNH2F	1.1/4 Fin 4.Full Fin 7.
Other Units <b>0</b>	3.HWRF 7.Electric 11.Geother	2.1/2 Fin 5.FI/Stair 8.
Stories <b>0</b>	4.Steam 8.FI/Wall 12.Heat/Co	3.3/4 Fin 6. 9.None
1.1 4.1.5 7.	Cool Type <b>0% 9 None</b>	Insulation <b>0</b>
2.2 5.1.75 8.	1.Central 4.W&C Air 7.	1.Full 4.Minimal 7.
3.3 6.2.5 9.	2.Evapor 5. 8.	2.Heavy 5. 8.
Exterior Walls <b>0</b>	3.H Pump 6. 9.None	3.Capped 6. 9.None
1.Clapboar 5.Stucco 9.B & B	Kitchen Style <b>0</b>	Unfinished % <b>0%</b>
2.Vin/Al 6.Brick 10.Cemplan	1.Modern 4.Obsolete	Grade & Factor <b>0 0%</b>
3.Compos./ 7.Stone 11.Concret	2.Typical 5. 8.	1.E Grade 4.B Grade 7.SC Grade
4.Asbestos 8.Wood Shi 12.Wood Bo	3.Old Type 6. 9.None	2.C Grade 5.A Grade 8.
Roof Surface <b>0</b>	Bath(s) Style <b>0</b>	3.C Grade 6.AA Grade 9.Same
1.Asphalt 4.Composit 7.Other	1.Modern 4.Obsolete 7.	SQFT (Footprint) <b>0</b>
2.Slate 5.Wood 8.	2.Typical 5. 8.	1.Poor Avg 7.V G
3.Metal 6.Roll Roo 9.	3.Old Type 6. 9.None	2.Fair Avg 8.Exc
SF Masonry Trim <b>0</b>	# Rooms <b>0</b>	3.Avg- Good 9.Same
SOLAR VOLTAIC <b>0</b>	# Bedrooms <b>0</b>	Phys. % Good <b>0%</b>
OPEN-4- <b>0</b>	# Full Baths <b>0</b>	Funct. % Good <b>100%</b>
Year Built <b>0</b>	# Half Baths <b>0</b>	Functional Code <b>9 None</b>
Year Remodeled <b>0</b>	# Addn Fixtures <b>0</b>	1.Incomp 4.Delap 7.Layoff
Foundation <b>0</b>	# Fireplaces <b>0</b>	2.O-Built 5.Bsmt 8.Long term
1.Concrete 4.Wood 7.		3.Damage 6.Style None
2.C Block 5.Slab 8.		Econ. % Good <b>100%</b>
3.Br/Stone 6.Piers 9.		Economic Code <b>None</b>
Basement <b>0</b>		0.None 3.No Power 6.Obsolete
1.1/4 Bmt 4.Full Bmt 7.		1.Location 4.Generate 9.None
2.1/2 Bmt 5.Crwl 8.		2.Encroach 5.Flood Pl 9.
3.3/4 Bmt 6. 9.None		Entrance Code <b>0</b>
Bsmt Gar # Cars <b>0</b>		1.Interior 4.Vacant 7.
Wet Basement <b>0</b>		2.Refusal 5.Estimate 8.
1.Dry 4. 7.		3.Informed 6. 9.
2.Damp 5. 8.	Information Code <b>0</b>	
3.Wet 6. 9.	1.Owner 4.Agent 7.	
	2.Relative 5.Estimate 8.	
	3.Tenant 6.Other 9.	

Date Inspected

Additions, Outbuildings & Improvements

Type	Year	Units	Grade	Cond	Phys.	Funct.	Sound Value
24 Frame Shed	1970	120	2 100	4	0 %	100 %	
					%	%	1.One Story Fram
					%	%	2.Two Story Fram
					%	%	3.Three Story Fr
					%	%	4.1 & 1/2 Story
					%	%	5.1 & 3/4 Story
					%	%	6.2 & 1/2 Story
					%	%	21.Open Frame Por
					%	%	22.Encl Frame Por
					%	%	23.Frame Garage
					%	%	24.Frame Shed
					%	%	25.Frame Bay Wind
					%	%	26.1SFr Overhang
					%	%	27.Unfin Basement
					%	%	28.Unfinished Att
					%	%	29.Finished Attic

Proposed Value